

- NOTES:**
1. ALL DIMENSIONS SHOWN ARE IN METRES UNLESS OTHERWISE.
 2. DO NOT SCALE FROM THIS DRAWING
 3. POSITION OF SEWERS IS TAKEN FROM ENVIROFLOW CAD SURVEY INFORMATION REFERENCE ENV10013, SUPPLEMENTED BY INFORMATION PROVIDED BY BARNSELY METROPOLITAN BOROUGH COUNCIL.

- KEY**
- SURFACE WATER SEWER - YORKSHIRE WATER
 - SURFACE WATER SEWER - BMBC
 - COMBINED SEWER - YORKSHIRE WATER
 - COMBINED SEWER - BMBC
 - - YW - - MISSING YW COMBINED SEWER
 - - YW - - MISSING YW SURFACE WATER SEWER
 - - RISING - - MISSING YW MAIN
 - CONNECTION
 - ADDITIONAL INFORMATION REQUIRED

P01	19/03/24	First Revision	LB	CK	VB
Rev	Date	Description	Drawn	Check	App'd
S3		Drawing status: Suitable for Review and Comment			4

Designer:

First Floor, 3 Wellington Place, Leeds, LS1 4AP, UK
T+ 44 (0) 113 395 6200
wsp.com

Client:

BARNSELY
Metropolitan Borough Council

Project Title
A635 Bus Rapid Transfer Route

Drawing Title
**Drainage Network
Sheet 6 of 9**

Scale@A1: 1:250	Checked: C.Kirk	Approved: V.Belton	Date: 19/03/24
Project No: 70111595	Designed: L.Brown	Drawn: L.Brown	Rev: P01

Drawing Number:
70111595-WSP-HDG-AZ-DR-CD-000024

© WSP UK Ltd

This map is reproduced from Ordnance Survey material with the permission of Ordnance Survey on behalf of the Controller of Her Majesty's Stationery Office © Crown copyright. Unauthorised reproduction infringes Crown copyright and may lead to prosecution or civil proceedings. 100022264 (2009).



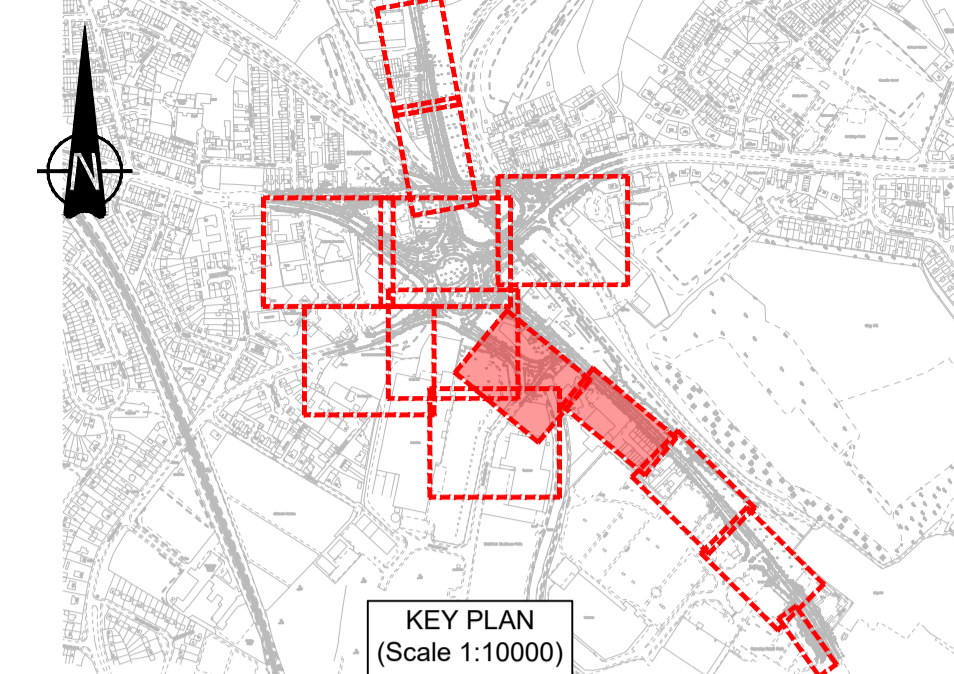
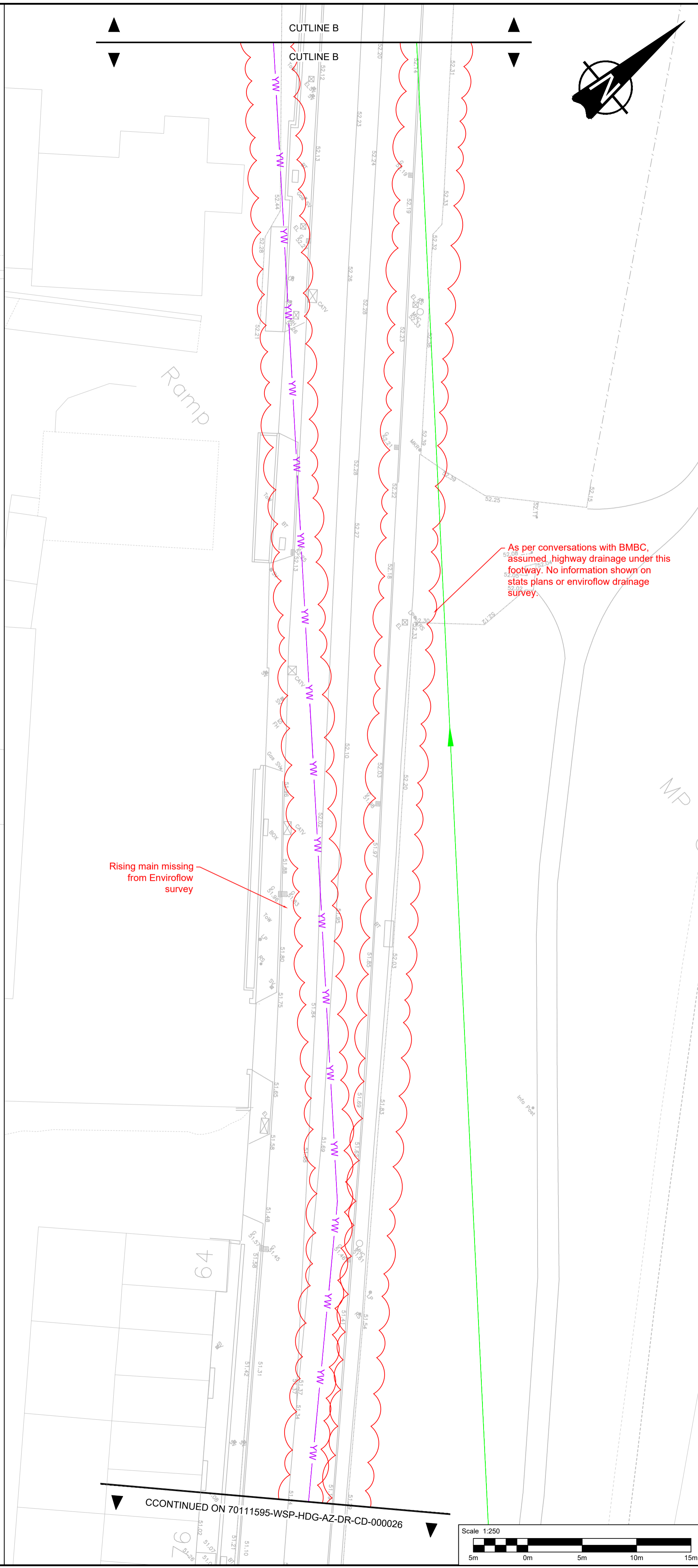
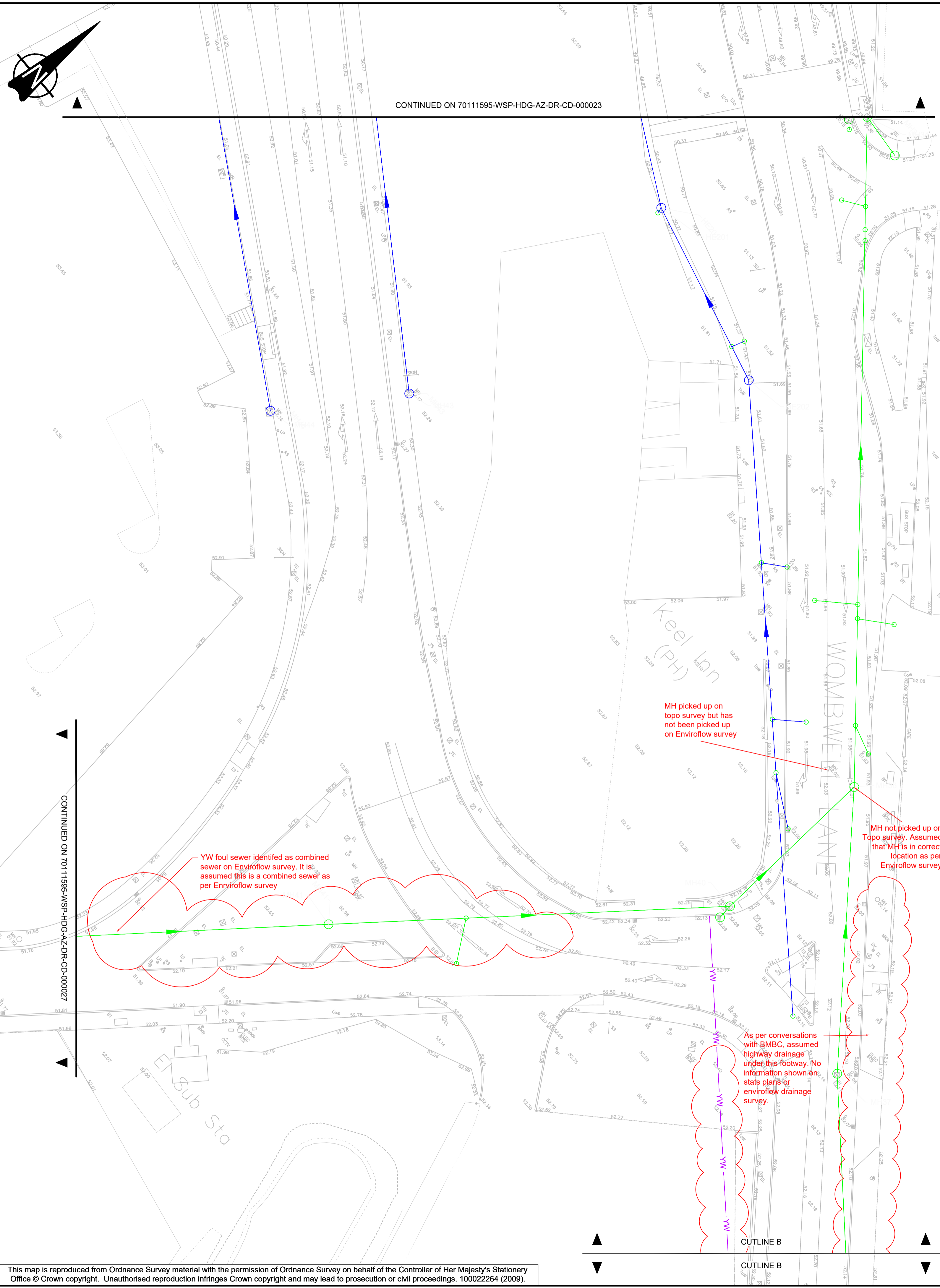

- NOTES:**
- ALL DIMENSIONS SHOWN ARE IN METRES UNLESS OTHERWISE.
 - DO NOT SCALE FROM THIS DRAWING
 - POSITION OF SEWERS IS TAKEN FROM ENVIROFLOW CAD SURVEY INFORMATION REFERENCE ENV10013, SUPPLEMENTED BY INFORMATION PROVIDED BY BARNSELY METROPOLITAN BOROUGH COUNCIL.

- KEY**
- SURFACE WATER SEWER - YORKSHIRE WATER
 - SURFACE WATER SEWER - BMBC
 - COMBINED SEWER - YORKSHIRE WATER
 - COMBINED SEWER - BMBC
 - MISSING YW COMBINED SEWER
 - MISSING YW SURFACE WATER SEWER
 - MISSING YW MAIN
 - CONNECTION
 - ADDITIONAL INFORMATION REQUIRED

YW foul sewer identified as combined sewer on Enviroflow survey. It is assumed this is a combined sewer as per Enviroflow survey

MH picked up on topo survey but has not been picked up on Enviroflow survey

MH not picked up on Topo survey. Assumed that MH is in correct location as per Enviroflow survey

Rising main missing from Enviroflow survey

As per conversations with BMBC, assumed highway drainage under this footway. No information shown on stats plans or enviroflow drainage survey.

As per conversations with BMBC, assumed highway drainage under this footway. No information shown on stats plans or enviroflow drainage survey.

Rev	Date	Description	Drawn	Check	App'd
P01	19/03/24	First Revision	LB	CK	VB
S3		Drawing status: Suitable for Review and Comment			4

wsp

First Floor, 3 Wellington Place, Leeds, LS1 4AP, UK
T+ 44 (0) 113 395 6200
wsp.com

BARNSELY
Metropolitan Borough Council

Project Title: A635 Bus Rapid Transfer Route

Drawing Title: Drainage Network
Sheet 7 of 9

Scale@A1: 1:250	Checked: C.Kirk	Approved: V.Belton	Date: 19/03/24
Project No: 70111595	Designed: L.Brown	Drawn: L.Brown	Rev: P01

Drawing Number: 70111595-WSP-HDG-AZ-DR-CD-000025

© WSP UK Ltd



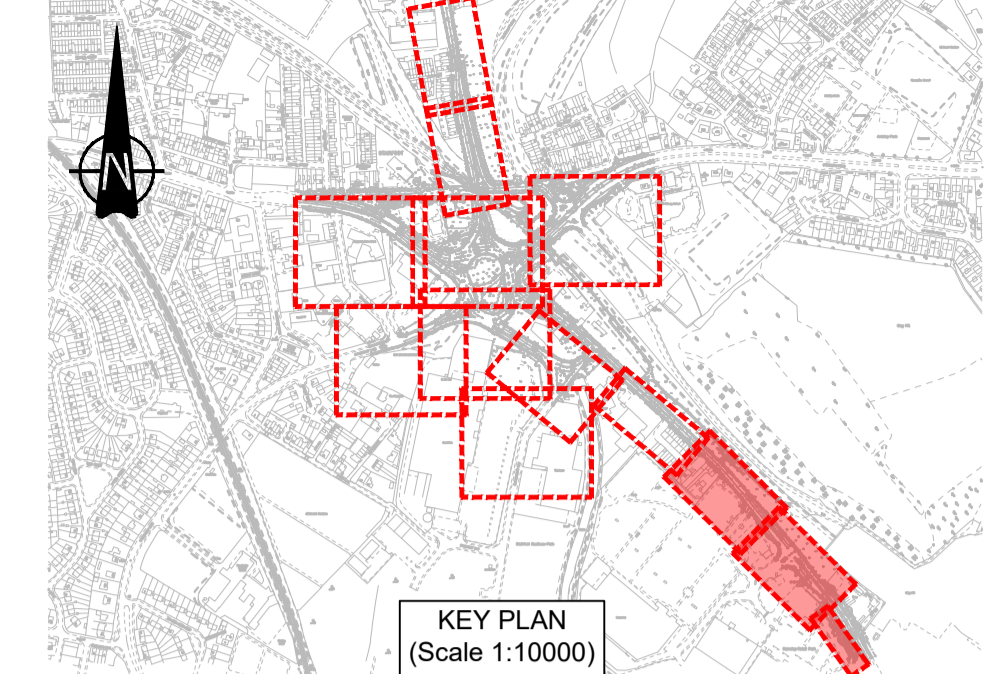
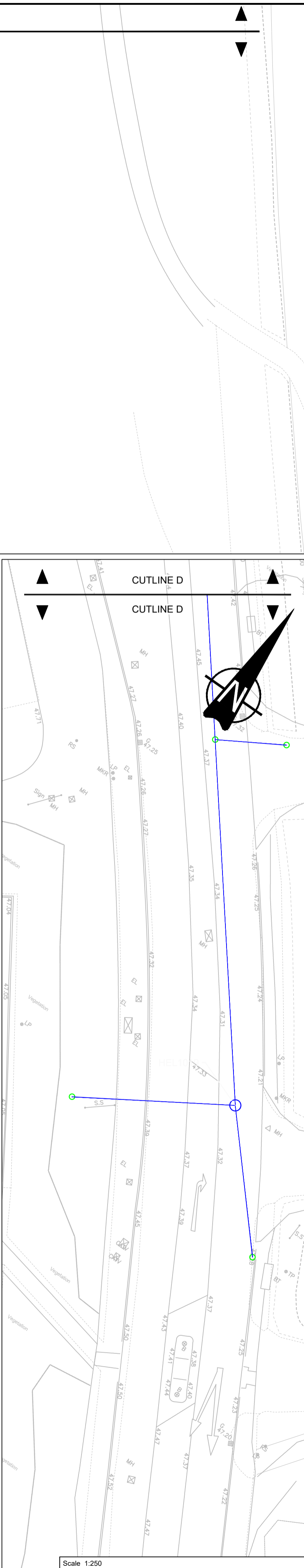
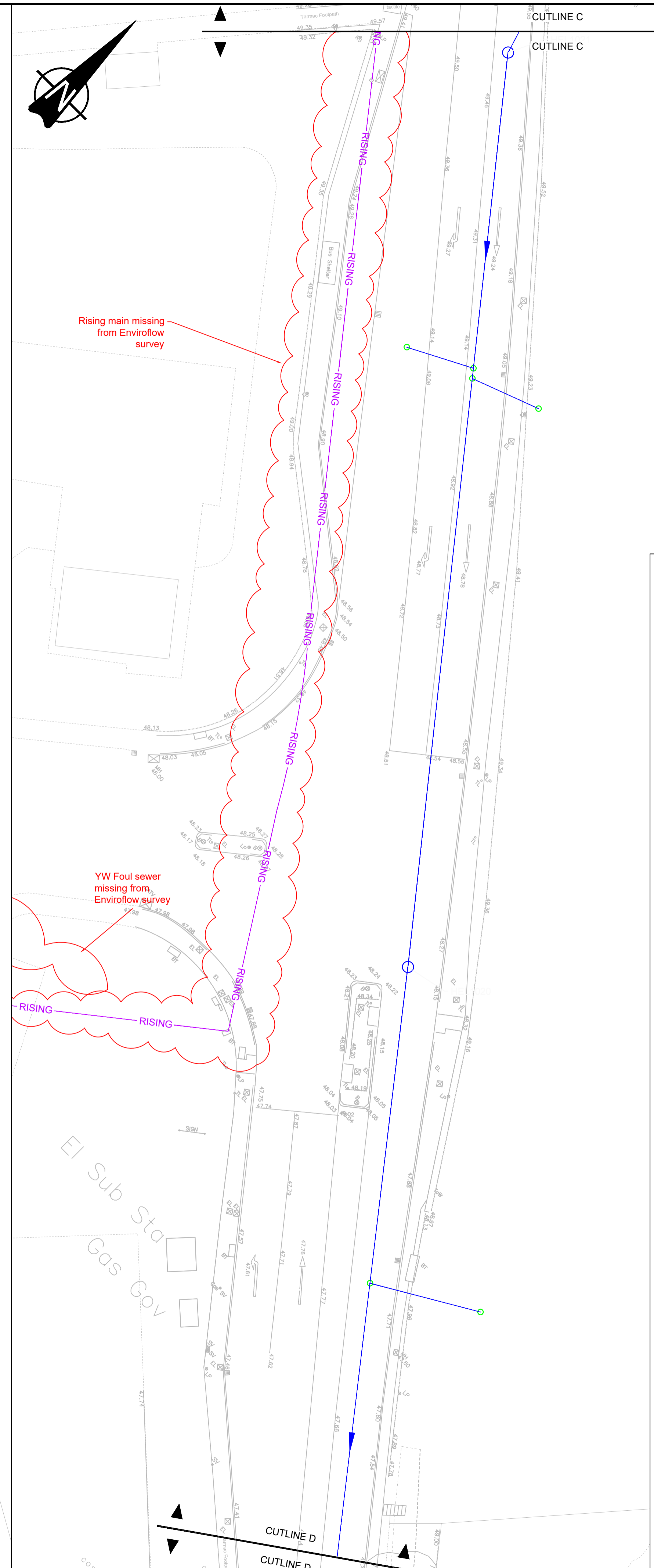
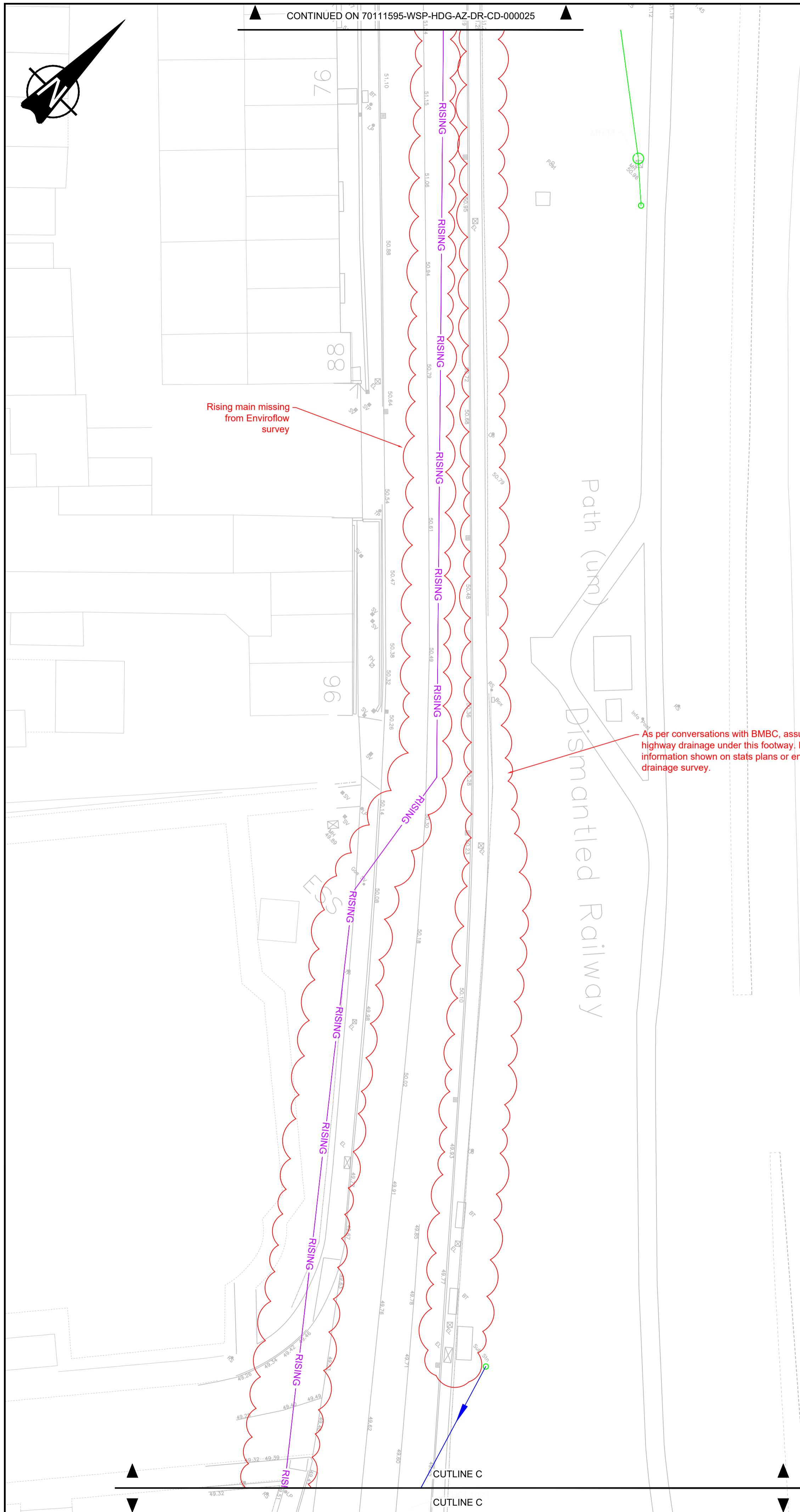

- NOTES:**
- ALL DIMENSIONS SHOWN ARE IN METRES UNLESS OTHERWISE.
 - DO NOT SCALE FROM THIS DRAWING
 - POSITION OF SEWERS IS TAKEN FROM ENVIROFLOW CAD SURVEY INFORMATION REFERENCE ENV10013, SUPPLEMENTED BY INFORMATION PROVIDED BY BARNSELY METROPOLITAN BOROUGH COUNCIL.

- KEY**
- SURFACE WATER SEWER - YORKSHIRE WATER
 - SURFACE WATER SEWER - BMBC
 - COMBINED SEWER - YORKSHIRE WATER
 - COMBINED SEWER - BMBC
 - MISSING YW COMBINED SEWER
 - MISSING YW SURFACE WATER SEWER
 - MISSING YW MAIN
 - CONNECTION
 - ADDITIONAL INFORMATION REQUIRED

Rev	Date	Description	Drawn	Check	App'd
P01	19/03/24	First Revision			
Status code: S3			Drawing status: Suitable for Review and Comment		Stage: 4

wsp

First Floor, 3 Wellington Place, Leeds, LS1 4AP, UK
T+ 44 (0) 113 395 6200
wsp.com

BARNSELY
Metropolitan Borough Council

Project Title: **A635 Bus Rapid Transfer Route**

Drawing Title: **Drainage Network Sheet 8 of 9**

Scale@A1: 1:250	Checked: C.Kirk	Approved: V.Belton	Date: 19/03/24
Project No: 70111595	Designed: L.Brown	Drawn: L.Brown	Rev: P01

Drawing Number: **70111595-WSP-HDG-AZ-DR-CD-000026**

© WSP UK Ltd

This map is reproduced from Ordnance Survey material with the permission of Ordnance Survey on behalf of the Controller of Her Majesty's Stationery Office © Crown copyright. Unauthorised reproduction infringes Crown copyright and may lead to prosecution or civil proceedings. 10002264 (2009).

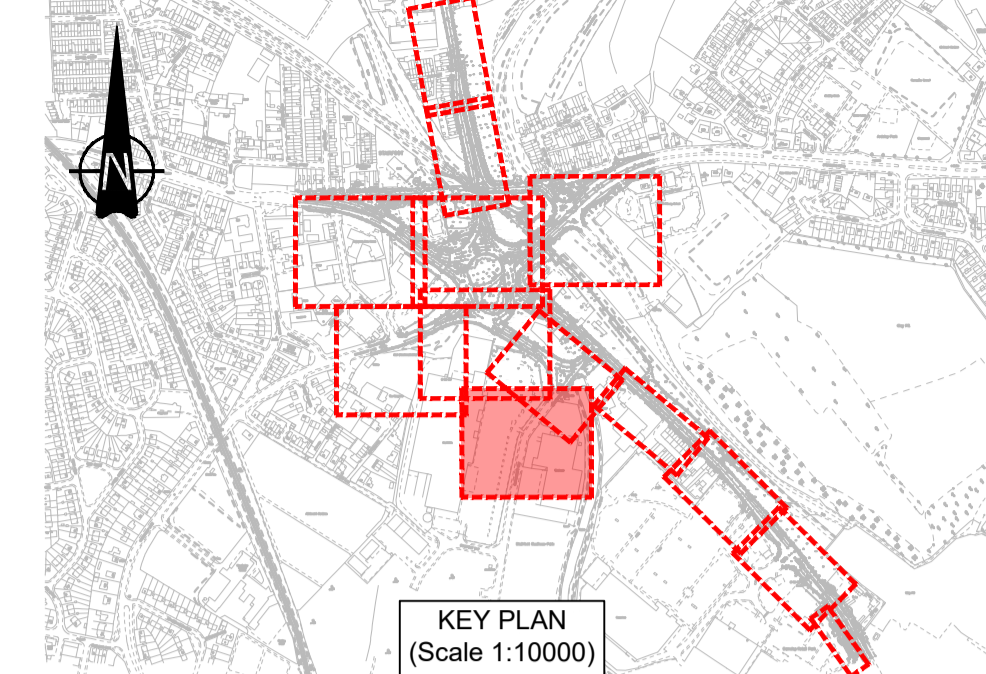
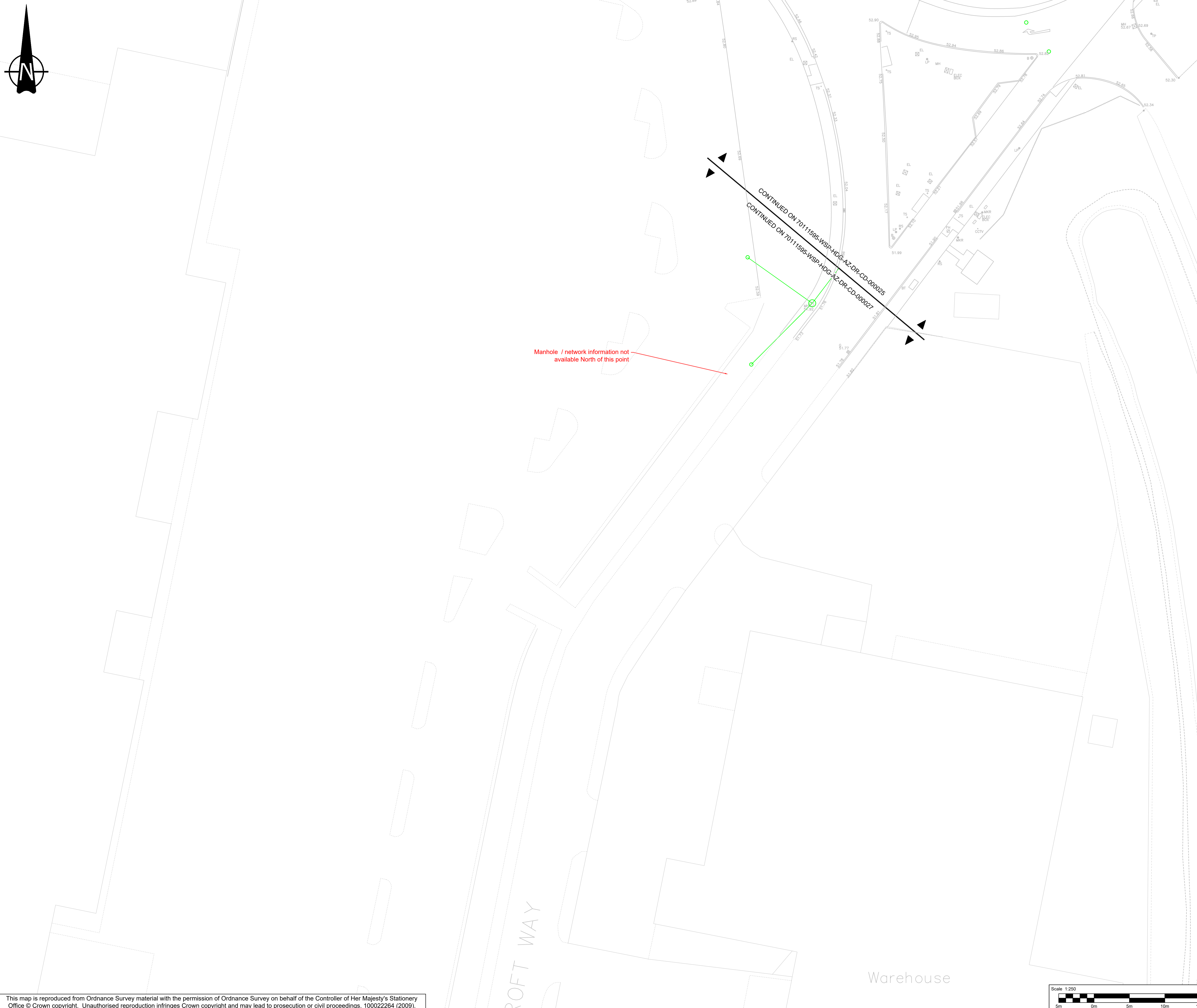

- NOTES:**
1. ALL DIMENSIONS SHOWN ARE IN METRES UNLESS OTHERWISE.
 2. DO NOT SCALE FROM THIS DRAWING
 3. POSITION OF SEWERS IS TAKEN FROM ENVIROFLOW CAD SURVEY INFORMATION REFERENCE ENV10013, SUPPLEMENTED BY INFORMATION PROVIDED BY BARNSELY METROPOLITAN BOROUGH COUNCIL.

KEY

	SURFACE WATER SEWER - YORKSHIRE WATER
	SURFACE WATER SEWER - BMBC
	COMBINED SEWER - YORKSHIRE WATER
	COMBINED SEWER - BMBC
	MISSING YW COMBINED SEWER
	MISSING YW SURFACE WATER SEWER
	MISSING YW MAIN
	CONNECTION
	ADDITIONAL INFORMATION REQUIRED

Rev	Date	Description	Drawn	Check	App'd
P01	19/03/24	First Revision	LB	CK	VB

Status code: S3 Drawing status: Suitable for Review and Comment Stage: 4

Designer:

First Floor, 3 Wellington Place, Leeds, LS1 4AP, UK
T+ 44 (0) 113 395 6200
wsp.com

Client:

BARNSELY
Metropolitan Borough Council

Project Title: A635 Bus Rapid Transfer Route

Drawing Title: Drainage Network
Sheet 9 of 9

Scale@A1: 1:250	Checked: C.Kirk	Approved: V.Belton	Date: 19/03/24
Project No: 70111595	Designed: L.Brown	Drawn: L.Brown	Rev: P01

Drawing Number: 70111595-WSP-HDG-AZ-DR-CD-000027

© WSP UK Ltd

This map is reproduced from Ordnance Survey material with the permission of Ordnance Survey on behalf of the Controller of Her Majesty's Stationery Office © Crown copyright. Unauthorised reproduction infringes Crown copyright and may lead to prosecution or civil proceedings. 100022264 (2009).



Appendix B

DESIGN FIX 0 GENERAL
ARRANGEMENT

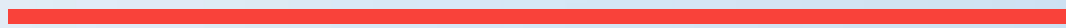

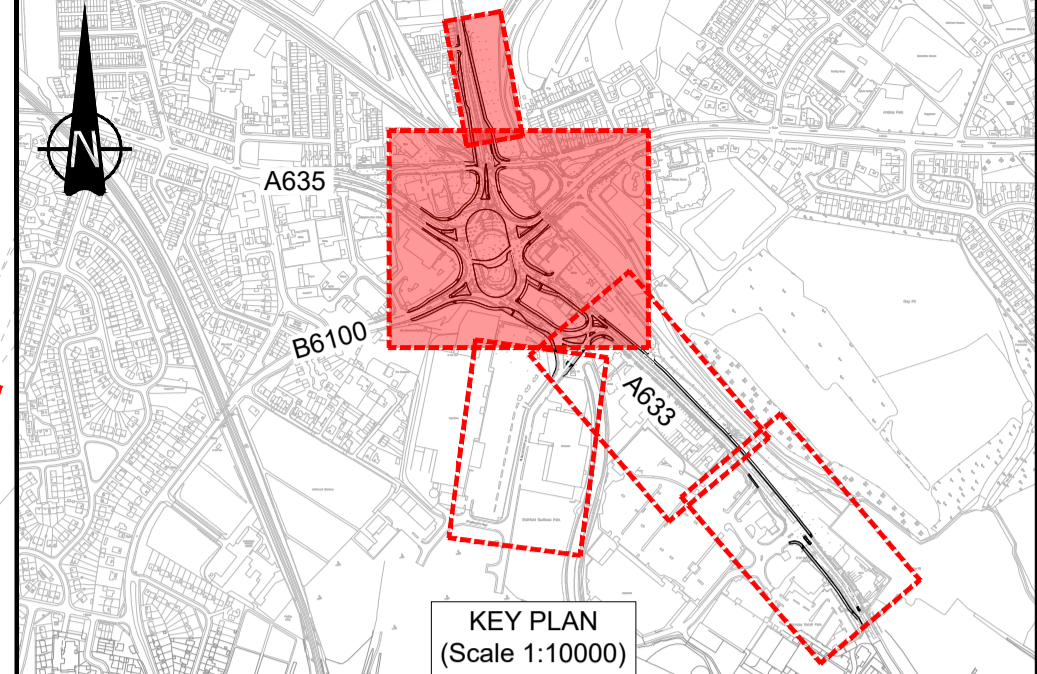
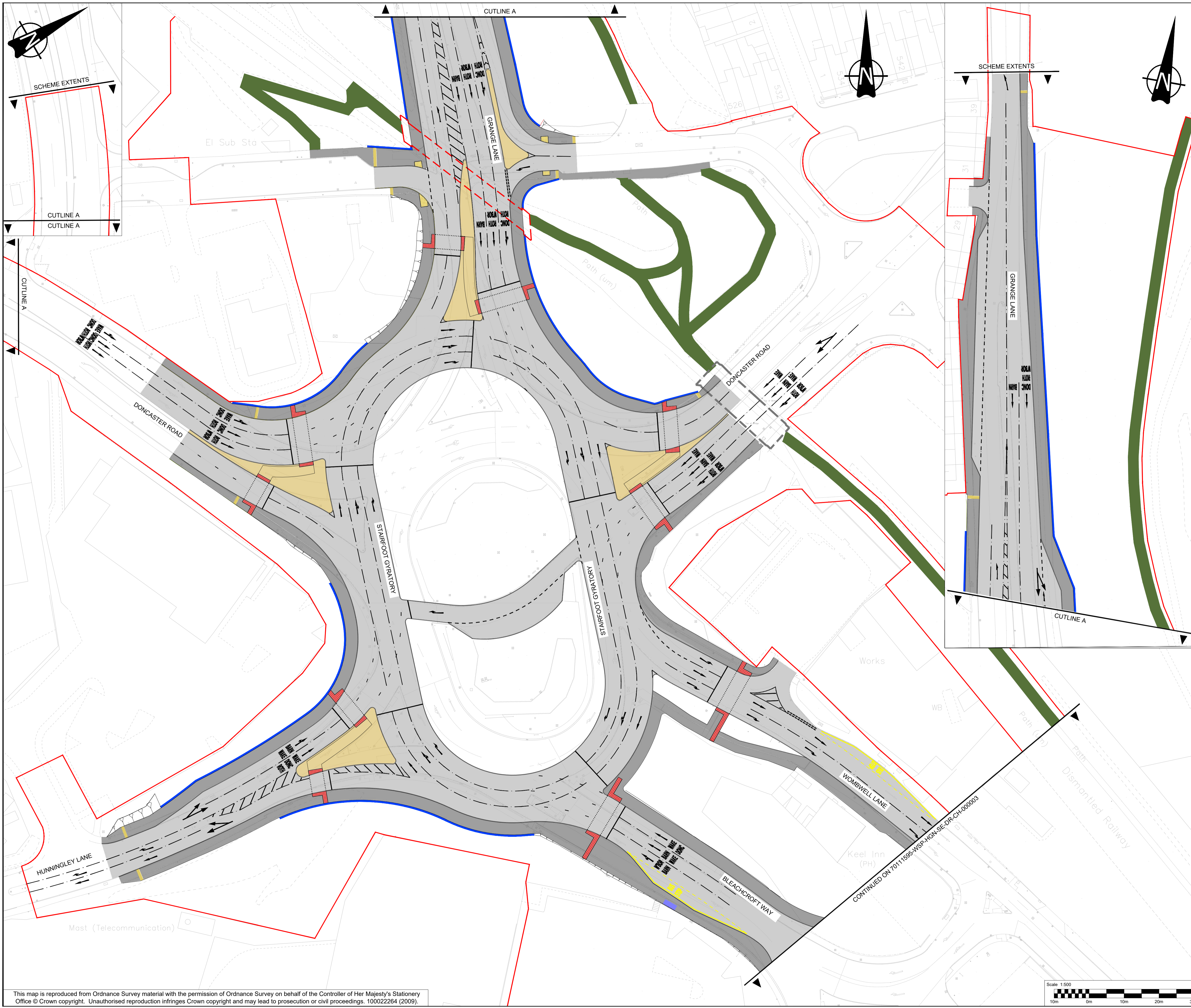

- NOTES:**
1. ALL DIMENSIONS SHOWN ARE IN METRES UNLESS OTHERWISE STATED.
 2. BACKGROUND MAPPING USED BASED ON OS WITH AN INSERTED LOCAL TOPOGRAPHICAL SURVEY PROVIDED BY OTHERS.

- KEY:**
- RED LINE BOUNDARY
 - CARRIAGEWAY
 - FOOTWAY
 - TRANS PENNINE TRAIL IMPROVEMENTS
 - PHYSICAL ISLAND
 - BLISTER TACTILE PAVING (RED)
 - BLISTER TACTILE PAVING (BUFF)
 - CORDUROY PAVING (BUFF)
 - EARTHWORKS
 - EXISTING STRUCTURE
 - PROPOSED STRUCTURE
 - RETAINING WALL
 - ROAD MARKING
 - BUS SHELTER

Rev	Date	Description	Drawn	Check	App'd	
P01	06/12/23	Design Fix 0		AW	BM	LB
P02	22/12/23	DESIGN FIX 0 - REVISED TO ADDRESS CLIENT COMMENTS		KK	BM	LB
P03	30/04/24	DESIGN FIX 2		DW	LB	IA

Status code:	Drawing status:	Stage:
S1	Suitable for Coordination	4

wsp

First Floor, 3 Wellington Place, Leeds, LS1 4AP, UK
T+ 44 (0) 113 395 6200
wsp.com

Client

BARNSELEY
Metropolitan Borough Council

Project Title

A635 Bus Rapid Transfer Route

Drawing Title

**General Arrangement
Sheet 1 of 2**

Scale@A1:	Checked:	Approved:	Date:
1:500	L.Basterfield	I.Akram	30/04/24
Project No:	Designed:	Drawn:	Rev:
70111595	A.Wallace	D.Williams	P03

Drawing Number:

70111595-WSP-HGN-AZ-DR-CH-000002

© WSP UK Ltd

This map is reproduced from Ordnance Survey material with the permission of Ordnance Survey on behalf of the Controller of Her Majesty's Stationery Office © Crown copyright. Unauthorised reproduction infringes Crown copyright and may lead to prosecution or civil proceedings. 10002264 (2009).

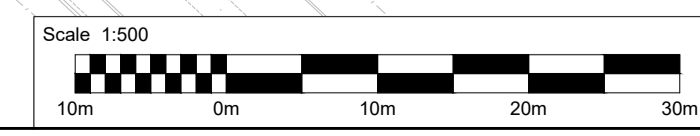

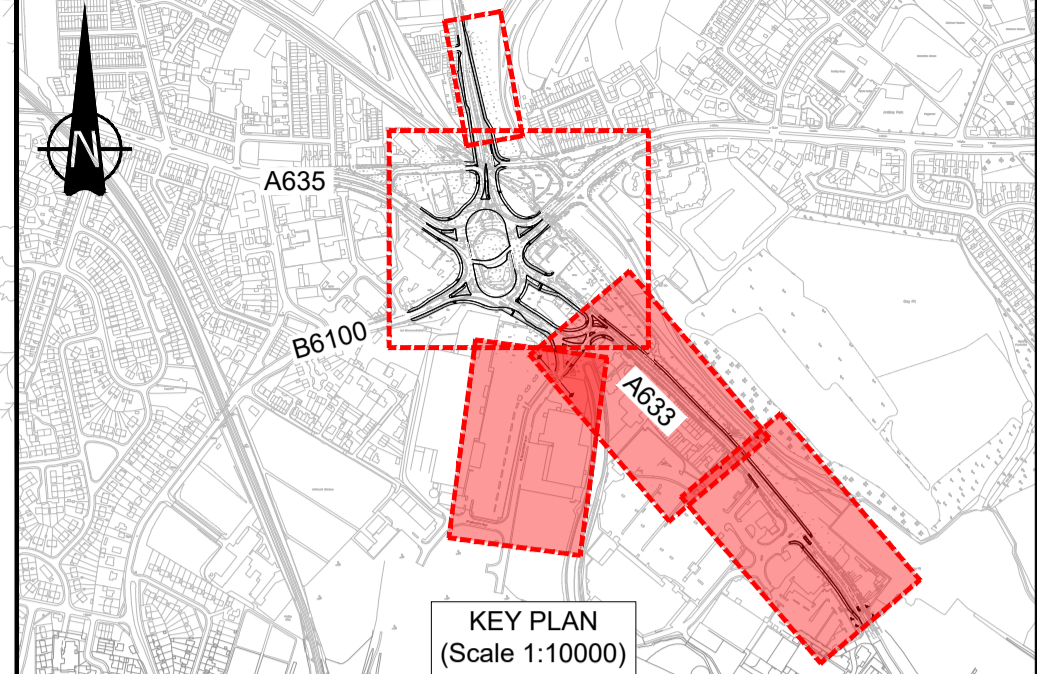
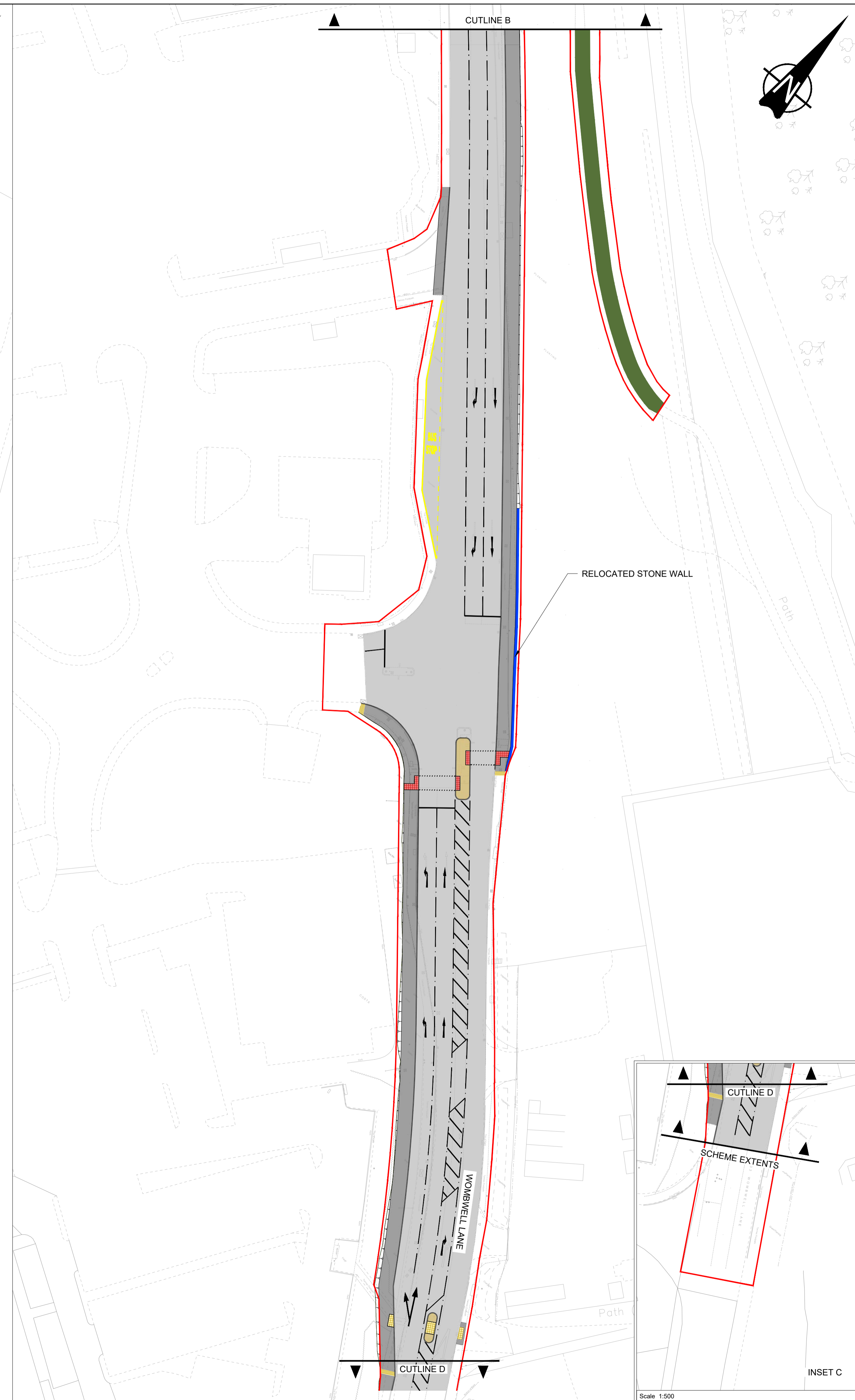
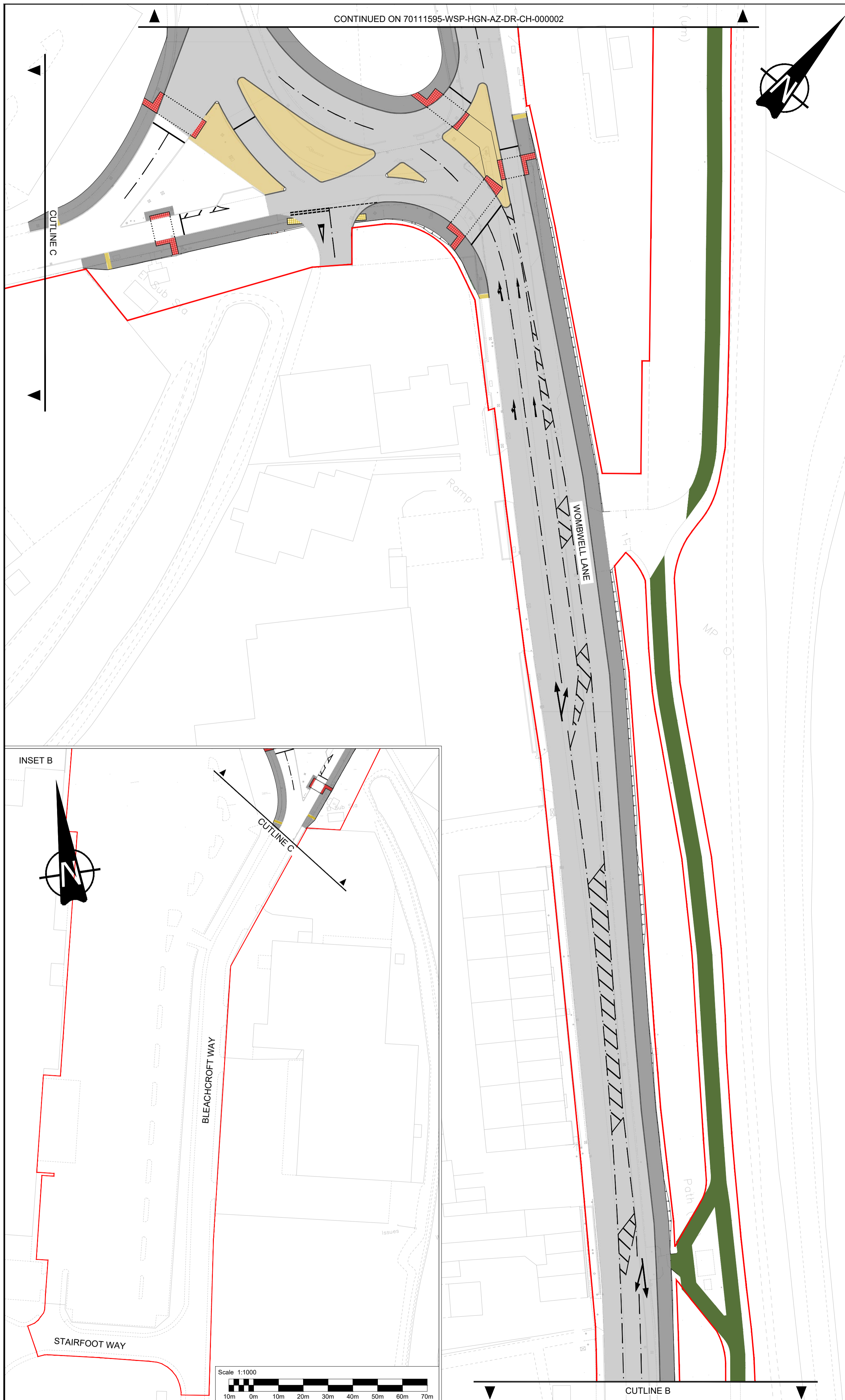

- NOTES:
1. ALL DIMENSIONS SHOWN ARE IN METRES UNLESS OTHERWISE STATED.
 2. BACKGROUND MAPPING USED BASED ON OS WITH AN INSERTED LOCAL TOPOGRAPHICAL SURVEY PROVIDED BY OTHERS.

- KEY:
- RED LINE BOUNDARY
 - CARRIAGEWAY
 - FOOTWAY
 - TRANS PENNINE TRAIL IMPROVEMENTS
 - PHYSICAL ISLAND
 - BLISTER TACTILE PAVING (RED)
 - BLISTER TACTILE PAVING (BUFF)
 - CORDUROY PAVING (BUFF)
 - EARTHWORKS
 - EXISTING STRUCTURE
 - PROPOSED STRUCTURE
 - RETAINING WALL
 - ROAD MARKING
 - BUS SHELTER

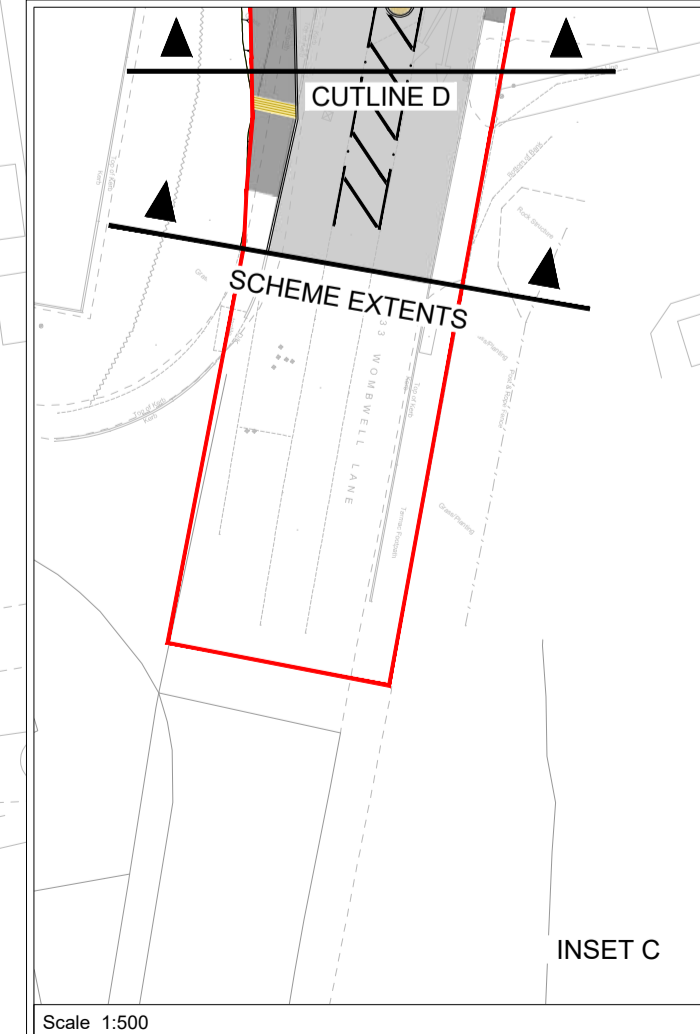
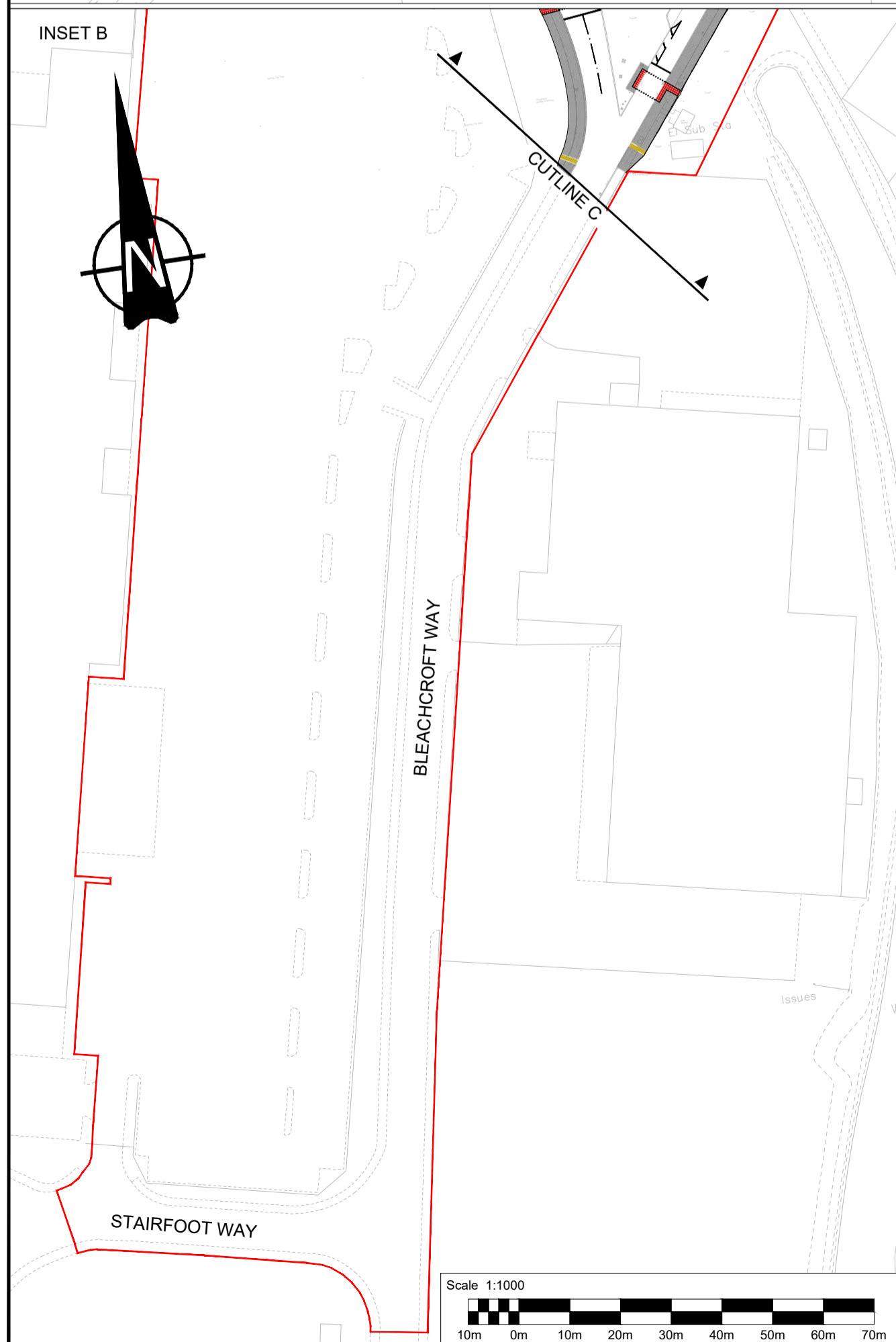

This map is reproduced from Ordnance Survey material with the permission of Ordnance Survey on behalf of the Controller of Her Majesty's Stationery Office © Crown copyright. Unauthorised reproduction infringes Crown copyright and may lead to prosecution or civil proceedings. 100022264 (2009).

P01	06/12/23	Design Fix 0				AW	BM	LB
P02	22/12/23	DESIGN FIX 0 - REVISED TO ADDRESS CLIENT COMMENTS				KK	BM	LB
P03	30/04/24	DESIGN FIX 2				DW	LB	IA
Rev	Date	Description	Drawn	Check	App'd			

Status code: S1 Drawing status: Suitable for Coordination Stage: 4

Designer:

First Floor, 3 Wellington Place, Leeds, LS1 4AP, UK
T+ 44 (0) 113 395 6200
wsp.com

Client:

BARNLSLEY
Metropolitan Borough Council

Project Title: **A635 Bus Rapid Transfer Route**

Drawing Title: **General Arrangement Sheet 2 of 2**

Scale@A1: As shown	Checked: L.Basterfield	Approved: I.Akram	Date: 30/04/24
Project No: 70111595	Designed: A.Wallace	Drawn: D.Williams	Rev: P03

Drawing Number: **70111595-WSP-HGN-AZ-DR-CH-000003**

Appendix C

DRAINAGE EMAIL CONVERSATION



Basterfield, Luke

From: Rowlands , Jake (PROJECT MANAGER) <JakeRowlands@barnsley.gov.uk>
Sent: 17 October 2023 14:06
To: Basterfield, Luke
Cc: Jones , Andrew (GROUP LEADER HIGHWAY DESIGN)
Subject: FW: A635 - Drainage Queries
Attachments: BCD5913-CKDB.pdf; BCD500A-Sewers Bedding & backfill.pdf; BCD510D-Connection to Existing Drain.pdf; BCD511C-Connection to manholes.pdf; BCD525D-Back Drop MH.pdf; BCD530D-Gullies Group 1.pdf; BCD531C-Gullies Group 2.pdf; BCD570C-Trench Backfill - Service Support.pdf; BCD571B-Trench Reinstatement.pdf; BCD5900-CKDB.pdf; BCD5901-CKDB.pdf; BCD5902-CKDB.pdf; BCD5903-CKDB.pdf; BCD5904-CKDB.pdf; BCD5905-CKDB.pdf; BCD5906-CKDB.pdf; BCD5907-CKDB.pdf; BCD5908-CKDB.pdf; BCD5909-CKDB.pdf; BCD5910-CKDB.pdf; BCD5911-CKDB.pdf; BCD5912-CKDB.pdf; DR-SK-003 - Stairfoot Roundabout - Existing Manhole Locations - P2.pdf; DR-SK-002 - Stairfoot Roundabout - Known Existing Drainage Apparatus.pdf

Afternoon Luke

Do you want a Drainage meeting late this week/early next week?

Please see responses in red:

- Please can we have a copy of BMBC standard details.

See examples attached, further details can be made available upon request, just let me know what is required

- Is it possible to get details of the proposed drainage survey that is being procured, this will allow us to review and see if all information we need is received.

Copy of drawings attached showing Manholes and drain runs to be surveyed.

- Details of the outfalls into the River Dearne. This may be covered in the drainage survey.

It is believed that the Highway Drainage system outfalls to the Public Sewer system not the River Dearne, this will be confirmed once the survey is complete

- Standards to be designed to – Assume this will be the DMRB.

Correct DMRB except that criteria for no flooding from the Highway Drainage system should be 1 in 10 years not 1 in 5.

- Any Information pertaining to any departures they may have already identified.

None as yet

- Is there any template available for WSP to use for any departures required.

We don't have a preferred format. I have asked Highways DC if they have an example of something you could adopt, or you could use the Welsh/ Scottish format as a guide, or a format that WSP have previously used. Key is to ensure that a check and challenge approach is incorporated.

- Confirm climate change uplift required:
 - Percentage uplift required.

Initial discussions with the LLFA suggest Climate change uplift should be 30% i.e 100 year Storm +30%, however, confirmation of this and any other LLFA requirements should be sought at an early stage.

- Would this be on the “new” pavement area only (ie the difference between existing impermeable area and proposed).
- Or would this be on the whole of the impermeable area. Note that this would mean considerable attenuation storage.

Initial discussions with the LLFA suggest Climate change uplift should be 30% i.e 100 year Storm +30% for the whole site, however, confirmation of this and any other LLFA requirements should be sought at an early stage.

- Any preference on attenuation storage type. Some local authorities might prefer oversized pipes rather than ponds or stormcell type features

Attenuation storage should preferably be oversized pipes, box culverts or pond dependent upon storage volume requirements and land availability, Stormcell or similar is not acceptable.

- Any requirements/preference on drainage collection type – gullies or CKD?

Gullies are preferable dependant upon spacing requirements, we can discuss this at our meeting

- Will BMBC be appointing a TA for drainage? Who is the approver.

Wayne Atkins – wayneatkins@barnsley.gov.uk, tel: 07748181374

Jake Rowlands

Project Manager

Strategic Transport

Growth & Sustainability

Barnsley Council

Mobile: 07561516162

E: jakerowlands@barnsley.gov.uk

*** Barnsley MBC Disclaimer: This e-mail and any files attached are confidential for the use of the intended recipient. If you have received this e-mail in error please notify the sender as soon as possible and delete the communication from your system without copying, disseminating or distributing the same in any way by any means. Any views or opinions expressed belong solely to the author and do not necessarily represent those of the Council. In particular, the Council will not accept liability for any defamatory statements made by email communications. Recipients are responsible for ensuring that all e-mails and files sent are checked for viruses. The Council will not accept liability for damage caused by any virus transmitted by this e-mail. No guarantees are offered on the security, content and accuracy of any e-mails and files received. Be aware that this e-mail communication may be intercepted for regulatory, quality control, or crime detection purposes unless otherwise prohibited. The content of this email and any attachment may be stored for future reference. Link to privacy statement - <https://www.barnsley.gov.uk/services/information-and-privacy/your-privacy/>



First Floor
3 Wellington Place
Leeds
LS1 4AP

wsp.com

OFFICIAL

Appendix B

GENERAL ARRANGEMENT PLAN



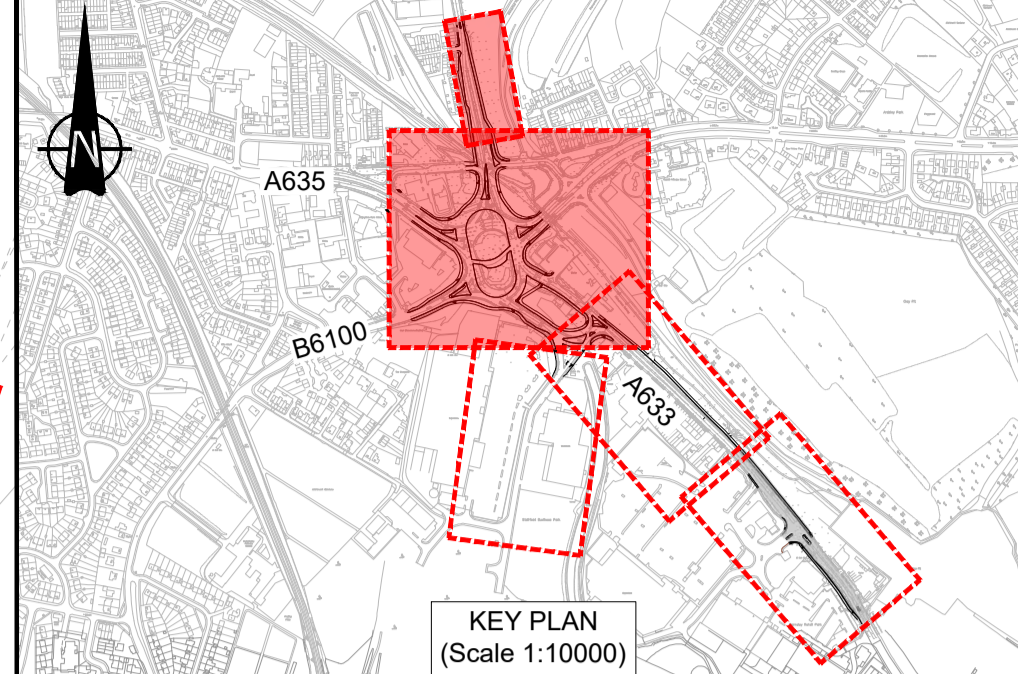
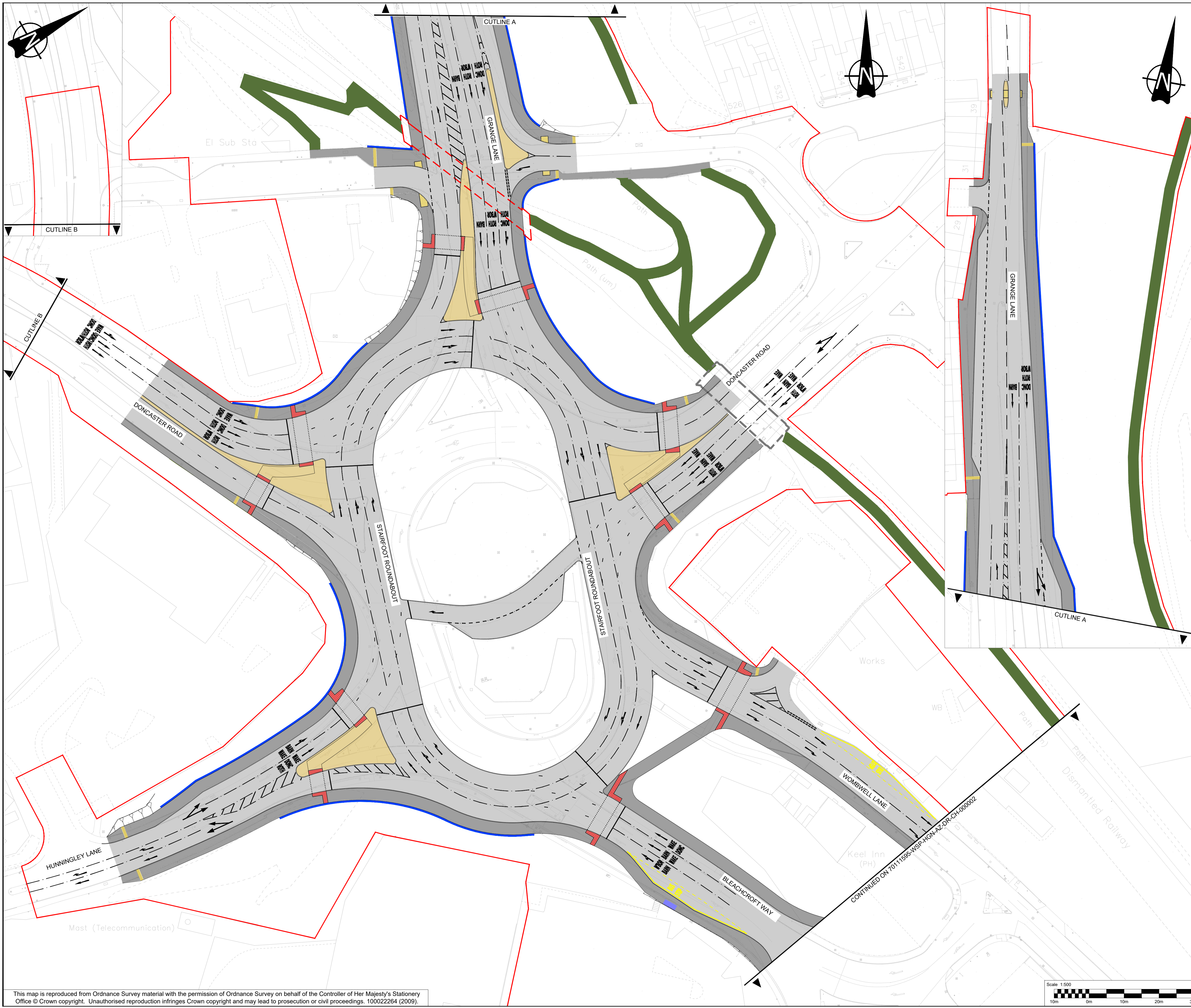

- NOTES:**
1. ALL DIMENSIONS SHOWN ARE IN METRES UNLESS OTHERWISE STATED.
 2. BACKGROUND MAPPING USED BASED ON OS WITH AN INSERTED LOCAL TOPOGRAPHICAL SURVEY PROVIDED BY OTHERS.

- KEY:**
- RED LINE BOUNDARY
 - CARRIAGEWAY
 - FOOTWAY
 - TRANS PENNINE TRAIL IMPROVEMENTS
 - PHYSICAL ISLAND
 - BLISTER TACTILE PAVING (RED)
 - BLISTER TACTILE PAVING (BUFF)
 - CORDUROY PAVING (BUFF)
 - EARTHWORKS
 - EXISTING STRUCTURE
 - PROPOSED STRUCTURE
 - RETAINING WALL
 - ROAD MARKING
 - BUS SHELTER

Rev	Date	Description	Drawn	Check	App'd
P01	06/12/23	Design FIX 0	AW	BM	LB
P02	22/12/23	DESIGN FIX 0 - REVISED TO ADDRESS CLIENT COMMENTS	KK	BM	LB
P03	30/04/24	DESIGN FIX 2	DW	LB	IA
P04	18/06/24	DESIGN FIX 2 - REVISED TO ADDRESS CLIENT COMMENTS	KK	BM	LB

Status code:	Drawing status:	Stage:
S1	Suitable for Coordination	4

wsp

First Floor, 3 Wellington Place, Leeds, LS1 4AP, UK
T+ 44 (0) 113 395 6200
wsp.com

Client

BARNLSLEY
Metropolitan Borough Council

Project Title

A635 Bus Rapid Transit Route

Drawing Title

General Arrangement
Sheet 1 of 2

Scale@A1:	1:500	Checked:	B.Mathew	Approved:	L.Basterfield	Date:	18/06/24
Project No:	70111595	Designed:	A.Wallace	Drawn:	K.Krishnan	Rev:	P04

Drawing Number:

70111595-WSP-HGN-AZ-DR-CH-000002

© WSP UK Ltd

This map is reproduced from Ordnance Survey material with the permission of Ordnance Survey on behalf of the Controller of Her Majesty's Stationery Office © Crown copyright. Unauthorised reproduction infringes Crown copyright and may lead to prosecution or civil proceedings. 10002264 (2009).

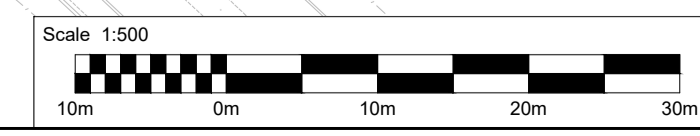

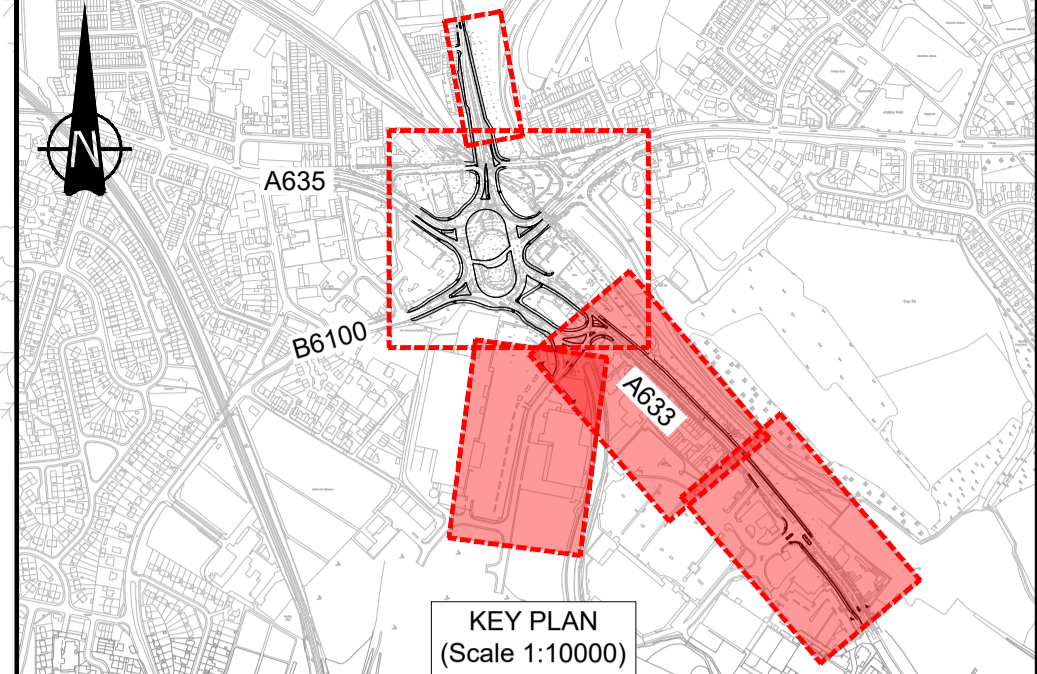
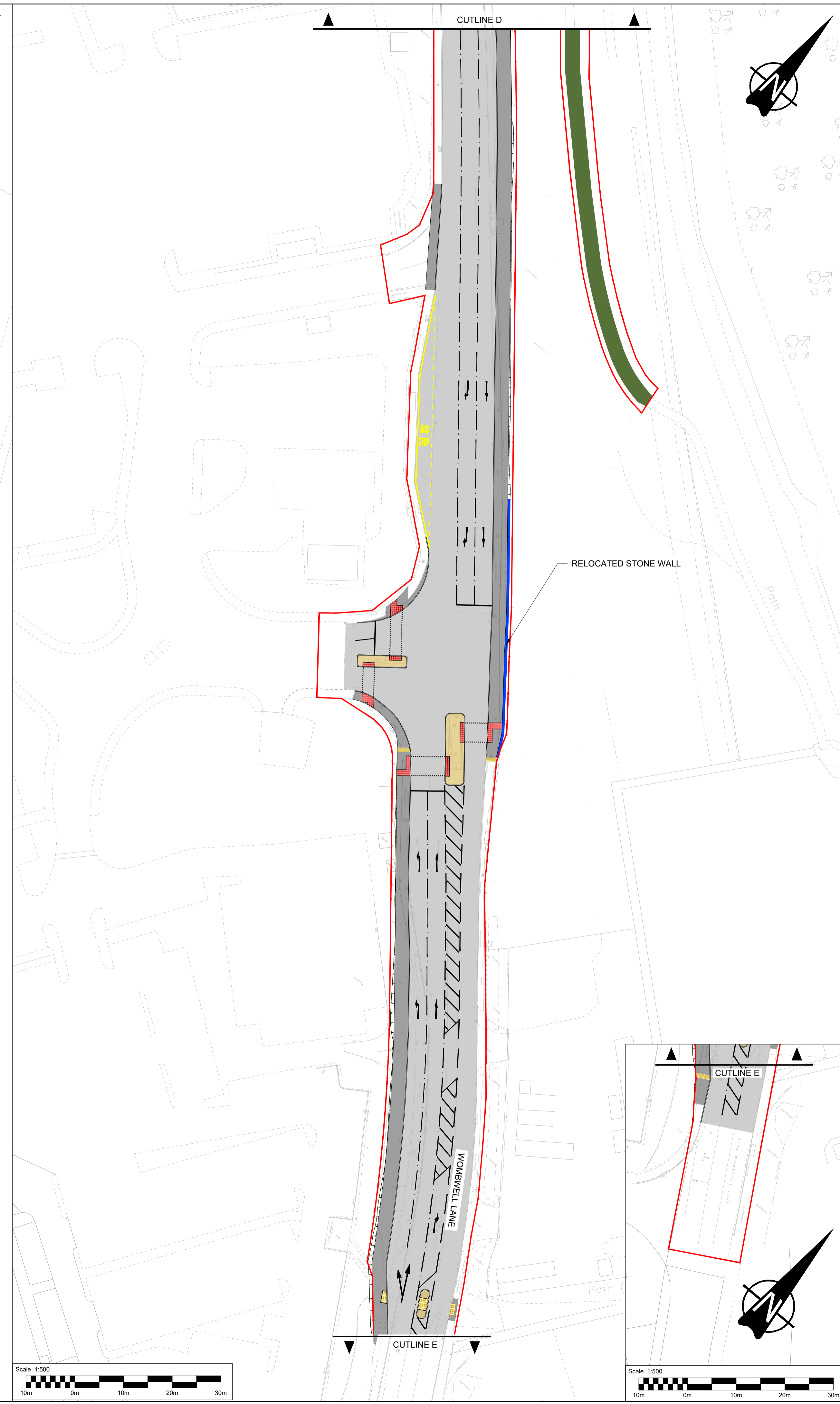
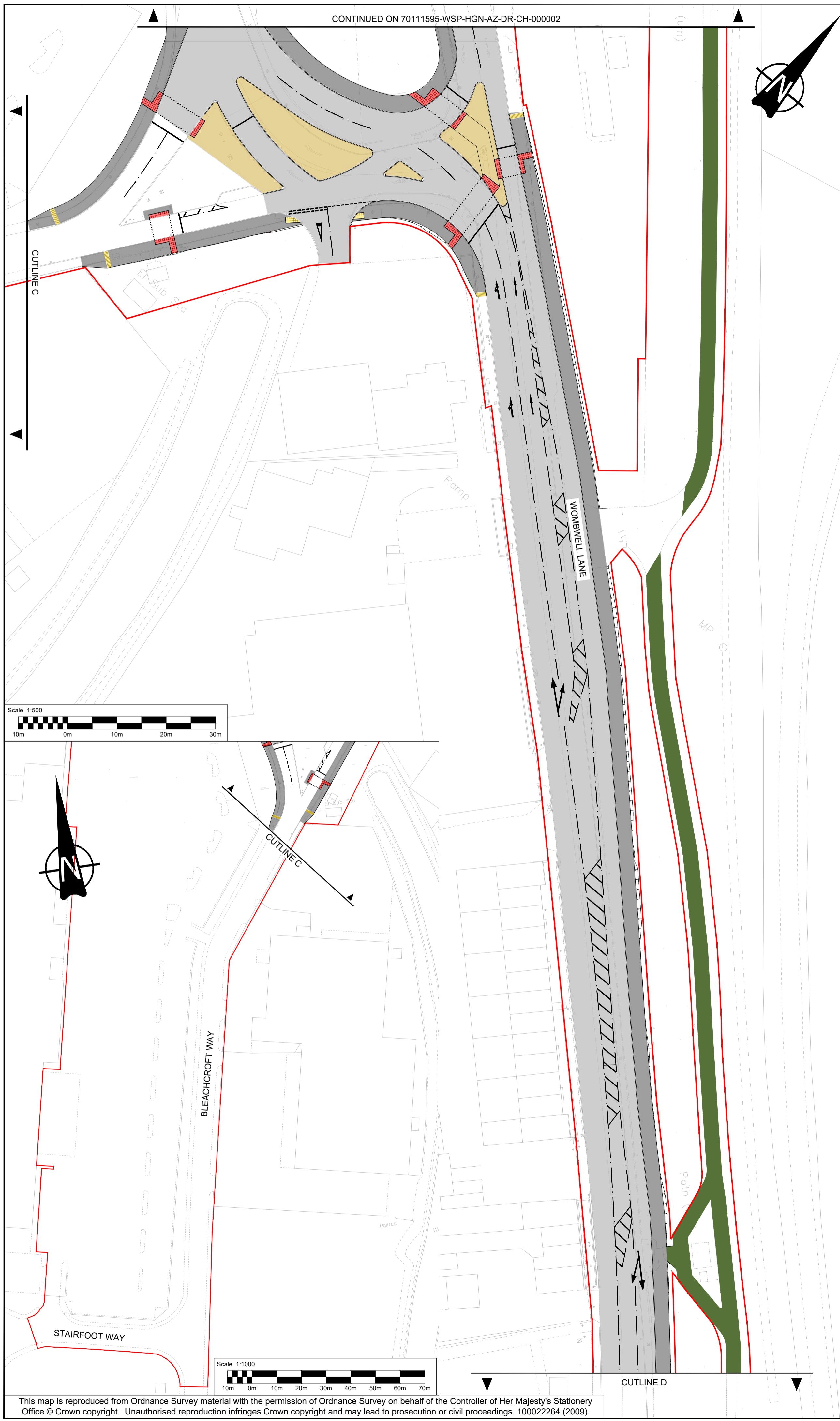

- NOTES:**
1. ALL DIMENSIONS SHOWN ARE IN METRES UNLESS OTHERWISE STATED.
 2. BACKGROUND MAPPING USED BASED ON OS WITH AN INSERTED LOCAL TOPOGRAPHICAL SURVEY PROVIDED BY OTHERS.

- KEY:**
- RED LINE BOUNDARY
 - CARRIAGEWAY
 - FOOTWAY
 - TRANS PENNINE TRAIL IMPROVEMENTS
 - PHYSICAL ISLAND
 - BLISTER TACTILE PAVING (RED)
 - BLISTER TACTILE PAVING (BUFF)
 - CORDUROY PAVING (BUFF)
 - EARTHWORKS
 - EXISTING STRUCTURE
 - PROPOSED STRUCTURE
 - RETAINING WALL
 - ROAD MARKING
 - BUS SHELTER

Rev	Date	Description	Drawn	Check	App'd
P01	06/12/23	Design FIX 0	AW	BM	LB
P02	22/12/23	DESIGN FIX 0 - REVISED TO ADDRESS CLIENT COMMENTS	KK	BM	LB
P03	30/04/24	DESIGN FIX 2	DW	LB	IA
P04	18/06/24	DESIGN FIX 2 - REVISED TO ADDRESS CLIENT COMMENTS	KK	BM	LB

Status code:	Drawing status:	Stage:
S1	Suitable for Coordination	4

wsp

First Floor, 3 Wellington Place, Leeds, LS1 4AP, UK
T+ 44 (0) 113 395 6200
wsp.com

Client: **BARNESLEY**
Metropolitan Borough Council

Project Title: **A635 Bus Rapid Transit Route**

Drawing Title: **General Arrangement Sheet 2 of 2**

Scale@A1:	Checked:	Approved:	Date:
As shown	B.Mathew	L.Basterfield	18/06/24
Project No:	Designed:	Drawn:	Rev:
70111595	A.Wallace	K.Krishnan	P04

Drawing Number: **70111595-WSP-HGN-AZ-DR-CH-000003**

© WSP UK Ltd

This map is reproduced from Ordnance Survey material with the permission of Ordnance Survey on behalf of the Controller of Her Majesty's Stationery Office © Crown copyright. Unauthorised reproduction infringes Crown copyright and may lead to prosecution or civil proceedings. 100022264 (2009).