

DO NOT SCALE: Contractor to check all dimensions and report any omissions or errors

NOTES

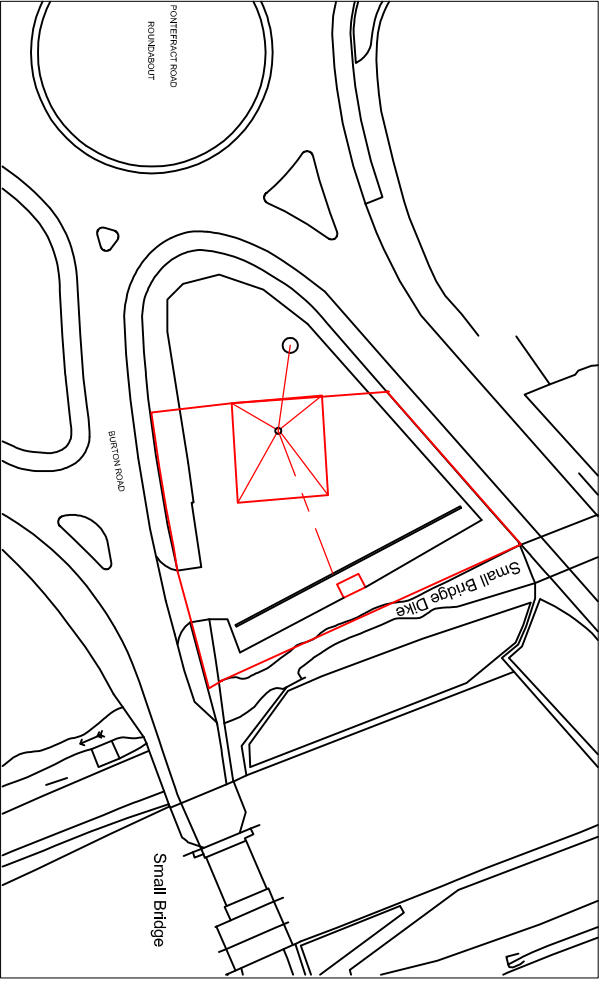

LOCATION PLAN
SCALE 1:1250 AT A3

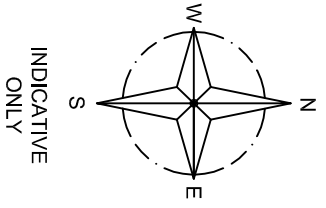
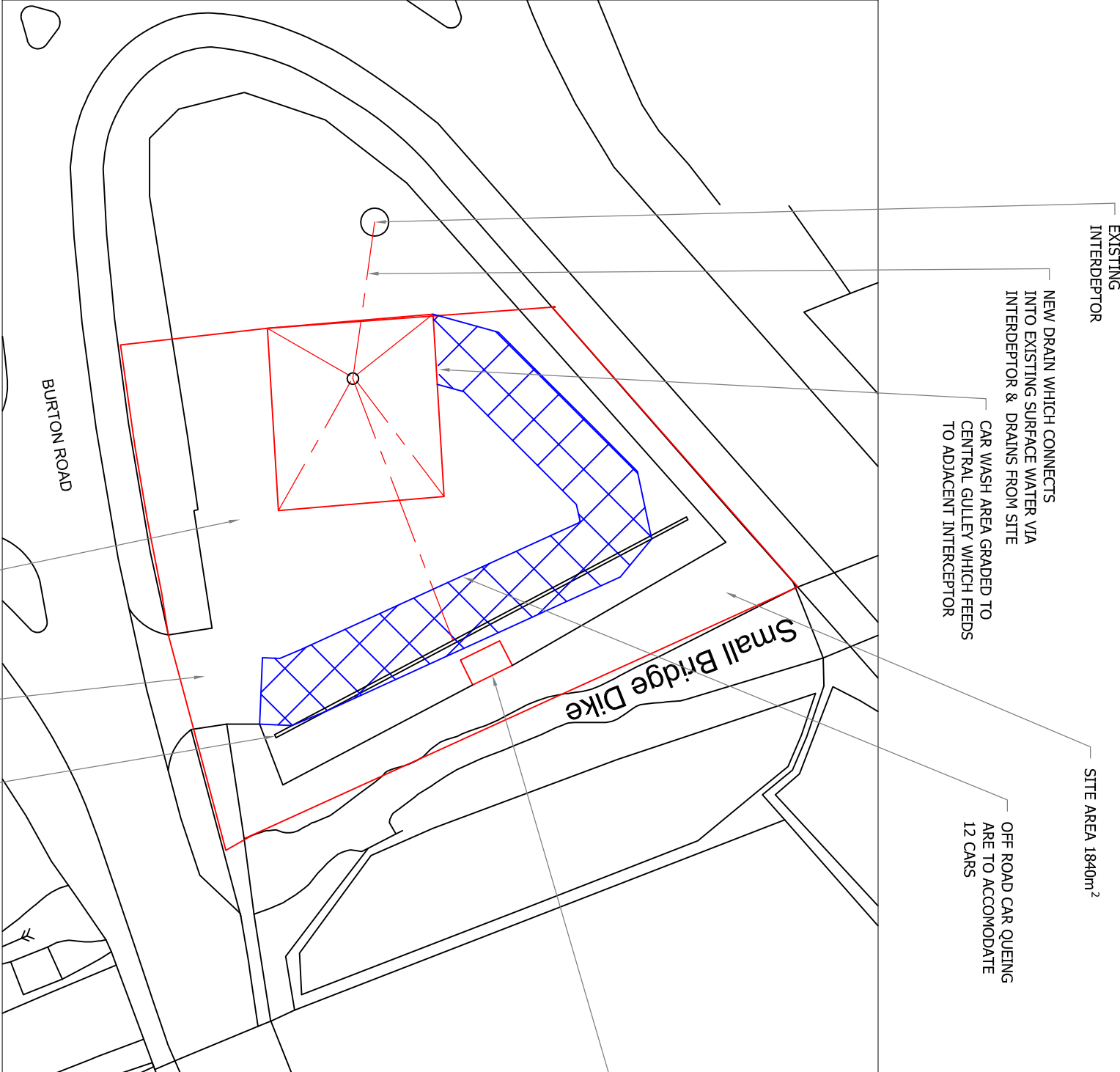

SITE PLAN
SCALE 1:500 AT A3

THE EXISTING SITE IS TO BE MADE LEVEL WITH NEW SURFACE DRAINAGE INSTALLED. A NEW 2m HIGH WALL/FENCE IS TO BE CONSTRUCTED TO THE NORTH EAST OF THE SITE TO PREVENT AIRBORN CONTAMINATION OF THE WATER COURSE. THERE WILL BE GATES OR CHAINS ACCROSS THE ENTRANCES TO RESTRICT ACCESS TO THE SITE WHILST IT IS CLOSED. THERE WILL BE NEW SIGNAGE WITHIN THE CURTLAGE OF THE SITE FOR ADVERTISING PURPOSES.

APPROXIMATE POSITION OF PORTACABIN

Rev	Description	By	Chk	App	Date

JRB DESIGNS LTD
1 Saville Road
Cudworth
Barnsley
S72 8LT
Tel: 01226 383542
Fax: 01226 380078
Mob: 07970 541192
Email: john@jrbdesigns.co.uk
This drawing is copyright. © Jrbdesigns Ltd.

Client
MR V PREKA
23 GRANVILLE STREET
BARNLSLEY

Drawing Title
SITE PLANS

Address
LAND ADJACENT TO PONTERRACT RD.
ROUNDAABOUT BURTON ROAD
CUDWORTH
BARNLSLEY S72

Project Title:
PROPOSED HAND CAR WASH
& VALETING FACILITY

Purpose of Issue:
PLANNING

Drawing Status
FIRST ISSUE

Scale at A3	Drawn By	Date	Checked By	Approved By	Date	Revision
AS SHOWN	JRB	07/10/2010	VP	VP	07/10/2010	-

Project No. **MVP001** Drawing No. **001**

APPROVAL: INFORMATION TENDER CONTRACT CONSTRUCTION