

Junction of Low Cudworth Green & White Cross Road

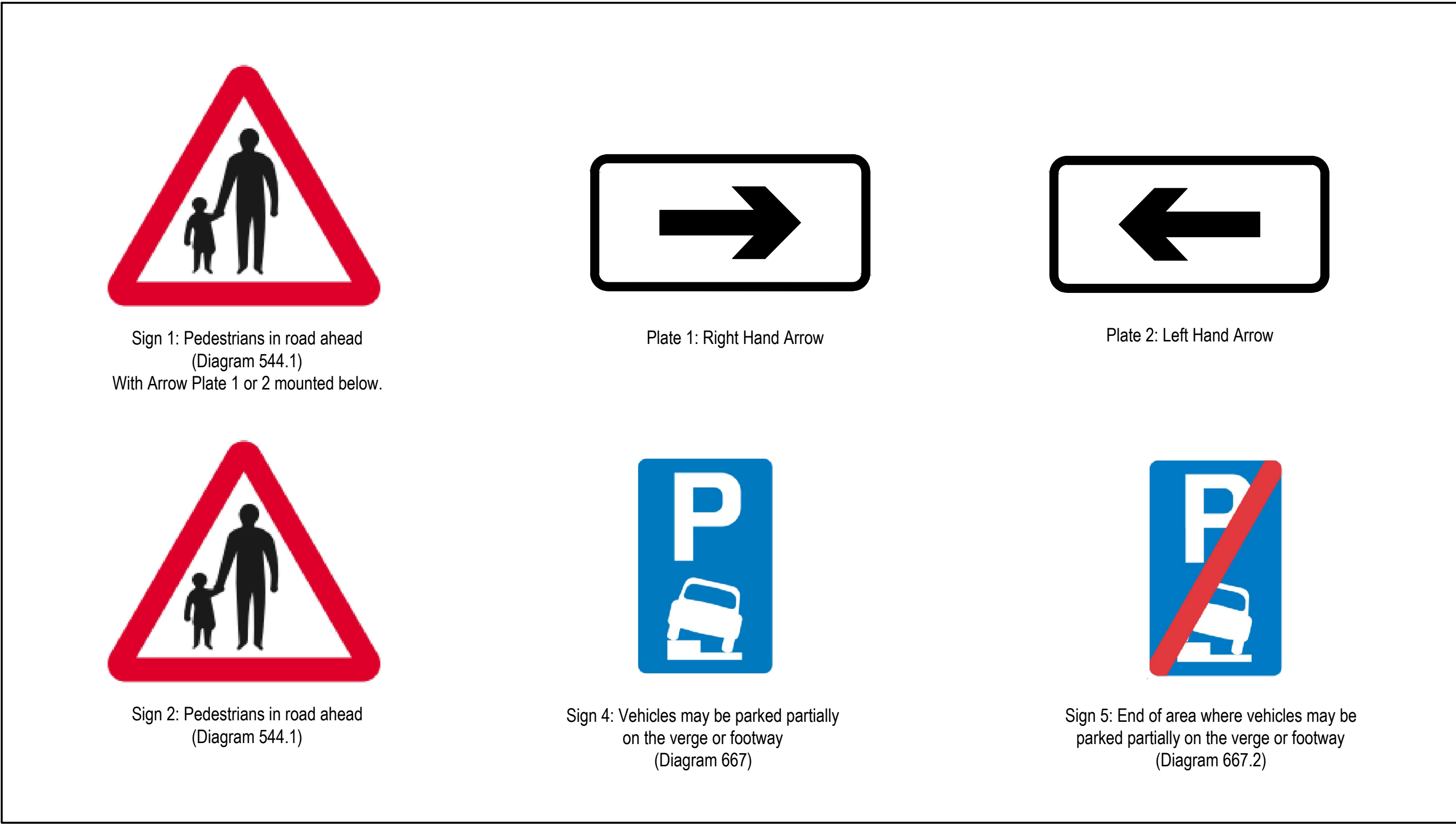

ROAD SIGN KEY

PROPOSED ROAD MARKINGS TO TSRGD 2016						
REFERENCE RM/:	MARKING TYPE	DIAGRAM NUMBER	COLOUR	LENGTH (mm)	WIDTH (mm)	SPACING (mm)
RM/1.1	---	1004	WHITE	4000	100	2000
RM/1.2	---	1003A	WHITE	600	200	300
RM/1.3	---	1009A	WHITE	600	100	300
RM/1.4	---	1023A	WHITE	3750	150	N/A
RM/1.5	---	1012.1	WHITE	N/A	150	N/A
RM/1.6	---	1028.4	WHITE	600 (23000)	50 (2700)	600
RM/1.7	SLOW	1024	WHITE	N/A	1600	N/A

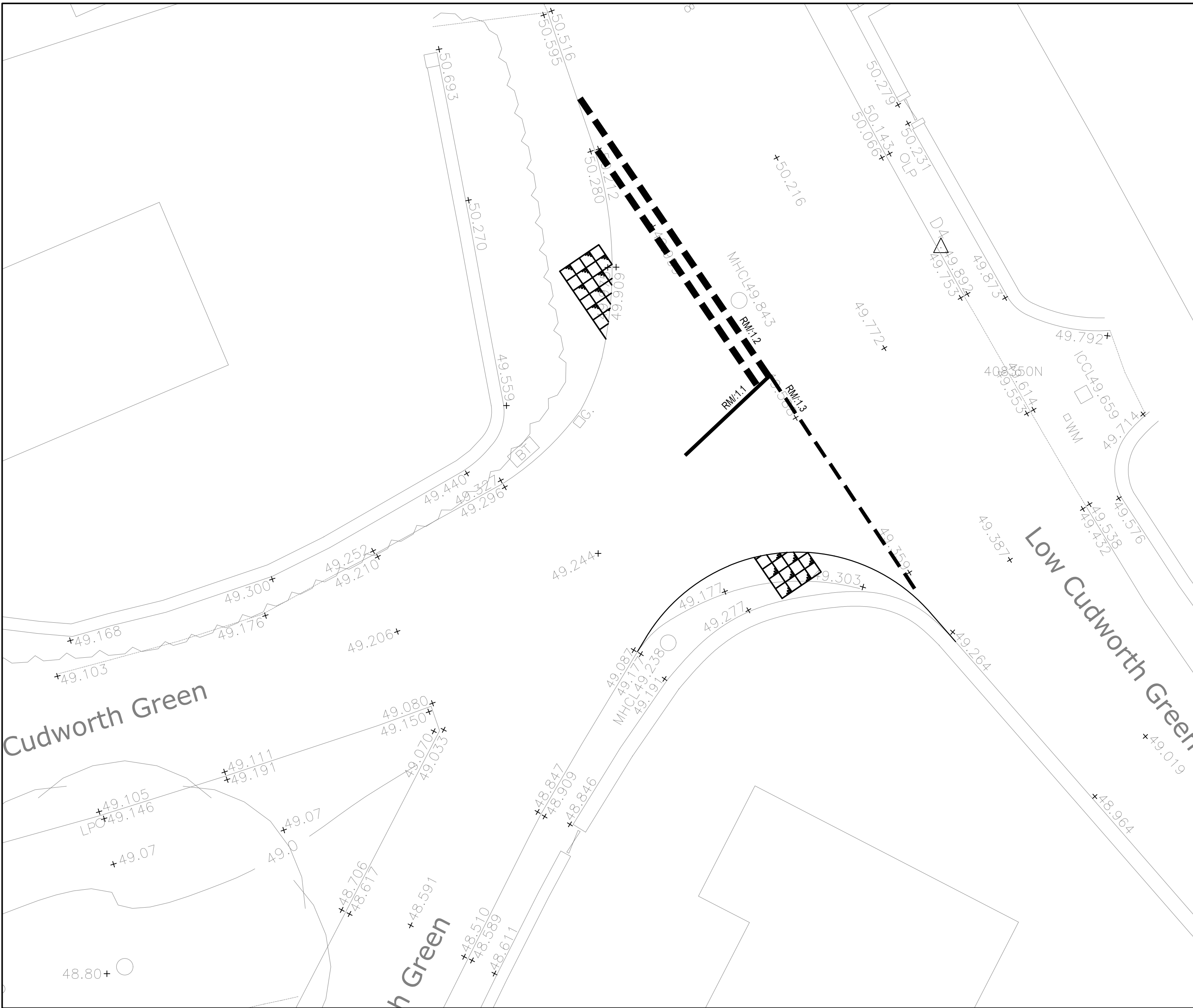

Low Cudworth Green

INFORMATION WITHIN THIS DRAWING IS NOT NECESSARILY PRODUCED TO SCALE. ALWAYS USE FIGURED DIMENSIONS AND CO-ORDINATES - IF IN DOUBT, ASK.

NOTES

- All works shall be carried out in accordance with the Specification for Highway Works unless otherwise instructed by Local Authority Highways Inspecting Officer/Engineer.
- All roadmarkings and signs must comply with Traffic Signs Regulations and General Directions 2016.
- All roadmarkings to be thermoplastic screed.
- All white thermoplastic roadmarkings to have internal and surface hot applied solid glass beads.

F	Reference to Half and Half parking on Lunn Road removed.	GH	CH	28.03.23
E	Updated to suit S278 comments	GH	CH	19.11.20
D	Updated to suit S278 comments rec'd 03.09.20	GH	CH	28.09.20
C	Updated to suit S278 comments rec'd 09.03.20. Markings added to Low Cudworth Green.	GH	CH	31.03.20
B	Updated to suit S278 comments	GH	CH	21.12.18
A	First Issue.			
REV	DESCRIPTION	SIG	CHK	DATE

BARRATT & DAVID WILSON HOMES  
YORKSHIRE WEST

LAND OFF CARRS LANE, CUDWORTH,  
BARNLEY, SOUTH YORKSHIRE

S278 SIGNING AND LINING PLAN  
(SHEET 1 OF 3)

**Eastwood & Partners**  
CONSULTING ENGINEERS  
St. Andrew's House  
23 Kingfield Road  
Sheffield  
S11 9AS  
Tel: 0114 255 4554  
Fax: 0114 255 4330  
mail@eastwoodandpartners.com  
www.eastwoodandpartners.com

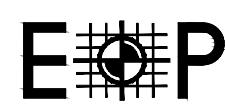

SCALE WHEN PLOTTED AT A0				DRAWING STATUS	
1:100				APPROVAL	
DRAWN	CHECKED	DATE		DRAWING NUMBER	REV
GH	CH	21.08.18		39094/087	F