

ROAD 1 ALIGNMENT - LONGSECTION
SCALE: H 1:200, V 1:20. DATUM: 196.000

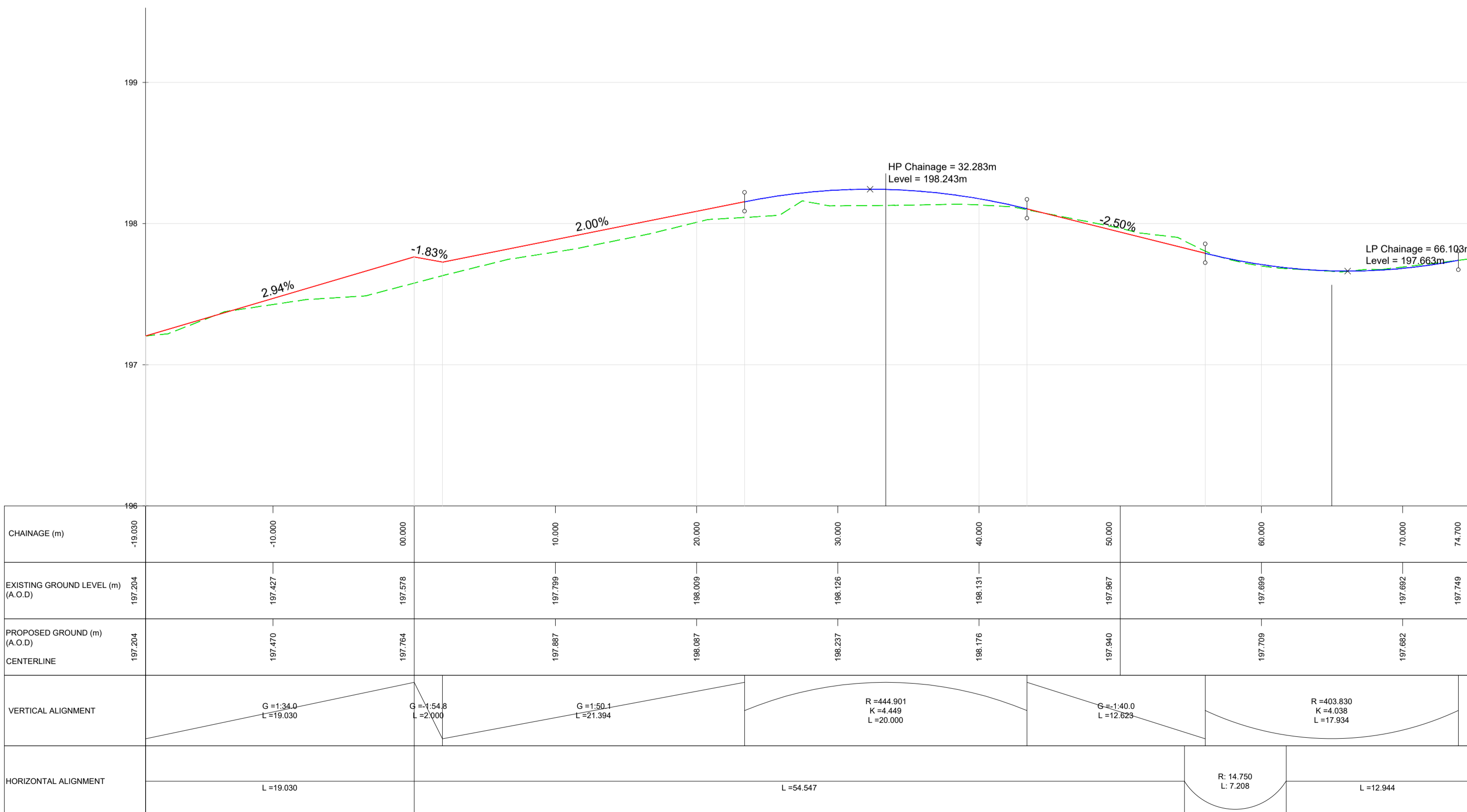

ROAD 2 ALIGNMENT - LONGSECTION
SCALE: H 1:200, V 1:20. DATUM: 196.000

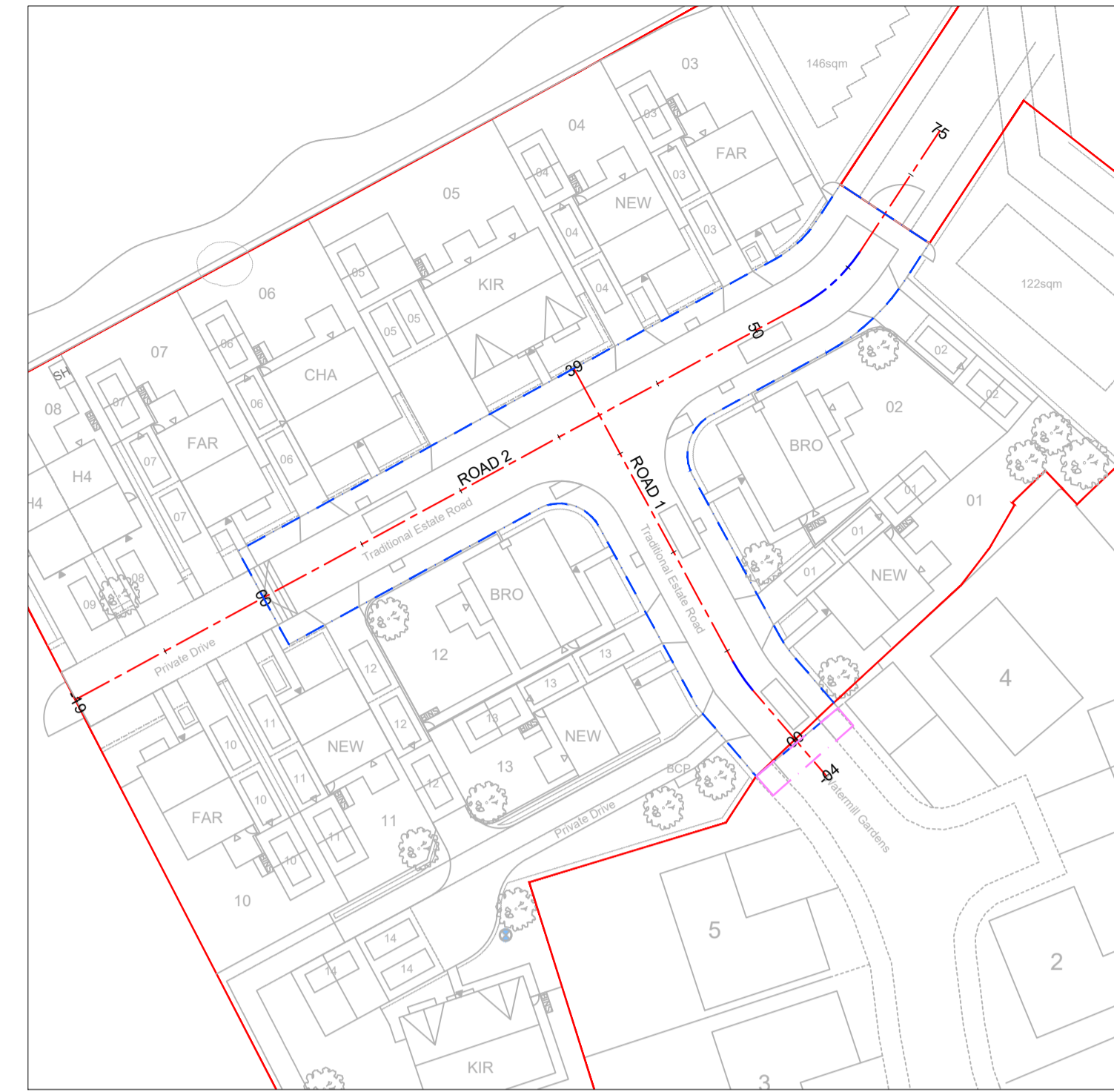

KEY PLAN
1:500

NOTES:

- THESE NOTES ARE INTENDED TO AUGMENT DRAWINGS AND SPECIFICATIONS. WHERE CONFLICT OF REQUIREMENTS EXIST THE ORDER OF PRECEDENCE SHALL BE AS SHOWN IN THE SPECIFICATION. OTHERWISE THE STRICTEST PROVISION SHALL GOVERN.
- THIS DRAWING IS TO BE READ IN CONJUNCTION WITH ALL OTHER RELEVANT ENGINEERS AND ARCHITECTS DRAWINGS.
- DRAWINGS NOT TO BE SCALED. ALL DIMENSIONS TO BE CHECKED ON SITE BY THE CONTRACTOR. ANY DISCREPANCIES TO BE NOTIFIED TO THE ENGINEER AND FURTHER INSTRUCTIONS OBTAINED BEFORE WORK IS COMMENCED.
- ALL LEVELS ARE AOD (ABOVE ORDNANCE DATUM) UNO.

THE INFORMATION ON THIS DRAWING IS FOR APPROVAL PURPOSES ONLY. NO CONSTRUCTION WORKS ARE TO BE UNDERTAKEN UNTIL WRITTEN APPROVAL IS RECEIVED FROM BMBC HIGHWAYS DEPARTMENT.

STREET LIGHTING DESIGN TO BE UNDERTAKEN BY BMBC (DESIGN TBC)

ABBREVIATIONS

BMBC - BARNSELEY METROPOLITAN BOROUGH COUNCIL

HEALTH & SAFETY RISKS



IN ADDITION TO THE STANDARD HAZARDS AND RISKS NORMALLY ASSOCIATED WITH THE TYPE OF WORK DETAILED ON THIS DRAWING, PLEASE NOTE THE FOLLOWING RESIDUAL HEALTH AND SAFETY RISKS

CONSTRUCTION RISKS

- CR 01 EXCAVATIONS - ALL EXCAVATIONS TO BE ADEQUATELY FENCED OFF AND SUPPORTED DURING CONSTRUCTION. CONTRACTOR TO DETERMINE SAFE CONSTRUCTION SEQUENCE AND METHODS.
- CR 02 DANGER FROM EXISTING UNDERGROUND SERVICES - OBTAIN SERVICES RECORDS. USE DUE CARE AND ATTENTION WHEN EXCAVATING. USE OF C.A.T. SCAN MAY BE REQUIRED PRIOR TO EXCAVATIONS.

IT IS ASSUMED THAT ALL WORKS WILL BE CARRIED OUT BY A COMPETENT CONTRACTOR WORKING IN ACCORDANCE WITH THE REQUIREMENTS DEFINED IN THE CDM REGULATIONS.

P1	FIRST ISSUE	20.03.26	MJC	SC	BH
Rev	Description	Date	By	Crk	App

Alan Wood & Partners
www.alanwood.co.uk

Locations:
Hull
Leeds
Lincoln
Scarborough
Sheffield
Stockton-on-Tees
York

Issuing Office:
Hull Office
341 Beverley Road
Hull
HU5 1LD

eng@alanwood.co.uk
T. 01482 442138

Project:	PROPOSED DEVELOPMENT AT LAND OFF WAREMILL GARDENS, PENISTONE				
Client:	MULGRAVE PROPERTY GROUP LTD				
Drawing:	SECTION 38 PROPOSED LONGSECTIONS				
Role:	CIVIL ENGINEER				
Drawing Status:	FOR REVIEW				Subtable Code: S3
Job no.:	47480	Scale@ A1:	AS NOTED	Rev.	P1
Project	Originator	Zone	Level	Type	Role
MDL - AWP - ZZ - XX - DR - C - 4150					

JOB NO: 47480 - SECTION 38 - DRAWING REFERENCE TABLE	
This Drawing to be Read in Conjunction with the Drawings Listed Below	
Drawing Reference	Drawing Reference
Alan Wood & Partners	MDL - AWP - ZZ - XX - DR - C - 4100
S38 Site Location Plan	MDL - AWP - ZZ - XX - DR - C - 4101
S38 General Arrangement	MDL - AWP - ZZ - XX - DR - C - 4105
S38 Surface Water Gully Impermeable Area Plan	MDL - AWP - ZZ - XX - DR - C - 4110
S38 Legal Plan	MDL - AWP - ZZ - XX - DR - C - 4120
S38 Surfacing Plans	MDL - AWP - ZZ - XX - DR - C - 4130
S38 Kerbing Plans	MDL - AWP - ZZ - XX - DR - C - 4140
S38 Proposed Levels	MDL - AWP - ZZ - XX - DR - C - 4150
S38 Proposed Longsections	MDL - AWP - ZZ - XX - DR - C - 4155
S38 Highway Construction Details	MDL - AWP - ZZ - XX - DR - C - 4180 to 4181
S38 Vehicle Tracking and Visibility Splays	
Drawings by others	Date Received
Site Layout	21.01.2026 (Rev D)
Topographic Survey	25.10.2024 (06_220693_01)