

Side Elevation

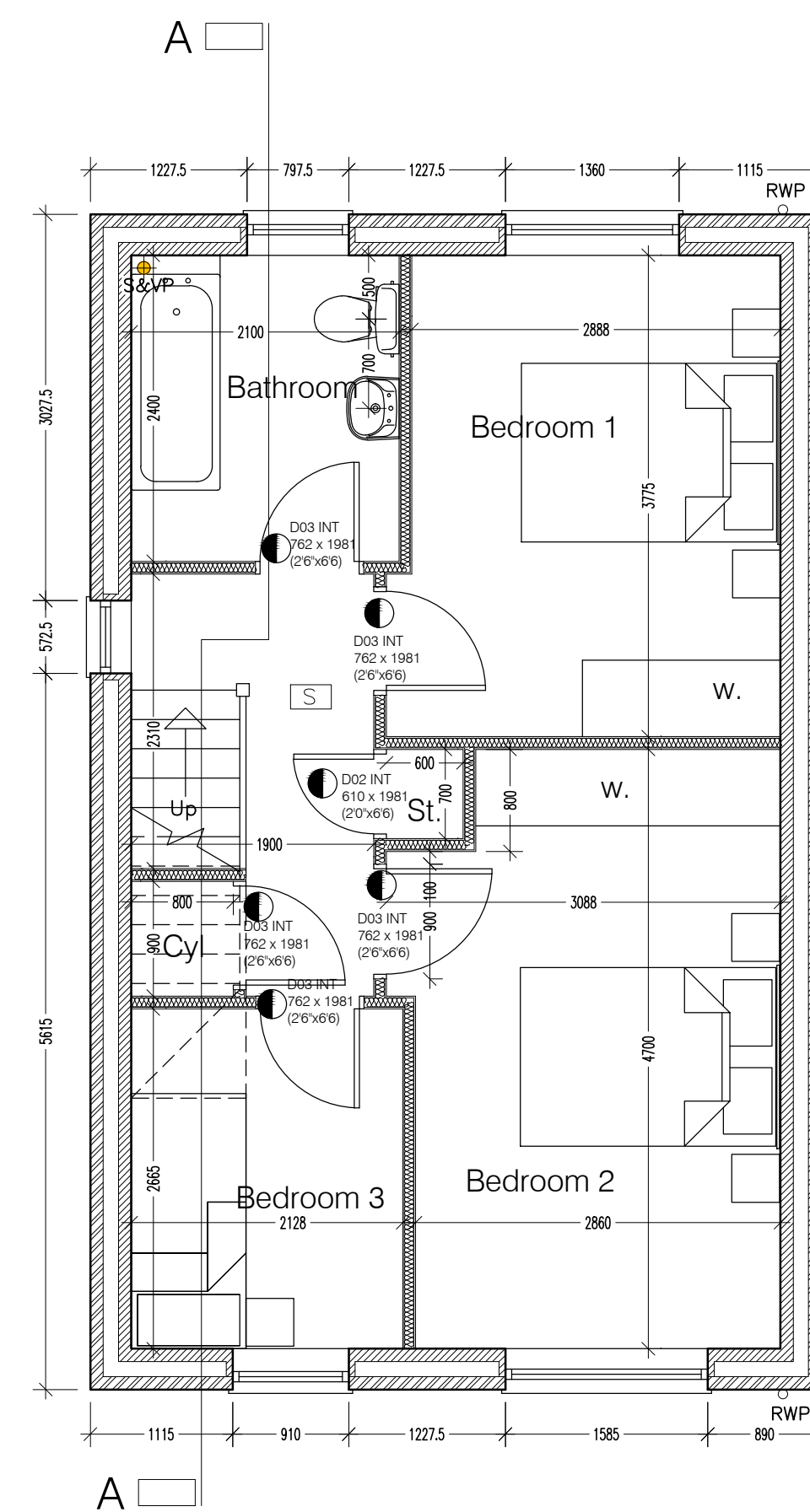

Architectural floor plan of a two-unit residential building, labeled "Aspen" and "Aspen Handed". The plan shows two symmetrical units separated by a central corridor. Each unit includes a Lounge, Dining area, Kitchen, Hall, and W.C. (Water Closet). Key dimensions are provided for overall and internal spaces. Structural details like "241mm deep T.J.I joists at 600mm c/c" and "Beam and block span" are indicated. The plan also shows external features like stairs (St.), a ramp (RWP), and various doors and windows.

Type Aspen - 3 Bedroom 2 storey

Rev D 21st Jul '23 Wall Cavity updated to 120mm cavity
Rev C 11th Oct '22 Brick soilder band removed on side elevations
Rev B 22nd Jun '22 SVP positions amended and Gully removed
Rev A 1st Dec '21 Bathroom amended.

Project: **Saul Homes**
Standard House Types

Title:	House Type 'Aspen' Ground and First Floor Plan Elevations and Section A-A
--------	---

Scales:		Drawn:		Date:		Checked:	
1:50:100@A1		PJ		05 / 17			
Drawing no:				Rev:			
SH / ST / 06				D			



Burntwood Office Park
Common Road
Brierley
Barnsley
S72 9ET

T: 01226 707090
F: 01226 707091
info@saulhomes.co.uk
www.saulhomes.co.uk



SAUL
HOMES