

Notes_

PLANNING

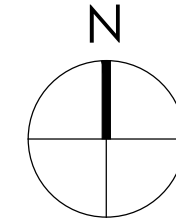

Note:
 Surrounding contextual buildings and information are based on received ordinance survey drawings and are shown for illustrative purposes only. assumed site boundary is subject to legal confirmation

Note:
 Information is based on OS map and received information and is subject to full topographical survey.
 Assumed site boundary and site constraints subject to legal confirmation.
 All Legal easements and extent of existing underground services locations are subject to confirmation.

Rev_ Date_ Amendments_ By_ Apr'd

Eight_OneTwo
 Architects

Tel_ +44 [0]7761 570735
 Email_ mail@eightonetwo.co.uk
 www.eightonetwo.co.uk
 Studio A5_Brooke's Mill_Armitage Bridge_Huddersfield_HD4 7NR

Drawing Status_
 PLANNING

Client_
 MR + MRS HOPWOOD

Project_
 FLASH HOUSE FARM_ CAWTHORNE_ BARNESLEY

Drawing Title_
 EXISTING SITE + LOCATION PLAN

Drawing Scale_ 1:1250, 1:500
 Drawn By_ JaL
 Checked By_ JaL

Paper Size_ A3
 Drawn Date_ 01/06/2020
 Checked Date_ 17/07/2020

Drawing Number_
 20 808 102



SITE PLAN AS EXISTING

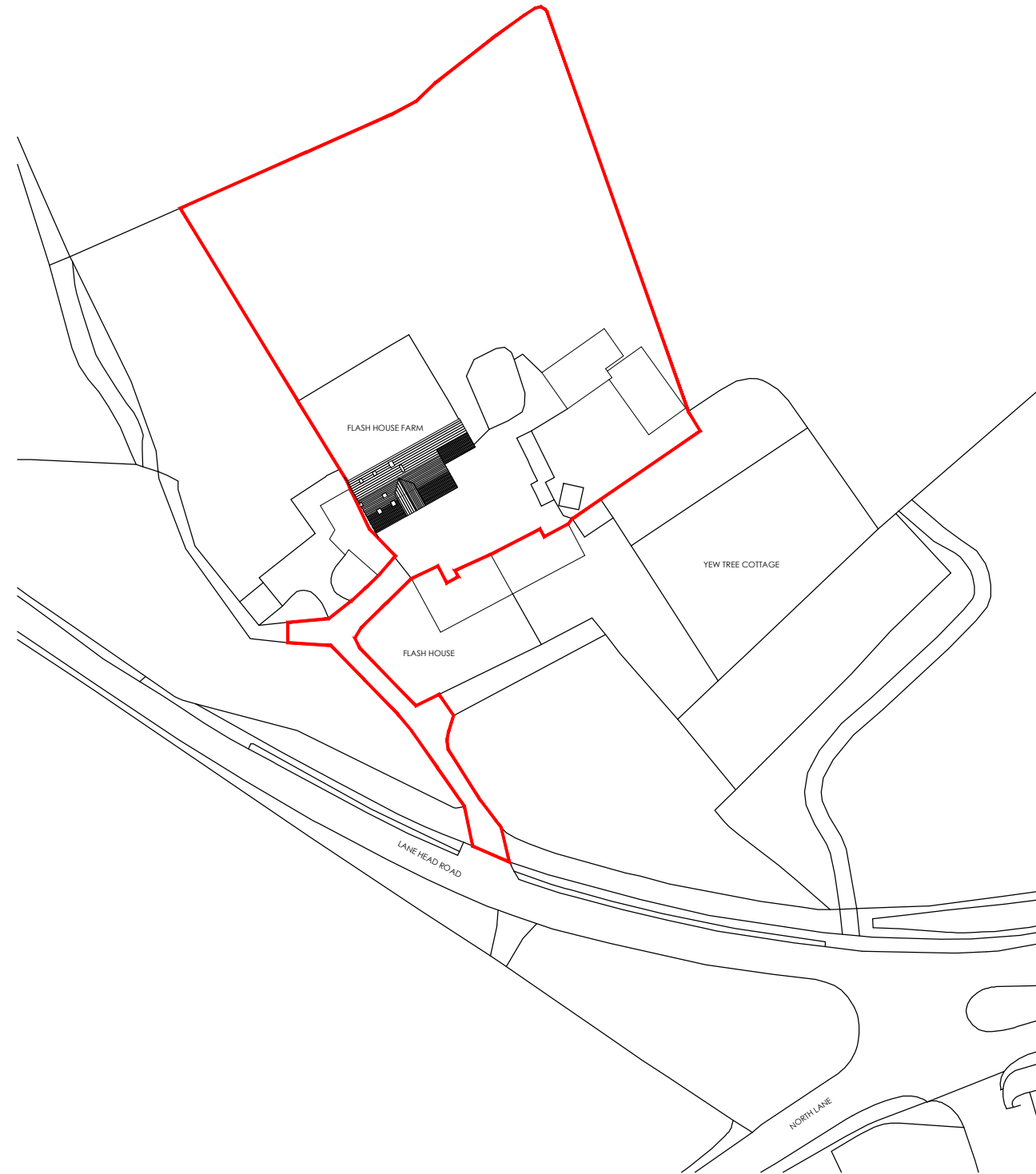
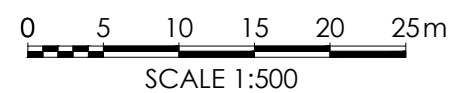

LOCATION PLAN AS EXISTING

