

Utility apparatus

Underground utility apparatus
 Mechanical handling for the installation of underground apparatus and drainage sewers any roots present and can change the local hydrology in a way that adversely affects the health of the tree. For this reason, particular care should be taken in the root and methods of installation, of all underground apparatus. Wherever possible, apparatus should be routed outside of RPA's. Where this is not possible, it is preferable to keep apparatus together in common ducts, all inspection chambers should be sited outside of the RPA's.

Where underground apparatus is to cross within the RPA's, detailed plans showing the proposed route should be drawn up in conjunction with the project arboriculturist, in such cases trenchless insertion methods should be used with entry and retrieval pits being located outside of the RPA's. If this option is not feasible and providing roots can be retained and protected excavations should be undertaken using hand held tools (oil-gauge, force, shovel) or a combination of trenchless and manual excavation (broken branch).

Any design and installation should be undertaken in accordance with the National Joint Utilities Guidelines (NJUG).

Above-ground utility apparatus
 Above-ground apparatus including CCTV cameras and lighting should be sited to avoid the need for detrimental tree pruning, as such the current and future crown size of the tree should be assessed. Tree branches can be pruned back with care to provide space, though it is not appropriate for repetitive and significant tree work to be an initial design solution unless this is a suitable management outcome for the tree. Any pruning should be undertaken in accordance with BS3998:2010

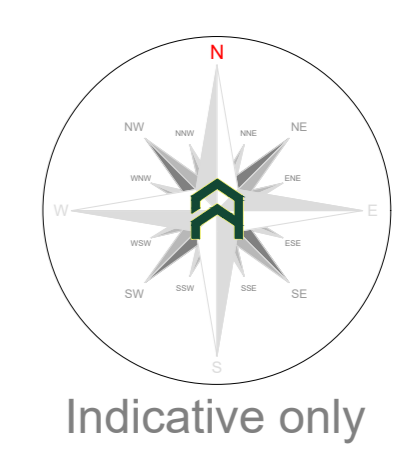
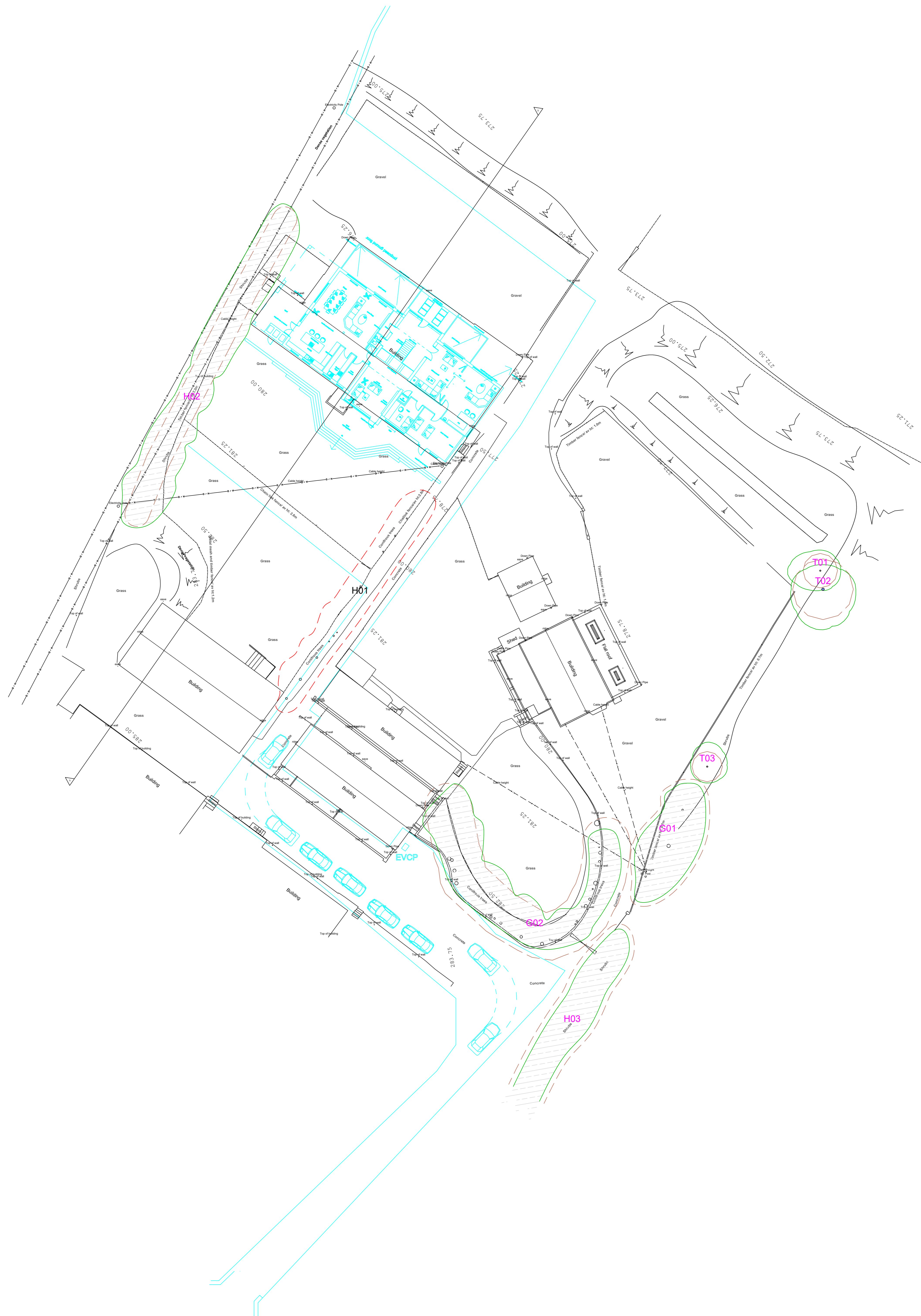

Arboricultural Impacts

Impacts	No. of trees
Trees to be removed	0
Grass/hedges to be removed (Partial removal of groups)	1 (S)
Trees with proposed measures into RPA's	0
Grass/Hedges with proposed measures into RPA's	0
Trees that will require pruning	0
Grass/hedges that will require pruning	0
Trees to be transplanted	0
Grass/hedges to be transplanted	0

Tree Work Schedule

No.	Species	Works	Category
H01	Leyland Cypress	Full trees and remove stumps	C2

All tree work is to be undertaken in accordance with British Standard BS 3968:2010 Tree work - Recommendations.
 All work is to be undertaken in accordance with the site plan to be left as found. Care is to be taken of the ground around retained trees to make sure that it does not become compacted as a result of tree surgery operations. No equipment or vehicles such as tractor loaders, tractors, excavators or cranes shall be parked or driven beneath the crowns of any retained trees, to prevent subsequent compaction and root death.

No. of individual trees to be removed

U	A	B	C
0	0	0	0

No. of groups / hedges to be removed

U	A	B	C
0 (S)	0 (S)	0 (S)	1 (S)

Arboricultural Method Statement

All tree work is to be undertaken in accordance with British Standard BS 3968:2010 Tree work - Recommendations.
 Please refer to Arboricultural Method Statement and Tree Protection Plan, for full details of all proposed trees and how all aspects of the development may be implemented without detriment to retained trees.



Project: **Stanccliffe House Farm, Woodhead Road, Wortley, Sheffield, S35 7DA**

Client: **Khella Property Services**

Drawing: **Arboricultural Impact Assessment**

Based on: **Proposed Site Plan**

Drawing No: **Arbtech AIA 01** Rev:

Date: **Feb 2024** Scale: **1:200 @ A0** Drawn: **AJN**

Key:

Tree Nos.	T01	Tree Categories	Category 'A' trees	Category 'B' trees	Category 'C' trees	Existing site	Proposed site
RPA's		Category 'A' trees	Category 'B' trees	Category 'C' trees	Existing site	Proposed site	
Category 'A' trees		Category 'B' trees	Category 'C' trees	Existing site	Proposed site		
Proposed site		Trees to be removed					

