

Refer to TPM drawing 201

Code	Plant Name	Height/Spread/Grade	Girth	Age	Root	Container	Height	Form	Density/lt
44	Alnus glutinosa	30-40cm	200-300mm	20	C	SA	1500mm	Multi-stemmed	400
45	Alnus glutinosa	30-40cm	200-300mm	10-15cm	20	SA	1500mm	Multi-stemmed	400
46	Alnus glutinosa	30-40cm	200-300mm	10-15cm	20	SA	1500mm	Multi-stemmed	400
47	Alnus glutinosa	30-40cm	200-300mm	10-15cm	20	SA	1500mm	Multi-stemmed	400
48	Alnus glutinosa	30-40cm	200-300mm	10-15cm	20	SA	1500mm	Multi-stemmed	400
49	Alnus glutinosa	30-40cm	200-300mm	10-15cm	20	SA	1500mm	Multi-stemmed	400
50	Alnus glutinosa	30-40cm	200-300mm	10-15cm	20	SA	1500mm	Multi-stemmed	400
51	Alnus glutinosa	30-40cm	200-300mm	10-15cm	20	SA	1500mm	Multi-stemmed	400
52	Alnus glutinosa	30-40cm	200-300mm	10-15cm	20	SA	1500mm	Multi-stemmed	400
53	Alnus glutinosa	30-40cm	200-300mm	10-15cm	20	SA	1500mm	Multi-stemmed	400
54	Alnus glutinosa	30-40cm	200-300mm	10-15cm	20	SA	1500mm	Multi-stemmed	400
55	Alnus glutinosa	30-40cm	200-300mm	10-15cm	20	SA	1500mm	Multi-stemmed	400
56	Alnus glutinosa	30-40cm	200-300mm	10-15cm	20	SA	1500mm	Multi-stemmed	400
57	Alnus glutinosa	30-40cm	200-300mm	10-15cm	20	SA	1500mm	Multi-stemmed	400
58	Alnus glutinosa	30-40cm	200-300mm	10-15cm	20	SA	1500mm	Multi-stemmed	400
59	Alnus glutinosa	30-40cm	200-300mm	10-15cm	20	SA	1500mm	Multi-stemmed	400
60	Alnus glutinosa	30-40cm	200-300mm	10-15cm	20	SA	1500mm	Multi-stemmed	400
61	Alnus glutinosa	30-40cm	200-300mm	10-15cm	20	SA	1500mm	Multi-stemmed	400
62	Alnus glutinosa	30-40cm	200-300mm	10-15cm	20	SA	1500mm	Multi-stemmed	400
63	Alnus glutinosa	30-40cm	200-300mm	10-15cm	20	SA	1500mm	Multi-stemmed	400
64	Alnus glutinosa	30-40cm	200-300mm	10-15cm	20	SA	1500mm	Multi-stemmed	400
65	Alnus glutinosa	30-40cm	200-300mm	10-15cm	20	SA	1500mm	Multi-stemmed	400
66	Alnus glutinosa	30-40cm	200-300mm	10-15cm	20	SA	1500mm	Multi-stemmed	400
67	Alnus glutinosa	30-40cm	200-300mm	10-15cm	20	SA	1500mm	Multi-stemmed	400
68	Alnus glutinosa	30-40cm	200-300mm	10-15cm	20	SA	1500mm	Multi-stemmed	400
69	Alnus glutinosa	30-40cm	200-300mm	10-15cm	20	SA	1500mm	Multi-stemmed	400
70	Alnus glutinosa	30-40cm	200-300mm	10-15cm	20	SA	1500mm	Multi-stemmed	400
71	Alnus glutinosa	30-40cm	200-300mm	10-15cm	20	SA	1500mm	Multi-stemmed	400
72	Alnus glutinosa	30-40cm	200-300mm	10-15cm	20	SA	1500mm	Multi-stemmed	400
73	Alnus glutinosa	30-40cm	200-300mm	10-15cm	20	SA	1500mm	Multi-stemmed	400
74	Alnus glutinosa	30-40cm	200-300mm	10-15cm	20	SA	1500mm	Multi-stemmed	400
75	Alnus glutinosa	30-40cm	200-300mm	10-15cm	20	SA	1500mm	Multi-stemmed	400
76	Alnus glutinosa	30-40cm	200-300mm	10-15cm	20	SA	1500mm	Multi-stemmed	400
77	Alnus glutinosa	30-40cm	200-300mm	10-15cm	20	SA	1500mm	Multi-stemmed	400
78	Alnus glutinosa	30-40cm	200-300mm	10-15cm	20	SA	1500mm	Multi-stemmed	400
79	Alnus glutinosa	30-40cm	200-300mm	10-15cm	20	SA	1500mm	Multi-stemmed	400
80	Alnus glutinosa	30-40cm	200-300mm	10-15cm	20	SA	1500mm	Multi-stemmed	400
81	Alnus glutinosa	30-40cm	200-300mm	10-15cm	20	SA	1500mm	Multi-stemmed	400
82	Alnus glutinosa	30-40cm	200-300mm	10-15cm	20	SA	1500mm	Multi-stemmed	400
83	Alnus glutinosa	30-40cm	200-300mm	10-15cm	20	SA	1500mm	Multi-stemmed	400
84	Alnus glutinosa	30-40cm	200-300mm	10-15cm	20	SA	1500mm	Multi-stemmed	400
85	Alnus glutinosa	30-40cm	200-300mm	10-15cm	20	SA	1500mm	Multi-stemmed	400

GENERAL NOTES

- This drawing is the copyright of TPM Landscape Ltd and cannot be reproduced in any form without the consent of the company.
- This drawing is to be read in conjunction with detail landscape drawings, details and specification.
- This drawing is to be read in conjunction with all relevant Architects', Engineer's, Specialist's, Bills of Quantities and Specifications.
- The insertion of any firm or proprietary brand on this drawing is an indication of the class or quality required and does not exclude the use of alternative materials that are equal in performance, quality and appearance, provided that they have been approved in writing by the Landscape Architect.
- The Contractor is responsible for accurately ascertaining the position of underground services and responding to all relevant service easement requirements.
- All dimensions are in millimetres unless stated otherwise, for the purposes of construction this drawing must not be scaled and only written dimensions used. Written and scaled dimensions to be checked on site, any discrepancies reported prior to work commencing. IF IN DOUBT PLEASE ASK.
- All work and materials are to be in accordance with the relevant British Standards and Code of Practice.
- All Proprietary products are to be used strictly in accordance with the manufacturer's instructions and details.

Code	Plant Name	Height/Spread/Grade	Girth	Age	Root	Container	Height	Form	Density/lt
48	Alnus glutinosa	30-40cm	200-300mm	20	C	SA	1500mm	Multi-stemmed	400
49	Alnus glutinosa	30-40cm	200-300mm	10-15cm	20	SA	1500mm	Multi-stemmed	400
50	Alnus glutinosa	30-40cm	200-300mm	10-15cm	20	SA	1500mm	Multi-stemmed	400
51	Alnus glutinosa	30-40cm	200-300mm	10-15cm	20	SA	1500mm	Multi-stemmed	400
52	Alnus glutinosa	30-40cm	200-300mm	10-15cm	20	SA	1500mm	Multi-stemmed	400
53	Alnus glutinosa	30-40cm	200-300mm	10-15cm	20	SA	1500mm	Multi-stemmed	400
54	Alnus glutinosa	30-40cm	200-300mm	10-15cm	20	SA	1500mm	Multi-stemmed	400
55	Alnus glutinosa	30-40cm	200-300mm	10-15cm	20	SA	1500mm	Multi-stemmed	400
56	Alnus glutinosa	30-40cm	200-300mm	10-15cm	20	SA	1500mm	Multi-stemmed	400
57	Alnus glutinosa	30-40cm	200-300mm	10-15cm	20	SA	1500mm	Multi-stemmed	400
58	Alnus glutinosa	30-40cm	200-300mm	10-15cm	20	SA	1500mm	Multi-stemmed	400
59	Alnus glutinosa	30-40cm	200-300mm	10-15cm	20	SA	1500mm	Multi-stemmed	400
60	Alnus glutinosa	30-40cm	200-300mm	10-15cm	20	SA	1500mm	Multi-stemmed	400
61	Alnus glutinosa	30-40cm	200-300mm	10-15cm	20	SA	1500mm	Multi-stemmed	400
62	Alnus glutinosa	30-40cm	200-300mm	10-15cm	20	SA	1500mm	Multi-stemmed	400
63	Alnus glutinosa	30-40cm	200-300mm	10-15cm	20	SA	1500mm	Multi-stemmed	400
64	Alnus glutinosa	30-40cm	200-300mm	10-15cm	20	SA	1500mm	Multi-stemmed	400
65	Alnus glutinosa	30-40cm	200-300mm	10-15cm	20	SA	1500mm	Multi-stemmed	400
66	Alnus glutinosa	30-40cm	200-300mm	10-15cm	20	SA	1500mm	Multi-stemmed	400
67	Alnus glutinosa	30-40cm	200-300mm	10-15cm	20	SA	1500mm	Multi-stemmed	400
68	Alnus glutinosa	30-40cm	200-300mm	10-15cm	20	SA	1500mm	Multi-stemmed	400
69	Alnus glutinosa	30-40cm	200-300mm	10-15cm	20	SA	1500mm	Multi-stemmed	400
70	Alnus glutinosa	30-40cm	200-300mm	10-15cm	20	SA	1500mm	Multi-stemmed	400
71	Alnus glutinosa	30-40cm	200-300mm	10-15cm	20	SA	1500mm	Multi-stemmed	400
72	Alnus glutinosa	30-40cm	200-300mm	10-15cm	20	SA	1500mm	Multi-stemmed	400
73	Alnus glutinosa	30-40cm	200-300mm	10-15cm	20	SA	1500mm	Multi-stemmed	400
74	Alnus glutinosa	30-40cm	200-300mm	10-15cm	20	SA	1500mm	Multi-stemmed	400
75	Alnus glutinosa	30-40cm	200-300mm	10-15cm	20	SA	1500mm	Multi-stemmed	400
76	Alnus glutinosa	30-40cm	200-300mm	10-15cm	20	SA	1500mm	Multi-stemmed	400
77	Alnus glutinosa	30-40cm	200-300mm	10-15cm	20	SA	1500mm	Multi-stemmed	400
78	Alnus glutinosa	30-40cm	200-300mm	10-15cm	20	SA	1500mm	Multi-stemmed	400
79	Alnus glutinosa	30-40cm	200-300mm	10-15cm	20	SA	1500mm	Multi-stemmed	400
80	Alnus glutinosa	30-40cm	200-300mm	10-15cm	20	SA	1500mm	Multi-stemmed	400
81	Alnus glutinosa	30-40cm	200-300mm	10-15cm	20	SA	1500mm	Multi-stemmed	400
82	Alnus glutinosa	30-40cm	200-300mm	10-15cm	20	SA	1500mm	Multi-stemmed	400
83	Alnus glutinosa	30-40cm	200-300mm	10-15cm	20	SA	1500mm	Multi-stemmed	400
84	Alnus glutinosa	30-40cm	200-300mm	10-15cm	20	SA	1500mm	Multi-stemmed	400
85	Alnus glutinosa	30-40cm	200-300mm	10-15cm	20	SA	1500mm	Multi-stemmed	400

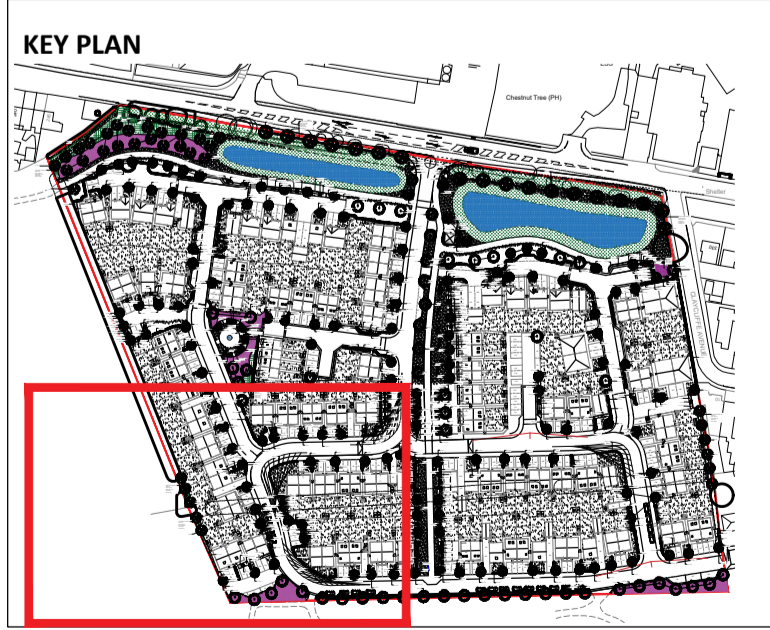

NOTES ON PLANTING

- Topsoil / Subsoil:** Topsoil shall be spread to min 450mm depth over planting beds and 150mm depth over turf areas and graded to fall. Topsoil should be in accordance with BS3882:2015 and where subsoil is required, to be in line with BS8601:2013. It is recommended that samples are tested with Certification and Analysis Reports with a concise analysis. To be provided to the landscape Architect / Client for approval. If the soil doesn't meet the BS standard specialist advice should be received to see if the soil can be improved.
- Herbicide and Cultivation:** Topsoil to be treated with an application of herbicide prior to planting, where necessary, strictly in accordance with the Control of Pesticides Regulations 1986 (or otherwise updated / superceded legislation), and following manufacturers instructions and undertaken by qualified staff. The topsoil shall then be cultivated to 150mm depth)
- Container Grown Shrubs, Transplants and Whips:** Shrubs and transplants shall comply with the National Plant Specification. Shrubs shall be planted in pits 300 x 300 x 200mm depth, and the backfill shall include 3 litres Peat Free and Shrub Compost. Specimen plants to be planted in a pit 400 x 400 x 250mm deep with 5 litres Tree and Shrub Compost. BR whips should be notch planted as required and healed into position. All whips to be protected by a spiral bound shrub guard secured into place with a timber cane. When in public locations it may be necessary to have caps to the canes. Native Hedgerow planting to be planted in a double staggered row at 400mm centres.
- Herbicide:** Spot treat with herbicide throughout the maintenance period in accordance with the manufacturer's instructions.

- Bark Mulch:** All Ornamental Planting beds to receive 75mm depth pulverised ornamental bark mulch.
- Position of Plants:** Final position of trees and shrubs subject to confirmation of service location and approval of statutory undertakers.
- On excavation of the tree pit a bucket test should be undertaken to verify the water infiltration.** Certain species of trees will decline if the ground drainage is poor. Monitor the water egress. If water sits for long periods or doesn't drain the pit may require further works to break up the ground. A clean stone drainage layer may assist to ensure that the root ball isn't sat within standing water.
- TREES - STANDARDS** Tree pits for heavy standards and standards to be 600x600x600mm backfilled with sub soil and 300mm topsoil. Stakes to be 65mm diameter treated softwood driven firmly into the ground. Stakes to be 600mm above ground level and fixed to tree with suitable rubber tree tie.
- TREES - HEAVY STANDARDS** Tree pits for heavy standards to be 800x800x800mm backfilled with sub soil and 300mm topsoil. Stakes to be 65mm diameter treated softwood driven firmly into the ground. Stakes to be 600mm above ground level and fixed to tree with suitable rubber tree tie.

- Watering:** Plant only into moist soil and water thoroughly to the full depth of soil immediately after planting. Water regularly through the establishment period (minimum 3 months) to prevent dehydration. The trees should be watered through the irrigation pipe to ensure that the water gets down to the rootball. These trees should be watered regularly throughout spring-summer during the first 2 years to ensure that the tree root system establishes well.
- Grass Seeding:** Sow late summer to mid autumn. Prepare ground by removing any existing vegetation, large stones and roughly levelling. An application of non-residual systemic glyphosate containing weedkiller may be required. Grass seed should be spread at 50g per metre squared After sowing, lightly rake over area and water.
- Turf:** Complete ground preparations before turf is delivered to site to avoid turf drying out. Turf should be laid immediately on delivery. Remove all existing vegetation from area to be turfed and spread 150mm depth of top soil. Dig over or rotavate soil before laying turf if soil is compacted. Rake, lightly compact, and water soil. Stagger the joints when laying the turf. Water turf after laying and every day for the next 2-3 days, especially in periods of low rainfall.
- Wildflower Meadow:** Timing - Sow meadow during March and April or in September. When sowing into heavy soils, sow in March/April to avoid seeds/seedlings rotting in waterlogged soils. Ground Preparation - Control or remove weeds before sowing. For small areas, remove weeds by hand. For larger areas, a weed suppressing membrane or black plastic can be laid over the area 3 months prior to sowing to prevent weed growth. For larger areas and where vigorous perennial weeds, such as nettles, docks and dandelions, are present in large number, non-chemical control methods may not be effective. In these situations instead spray off

- existing vegetation using non-residual systemic glyphosate-containing weedkillers. Spray applications may be required more than once dependent on the site and time of year. Eradication of weeds is essential to the success of the establishment of the wildflower meadow.
  - Rotavate soil and rake to make even seed bed
- Sowing -**
  - Wildflower meadow to be sown at 1.5/4 g per m<sup>2</sup>.
  - Mix wildflower seed with silver sand to aid even seed distribution and to show area that have been covered. Sow half lengthways and half widthways for even coverage.
  - Rake in seeds lightly
  - Do not sow seed if heavy rain is forecast
- Soil compaction** is likely to have occurred during construction on site. A site inspection should be carried out by a landscape professional to assess the level of soil compaction, including drainage testing to see if the ground is likely to become waterlogged. If the ground is deemed to be too compacted for plant growth and to drain adequately then remediation works should be carried out. This could include rotavation of the soil using a push along rotavator and/or ground being broken up with spades or small machinery. A second site inspection should then take place to ensure that the soil is fit for purpose.
- Tree species selected subject to soil conditions and NHBC guidance.** Root barriers may be required subject to findings from soil analysis and engineer's details.

Refer to TPM drawing 203

**REVISION NOTES**

Rev	By	Description	Date
D	EO	Updated in line with latest landscape layout	27.08.25
C	RN	Updated in line with latest landscape layout	31.01.25
B	EO	Updated in line with latest landscape layout	14.01.25
A	EO	Updated in line with latest landscape layout	07.01.25

**SOFT LANDSCAPE**

- Trees and Hedgerows to be Retained**
- Trees and Hedgerows to be Removed**
- Proposed POS Native Tree**  
Trees to be planted as 18-20cm girth, Semi-mature, min 6m high, to be staked and secured with suitable rubber ties.
- Proposed Large Native Tree**  
Trees to be planted as 12-14cm girth, Heavy Standard, 3-4m high, to be staked and secured with suitable rubber ties.
- Proposed Medium Native Tree**  
Trees to be planted as 10-12cm girth, Heavy Standard, 3-4m high, to be staked and secured with suitable rubber ties.
- Proposed Small Native Tree**  
Trees to be planted as 10-12cm girth or 50L pots, 2-3m high and secured with single stake and suitable rubber ties.
- Proposed Native Hedge**  
80-100cm, BR stock, planted as a double staggered row at 300mm centres
- Proposed Formal Native Hedge**  
Evergreen hedge to be Standard planted at 60-80cm, 5L pots, at 5 per lin.m. Species: Carpinus betulus
- Proposed Low Hedge**  
40-60cm high, to be planted in instant linear troughs
- Proposed Native Buffer Planting**  
Native shrubs to be 60-90cm height in groups of 3 or 5 protected by tubex or spiral guard. Shrubs species should include a mix of native species which provide berries, fruits and flowers to attract a range of species such as bats, birds and invertebrates.
- Proposed Ornamental Planting**  
Mixed shrub and herbaceous planting, 3-5L pots with 10-15L specimens. Planting beds to receive 75mm depth ornamental bark mulch.
- Proposed Wildflower Meadow**  
To be Emorgate EM2 Standard General Purpose Meadow Mix, supplied by Emorgate or similar approved. Including 80% ornamental grasses and 20% of wildflowers Sowing rate 4/gm<sup>2</sup>.
- Proposed Wet-Tolerant Grassland**  
To be Emorgate EP1 Pond Edge Mixture, supplied by Emorgate or similar approved. Including 20% native wild flowers and 80% slow growing grasses. Sowing rate 4/gm<sup>2</sup>.
- Proposed Wildflower Meadow for Wetlands**  
To be Emorgate EM8 Meadow Mixture for Wetlands, supplied by Emorgate or similar approved. Including 80% ornamental grasses and 20% of wildflowers Sowing rate 4/gm<sup>2</sup>.
- Proposed Bulb Planting**
- Proposed Maintained POS Grass**  
To be seeded.
- Proposed Amenity Grass**  
Front gardens to be turf.
- Proposed Amenity Grass**