

- NOTES**
- 1 ALL WORK TO BE CARRIED OUT IN ACCORDANCE WITH THE BUILDING REGULATIONS AND THE REQUIREMENTS OF THE LOCAL AUTHORITY.
 - 2 NO DIMENSIONS TO BE SCALED FROM THIS DRAWING.
 - 3 THE CONTRACTOR SHALL VERIFY ALL LEVELS AND DIMENSIONS ON SITE BEFORE COMMENCEMENT OF WORK.
 - 4 ON SITE ALTERATIONS TO THE CONSTRUCTION OR FINISHES SHOWN OR IMPLIED ON THIS DRAWING MUST BE DRAWN TO THE ATTENTION OF THE ARCHITECT BEFORE SUCH WORK IS IMPLEMENTED.
 - 5 ALL TIMBERS REQUIRE PRESERVATIVE TREATMENT

© COPYRIGHT RESERVED

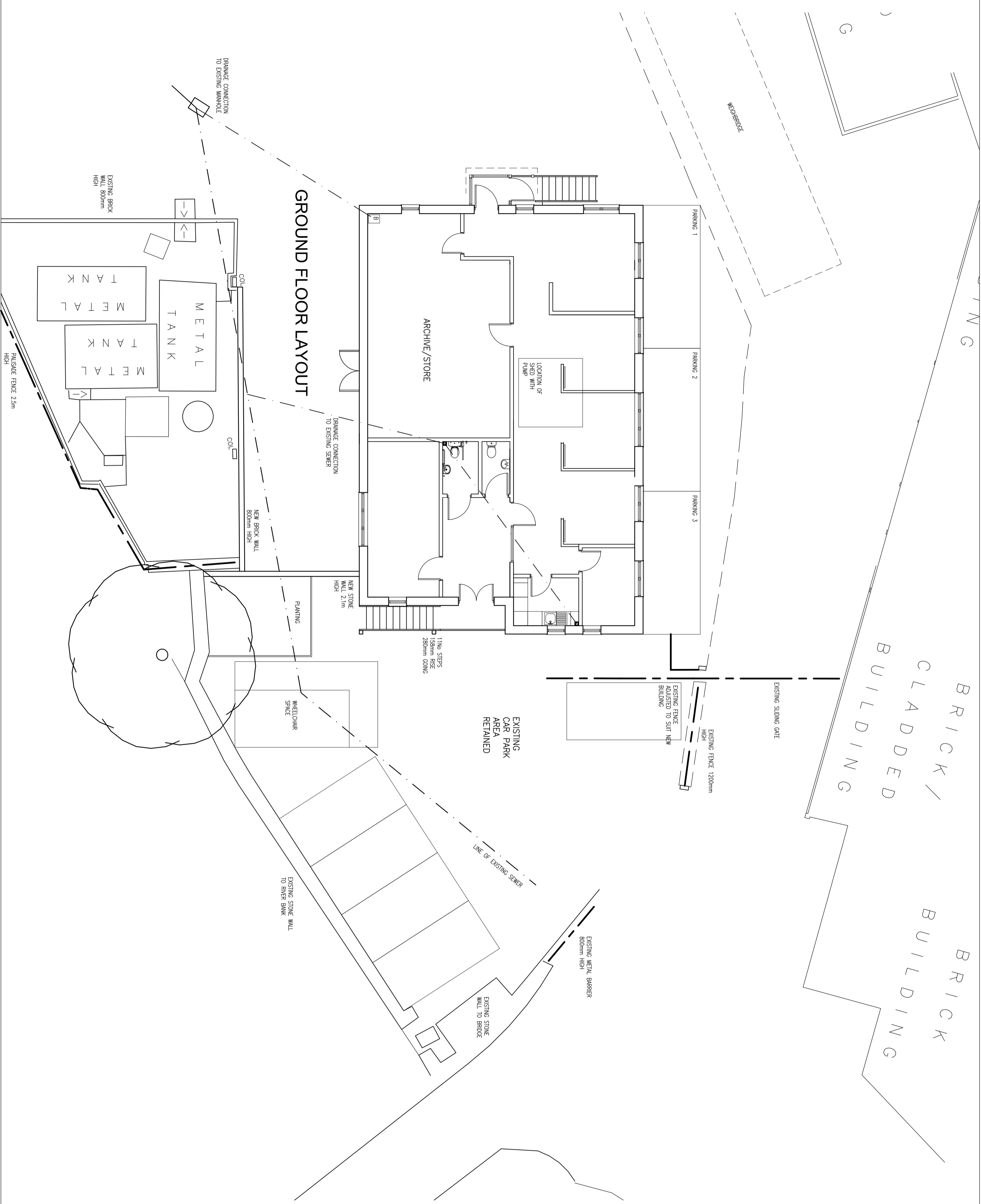

PRELIMINARY

Rev	Date	Details
01	13.03.19	Site updated to show parking spaces

Drawing Status:

PROGRESSIVE

Progressive Architecture
 4 Levensham Road, Skeltonville, West Yorkshire, HD7 5AL, Tel: 01484 846786

Client:
DR Baling Wire Manufacturers Ltd

Site:
 Office Building,
 Oxspring Wire Works, Oxspring,
 Penistone S36 8YW

Drawing Title:
Proposed Site Layout

Project Number:	Drawing Number:	Revision:
P1005	05	01
Date:	Scale:	Drawn:
05-03-19	1:100 @ A2	IWW