

GEORGINA AS DISCUSSED.

Michael A. Clynech
Architect, Town Planner, Property Consultant
DIP.ARCH. DIP. T.P. A.R.I.B.A. F.R.S.A.

14 Huddersfield Road Ingbirchworth, Penistone
Sheffield S36 7GF

Tel: 01226 766308

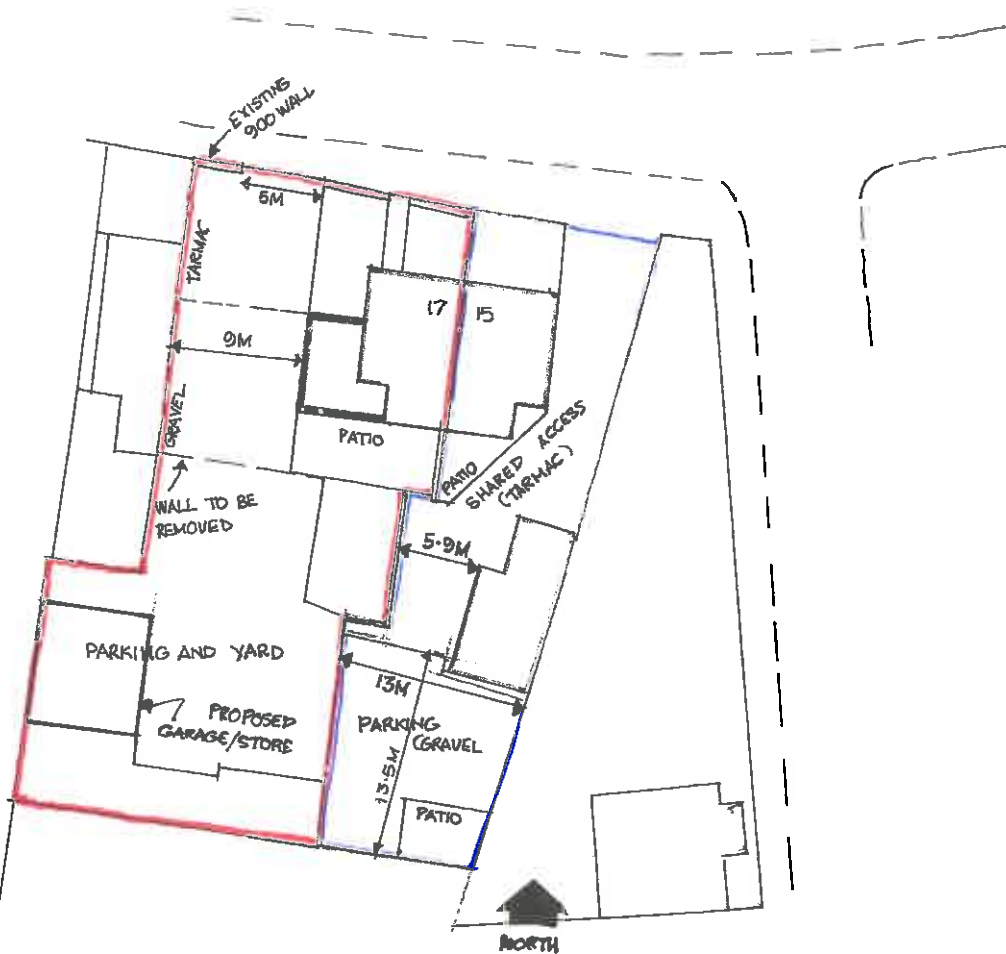

GARAGE EXTENSION TO 17 THURLSTONE ROAD - ACCESS AND SERVICE PARKING 1:500 A3

- OWNERSHIP
- PARKING / ACCESS AREA

MICHAEL A. CLYNCH
Dip. Arch. Dip. T.P. A.R.I.B.A.
Architect & Town Planner
14 Huddersfield Road, Ingbirchworth
Sheffield S36 7GF Tel: 01226 766308

Amended Plans