

**Arboricultural Survey to BS5837:2012**

**Jackie Creek**

**Starling House,  
Birks Lane,  
Millhouse Green,  
Sheffield,  
S36 9NB**

11 August 2022

Charlie Moore BSc (Hons) TechArborA

## Table of Contents

*If this report has been released electronically the appendices referred to herein can be found in the annexed zip folder/s as .pdf files. If this report has been released in hard copy the appendices will be bound into the back of this report. Plans are annexed separately as A0, A1, A2 or A3 as appropriate.*

1. Introduction .....	2
2. Survey .....	2
3. BS5837:2012 Scope.....	6
4. Methodology.....	6
5. Definitions.....	8
6. Recommendations.....	9
7. Limitations .....	9
8. Appendices .....	10
Appendix 1: Table 1 Cascade chart for tree quality assessment.....	11
Appendix 2: Schedule of Trees.....	13
Appendix 3: Tree Constraints Plan .....	14

## 1. Introduction

Arbtech Consulting Limited (Arbtech) received written instruction on 27<sup>th</sup> July 2022 from Jackie Creek to attend Starling House, Birks Lane, Millhouse Green, Sheffield, S36 9NB; grid reference, SE 22031 02995 (site) to undertake an arboricultural survey a to BS5837:2012 guidance to assess trees, hedges and major shrub groups growing on and within influencing distance of the site and to produce a Schedule of Trees and a Tree Constraints Plan.

I am Charlie Moore, a Consultant (Arboriculturist) at Arbtech Consulting Ltd. I hold a BSc Honors degree in Arboriculture and Urban Forestry and a BTEC Level 3 Extended Diploma in Countryside Management and have professional experience in arboriculture spanning 4 years. I also hold a Technician grade membership with the Arboricultural Association and the LANTRA Professional Tree Inspector ticket.

The advice below and appended is underwritten by our Professional Indemnity insurance for the business practice of Arboricultural Consultancy in the sum of one million Pounds Sterling in each and every claim.

**Table 1:** Documents referred to.

Document	Reference No.
Survey base drawing	1221 001 001
LPA pre-app comments	N/A
British Standard 5837:2012	“BS5837”
Tree Survey Schedule	Arbtech TS 01
Tree Constraints Plan	Arbtech TCP 01

## 2. Survey

Survey: An arboricultural survey to BS5837 of all trees within impacting distance of the site was undertaken by Charlie Moore on 9<sup>th</sup> of August 2022.

During the survey I categorised the trees using “Table 1 – Cascade chart for tree quality assessment” of the BS5837:2012 (see Appendix 1).

A total of 15No. individual trees, 5No. groups of trees, 0No. hedges and 0No. major shrub groups were surveyed. Details for each of the trees surveyed are provided in the Schedule of Trees (see Appendix 2).

Multiple small trees and shrubs occupy the site, none of which meet the minimum diameter requirements to be considered for this survey.

**Table 2:** Documents upon which this tree survey has been based.

Document	Originator	Reference Number	Title
Topo	Survey Site Solutions Ltd	1221 001 001	Topographical Survey

Limitations: The survey was made at ground level using visual observation only. Detailed examinations, such as climbing inspections and advanced decay detection equipment were not employed, though may form part of the survey’s management recommendations. Measurements were taken using specialist tapes, laser, and GPS devices. Where this was not possible, measurements are estimated.

Scope: Pre-development tree surveys make arboricultural management recommendations based exclusively upon the individual tree or group of trees condition relative to their present context (*i.e. not in relation to the proposed development*).

Legal Status: No statutory protection check has been performed. BS5837 does not draw any distinction between trees subject to statutory protection, such as a Tree Preservation Order (“TPO”), and those trees without. This is principally because a detailed planning consent overrides any TPO protection. Consequently, we do not seek to offer any comparison between or infer any difference in the quality or importance of TPO trees and other trees.

\* For more information on the surveyed trees please see Arbtech Consulting Ltd, Tree Survey Schedule (Appendix 1), Tree Survey Report and Tree Constraints Plan.

**Site description**

The site is located directly north of the river Don, and is situated to the south of Millhouse Green, between Thurlstone and Catshaw. The site itself comprises of a single dwelling area, with a driveway lined on either side by trees. The northern side of the riverbank has recently failed, and has been dug out at the behest of the Environment Agency, thus the bank edge has moved approximately 2m to the north.

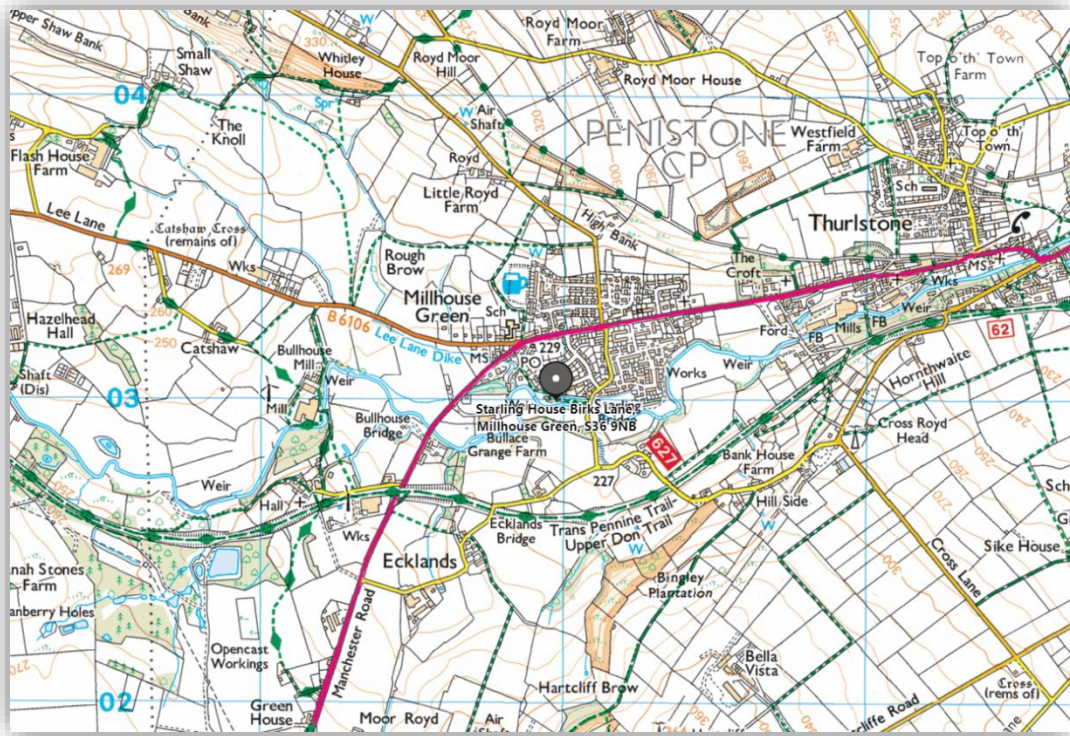

Figure 1: OS Map (Bing Maps)



Figure 2: Aerial Image of site with approximate red line boundary (Bing Maps)

## **Proposed scheme**

Replacement of the northern riverbank, with installation of Gabion Baskets to aid in future erosion resistance.

It is likely that arboricultural impacts can be addressed with arboricultural methodology or minor amendments to the proposal.

*This content is for educational and informative purposes; parts of it are reproduced with the kind permission of BSI Global.*

### 3. BS5837:2012 Scope

This standard recognises that there can be problems for development close to existing trees which are to be retained, and of planting trees close to existing structures. This standard sets out to assist those concerned with trees, in relation to construction, to form balanced judgements. It does not set out to put arguments for or against development, or for the removal or retention of trees. Where development, including demolition, is to occur, the standard provides guidance on how to decide which trees are appropriate for retention, on the means of protecting these trees during development, including demolition and construction work, and on the means of incorporating trees into the developed landscape.

### 4. Methodology

The methodology used to assess the trees was the British Standard 5837:2012 'Trees in Relation to Construction' tree survey method. The aim of the survey is to establish which trees are moderate and good quality; suitable for retention and justifying protection. And which trees are low or poor quality; either undesirable or unsuitable to retain and protect.

The tree survey includes all trees included in the land survey red line boundary plan, as well as any that may have been missed, and it should categorize trees or groups of trees, including woodlands for their quality and value within the existing context, in a transparent, understandable, and systematic way. Where the arboriculturist has deemed it appropriate, the trees have been tagged with small metal or plastic tags, placed as high as is convenient on the stem of each tree.

Whilst master plan proposals for the development of the site might be available, the trees have been surveyed without taking these into consideration. All detailed design work on site layout should take into consideration the results of the tree survey (and the TCP).

Trees forming groups and areas of woodland (including orchards, wood pasture and historic parkland) are identified and considered as groups where the arboriculturist has determined that this is appropriate, particularly where they contain a variety of species and age classes that could aid long-term management. It is often expedient to assess the quality and value of such groups of trees as a whole, rather than as individuals. However, an assessment of individuals within any group has been undertaken if they are open-grown or if there is a need to differentiate between them.

The quality and value of each tree or group of trees has been recorded by allocating it to one of the four categories: **A**, **B**, **C**, or **U** (highest to lowest quality respectively). The categories are differentiated on the tree survey plan by colour, or by suffixing the category adjacent to the tree identification number on the TCP.

The survey schedule lists all the trees or groups of trees. The following information is also provided:

- a) reference number (to be recorded on the tree survey plan);
- b) species (common or scientific names);
- c) height in meters (m);
- d) stem diameter in millimetres (mm) at 1.5m above adjacent ground level or immediately above the root flare for multi-stemmed trees;
- e) branch spread in meters taken at the four cardinal compass points;
- f) height of crown clearance above adjacent ground level in meters (m);
- g) age class (newly planted, young, semi-mature, early mature, mature, over mature);
- h) physiological condition (e.g. good, fair, poor, decline and dead);
- i) structural condition (e.g. good, fair, poor or not visible);
- j) comment about the tree, its location and preliminary management recommendations, including further investigation of suspected defects that require more detailed assessment and potential for wildlife habitat;
- k) The retention category referring to the quality and useful contribution in years; **U** = <10yrs; **A** = >40yrs; **B** = >20yrs; **C** = >10yrs. The retention subcategory referring to the type of amenity; 1 = Arboricultural; 2 = Landscape; 3 = Cultural including conservation (see Appendix 1 Cascade chart for tree quality assessment).

## 5. Definitions

### Arboriculturist

An arboriculturist (or arboricultural consultant) is a person who has, through relevant education, training, and experience, gained recognized qualifications and expertise in the field of trees in relation to construction.

### Tree Survey

A tree survey should be undertaken by an arboriculturist and should record information about the trees on a site independently of and prior to any specific design for development. As a subsequent task, and with reference to a design or potential design, the results of the survey should be included in the preparation of a tree constraints plan, which should be used to assist with site layout design.

### Tree Constraints Plan

A TCP is plan, typically delivered as an AutoCAD drawing (.DWG file format), prepared by an arboriculturist for the purposes of layout design showing the root protection area and representing the effect that the mature height and spread of retained trees will have on layouts through shade, dominance, etc.

### Root Protection Area

An RPA is a layout design tool indicating the area surrounding a tree that contains sufficient rooting volume to ensure the survival of the tree, shown in plan form in m<sup>2</sup>.

### Construction Exclusion Zone (also termed Tree Protection Zone)

A construction exclusion or tree protection zone is an area based on the RPA (in m<sup>2</sup>), identified by an arboriculturist, to be protected during development, including demolition and construction work, by the use of barriers and/or ground protection fit for purpose to ensure the successful long-term retention of a tree.

### Arboricultural Impact Assessment (AIA)

This is a study, undertaken by an arboriculturist, to identify, evaluate and possibly mitigate the extent of direct and indirect impacts on existing trees that may arise as a result of the implementation of any site layout proposal.

### Tree Protection Plan (TPP)

A TPP is plan, typically delivered as an AutoCAD drawing (.DWG file format), prepared by an arboriculturist showing the finalized layout proposals, tree retention and tree and landscape protection measures detailed within the arboricultural method statement, which can be shown graphically.

### Arboricultural Method Statement (AMS)

This is a methodology for the implementation of any aspect of development that has the potential to result in loss of or damage to a tree. The AMS is likely to include details of an on-site tree protection monitoring regime.

## 6. Recommendations

As we have not seen your planning proposals, we make the following recommendation to ensure that there are no irrevocable issues to the proposed retained trees and so that no conditions relating to arboriculture are attached to any planning consent secured; obtain an arboricultural report to include:

- a) An arboricultural impact assessment (AIA).
- b) An arboricultural method statement (AMS).
- c) A tree protection plan drawing (TPP).

## 7. Limitations

Trees were inspected from using visual observation from ground level only. Trees were not climbed or inspected below ground level. Inaccessible trees will have best estimates made about the location, physical dimensions, and characteristics. Trees have been grouped where BS5837 guides us that it is expedient to do so. Trees have been excluded from the survey if they are found by us to be sufficiently far away from the proposed developable area or if they are outside of the red line boundary plan showing the expectations of our client for the extent of the survey. BS5837 does not draw any distinction between trees subject to statutory protection, such as a Tree Preservation Order (“TPO”), and those trees without. This is principally because a detailed planning consent overrides any TPO protection. Consequently, we do not seek to offer any comparison between or infer any difference in the quality or importance of TPO trees and other trees.

## 8. Appendices

The following documents were released to the Client as appendices to this report:

- Survey Schedule (.PDF)
- Tree Constraints Plan drawing (.DWG & .PDF)

If you require clarification of information contained herein, please do not hesitate to contact us via 01244 661170.

Yours Sincerely,



Charlie Moore BSc (Hons) TechArborA

Consultant Arboriculturist

07842313880

charliemoore@arbtech.co.uk

## Appendix 1: Table 1 Cascade chart for tree quality assessment

---

## BS5837:2012 Trees in relation to design, demolition and construction – Recommendations

**Table 1** Cascade chart for tree quality assessment

Category and definition	Criteria (including subcategories when appropriate)	Identification on plan
Trees unsuitable for retention (see Note)		
<b>Category U</b> Those in such a condition that they cannot realistically be retained as living trees in the context of the current land use for longer than 10 years.	<ul style="list-style-type: none"> <li>•Trees that have serious, irremediable, structural defect, such that their early loss is expected due to collapse, including those that will become unviable after removal of other category U trees (e.g. where, for whatever reason, the loss of companion shelter cannot be mitigated by pruning).</li> <li>•Trees that are dead or are showing signs of significant, immediate, and irreversible overall decline.</li> <li>•Trees infected with pathogens of significance to the health and/or safety of other trees nearby, or very low quality trees suppressing adjacent trees of better quality.</li> </ul> <p><i>NOTE Category U trees can have existing or potential conservation value which might be desirable to preserve; see 4.5.7.</i></p>	Dark red
	<b>1 Mainly arboricultural qualities</b>	<b>2 Mainly landscape qualities</b>
		<b>3 Mainly cultural values, including conservation</b>
<b>Trees to be considered for retention</b>		
<b>Category A</b> <b>Trees of high quality</b> with an estimated remaining life expectancy of at least 40 years.	Trees that are particularly good examples of their species, especially if rare or unusual; or those that are essential components of groups or formal or semi-formal arboricultural features (e.g. the dominate and/or principal trees within an avenue).	Trees, groups, or woodlands of particular visual importance as arboricultural and/or landscape features.
<b>Category B</b> <b>Trees of moderate quality</b> with an estimated remaining life expectancy of at least 20 years.	Trees that might be included in category A, but are downgraded because of impaired condition (e.g. presence of significant though remedial defects, including unsympathetic management and storm damage), such that they are unlikely to be suitable for retention of beyond 40 years; or trees lacking the special quality necessary to merit the category 'A' designation.	Trees present in numbers, usually growing as groups or woodlands, such that they attract a higher collective rating than they might as individuals; or trees occurring as collectives but situated so as to make little visual contribution to the wider locality.
<b>Category C</b> <b>Trees of low quality</b> with an estimated remaining expectancy of at least 10 years, or young trees with a stem diameter below 150mm.	Unremarkable trees of very limited merit or such impaired condition that they do not qualify in higher categories.	Trees present in groups or woodlands, but without this conferring on them significantly greater collective landscape value; and/or trees offering low or only temporary/transient landscape value.
		Trees, groups or woodlands of significant conservation, historical, commemorative or other value (e.g. veteran trees or wood-pasture).
		Trees with material conservation or other cultural value.
		Trees with no material conservation or other cultural value.
		Light green
		Mid blue
		Grey

---

## Appendix 2: Schedule of Trees

---

Client: Jackie Creek  
 Project: Starling House, Birks Lane, Millhouse Green,  
 Sheffield, S36 9NB  
 Survey Date: 09/08/2022  
 Surveyor: Charlie Moore



Unit 3, Well House Barns  
 Chester Road  
 Chester  
 Cheshire  
 CH4 0DH  
 Phone: 01244661170

Tree and Tag No Species	Hght (m)	Stems		Crown		Age	RP A (m <sup>2</sup> ) R (m)	Phys Condition	Structural Condition	Preliminary Recommendations Survey Comment	Cat ERC	
		No	Ø (mm)	Spread (m)	Clear (m)							
<b>G01</b>										Estimated Measurements		
Various <i>See comments for details</i>	15	1	410	N	4.5	0	M	A: 76.1 R: 4.92	Good	C: Good S: Not visible B: Not visible	20+ yrs <b>B.2</b>	
				E	4.5	0				Offsite group located on the far side of a land drain ditch; comprised of several trees with small suckers; species include ash, sycamore and Wych elm; recorded dimensions denote the maximum measurements for the group - stems between 410mm and 80mm, heights between 15m and 6m.		
				S	4.5	0						
				W	4.5	0						
<b>G02</b>										Estimated Measurements		
Various <i>See comments for details</i>	5	1	110	N	1	0	EM	A: 5.5 R: 1.32	Good	C: Good S: Not visible B: Not visible	20+ yrs <b>C.2</b>	
				E	1	0				Large onsite group of shrubs and small trees; species include elder, holly, clematis and rhododendron; recorded dimensions denote the maximum measurements for the group - stems between 110mm and 50mm.		
				S	1	0						
				W	1	0						
<b>G03</b>										Estimated Measurements		
Various <i>See comments for details</i>	2.5	1	60	N	0.5	0	M	A: 1.6 R: 0.71	Good	C: Good S: Not visible B: Not visible	20+ yrs <b>C.2</b>	
				E	0.5	0				Onsite linear shrub group; recorded dimensions denote the maximum measurements for the group - stems between 60mm and 20mm, heights between 2.5m and 1m; species include laurel, Wych elm and rhododendron.		
				S	0.5	0						
				W	0.5	0						
<b>G04</b>										Estimated Measurements		
Various <i>See comments for details</i>	18	1	750	N	5	1	M	A: 254.5 R: 9	Good	C: Good S: Not visible B: Not visible	40+ yrs <b>B.2</b>	
				E	5	1				Offsite linear group of mature trees, with smaller shrubs and trees; located on the far side of a river; species include cherry, sycamore and oak; recorded dimensions denote the maximum measurements for the group - stems between 750mm and 80mm, heights between 18m and 5m.		
				S	5	1						
				W	5	1						
<b>Age Classifications:</b>	N	Newly planted	EM	Early Mature	<b>Condition:</b>		C	Crown	<b>Stems:</b>		Ø	Diameter
	Y	Young	M	Mature			S	Stem			(Eq)	Equivalent stem diameter using BS5837:2012 definition
	SM	Semi-mature	OM	Over Mature			B	Basal area	<b>ERC:</b>			Estimated Remaining Contributio

Tree and Tag No Species	Hght (m)	Stems		Crown		Age	RP A (m <sup>2</sup> ) R (m)	Phys Condition	Structural Condition	Preliminary Recommendations		Cat ERC
		No	Ø (mm)	Spread (m)	Clear (m)					Survey Comment		
Estimated Measurements												
G05 Various <i>See comments for details</i>	14	1	550	N	4	1	M	A: 136.9 R: 6.6	Good	C: Good S: Not visible B: Not visible	Offsite linear group of mature trees, with smaller shrubs and trees; species include sycamore and ash; recorded dimensions denote the maximum measurements for the group - stems between 550mm and 80mm, heights between 14m and 5m.	B.2 40+ yrs
Estimated Measurements												
T01 Sycamore <i>Acer pseudoplatanus</i>	8.5	2	431 (Eq)	N	4.5	2	M	A: 84.2 R: 5.17	Good	C: Fair S: Good B: Not visible	Offsite tree; located adjacent to a walkway; twin stemmed from base; historically been topped to a height of 4m - wounds approximately between 120mm and 250mm, no occlusion visible from ground level; asymmetrical crown distribution due to neighbouring trees.	B.1 20+ yrs
Estimated Measurements												
T02 Sycamore <i>Acer pseudoplatanus</i>	8.5	1	410	N	3	3.5	M	A: 76.1 R: 4.92	Good	C: Fair S: Good B: Not visible	Offsite tree; located adjacent to a walkway; twin stemmed from base; historically been topped to a height of 5m - wounds approximately between 80mm and 120mm, no occlusion visible from ground level; asymmetrical crown distribution due to neighbouring trees.	B.1 20+ yrs
<b>Age Classifications:</b>	N	Newly planted	EM	Early Mature	<b>Condition:</b>			C	Crown	<b>Stems:</b>	Ø	Diameter
	Y	Young	M	Mature				S	Stem		(Eq)	Equivalent stem diameter using BS5837:2012 definition
	SM	Semi-mature	OM	Over Mature				B	Basal area	<b>ERC:</b>		Estimated Remaining Contributio

Tree and Tag No Species	Hght (m)	Stems		Crown		Age	RP A (m <sup>2</sup> ) R (m)	Phys Condition	Structural Condition	Preliminary Recommendations Survey Comment	Cat ERC	
		No	Ø (mm)	Spread (m)	Clear (m)							
<b>T03</b>												
Common Ash <i>Fraxinus excelsior</i>	18	1	750	N	9	5	M	A: 254.5 R: 9	Fair	C: Good S: Good B: Poor	<b>U</b>  <10 yrs	
				E	9.5	5						
				S	9	4						
				W	6	9						
<b>T04</b>												
Silver Birch <i>Betula pendula</i>	19	1	530	N	4.5	4	M	A: 127.1 R: 6.36	Good	C: Good S: Good B: Fair	<b>B.1</b>  20+ yrs	
				E	5.5	10						
				S	4	10						
				W	3.5	6						
<b>Age Classifications:</b>	N	Newly planted	EM	Early Mature	<b>Condition:</b>		C	Crown	<b>Stems:</b>		Ø	Diameter
	Y	Young	M	Mature			S	Stem			(Eq)	Equivalent stem diameter using BS5837:2012 definition
	SM	Semi-mature	OM	Over Mature			B	Basal area	<b>ERC:</b>			Estimated Remaining Contributio

Tree and Tag No Species	Hght (m)	Stems		Crown		Age	RP A (m <sup>2</sup> ) R (m)	Phys Condition	Structural Condition	Preliminary Recommendations Survey Comment	Cat ERC		
		No	Ø (mm)	Spread (m)	Clear (m)								
<b>T05</b>													
Common Horse Chestnut <i>Aesculus hippocastanum</i>	16	1	510	N	5	1	M	A: 117.7 R: 6.12	Good	C: Good S: Good B: Fair	<b>B.1</b> 20+ yrs		
				E	5	2							
				S	5	2							
				W	4	1							
<b>T06</b>													
Common Laburnum <i>Laburnum anagyroides</i>	8	1	330	N	3	4.5	M	A: 49.3 R: 3.96	Fair	C: Good S: Good B: Poor	<b>U</b> <10 yrs		
				E	3	3							
				S	3	2.5							
				W	3	2.5							
<b>T07</b>											Estimated Measurements		
Wych Elm <i>Ulmus glabra</i>	10	1	340	N	5	3.5	EM	A: 52.3 R: 4.08	Decline	C: Poor S: Not visible B: Not visible	<b>U</b> <10 yrs		
				E	5	3							
				S	3.5	2.5							
				W	2.5	3							
<b>T08</b>											Estimated Measurements		
Sycamore <i>Acer pseudoplatanus</i>	10	1	330	N	2.5	6	M	A: 49.3 R: 3.96	Good	C: Good S: Not visible B: Not visible	<b>B.1</b> 20+ yrs		
				E	3.5	3							
				S	6	2							
				W	4.5	2							
<b>T09</b>													
Tree Rhododendron <i>Rhododendron arboreum</i>	4.5	1	100	N	3	1	M	A: 4.5 R: 1.19	Good	C: Good S: Good B: Good	<b>C.1</b> 20+ yrs		
				E	3	2							
				S	3.5	2							
				W	3.5	2							
<b>Age Classifications:</b>	N	Newly planted	EM	Early Mature				<b>Condition:</b>	C	Crown	<b>Stems:</b>	Ø	Diameter
	Y	Young	M	Mature					S	Stem		(Eq)	Equivalent stem diameter using BS5837:2012 definition
	SM	Semi-mature	OM	Over Mature					B	Basal area	<b>ERC:</b>		Estimated Remaining Contributio

Tree and Tag No Species	Hght (m)	Stems		Crown		Age	RP A (m <sup>2</sup> ) R (m)	Phys Condition	Structural Condition	Preliminary Recommendations Survey Comment	Cat ERC	
		No	Ø (mm)	Spread (m)	Clear (m)							
<b>T10</b>												
Wild Cherry <i>Prunus avium</i>	12	1	290	N	0.5	3	M	A: 38.1 R: 3.48	Good	C: Good S: Good B: Not visible	<b>C.1</b> 10+ yrs Located in grassland; unable to thoroughly inspect the base due to shrubs obstructing view; asymmetrical crown distribution due to neighbouring group of trees; historic pruning around the crown break, wounds approximately between 60mm and 140mm - no occlusion.	
<b>T11</b>												
Copper Beech <i>Fagus sylvatica 'Purpurea'</i>	9	1	170	N	3	2	SM	A: 13.1 R: 2.04	Good	C: Good S: Good B: Fair	<b>C.1</b> 20+ yrs Located in grassland; large pile of rocks for gabion baskets piled directly adjacent to the main stem on the eastern side; bark damage to the main stem on the north western side, consistent with mechanical damage - circa 10 percent occlusion.	
<b>T12</b>												
Wild Cherry <i>Prunus avium</i>	10	1	480	N	4	2.5	M	A: 104.2 R: 5.75	Good	C: Good S: Fair B: Fair	<b>C.1</b> 10+ yrs Located in grassland; abrupt soil height change approximately 2m from the southern side of stem - soil level drops by approximately 1.8m exposing roots between 1mm and 30mm; historic limb failure from 1.4m, has torn down to the base - wound approximately 350mm X 1.5m, no occlusion; crown break from 1.5m, recorded stem diameter taken from 1m above ground level.	
<b>T13</b>												
Willow <i>Salix sp.</i>	14	1	420	N	3.5	13	M	A: 79.8 R: 5.03	Good	C: Good S: Good B: Good	<b>B.1</b> 20+ yrs Located in grassland; widespread crown with asymmetrical distribution due to neighbouring group of trees; deadwood within the canopy approximately between 10mm X 200mm and 40mm X 1m.	
<b>Age Classifications:</b>	N	Newly planted	EM	Early Mature	<b>Condition:</b>			C	Crown	<b>Stems:</b>	Ø	Diameter
	Y	Young	M	Mature				S	Stem		(Eq)	Equivalent stem diameter using BS5837:2012 definition
	SM	Semi-mature	OM	Over Mature				B	Basal area	<b>ERC:</b>		Estimated Remaining Contributio

Tree and Tag No Species	Hght (m)	Stems		Crown		Age	RP A (m <sup>2</sup> ) R (m)	Phys Condition	Structural Condition	Preliminary Recommendations		Cat ERC
		No	Ø (mm)	Spread (m)	Clear (m)					Survey Comment		
<b>T14</b>												
Norway Maple 'Crimson King' <i>Acer platanoides 'Crimson King'</i>	14	1	410	N	4.5	1	M	A: 76.1 R: 4.92	Good	C: Good S: Good B: Fair	Located in grassland; abrupt soil level change approximately 2.5m to the south - soil level drop by approximately 1.8m exposing roots between 1mm and 25mm diameter; superficial bark damage around the main stem consistent with mechanical damage.	<b>B.1</b> 20+ yrs
<b>T15</b>												
Common Laburnum <i>Laburnum anagyroides</i>	6	3	256 (Eq)	N	1.5	2	M	A: 29.7 R: 3.07	Good	C: Good S: Good B: Fair	Located in grassland; bark damage to the base approximately 230mm X 220mm - now occluded to 80mm X 110mm; main stem angle approximately 30 degrees from vertical; abrupt soil level change approximately 1.5m to the south - soil level drop approximately 1.8m, exposing roots approximately between 1mm and 20mm diameter.	<b>C.1</b> 20+ yrs
<b>Age Classifications:</b>	N	Newly planted	EM	Early Mature	<b>Condition:</b>			C	Crown	<b>Stems:</b>	Ø	Diameter
	Y	Young	M	Mature				S	Stem		(Eq)	Equivalent stem diameter using BS5837:2012 definition
	SM	Semi-mature	OM	Over Mature				B	Basal area	<b>ERC:</b>		Estimated Remaining Contributio

---

## Appendix 3: Tree Constraints Plan

---

Note: Existing dwelling(s) retaining walls, roads(s) and structures are likely to be partial or complete root barriers. We currently do not have enough information with regards to the existing and surrounding properties and structures, foundations, soil types etc. to definitively determine the root barriers. Site features that are significant enough to be considered barriers to root development, irrespective of proximity to trees, have been identified with a light blue hatch (see key for details).

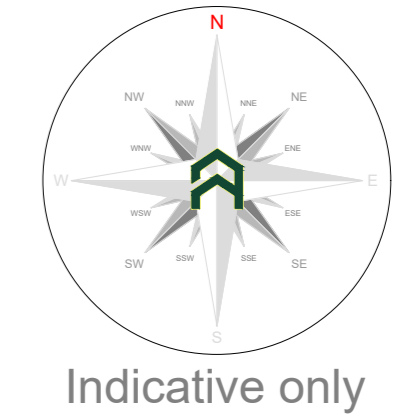

Indicative only

**Tree Categories**

These are categorised in accordance with the cascade chart in Table 1 of the British Standard BS 5837:2012 'Trees in relation to design, demolition and construction - Recommendations'

Category 'U': Trees in such condition that they cannot realistically be retained as living trees in context of the current land use for longer than 10 years.

Category 'V': Trees of high quality with an estimated remaining life expectancy of at least 40 years.

Category 'W': Trees of moderate quality with an estimated remaining life expectancy of at least 20 years.

Category 'X': Trees of low quality with an estimated remaining life expectancy of at least 10 years, or young trees with a stem diameter below 100mm.

**Root Protection Area**

In order to avoid damage to the roots or rooting environment of retained trees, the Root Protection Area (RPA) should be plotted around each of the category 'U' and 'V' trees. This is a minimum area in which should be left undisturbed around each retained tree.

The RPA is calculated using the British Standard BS 5837:2012 'Trees in relation to design, demolition and construction - Recommendations'.

The calculated RPA is capped to 7.57m<sup>2</sup>, which is the equivalent to a circle with a radius of 1.5m. Where there appears to be restrictions to root growth the root protection area is reshaped to more accurately reflect the likely distribution of the roots.

**Tree Survey Report**

Please refer to Arbtech Consulting Ltd. Tree Survey Report and Tree Schedule for full details on all surveyed trees, hedgerows and major shrub groups.

All trees were surveyed and categorised in accordance with the guidance as set out in the British Standard BS5837:2012 'Trees in relation to design, demolition and construction - Recommendations'.

We make the following recommendation to ensure that no conditions relating to arboriculture are attached to any planning consent secured, obtain an arboricultural report to include:

- a) An arboricultural impact assessment (AIA);
- b) An arboricultural method statement (AMS); and
- c) A tree protection plan (TPP).

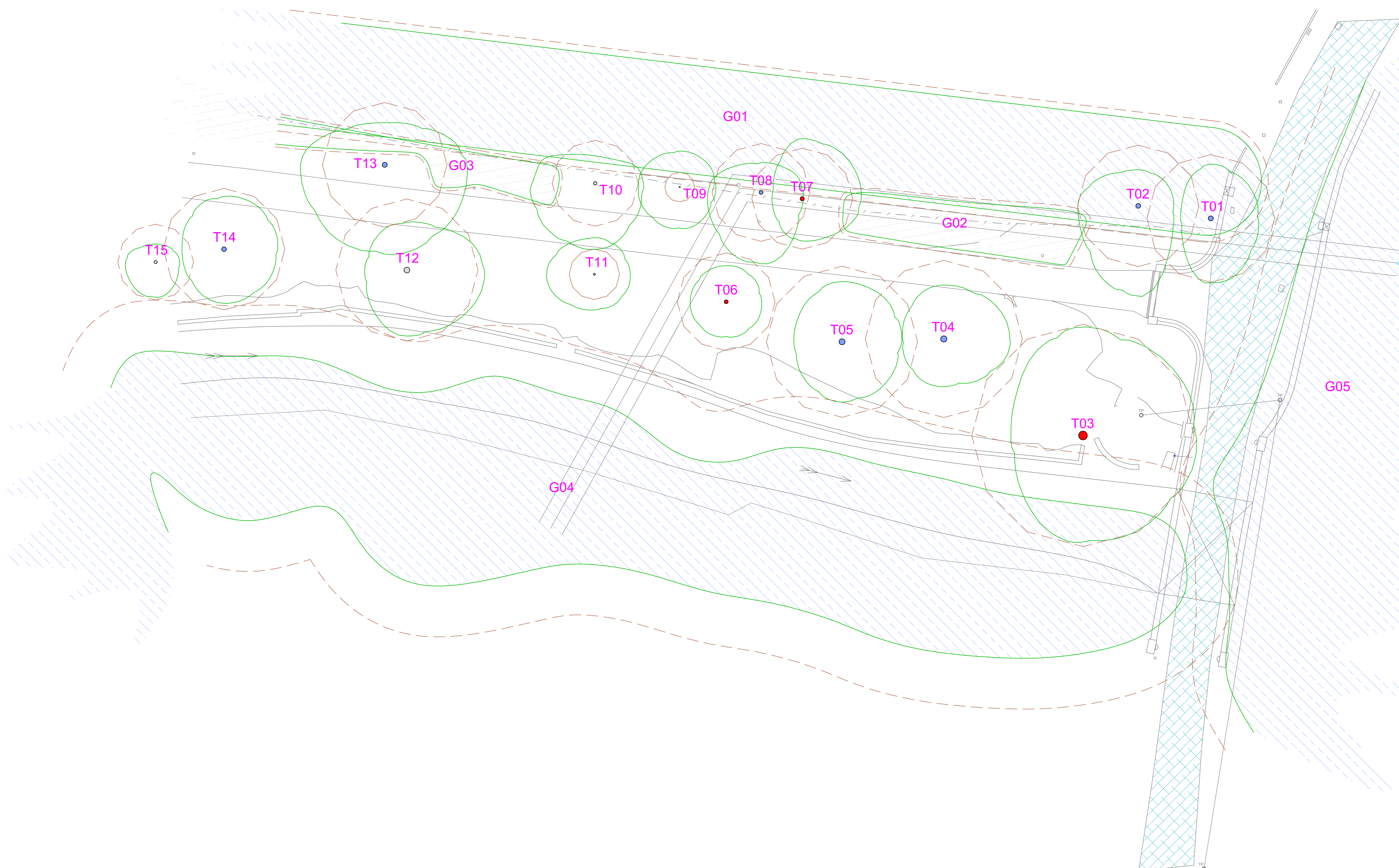

Project: **Starling House, Birks Lane, Millhouse Green, Sheffield, S36 9NB**

Client: **Jackie Creek**

Drawing: **Tree Constraints Plan**

Based on: **1221 001 001**

Drawing No: **Arbtech TCP 01** Rev:

Date: **Aug 2022** Scale: **1:150 @ A0** Drawn: **CMJM**

Key:

Tree Nos.:	T01	Tree Category:	Category 'U' trees	Trunks:	○
RPA:	○	Category 'U' trees	●	Category 'W' trees	●
Category 'W' groups:	○	Category 'W' trees	○	Category 'X' groups	○
Potential root barriers:	▨				

Document number	Editor	Signature	Position	Issue number	Date
Arbtech TSR 01	Charlie Moore		Consultant (Arboriculturist)	01	11/08/22

## Limitations

Arbtech Consulting Ltd has prepared this report for the sole use of the above-named Client/Agent in accordance with our terms of business, under which our services were performed. No other warranty, expressed or implied, is made as to the professional advice included in this report or any other services provided by us. This report may not be relied upon by any other party without the prior and express written agreement of Arbtech Consulting Ltd. The assessments made assume that the sites and facilities will continue to be used for their current purpose without significant change. The conclusions and recommendations contained in this report are based upon information provided by others and upon the assumption that all relevant information has been provided by those parties from whom it has been requested. Information obtained from third parties has not been independently verified by Arbtech Consulting Ltd.

## Copyright

© This Report is the copyright of Arbtech Consulting Ltd. Any unauthorised reproduction or usage by any person other than the addressee is strictly prohibited.