

## WORSBROUGH INDUSTRIAL AND SOCIAL HISTORY SOCIETY

### PROPOSED MONUMENT at PARK ROAD WORSBROUGH BRIDGE, BARNSELY

#### STATEMENT IN SUPPORT of APPLICATION

##### Site

The proposed monument is to be erected by the Worsbrough Industrial and Social History Society on land in the ownership of Barnsley Metropolitan Borough Council. The land is situated at the junction of Park Road (A61) and Millers Dale at Worsbrough Bridge, (OS Grid Reference: SE 35273 03768) and is shown in Photograph 1 below.



**Photograph 1 - Site**

The land is in the ownership of Barnsley MBC and is designated as Park Road - Public Open Space on the Council's land ownership map. Discussions have been held with local Council Members and the authority's Estates Department to gain support and to obtain permission to make the application.

##### Proposal

The monuments have been positioned in such place so to avoid conflict with underground services located on the land; which are shown on the drawing submitted with the application.

It is proposed that the monument will consist of three elements;

- (1) A restored colliery pit tub mounted on rails and sleepers. The tub to be used was originally used at Kellingley Colliery but is typical of those as used in local mines. The tub will be supported on a reinforced concrete slab, with the rails and tub permanently fixed to prevent movement by unauthorised persons.

The pit tub will have four 300 x 150 plaques mounted on the front face to commemorate the miners who lost their lives in mining disasters in Worsbrough Mines, as detailed below:-

Darley Main Colliery: Explosion on the 24<sup>th</sup> January, 1849: - 75 lives lost

Edmunds Main Colliery: Explosion on the 8<sup>th</sup> December, 1872: - 59 lives lost

Swaithe Main Colliery: Explosion on the 6<sup>th</sup> December, 1875: - 143 lives lost

Barrow Colliery: Pit cage failure on the 15<sup>th</sup> November, 1907: - 7 lives lost



**Photograph 2 - Restored Pit Tub (typical)**

- (2) An 841 x 1189 mm high pre-printed plastic information board on a 10mm thick steel sheet fixed to a 40 x 40 x 2.5mm galvanised mild steel box section frame, mounted on 250 x 150 tanalised timber railway sleepers, the board will be fixed 600 above ground level.

Information on the board will give additional written information and photographs if available with respect to the disasters with contact details to allow visitors to obtain further information.

- (3) A large replica of a miner's lamp mounted on a 550mm diameter precast concrete column finished in **to be decided** coloured paint. The column is to be fixed to an irregularly shaped natural sandstone plinth, shown in the photograph below. The plinth will be finished approximately 250mm above ground level and will be supported on a reinforced concrete slab finished 50mm below ground level. Total height of the monument and plinth will be approximately 1900mm.

The lamp is one of 5 which were originally positioned on the roof of the demolished Ceag lamp factory building formerly located on Queens Road, Barnsley.

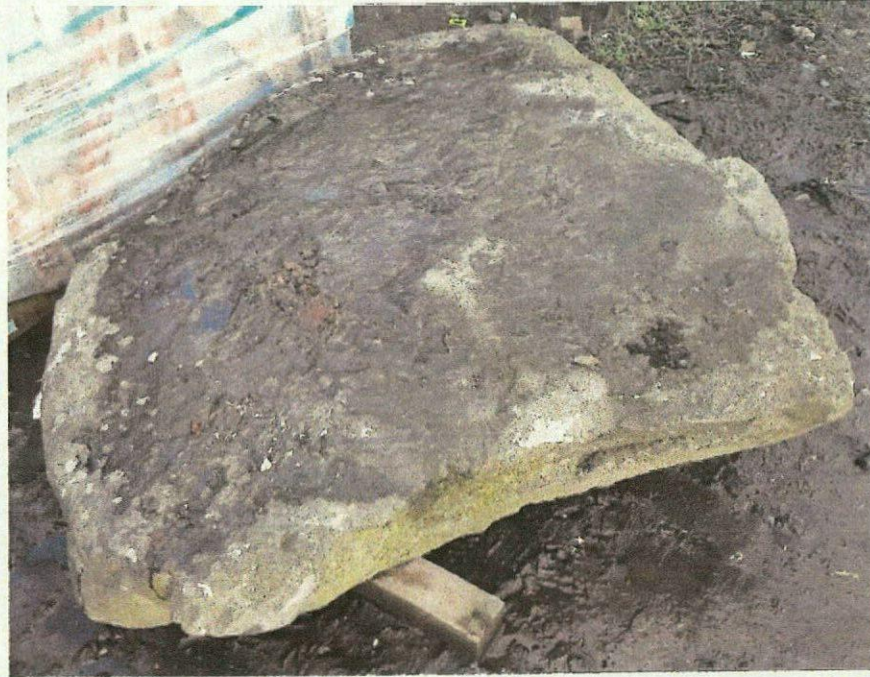

**Photograph 3 - Natural stone plinth**

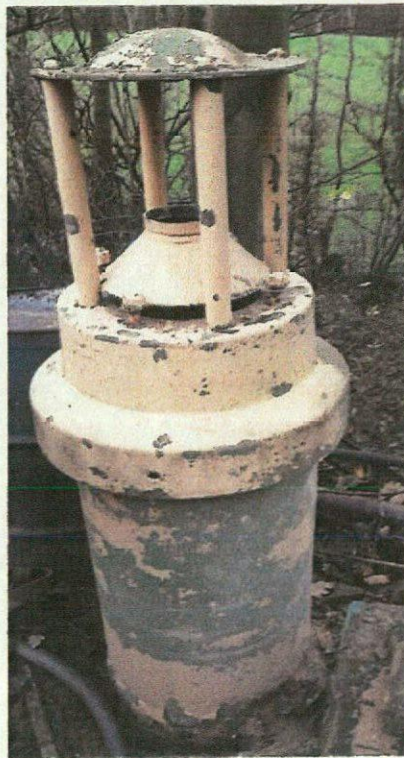

**Photograph 4 – Lamp (prior to restoration)**

A 750mm wide pathway will be constructed in precast concrete flagstones from the existing opening adjacent to the electricity sub-station to the monument to prevent damage to the grassed area.

**Statement**

The monument is to be erected to commemorate the 284 lives lost in the mines of Worsbrough, and to ensure that they are not forgotten, as many of the bodies of these workers were ever recovered.



Stephen Lonsdale &lt;slonser@gmail.com&gt;

---

**Park Road, Worsbrough - Commemorative Monuments**

8 messages

---

**Carratt , Adam** <AdamCarratt@barnsley.gov.uk>  
To: "slonser@gmail.com" <slonser@gmail.com>  
Cc: "Clarke , John" <CllrJohnClarke@barnsley.gov.uk>

Thu, Jul 25, 2019 at 4:03 PM

Hi Steve,

I'm just contacting you to confirm that I have now carried out all of the relevant initial consultations for the proposals at Park Road, Worsbrough.

The following departments have been contacted and have made these comments:

**HIGHWAYS** – No issues with the positioning of the monuments would not affect any sightlines.

**PARKS SERVICES** – Wanted to stress that all maintenance and upkeep for anything that is positioned on the land as part of the agreement, will be the responsibility of the group. Additionally, they wanted to ensure that the positioning of any items on the land did not impede the grounds maintenance team when cutting the grass on the land i.e. not to leave awkward shaped sections of land that are hard to get around with a mower.

**NORTHERN POWERGRID** – No objections subject to there being no permanent structures placed on the route of any cables, no structures hindering access to the cables or the substation and no structures being placed within 2 metres of the substation which could potentially act as a climbing aid.

**PLANNING** – They have suggested that in principle they have no objections to the proposals. Planning have stated that you will need to submit a formal planning application as this land is designated as greenspace in the local plan and therefore any 'development' requires a formal application. They have also asked that you contact Ed Jowett (edwardjowett@barnsley.gov.uk) to arrange a tree survey on the land.

Once you have had further conversations with planning please contact me to discuss the outcome and we will take it from there.

Kind regards

**Adam Carratt**

**Student Surveyor**

Assets – Regeneration & Property – Place Directorate

Tel: 01226 774828

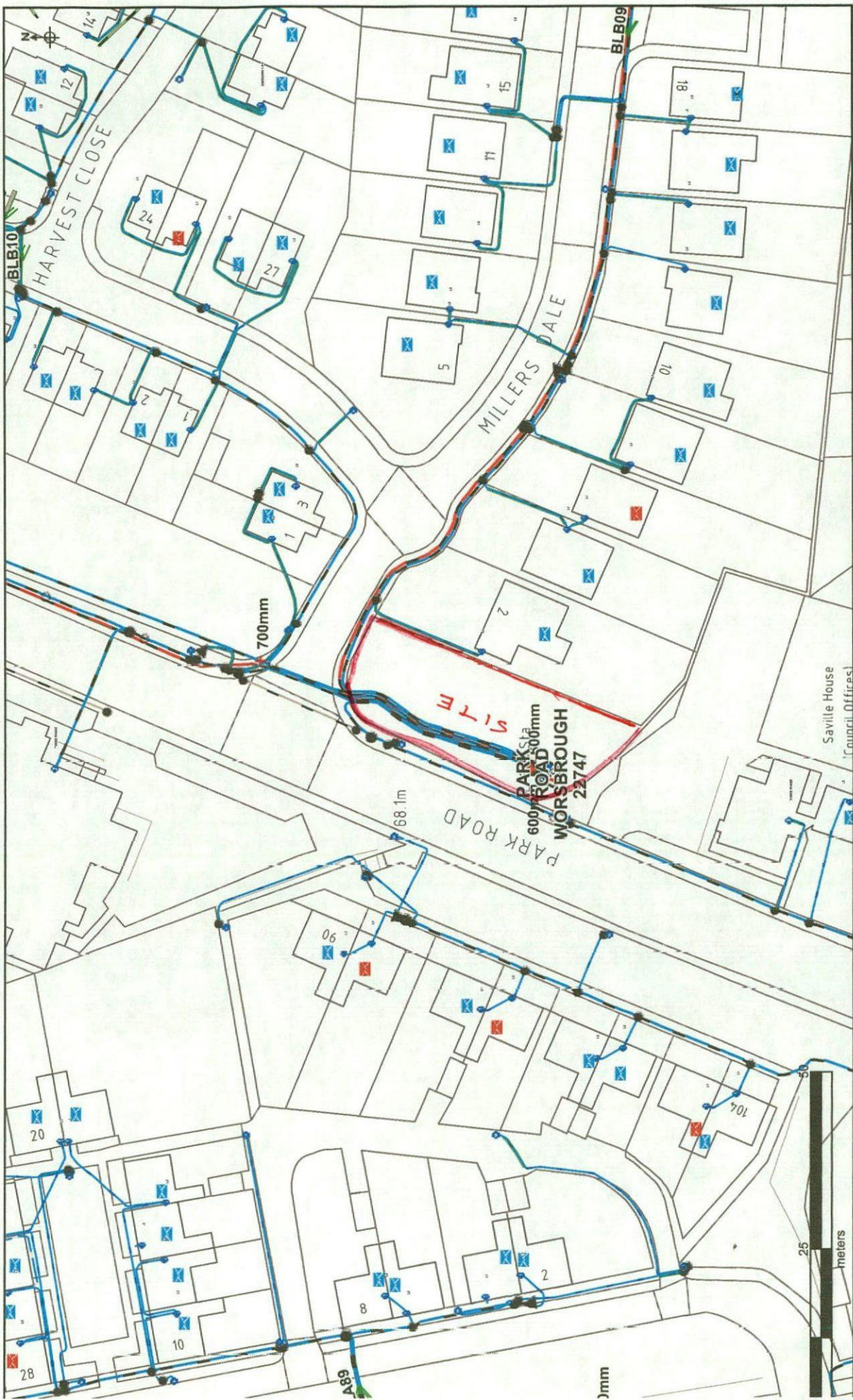

**NORTHERN  
POWERGRID  
MAINS RECORD**

OS Grid Reference: SE3526003754

Printed By: peter.liddle

Title:  
Monument

Original Print Size A3

Legend:

- |                      |          |            |                          |                               |            |            |            |            |            |            |     |
|----------------------|----------|------------|--------------------------|-------------------------------|------------|------------|------------|------------|------------|------------|-----|
| Underground Cables:  | 20kV     | 11kV       | 6.6kV                    | 3.3kV                         | 25kV       | 25kV       | 25kV       | 13.2kV     | 11kV       | 8kV        | 3kV |
|                      | LV Mains | LV Service | LV Service Assumed Route | LV Service Logical Connection | LV Service | LV Service | LV Service | LV Service | LV Service | LV Service | Aut |
|                      | 20kV     | 11kV       | 6.6kV                    | 3.3kV                         | 25kV       | 25kV       | 25kV       | 13.2kV     | 11kV       | 8kV        | 3kV |
|                      | Aut      | Aut        | Aut                      | Aut                           | Aut        | Aut        | Aut        | Aut        | Aut        | Aut        | Aut |
| Overhead Conductors: | 20kV     | 11kV       | 6.6kV                    | 3.3kV                         | 25kV       | 25kV       | 25kV       | 13.2kV     | 11kV       | 8kV        | 3kV |
|                      | 20kV     | 11kV       | 6.6kV                    | 3.3kV                         | 25kV       | 25kV       | 25kV       | 13.2kV     | 11kV       | 8kV        | 3kV |
|                      | Aut      | Aut        | Aut                      | Aut                           | Aut        | Aut        | Aut        | Aut        | Aut        | Aut        | Aut |

Cell Centre Phone Numbers: if the area is located in: North East call 2800 668877, Yorkshire or North Lines call 2800 375675

**Northern Powergrid Holdings Company**  
 The position of our equipment is shown on the plan as accurately as possible. It may have changed since the plan was produced. Therefore the position of our equipment and those services which may not be shown should be established on site. Electricity cables not owned by Northern Powergrid Holdings Company may be laid in this area and may not be shown on this plan. For more information on our services and equipment, please contact our Customer Services Department. For guidance purposes only. In all cases, accurate information should be obtained from the owner of such cables prior to the commencement of work on site.

Reference should be made to HSE Guidance, HSE/GM47 'Avoiding Danger from Underground Services' and G57 'Avoidance of Danger from Overhead Power Lines'.

Reproduced from a base map by Ordnance Survey map by Northern Powergrid Holdings Company by permission of Ordnance Survey on behalf of the Controller of Her Majesty's Stationery Office. Crown (S) Copyright (Northern Powergrid Holdings Company: E118031761 and E118032857).

Date Printed: 07-Dec-2018  
 Scale: 1: 500