

- Notes
1. New connection to be confirmed by Yorkshire Water. A connection must not exceed the overall allowable discharge area of the network.

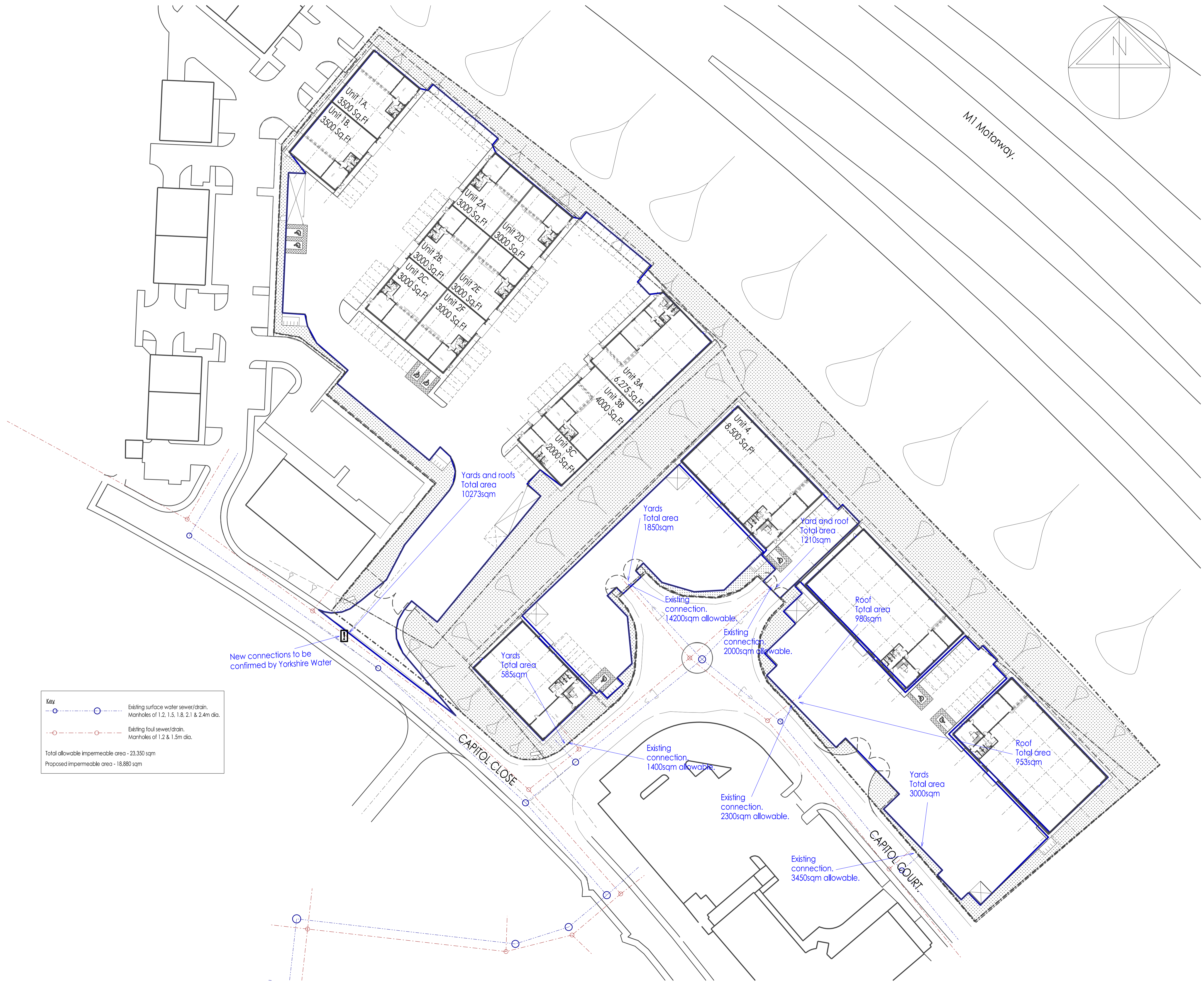

Key

- Existing surface water sewer/drain. Manholes of 1.2, 1.5, 1.8, 2.1 & 2.4m dia.
- Existing foul sewer/drain. Manholes of 1.2 & 1.5m dia.

Total allowable impermeable area - 23,350 sqm
Proposed impermeable area - 18,880 sqm

Rev	Description	Drm	Vf'd	Date
C	Revised Entrance	WD		07.17
B	Revised Drainage Layout	WD		06.17
A	Revised Drainage Layout	WD		06.17

As outlined in section 2.3 of the CIB Industry Guidance to Designers, insignificant risks can usually be ignored, as can risks arising from routine construction activities, unless the design compounds or significantly alters these risks. In accordance with CDM Regulations 8, 9 and 11, any significant risks relating to the design features shown on this drawing have been identified and are annotated thus:

No significant risks have been identified.
 Significant risks have been identified - refer to notes on drawing for information on residual risks and any control measures to be employed.

Refer to the current Designer's Risk Assessment sheets for further details.

Designer's Signature: WD Date: 06/2017

Drawing Status: SKETCH

williamsaunders
architecture: engineering: building consultancy

Sheppard Lockton House
Cafferata Way
Newark-on-Trent
Nottinghamshire, NG24 2JN

Tel: 01636 704361
Fax: 01636 702809
W: wms-saunders.co.uk

Also at Leeds, Cardiff, Wiroksworth

Project: Proposed Development, Capitol Park, Barnsley.

Client: Carnell Management Services Ltd.

Title: Indicative Drainage Areas

Drawn: WD	Date: June 2017	Scale: 1:500	@ A1
Discipline: Civils	Project Number: 11548	Drawing Number: (D)101	Revision: C