

- Notes
1. Preliminary drainage layout, subject to change during detailed design.
Oil interceptor siting and spec. to be based on area drained.
 2. Discharge is not limited by flow rate, only discharge area, for details refer to drawing D101.
 3. New foul and surface water connections to Capitol Close to be confirmed by Yorkshire Water. Correspondence indicates a connection is possible at an unrestricted discharge rate unless the overall network area is increased.

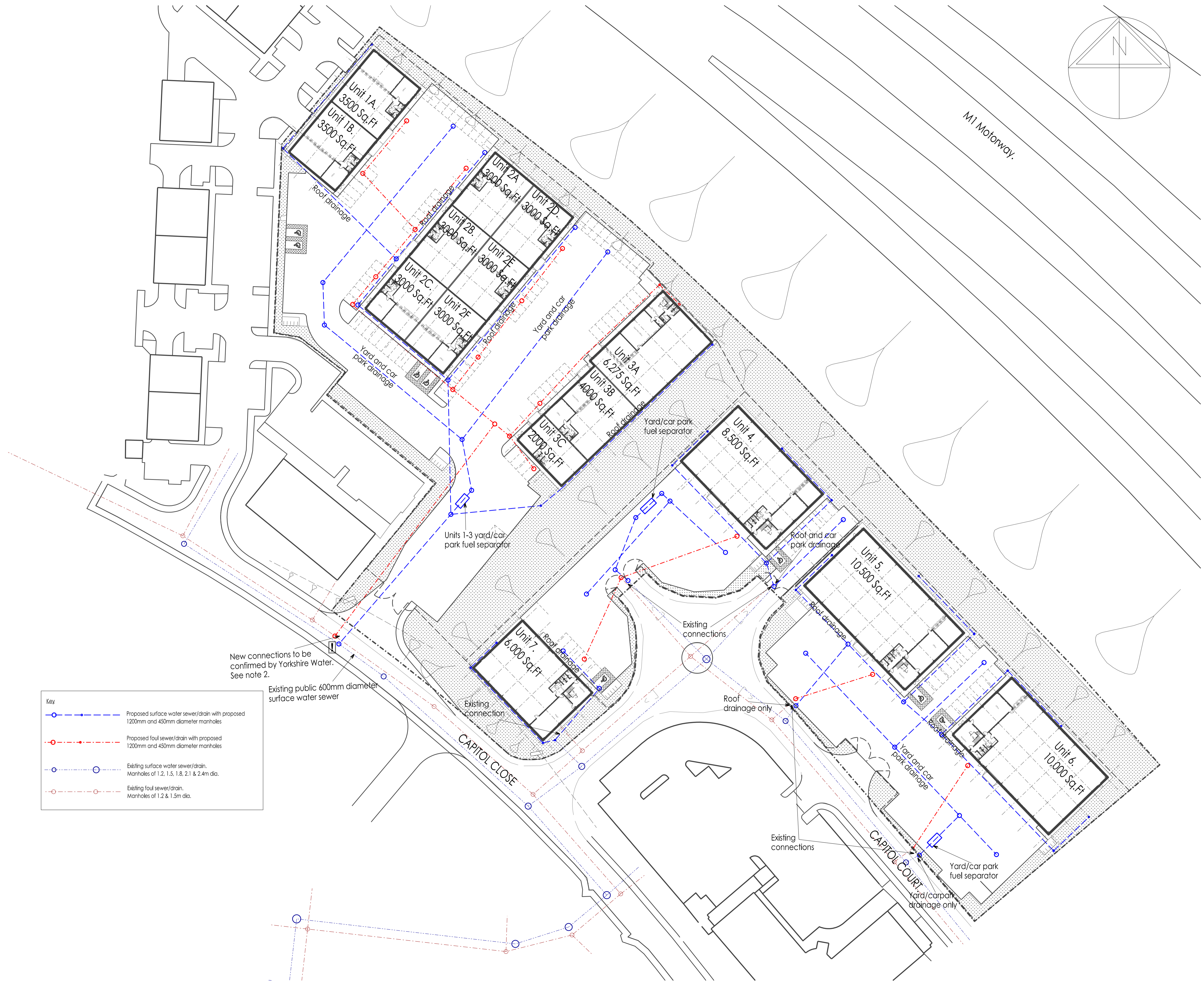
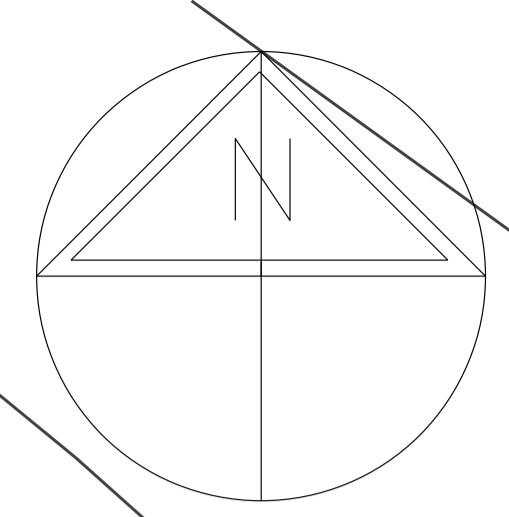

Key

	Proposed surface water sewer/drain with proposed 1200mm and 450mm diameter manholes
	Proposed foul sewer/drain with proposed 1200mm and 450mm diameter manholes
	Existing surface water sewer/drain. Manholes of 1.2, 1.5, 1.8, 2.1 & 2.4m dia.
	Existing foul sewer/drain. Manholes of 1.2 & 1.5m dia.

New connections to be confirmed by Yorkshire Water. See note 2.

Existing public 600mm diameter surface water sewer

C	Revised Entrance	WD	07.17
B	Revised Drainage Layout	WD	06.17
A	Revised Drainage Layout	WD	06.17

Rev	Description	Drm	Vf'd	Date
As outlined in section 2.3 of the CIB Industry Guidance to Designers, insignificant risks can usually be ignored, as can risks arising from routine construction activities, unless the design compounds or significantly alters these risks. In accordance with CDM Regulations 8, 9 and 11, any significant risks relating to the design features shown on this drawing have been identified and are annotated thus:				
<input checked="" type="checkbox"/>	No significant risks have been identified.			
<input type="checkbox"/>	Significant risks have been identified - refer to notes on drawing for information on residual risks and any control measures to be employed.			
Refer to the current Designer's Risk Assessment sheets for further details.				
Designer's Signature		WD	Date 06/2017	

Drawing Status SKETCH

williamsaunders
 architecture: engineering: building consultancy
 Sheppard Lockton House Tel: 01636 704361
 Cafferata Way Fax: 01636 702809
 Newark-on-Trent
 Nottinghamshire, NG24 2JN W: wms-saunders.co.uk
 Also at Leeds, Cardiff, Warkworth

Project Proposed Development, Capitol Park, Barnsley.			
Client Carnell Management Services Ltd.			
Title Indicative Drainage Layout			
Drawn WD	Date June 2017	Scale 1:500	@ A1
Discipline Civils	Project Number 11548	Drawing Number (D)100	Revision C