

Drawing status

Drawn by AP	Size A1	Scale 1:50
Notes	Status	Rev Date
PRELIMINARY STUDY	P	-
Amendments:	P	A 10.03.21
Dims added for the setting out of D01.		

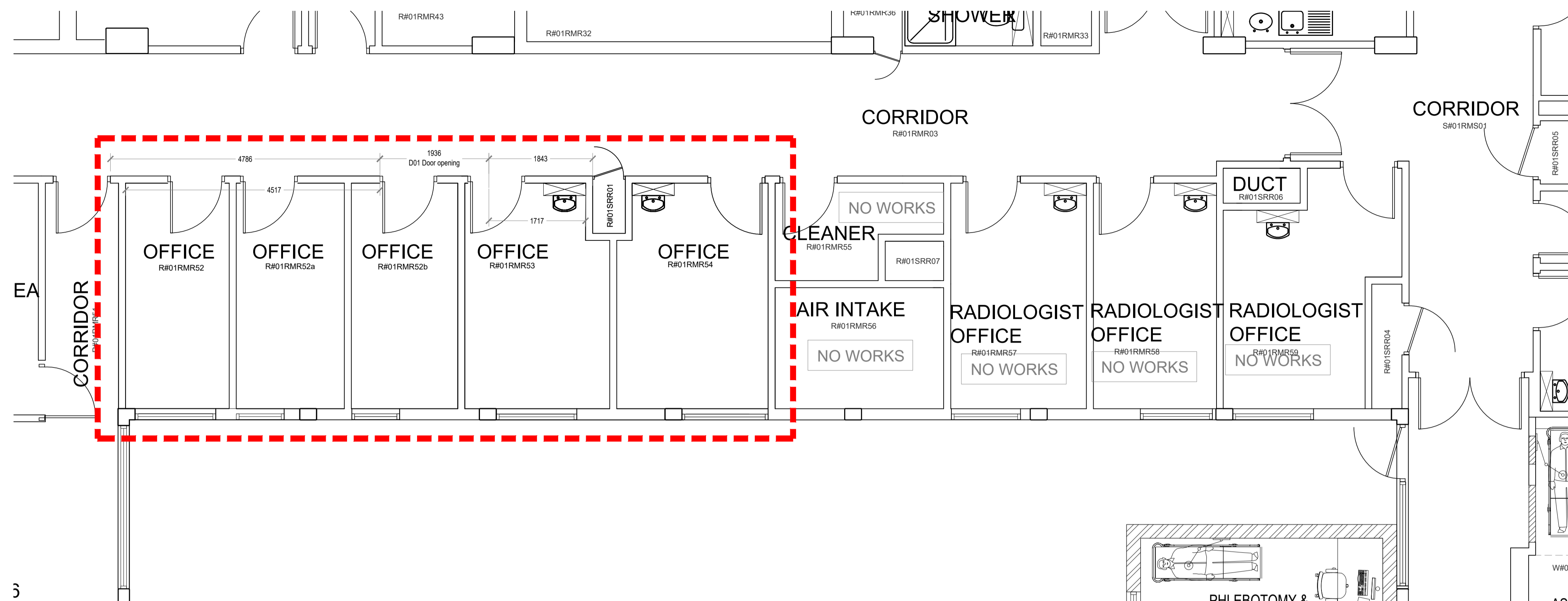

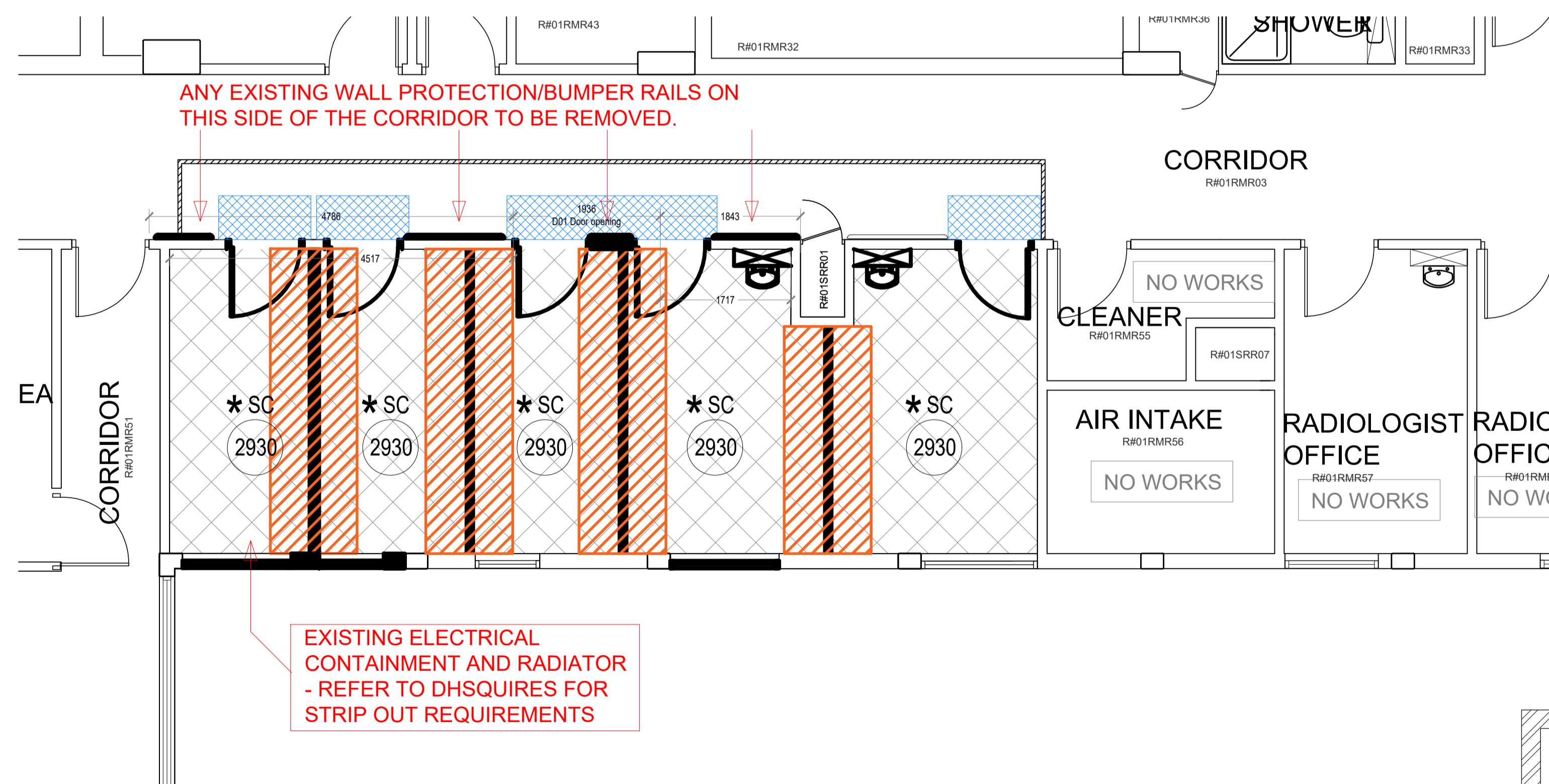







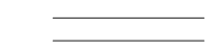

PLAN AS EXISTING  
1:50



DEMOLITION PLAN  
1:50

DEMOLITION NOTES

-  DENOTES POSITION OF CONTRACTOR PROVIDED TEMPORARY SEALED FIRE RETARDANT SCREENING.  
FOR SCREEN DETAILS PLEASE REFER TO **NBS L10 135**  
NOTE: SCREENS ARE NOT TO OBSTRUCT FIRE ESCAPE ROUTES.
-  DENOTES AN AREA FOR CONTRACTORS 'STICKY MATS' (TO BE CHANGED REGULARLY)  
REFER TO **NBS L10 650**
-  DENOTES EXISTING WALL **TO BE RETAINED**
-  DENOTES EXISTING WALL **TO BE DEMOLISHED** OR NEW OPENING TO BE FORMED.
-  AT ALL POINTS WHERE A DEMOLISHED MASONRY OR PARTITION WALL ABUTTS A RETAINED WALL CONTRACTOR IS TO ALLOW FOR ALL RETAINED SURFACES TO BE MADE GOOD WITH PLASTER AND SKIM.
-  **\* SC**  
DENOTES EXISTING MODULAR SUSPENDED CEILING AND TILES TO BE REMOVED. INCLUDE FOR REMOVING ALL HANGERS, SUPPORTS AND SHADOW BATTENS. MAKE GOOD TO DISTURBED WALL AND CEILING PLASTER AS REQUIRED TO REINSTATE.  
NOTE: AREAS WITH SUSPENDED CEILING HAVE SLOPING TIMBER BULKHEAD AT WINDOW LOCATIONS. THIS BULKHEAD IS TO BE REMOVED AND EXISTING PLASTERED SOFFIT MADE GOOD AND REINSTATE AS REQUIRED. PLASTERED SOFFIT TO RECEIVE NEW PLASTER SKIM FINISH AND PAINT DECORATION.  
NOTE: EXISTING CEILINGS ARE A COMBINATION OF MODULAR SUSPENDED GRID AND TILES AND PAINTED PLASTER TO UNDERSIDE OF BEAM AND BLOCK CEILING.
-  DENOTES AREA OF EXISTING FLOORING (CARPET/VINYL FLOOR FINISH) AND SKIRTINGS TO BE REMOVED.
-  REMOVE FLOOR FINISH AND OBSOLETE ADHESIVE AND LATEX LEVELLING COMPOUND WITH MECHANICAL MEANS AS REQUIRED TO EXPOSE EXISTING SCREED SUBSTRATE. EXISTING SCREED TO BE RETAINED AND PREPARED TO RECEIVE NEW LEVELLING COMPOUND AND SURFACE DPM PRIOR TO NEW FLOOR FINISH.  
NOTE: THE QUALITY OF THE EXISTING SCREED IS UNKNOWN.  
REMOVE EXISTING TIMBER (IF PRESENT) / COVERED SKIRTINGS. MAKE GOOD EXISTING PLASTER FINISH PRIOR TO DECORATION AS (4-) DRAWINGS
-  DENOTES EXISTING DOORSET TO BE REMOVED. EXISTING OPENING TO BE RETAINED UNLESS OTHERWISE STATED.  
**IN LOCATIONS WHERE EXISTING DOOR REMOVED AND NEW DOOR INSERTED INTO EXISTING OPENING CONTRACTOR TO ALLOW FOR ADJUSTING THE STRUCTURAL OPENING TO SUIT THE NEW DOOR.**
-  DENOTES ALLOWANCE OF EXISTING SCREED (ASSUMED THICKNESS 50mm. NOT KNOWN. CONTRACTOR TO INVESTIGATE) TO BE REMOVED AND REPLACED TO CATER FOR ANY LEVEL DIFFERENCES WHERE EXISTING WALL DEMOLISHED.  
ALLOW AT TENDER STAGE FOR 50mm STRIP EACH SIDE OF DEMOLISHED WALL.  
ALLOW FOR REPLACING WITH WORKS AS DESCRIBED IN ARDEX SPECIFICATION.  
PLEASE NOTE THAT IF THE FLOOR FINISH LEVEL DOES NOT DIFFER ON SITE WHERE THIS NOTE CORRESPONDS TO, THE WORKS SHOULD BE OMITTED IN THIS LOCATION (WE ARE NOT ANTICIPATING THAT THE FLOOR LEVELS WILL BE DIFFERENT IN THIS AREA AND THEREFORE THIS ITEM WILL PROBABLY NOT BE REQUIRED).
- EXACT SCOPE OF WORKS TO BE ON SITE WITH ARCHITECT & ARDEX FURTHER TO DEMOLITION OF EXISTING WALLS; ALLOW TIME IN PROGRAMME FOR SPECIFICATION CONFIRMATION.  
PLEASE REFER TO **NBS C20 115 AND NBS M10 130**

Drawing status annotation  
P-Preliminary T-Tender D-Design (post preliminary) C-Construction As-As Built

Client

BARNSELY HOSPITAL NHS  
FOUNDATION TRUST

Project title

MODULAR MRI

Project no

170/032

Drawing title

EXISTING FLOOR PLAN  
AND DEMOLITION PLAN

Drawing no

(S-)01

Status

P

Revision

A