

**Whitcher Wildlife Ltd.  
Ecological Consultants.**



**LESMOND CRESCENT, MIDDLECLIFFE**

**OS REF: SE 43231 05030**

**BIODIVERSITY ENHANCEMENT AND  
MANAGEMENT PLAN.**

**Ref No: 250358/BEMP.**

**Date: 8<sup>th</sup> April 2025.**

## **TABLE OF CONTENTS.**

---

	Page Number
<b>1. INTRODUCTION.</b>	<b>3</b>
<b>2. SUMMARY OF BASELINE RESULTS.</b>	<b>4</b>
<b>3. SUMMARY OF POST DEVELOPMENT HABITATS.</b>	<b>8</b>
<b>4. ON SITE BIODIVERSITY AND ENHANCEMENT MANAGEMENT PLAN DETAIL.</b>	<b>10</b>
<b>5. MONITORING.</b>	<b>11</b>

# 1. INTRODUCTION.

1.1. There are plans to construct five residential dwellings with parking and gardens in an area of land off Lesmond Crescent, Middlecliffe

1.2. The following condition has been received by Barnsley Metropolitan Borough Council:

*'Prior to commencement of development secured by condition, Biodiversity Enhancement Management Plan (BEMP) detailing the long-term management of the ecological mitigation in the approved Preliminary Ecology Appraisal (Ref:210906/Rev 1), Ecological Impact Assessment (210906/Rev1), Hedgerow Advice Note (Ref: 16785b/DK) and the accompanying Biodiversity Metric 3.0, along with the Landscape Masterplan, shall be submitted to and approved in writing by the Local Planning Authority. The development shall be implemented in accordance with the approved details.*

*Reason: To conserve and enhance biodiversity in accordance with Local Plan BIO1 Biodiversity and Geo Diversity and the SPD's Biodiversity and Geodiversity, and Trees and Hedgerows.'*

1.3. Therefore, Whitcher Wildlife Ltd were commissioned to undertake a Biodiversity Enhancement and Monitoring Plan to satisfy this condition.

\*\*\*\*\*

## **2. SUMMARY OF BASELINE RESULTS.**

2.1. The survey area comprised an area c.0.24 hectares of land off Lesmond Crescent in the hamlet of Middlecliffe (Grid Reference: SE 43231 05030). The site is surrounded by residential housing to its western and southern boundaries and arable agricultural land to the east and north. The red line boundary of the site is shown on the aerial map below.



2.2. An ecological impact assessment of the site was undertaken by Whitcher Wildlife in September 2021. Below is an overview of the findings of that survey.

2.3. The prior survey was undertaken using the JNCC Phase I Habitat Survey Methodology. The habitats on and adjacent to the site include:

- Amenity grassland
- Fence
- Hedgerow
- Short ephemeral
- Neutral grassland

2.4. The survey area primarily comprised neutral grassland, with two small areas of amenity grassland to the north and south of the habitat. A strip of amenity grassland extends from the south of the neutral grassland, and within the survey area are some patches of ephemeral/ short perennial. The site is bordered by intact hedgerows and fencing. The photographs below highlight the current habitats within the survey area.



2.5. The map below show the baseline habitats on the development site.



2.6. Biodiversity calculations for the extension area were initially carried out using the Biodiversity Metric 3.1, which was the appropriate metric at the time of writing the report.

2.7. The total Baseline Biodiversity Units on the site are shown in the table below.

Habitat	Area (Ha)	Condition	Connectivity	Biodiversity value
Amenity Grassland	0.01	Poor	Low	0.02
Short Ephemeral	0.02	Poor	Low	0.05
Neutral Grassland	0.21	Poor	Low	0.97
Total				1.04

2.8. In addition, the hedgerows provide additional linear habitat Biodiversity Value of 0.437 habitat units as shown in the table below.

Habitat	Length (Km)	Condition	Connectivity	Biodiversity value
Native Hedgerow	0.095	Moderate	Low	0.437
Total				0.437

\*\*\*\*\*



### 3. SUMMARY OF POST DEVELOPMENT HABITATS.

3.1. The plan below shows the proposed restoration plan for the site.

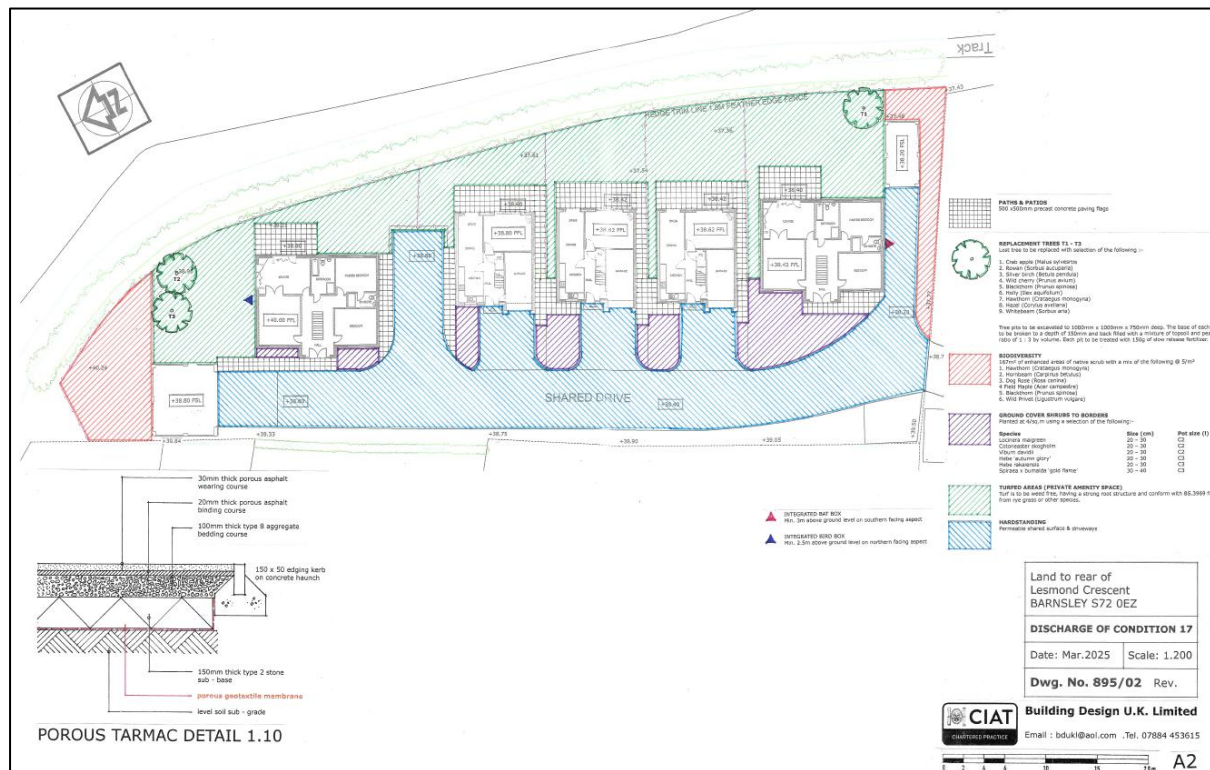

3.2. The proposed landscaping for the site focuses on converting the area of land off Lesmond Crescent into residential housing with adjoining gardens.

3.3. The 2021 proposals outlined an area of land c.167m<sup>2</sup> that will be set aside to create mixed scrub habitat, in addition to the retention of existing hedgerow habitats. This is beneficial as established native hedgerows are a priority habitat listed on the NERC Act 2006.

### 3.4. Post Restoration Biodiversity Values

3.4.1. According to most recent plans c.167m of land will be set aside to plant mixed scrub habitat as reflected in the BNG calculations below.

3.4.2. The table below outlines the resultant biodiversity value of the site once the proposed development has been implemented.



Habitat	Area (Ha)	Condition	Connectivity	Biodiversity value
Urban developed land	0.12	N/A-Other	Low	0.00
Urban-vegetated Garden	0.1033	Poor	Low	0.23
Mixed Scrub	0.0167	Moderate	Low	0.14
Total				0.37

3.4.3. As there is no provision at present to make changes to the linear habitat on site the biodiversity value of linear features will remain the same as the baseline condition.

Habitat	Length	Condition	Connectivity	Biodiversity value
Hedgerow	95m	Moderate	Low	0.437
Total				0.437

3.4.4. The final results provide an overall decrease in ‘area habitats’ biodiversity units (Bu) from the established baseline values, whilst linear biodiversity units are to remain the same. Area habitat values decline from a Biodiversity Value of 1.04 Bu to 0.37 Bu post-development. No change has been proposed to the value of the hedgerow habitat which will retain its biodiversity value of 0.437Bu.

\*\*\*\*\*

## **4. ON SITE BIODIVERSITY AND ENHANCEMENT MANAGEMENT PLAN DETAIL.**

### ***4.1. Native Hedgerow – Retained***

The client has confirmed that all hedgerows on site will be retained, ensuring that it maintains a ‘Moderate’ condition and that connectivity throughout the site is retained. As such, no specific management is required other than to ensure that the hedgerow is maintained as it currently exists, ensuring that it is not reduced in height or width.

### ***4.2. Urban Developed Land – Created***

The creation of 0.12ha of Urban Developed Land will not contribute to any biodiversity units to the site therefore there is no requirement for a management plan to cover this habitat.

### ***4.3. Urban Vegetated Garden – Created***

4.3.1. The gardens for the new properties will either be turfed with a standard garden lawn turf or seeded with a standard lawn seed mix. No condition assessment is required for this habitat as it is fixed at ‘Poor’ and no management plan is required.

4.3.2. There will be no control over the future maintenance of the garden habitats once the properties are sold, and although there is a possibility that some homeowners may remove the soft landscaping features, there is also high probability of some homeowners planting their own shrubs and plants as well as install features to attract wildlife species such as birds and insects, which will enhance the value of the garden habitat. Overall, it is assessed that this will balance out and these garden habitats will be retained long term.

### ***4.4. Mixed Scrub – Created***

4.4.1. Approximately 0.0167 ha of mixed scrub will be created within the habitat as per the previous restoration plans. This will include the planting of native species and have a target condition of ‘moderate’. The table below demonstrates which criteria will be met to ensure this habitat meets ‘moderate’ condition.

Condition Assessment Criteria		Criterion passed (Yes or No)
A	<p>The scrub is a good representation of the habitat type it has been identified as, based on its UKHab description (where in its natural range). The appearance and composition of the vegetation closely matches the characteristics of the specific scrub type.</p> <p>At least 80% of scrub is native, and there are at least three native woody species<sup>1</sup>, with no single species comprising more than 75% of the cover (except hazel <i>Corylus avellana</i>, common juniper <i>Juniperus communis</i>, sea buckthorn <i>Hippophae rhamnoides</i> or box <i>Buxus sempervirens</i>, which can be up to 100% cover).</p>	<b>Yes.</b> At least three native woody species will be planted.
B	Seedlings, saplings, young shrubs and mature (or ancient or veteran <sup>2</sup> ) shrubs are all present.	<b>Yes.</b> Initial planting will include species of varying ages to encourage a diverse age range.
C	There is an absence of invasive non-native plant species <sup>3</sup> (as listed on Schedule 9 of WCA <sup>4</sup> ) and species indicative of sub-optimal condition <sup>5</sup> make up less than 5% of ground cover.	<b>Yes.</b> Any non-native plant species identified will be eradicated, any species indicative of sub-optimal conditions will also be removed.
D	The scrub has a well-developed edge with scattered scrub and tall grassland and or forbs present between the scrub and adjacent habitat.	<b>No.</b> The area dedicated to this habitat will not allow space for this.
E	There are clearings, glades or rides present within the scrub, providing sheltered edges.	<b>No.</b> The area dedicated to this habitat will not allow space for this.
Number of criteria passed		
Condition Assessment Result (out of 5 criteria)	Condition Assessment Score	Score Achieved ×/✓
Passes 5 criteria	Good (3)	
Passes 3 or 4 criteria	Moderate (2)	✓
Passes 2 or fewer criteria	Poor (1)	

\*\*\*\*\*

## 5. MONITORING.

Due to the proposed habitats on site being insignificant, no monitoring is proposed.

\*\*\*\*\*

Prepared by:	
Frances Teasdale BSc	Date: 9 <sup>th</sup> April 2025

Checked by:	
Ruth Georgiou BSc MCIEEM	Date: 13 <sup>th</sup> April 2025