

SITE LAYOUT.
Scale.

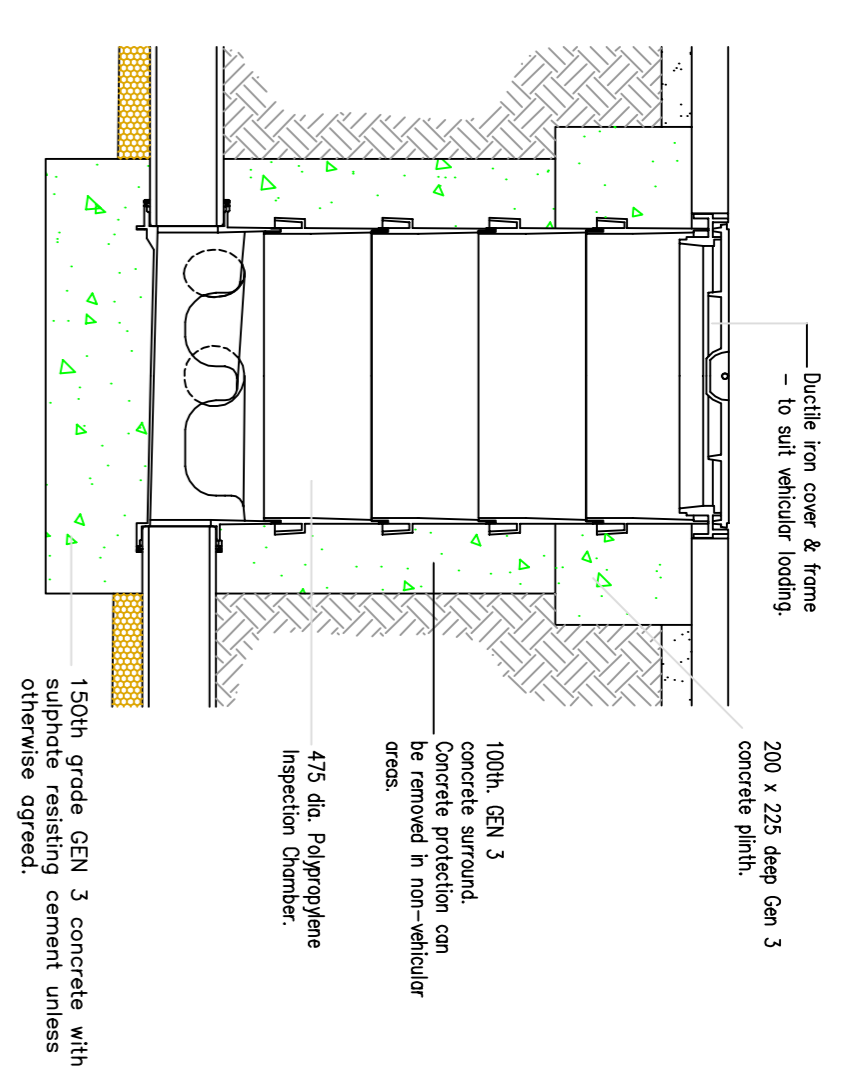

TYPICAL INSPECTION CHAMBER DETAIL.
Sited in driveways / hard landscaped areas

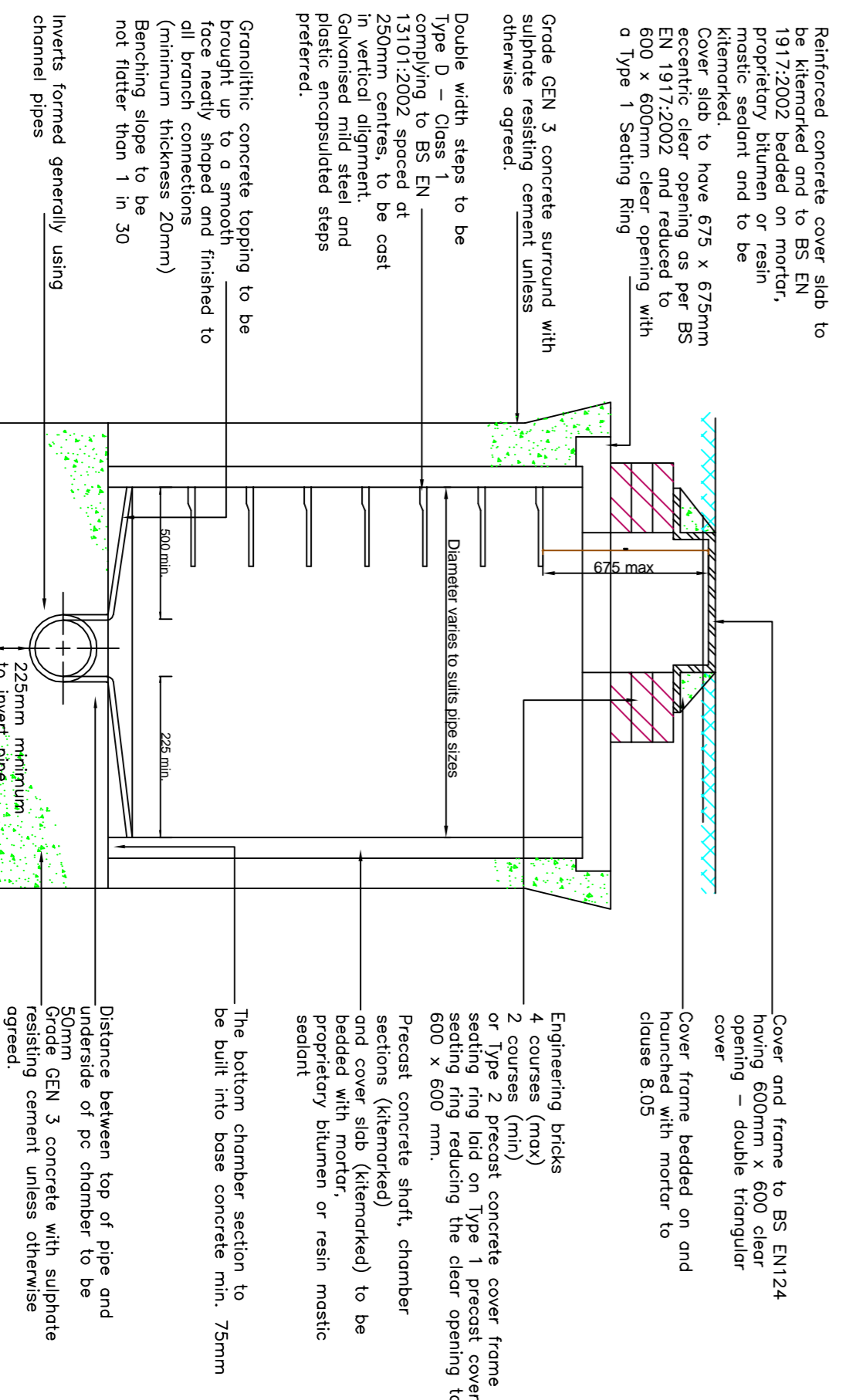

TYPICAL MANHOLE DETAIL - TYPE B'.
Scale = 1/20

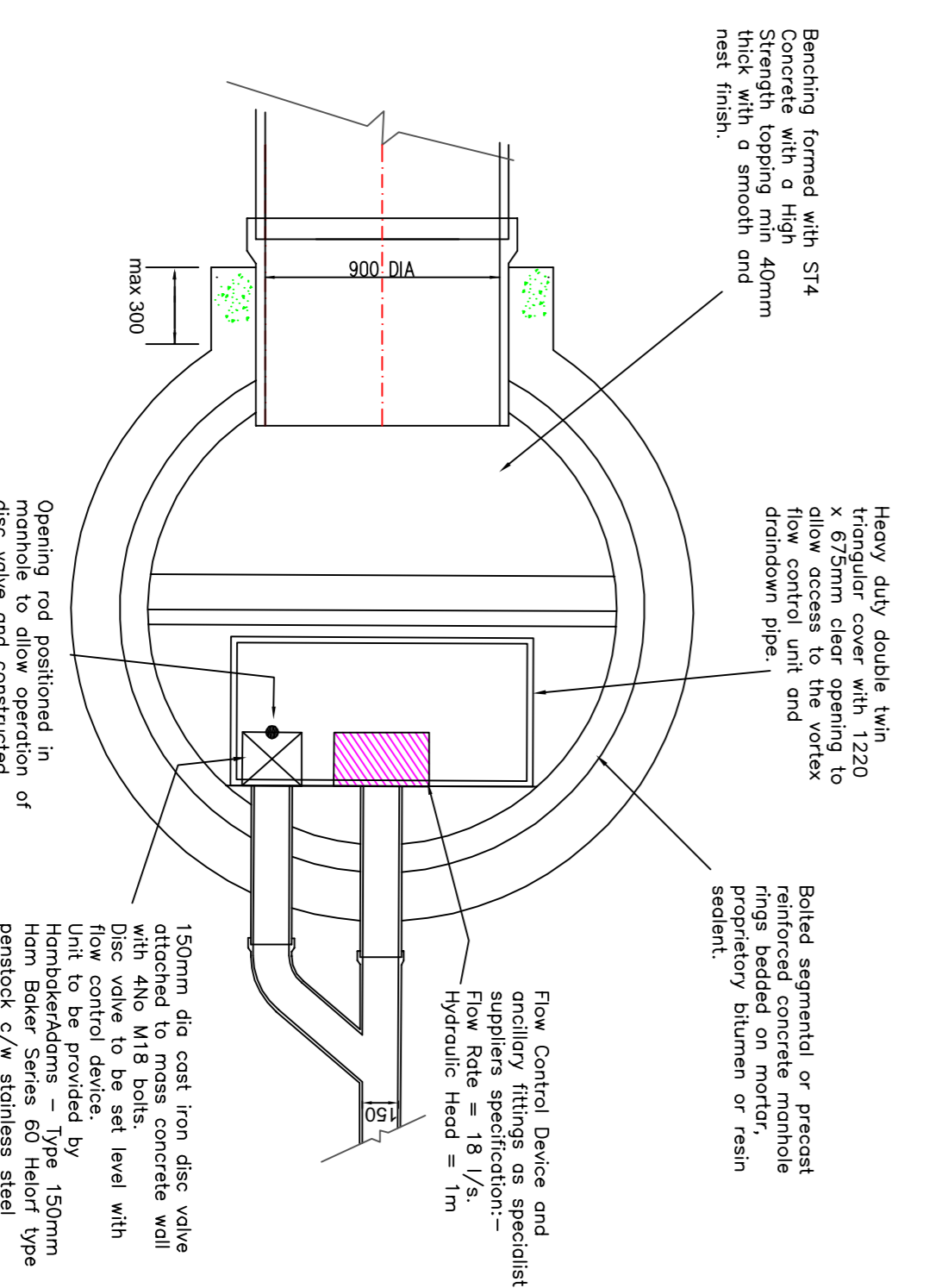

PLAN [Flow Control]

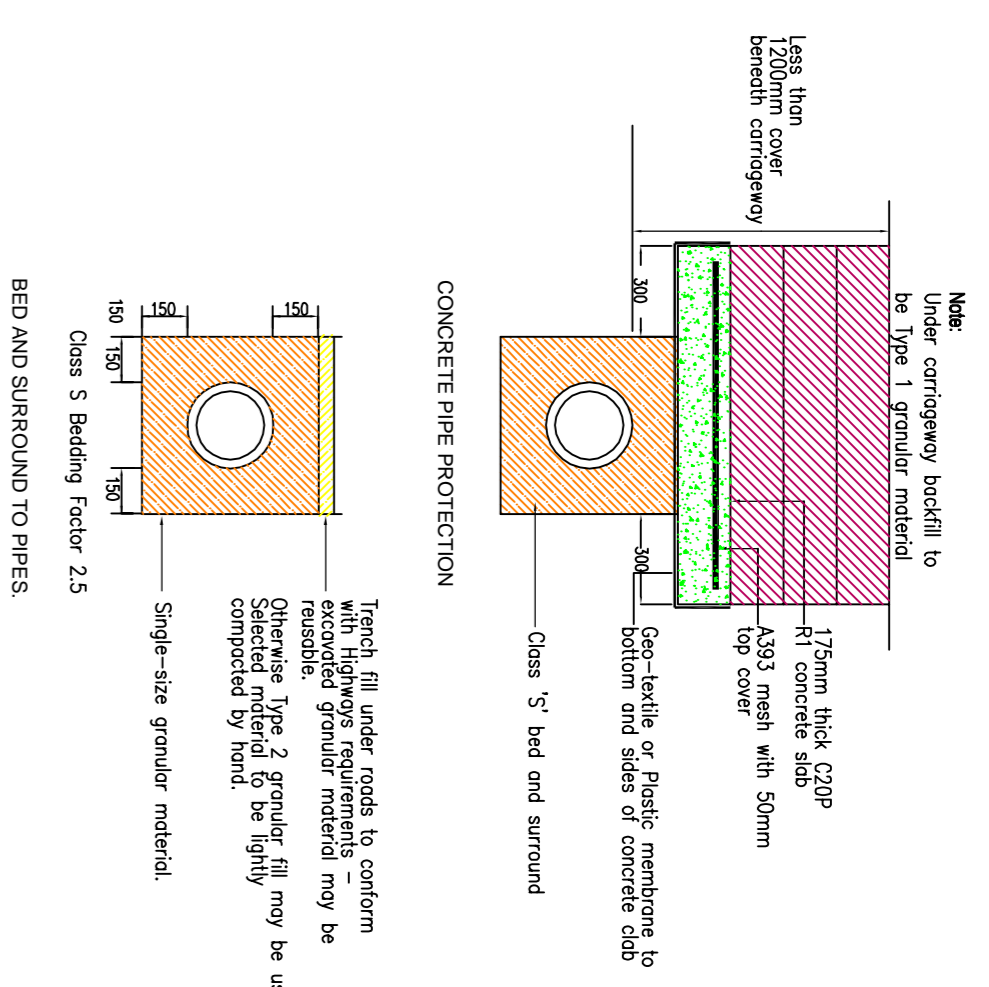

Bedding Class	200mm dia	300mm dia	400mm dia	500mm dia	600mm dia	750mm dia	900mm dia	1050mm dia	1200mm dia
Class 1	10	10	10	10	10	10	10	10	10
Class 2	10	10	10	10	10	10	10	10	10
Class 3	10	10	10	10	10	10	10	10	10
Class 4	10	10	10	10	10	10	10	10	10
Class 5	10	10	10	10	10	10	10	10	10
Class 6	10	10	10	10	10	10	10	10	10
Class 7	10	10	10	10	10	10	10	10	10
Class 8	10	10	10	10	10	10	10	10	10
Class 9	10	10	10	10	10	10	10	10	10
Class 10	10	10	10	10	10	10	10	10	10

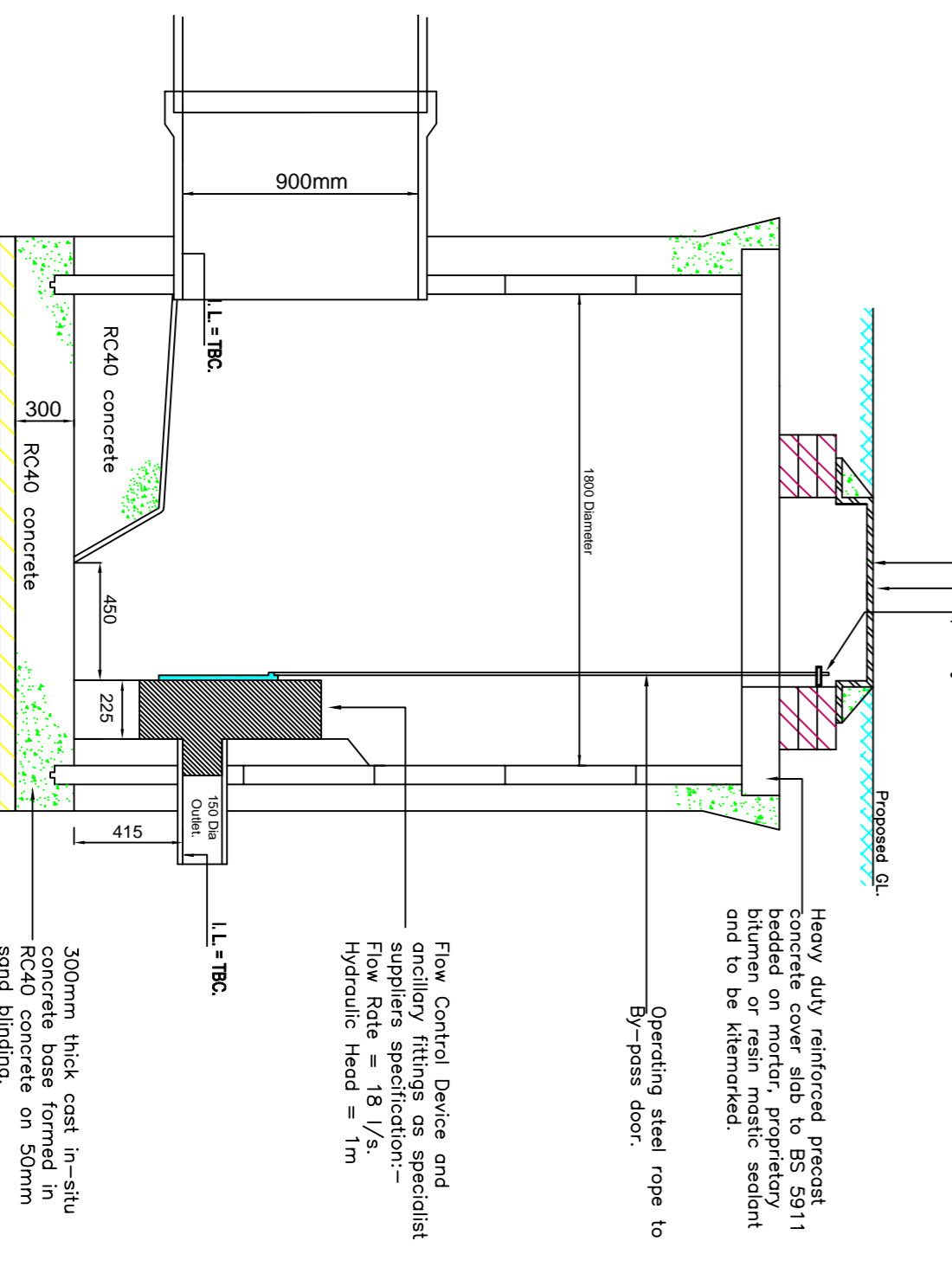

FLOW CONTROL MANHOLE AS YWS ADOPTION' - 6th EDITION.
Scale = 1/20

Discharge of Conditions.

UNDERGROUND SERVICES.

All sewerage details have been produced in accordance with the requirements of Yorkshire Water Services Limited on the opening Water Authority in this case. The drawings, standard details and construction details provide contractual guidance for the contractor to execute the works in compliance with the National Water Council - Sewers for Adoption and Yorkshire Water Adoption 6th Edition. Failure and surface water side branches to connect at development sites will be provided to the pipe diameters specified and laid at self cleaning gradients in each case.

All adoptable sewer works and materials to be in accordance with 'Sewers for Adoption 6th Edition' and the relevant British/European and Yorkshire Water Standards/Requirements/Adendum/Amendment.

Multiple covers shall/frost from a clear opening of 600mm and shall be Class D400 to BS EN 124 with 150mm deep frames in highways.

Final ground must be filled and consolidated under the supervision and to the satisfaction of Yorkshire Water before any sewer works are carried out.

Yorkshire Water is not obliged to accept filter drain/land drainage run-off into the public sewer network or adoptable drainage system (directly or indirectly). Any such run-off must be collected and disposed of in accordance with the National Water Council - Sewers for Adoption and Yorkshire Water Adoption 6th Edition.

Open sides shall carry the BS 5911 standard of all be replaced by W8 brackets. Where these clear openings of the Kitemarked product of different to that of the cover and frame, a load bearing slab should be fitted above the cover slab to bring the slab down to 600mm x 600mm for the W8 specified cover size. These shall be to the CP4 Technical Bulletin issued Autumn 2004 for Kitemarked cover size.

Adoptable sewer pipes to be laid in maximum 3 metre heights unless there is a specific operational need for any longer heights.

Bedding and backfill material to conform to the requirements of MS 4-08-02 (Table A2)

Public channel actions in manholes are not acceptable - W8 require dryway/concrete channel actions in manholes.

The chamber slab of manholes with more than one connection in them may need to be increased on treatment to accommodate the connections and bends.

Yorkshire Water policy is not to accept Type 'C' block manholes and 1000mm dia circular manholes, unless it is preferred that the use of Type B5 manholes is preferred. The use of Type B5 manholes is preferred over the use of Type B1 manholes. The depth of cover to the chamber where the depth of cover to the pipe soffit is 1 - 1.5 metres.

All bed and surface water side branches may be adopted to the final demonstration chamber and constructed as above.

The contractor is advised that services consisting of Cables, Ducts, Sewers and Manholes Street, and the contractor will be responsible for locating, supporting and protecting all services for the duration of the works.

The whole of the sewerage works are to be completed to the entire satisfaction of the Employer and on completion the contractor must leave the entire site clean and returned to the previous condition which will include all public highways and adjoining land that may have been disturbed at any time.

Any reference to the Highways Agency Specification shall mean the latest edition of Volume 1 of the Highways Manual of Contract Documents for Highways Works.

All trench bedfall will be Type 1 granular sub-base or B72 material complying with Table 6/1 of the Highways Agency Specification.

Rev	Date	Comments	By	CHK
B	18/01/17	W8S speed flow rate included.		ML
A	21/10/16	Storage amended.		ML

Project
RESIDENTIAL DEVELOPMENT,
WENTWORTH STREET.

Project
L. D. A. Ltd.
(Civil and Transportation)
CIVIL ENGINEERING & DESIGNMENT CONSULTANTS
P. O. Box 4091,
Sheffield,
S25 9EU.
Tel: 0114 266 1075
email: ml@lodgeandpartners.co.uk

Title
SEWERAGE DETAILS.
(Discharge of Conditions Only)

Scale
1:500 @ A1
1:500 @ A1
1:500 @ A1

Date
15/01/16
15/01/16
15/01/16

Job No
989100C
989100C
989100C

Dwg No
01
01
01

Rev
B
A
A