

ELEVATIONS SCALE 1:100

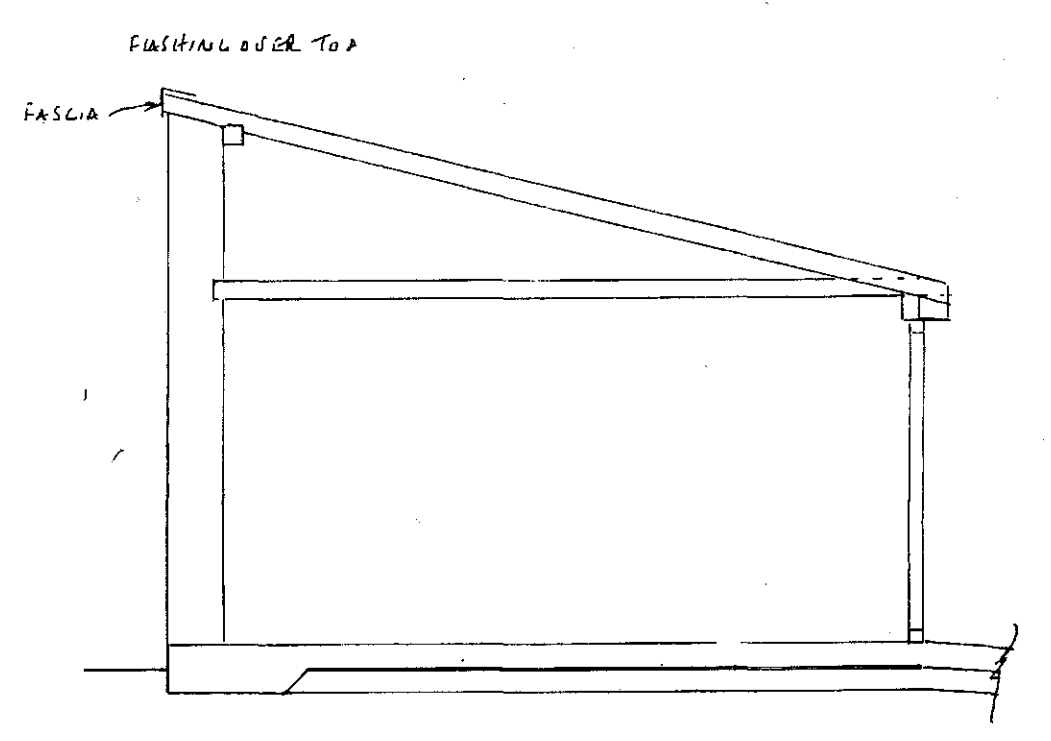
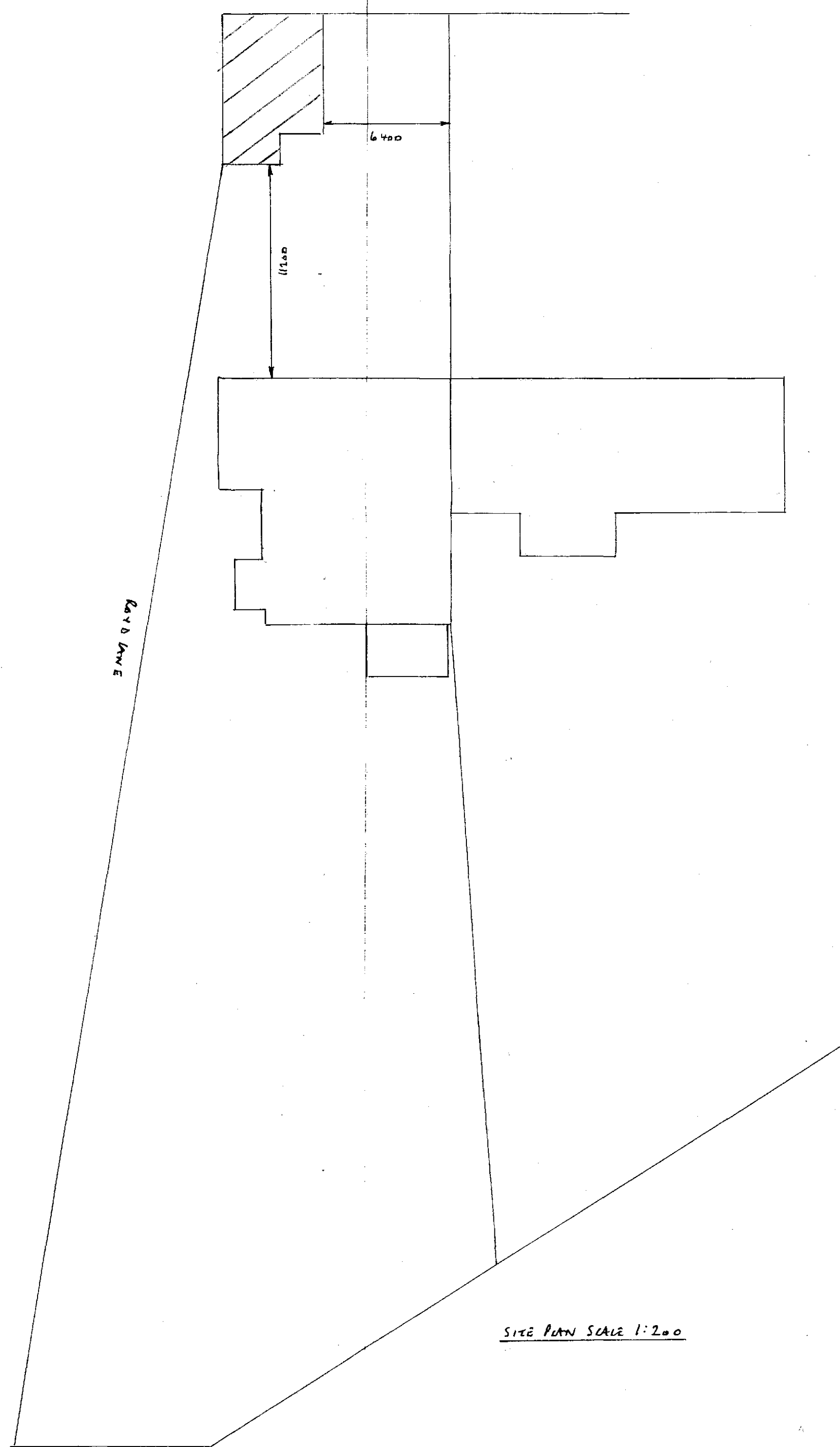
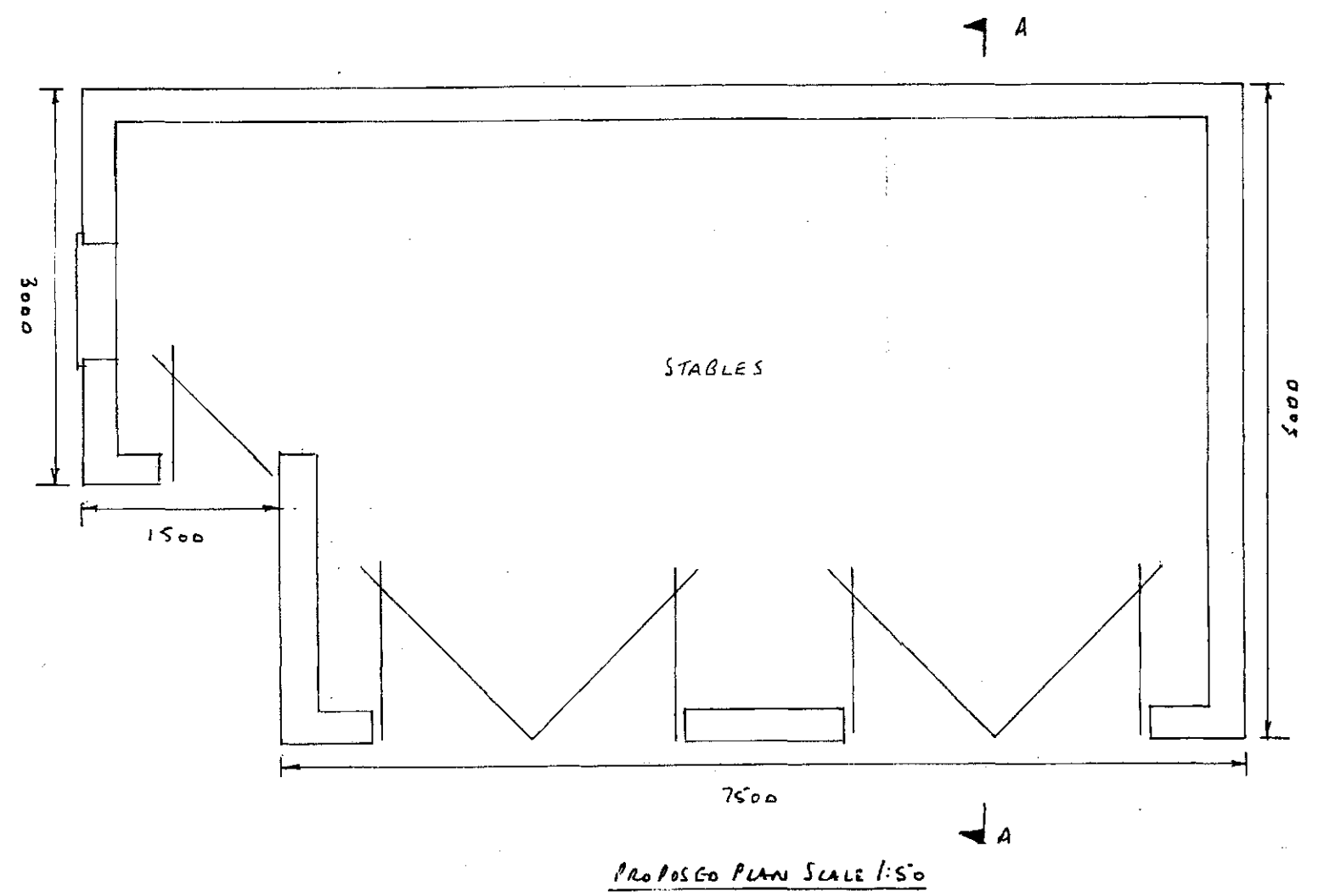

- FOUNDATION/FLOOR
- 150mm CONCRETE HARBING
  - 25mm SAND BEDDING
  - 1200 GAUGE VISQUEEN DPM
  - 150mm CONCRETE THICKENED TO 300mm AROUND PERIMETER
- WALLS
- STONEWORK TO MATCH EXISTING
  - 100mm LW LIME BRICKS
  - STAINLESS STEEL TIEBARS PALED 750mm HORIZONTALLY 450mm VERTICALLY & 225mm TO REVERS
  - DPL 150mm ABOVE G.L.
  - CN 71 LINTELS OVER EXTERNAL OPENINGS
- Roof
- 100 x 50mm WALL PLATE
  - 100 x 75mm WALL PLATE SECURED TO EXISTING WITH RAWL BOLTS EVERY METRE
  - 195 x 47 CEILING JOISTS AT 400mm CENTRES
  - 195 x 45mm RAFTERS AT 400mm CENTRES
  - 1m HOLDING DOWN STRAPS EVERY 3 RAFTERS
  - 1m LATERAL RESTRAINT STRAPS EVERY 1.5m TO HORIZONTAL 'LUTUPS' WITH MORGANS TO SECURE
  - 200 x 25mm FASCIA
  - 6mm EXTERIOR PLY SHEET
  - REINFORCED BITUMEN FELT
  - 28 x 25mm TILE BATTENS
  - ROOF TILES TO MATCH SURROUNDING AREA
- DRAINAGE
- 100mm RUP & 65mm RUP TO MATCH EXISTING
  - SW TO CONNECT TO SW DRAIN OR TO A SOAKAWAY 5m AWAY FROM BUILDING & 1m<sup>2</sup> BELOW INVERT LEVEL
- GENERAL
- ALL ELECTRICAL WORK TO COMPLY WITH PART P ELECTRICAL SAFETY & MUST BE DESIGNED, INSTALLED, INSPECTED & TESTED BY A COMPETENT PERSON REGISTERED UNDER THE COMPETENT PERSON SCHEME. A COPY OF THE BUILDING REGS SELF CERTIFICATE IS TO BE GIVEN TO THE LA ON COMPLETION OF THE WORKS

12 MAY 2017

PROPOSED DETACHED STABLES AT:  
 ROYD HILL FARM  
 ROYD LANE  
 HILHAM, BARNSLEY