

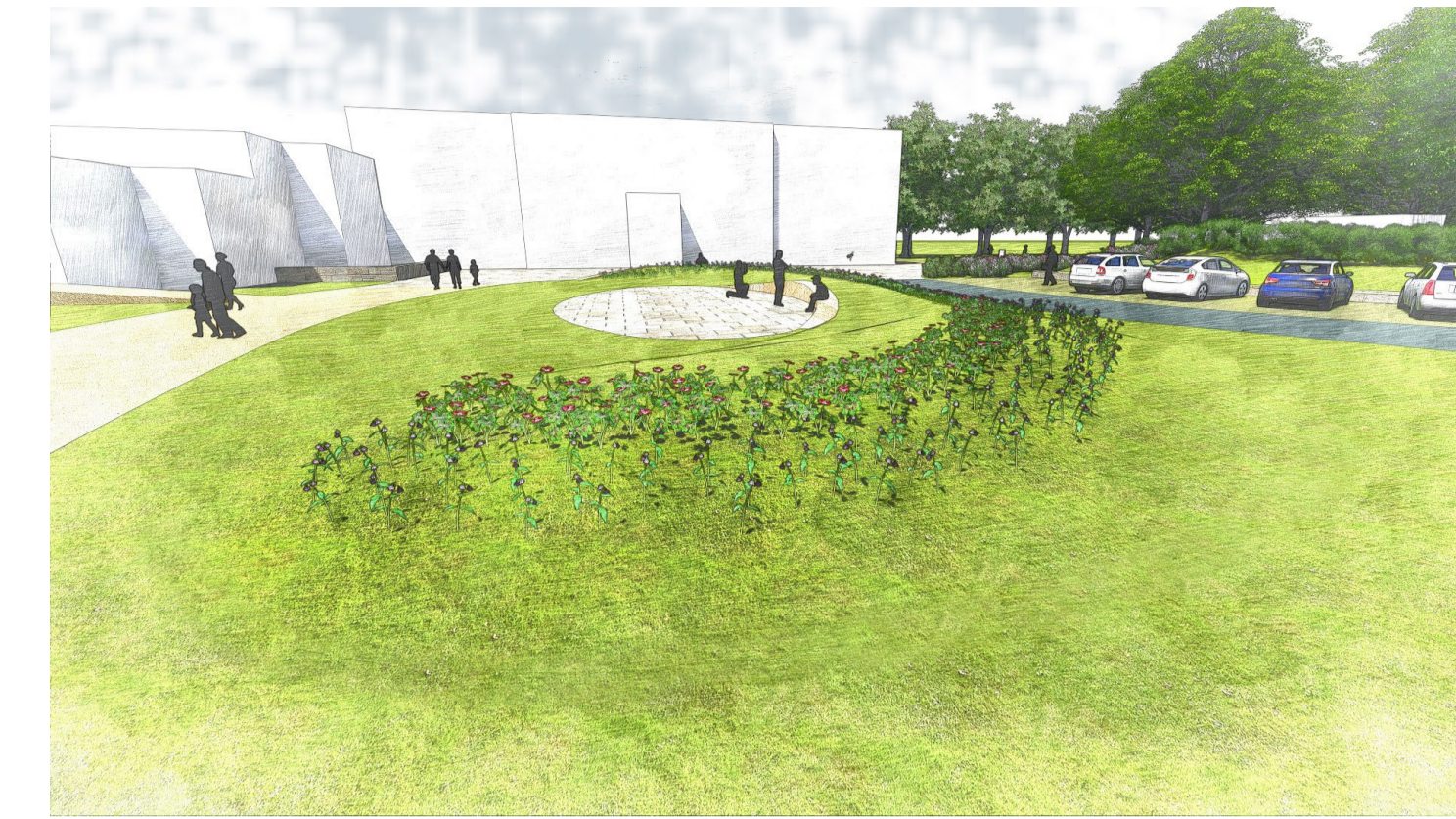

1. View from road looking over the grass mounding to the museum



2. Eye level view walking down the proposed footpath towards the museum



3. Exiting the hall with views onto interpretive seating



4. Views driving into proposed disabled parking

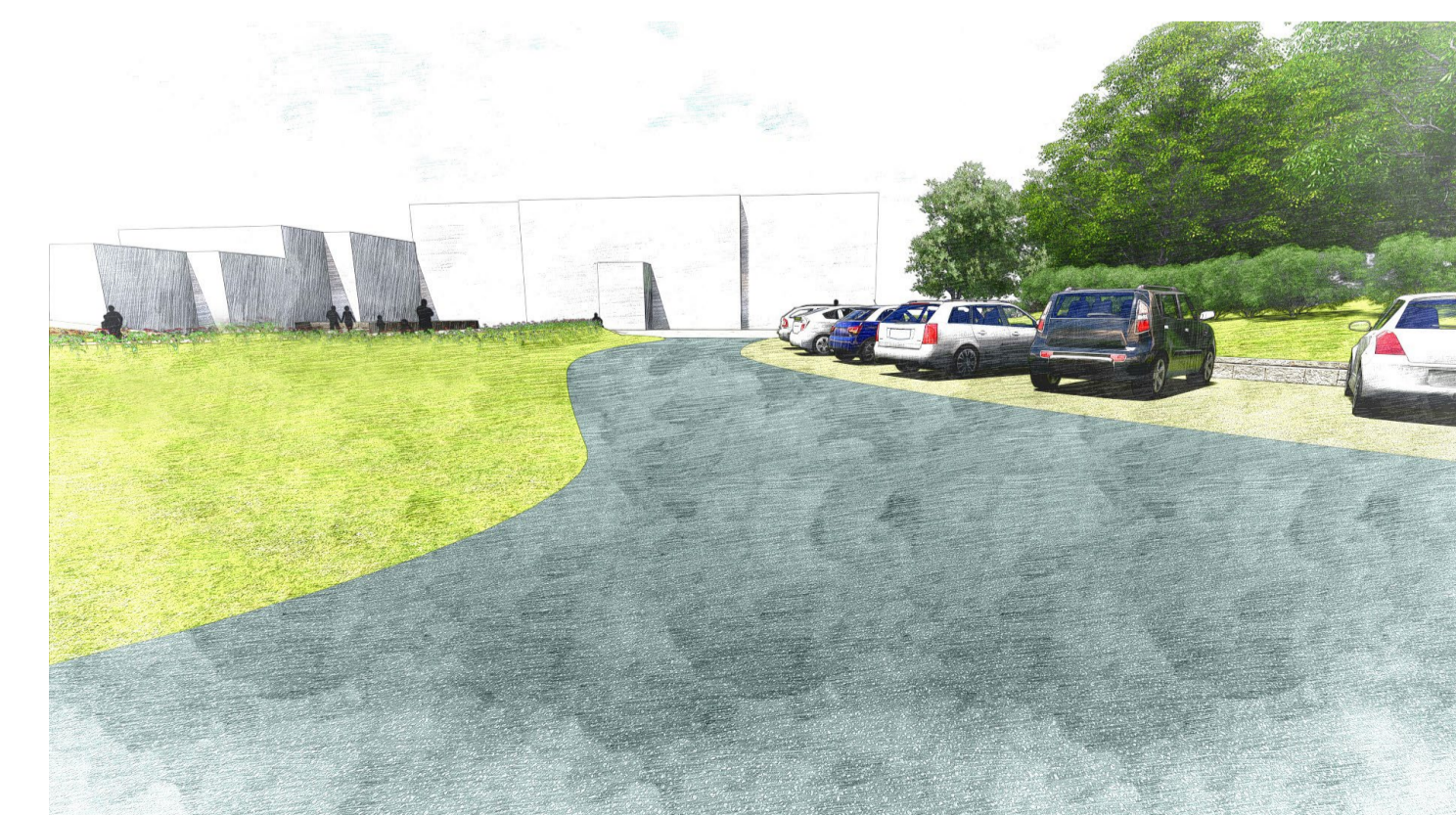

Hard Landscape

- Yorkstone paving**
Material: Grey Greenmoore Rustic Yorkstone paving
Size: 600mm x random lengths x 65mm thick
Laying pattern: Transverse stretcher bond
Ref Drawing CHP_PLI_S2_DR_SW5_0810 Detail 04
- Vehicular grade resin bound gravel**
Proposed honey coloured resin bound gravel to footpath surface and South Terrace
Ref Drawing CHP_PLI_S2_DR_SW5_0810 Detail 03
- Grasscrete parking**
Pre-grown modular reinforced grass
Bays edged in 100x100 silver granite setts
Bays divided using geo synthetic parking markers
Ref Drawing CHP_PLI_S2_DR_SW5_0810
- Stone feature wall**
Extracts of history carved into the sandstone wall
Material: Buff Diamond sawn York stone
Edge: 10mm rounded edge
Ref view 3
Ref Drawing CHP_PLI_S2_DR_SW3_0804

- Vehicular grade tarmac**
Edge: 100x100 silver granite setts
Ref Drawing CHP_PLI_S2_DR_SW5_0810
- Pedestrian grade hoggin footpath**
Improved access to the historic midden
Ref Drawing CHP_PLI_S2_DR_SW5_0810 Detail 01
- Pedestrian grade resin bonded footpath**
Resin bonded surface to footpaths joining the South Terrace
Ref Drawing CHP_PLI_S2_DR_SW5_0810 Detail 02
- Disabled parking bays**
Bay Size: 6.1 x 5.6m
Granite setts to define edge of bays
Ref view 3

Soft Landscape

- Extension to existing stone retaining wall**
Length of extension: 10500mm
Height: 400mm
- Removable bollards**
Epping Hardwood Timber Bollards
Ref drawing CHP_PLI_S2_DR_SW3_0804
- Base for future Marquee**
27000 x 9000mm
Honey coloured resin bound gravel to marquee base
Resin bound gravel to have hardwood timber edging
- Yorkstone setts**
Buff to grey



DRAWING NOTES:

- GENERAL:**
- COPYRIGHT OF THIS DRAWING IS VESTED IN PLINCKE AND IT MUST NOT BE COPIED OR REPRODUCED WITHOUT CONSENT.
 - DO NOT SCALE FROM THIS DRAWING - DIMENSIONS GOVERN. IF IN DOUBT ASK!
 - ALL DIMENSIONS ARE IN MILLIMETRES UNLESS NOTED OTHERWISE. ONLY FIGURED DIMENSIONS ARE TO BE TAKEN FROM THIS DRAWING.
 - ALL DIMENSIONS SHALL BE VERIFIED ON SITE BEFORE PROCEEDING WITH THE WORK. ALL CONTRACTORS MUST VISIT SITE AND BE RESPONSIBLE FOR TAKING AND CHECKING ALL DIMENSIONS RELATIVE TO THEIR WORK.
 - PLINCKE SHALL BE NOTIFIED IMMEDIATELY BY EMAIL OF ANY DISCREPANCIES.
 - PLINCKE ACCEPTS NO LIABILITY FOR ANY EXPENSE, LOSS OR DAMAGE OF WHATSOEVER NATURE AND HOWEVER ARISING FROM ANY VARIATION MADE TO THIS DRAWING OR IN THE EXECUTION OF THE WORK TO WHICH IT RELATES WHICH HAS NOT BEEN REFERRED TO THEM AND PRIOR APPROVAL OBTAINED.
 - ALL PLINCKE DRAWINGS TO BE READ IN CONJUNCTION WITH ALL RELEVANT ARCHITECTURAL, CAS ENGINEERS AND MSE ENGINEERS DRAWINGS AND SPECIFICATIONS.

REFERENCE FILES:

1. THIS DRAWING IS BASED ON THE FOLLOWING EXTERNAL CONSULTANTS DRAWINGS

| CONSULTANT | REFERENCE FILE | DATE RECEIVED |
|------------|----------------|---------------|
| | | |

HEALTH, SAFETY & ENVIRONMENTAL INFORMATION:

- IT IS ASSUMED THAT ALL WORKS ON THIS DRAWING WILL BE CARRIED OUT BY A COMPETENT CONTRACTOR AND, WHERE APPROPRIATE, WORKING TO AN APPROVED METHOD STATEMENT.
- THIS DRAWING IS TO BE READ IN CONJUNCTION WITH ALL OTHER HAZARDS / RISKS WHICH HAVE BEEN IDENTIFIED AND RECORDED WITHIN THE PRE-CONSTRUCTION INFORMATION PACK AND / OR THE CONSTRUCTION PHASE H&S PLAN.
- IN ADDITION TO THE HAZARDS / RISKS NORMALLY ASSOCIATED WITH THE TYPES OF WORK DETAILED ON THIS DRAWING, NOTE THE FOLLOWING:

ITEM N° RISK REGISTER DETAILS

P01 PLANNING PROPOSALS SS AA 05/05/16

| REV | DESCRIPTION | DRAWN | CHECK | DATE |
|-----|-------------|-------|-------|------|
| | | | | |

KEY PLAN



plincke.

MANCHESTER t: 0161 237 9223 e: north@plincke.co.uk
LONDON t: 0207 739 3330 e: london@plincke.co.uk

PROJECT TITLE
CANNON HALL PARKS FOR PEOPLE

DRAWING TITLE
FORECOURT: LAYOUT/HARD LANDSCAPE

PROJECT No. 0292 DRAWING No. CHP_PLI_S2_DR_LC1_0220

SCALE BAR @ 1:250

SCALE @ A1 1:200

DATE 05/05/16

REVISION P01

0 2.5 5.0 12.5 22.5m