

N O T E S.

TREE SCHEDULE TO BE REMOVED.

- 1. T1 FLOWERING CHERRY.
- 2. T2 LAYLANDI
- 3. T3 NOT KNOWN
- 4. T4 NOT KNOWN
- 5. T5 LAYLANDI
- 6. T6 NOT KNOWN.

ALL THE ABOVE IN POOR CONDITION GROWING WILD. - SCRUB.

A FRONT EXTENSION REQUIRED IN SIZE TO MATCH EXISTING.
 PLANTING SCHEME ADDED TO REAR BOUNDARY WITH NOTES.
 TEMPORARY FENCE AND PLANTING ADDED TO FRONT BOUNDARY WITH NOTES.
 ELECTRONIC FRONT GATE ADDED.
 PROPOSED BRICK FRONT BOUNDARY WALL REMOVED.

MAY 28

| REF. | REVISION. | DATE. |
|------|-----------|-------|
| | | |

SITE PLAN AND LOCATION PLAN.

PROPOSED REAR AND FRONT EXTENSIONS AND DORMER BEDROOMS AT 24 ST. JOHNS AVENUE BARNUGH GREEN BARNLSLEY, S75 1NX FOR MR & MRS. S. BALL.

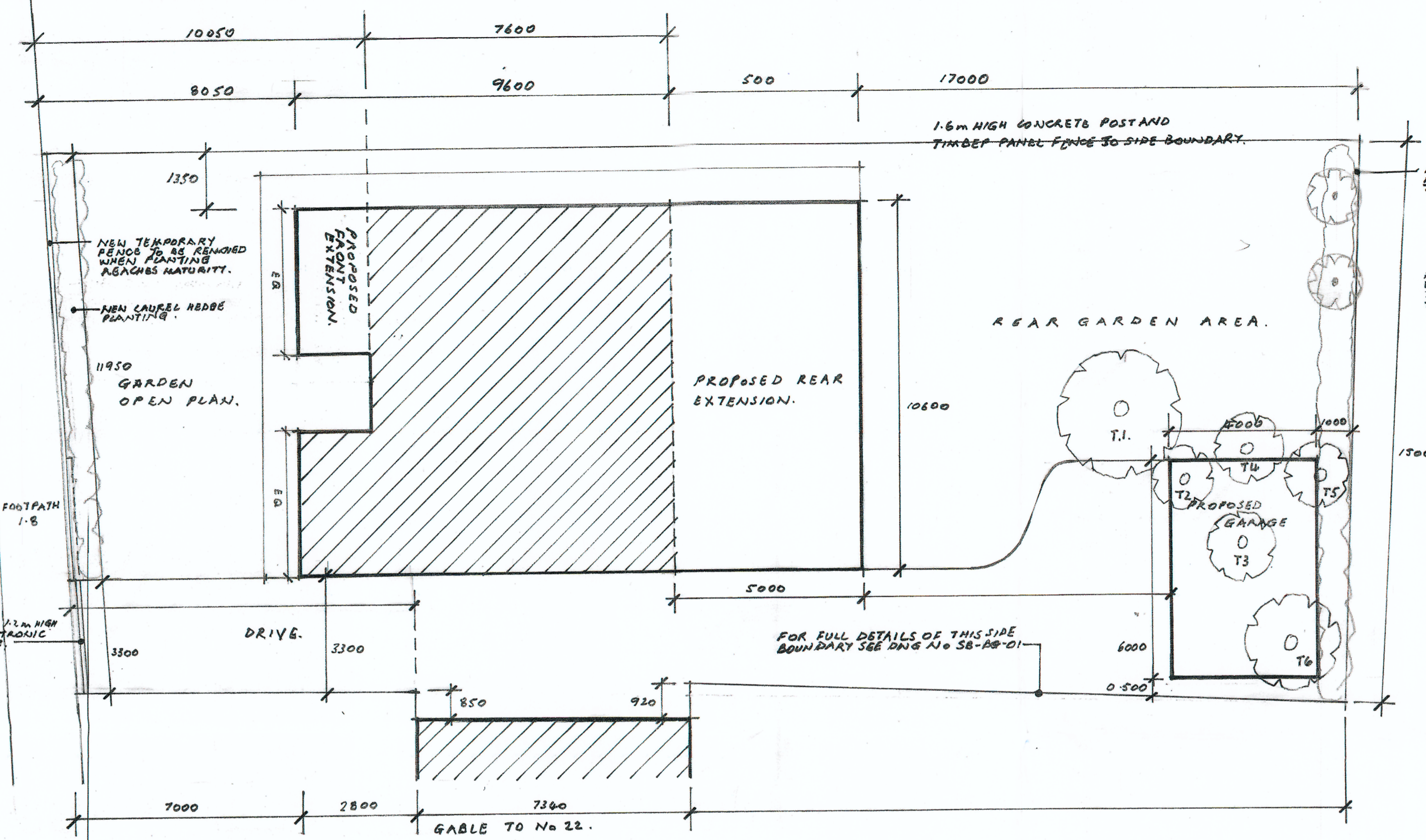

S I T E P L A N SCALE:- 1/100th.

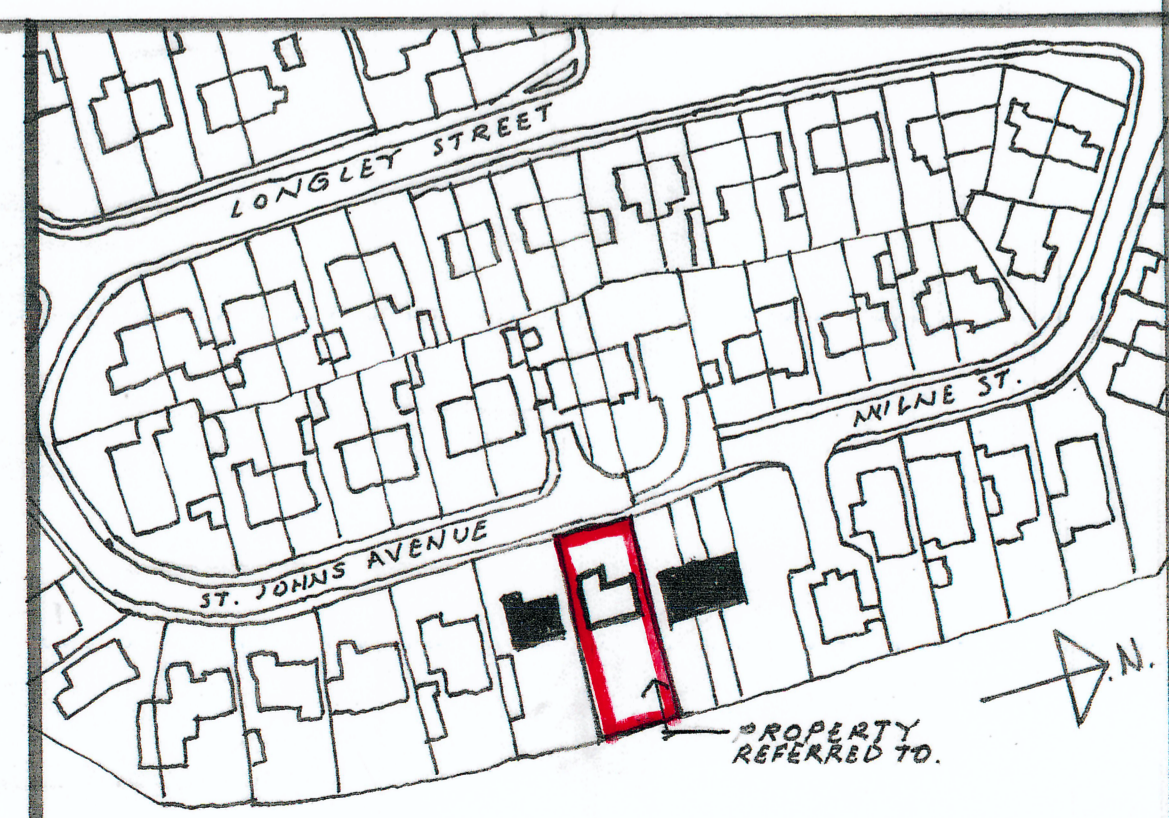

LOCATION PLAN. Scale:- 1/1250th

| DATE | | SCALES. |
|-------------|----------|------------|
| | | AS STATED. |
| DATE | JAN 25 | |
| DRAWING No. | SB-BG-07 | REVISION |
| | | A |