

REV	DATE	DETAILS OF ISSUE	INITIALS
-----	------	------------------	----------

STATUS OF DRAWING			
<input type="checkbox"/> 000 SURVEY/EXISTING (S)			400 TENDER (T)
<input type="checkbox"/> 100 SKETCH DESIGN (SK)			500 CONSTRUCTION (C)
<input type="checkbox"/> 200 PLANNING (PL)			600 AS BUILT (AB)
<input checked="" type="checkbox"/> 300 WORKING DRAWING (W)			PRELIMINARY (P)

EMERALD CONSTRUCTION Ltd.

HEALTHCARE DESIGN & BUILD SPECIALISTS

49 DARKLEY ROAD

KEADY

Co ARMAGH

BT60 3AX

T: 028 37 531777

F: 028 37 531707

PROJECT:

Proposed scheme at 'Westfield House' 47 Victoria Rd, Barnsley. S70 2BU.

TITLE:

Proposed floor plans & sections.

SCALE:

1:100

DWG NO:

BARN/301

REVISION

DATE:

Feb. 2019

DRAWN:

MB

CHECKED:

MB

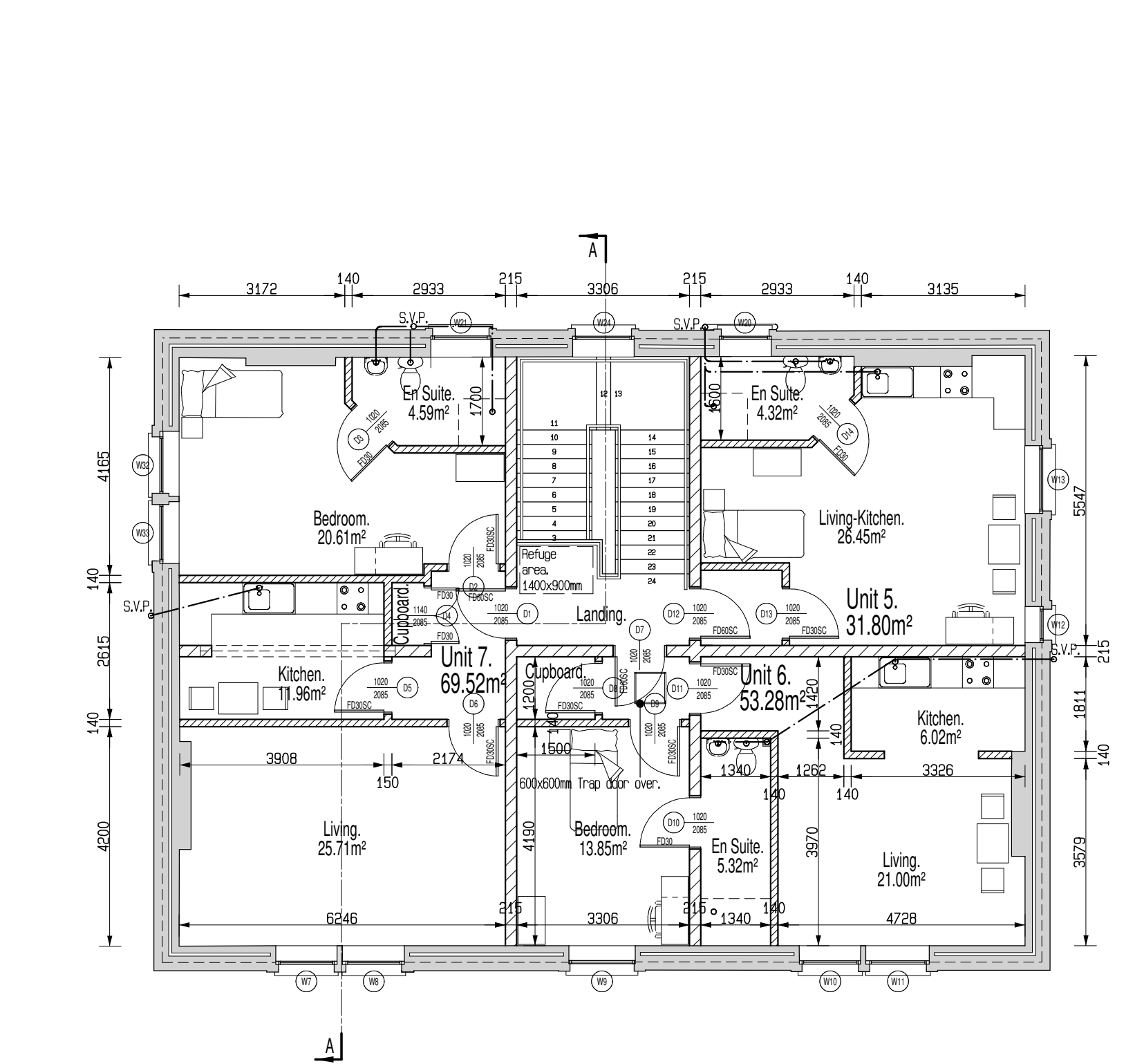

First floor plan.

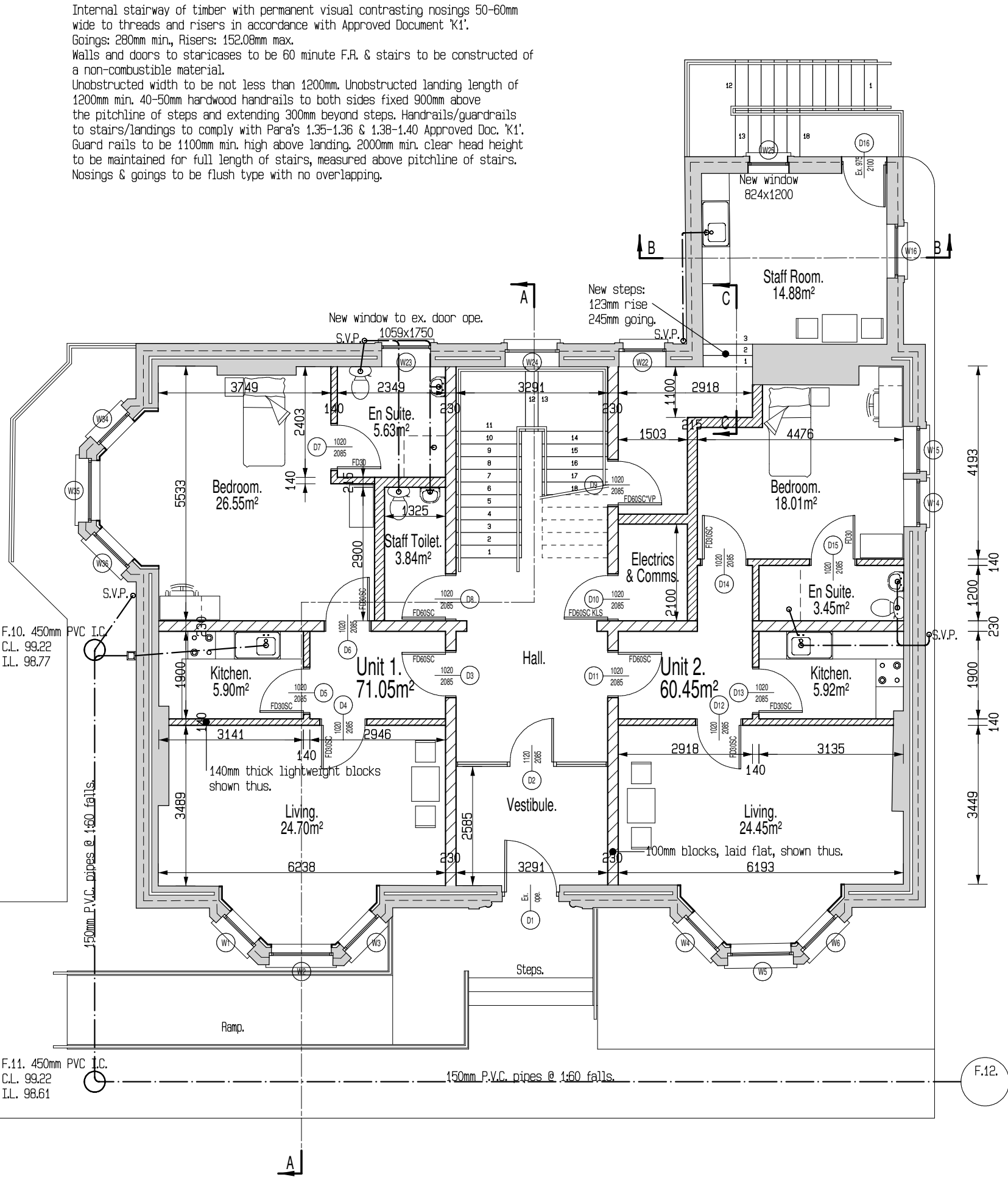

Ground floor plan. Scale: 1:100.

NEW TRUSS ROOF: (Roof to be designed and installed to the requirements in BS5534: 2014)  
Standard truss rafters by AIS Trusses Ltd @ 400mm crs.  
100 x 25 longitudinal, diagonal and chevron bracing to Truss details.  
Chevron bracing to roofs where span of truss exceeds 9m from w-plate to w-plate.  
Trap door, chimney framing and CWI supports to truss details.  
Truss design and bracing to be approved by Building Control prior to delivery on site. Girders trusses and truss shoes to manufacturers specification.  
All timbers in contact with masonry to be treated with a preservative.

ROOF INSULATION AND VENTILATION:  
300mm fibreglass insulation to horizontal ceilings,  
150mm insulation between joists and 150mm over.  
All to achieve a U-value not more the 0.20W/m<sup>2</sup>K.  
Fit eaves vents equal in area to a continuous  
10mm gap, equal to 55000mm<sup>2</sup>.

First floor suspended ceilings of  
36x100mm timbers with 1no. layer of  
12.5mm plasterboard

New floors of 60mm sand cement screed with  
under-floor heating pipes set on 25mm TF 70  
Kingspan<sup>®</sup> floor insulation, on 18mm WBP  
plywood, on new floor joists with 100mm TF70  
Kingspan<sup>®</sup> floor insulation between f. joists.  
Ditto to Staff Room.

Suspended compartment ceilings of  
36x100mm ceiling joists with 2no. layers  
of 12.5mm plasterboard with joints  
staggered and taped to give 1hr. fire  
resistance. Fix 38x100mm timber hangers  
connected between f. joists and c. joists.  
Ditto to basement ceilings, plasterboard to  
u-s of floor joists.

150mm sub-floor with 1no. layer  
of A393 mesh to bottom, on 1200g  
DPM, on hardcore fill, blunded  
with sand or quarry dust.  
Top of sub-floor to be level with  
top of plywood, on floor joists.  
See Engineers plans, SK-10-r1.

Section A:A. Scale: 1:100.

External conc. stairway supplied & fitted by specialist company.  
Gauges: 280mm, Risers: 148.27mm.  
Unobstructed width to be not less than 900mm.  
40-50mm galv. steel handrail to open side, 900mm above the  
pitchline of steps and extending 300mm beyond steps. Guardrails to  
landing to be 1000mm high.

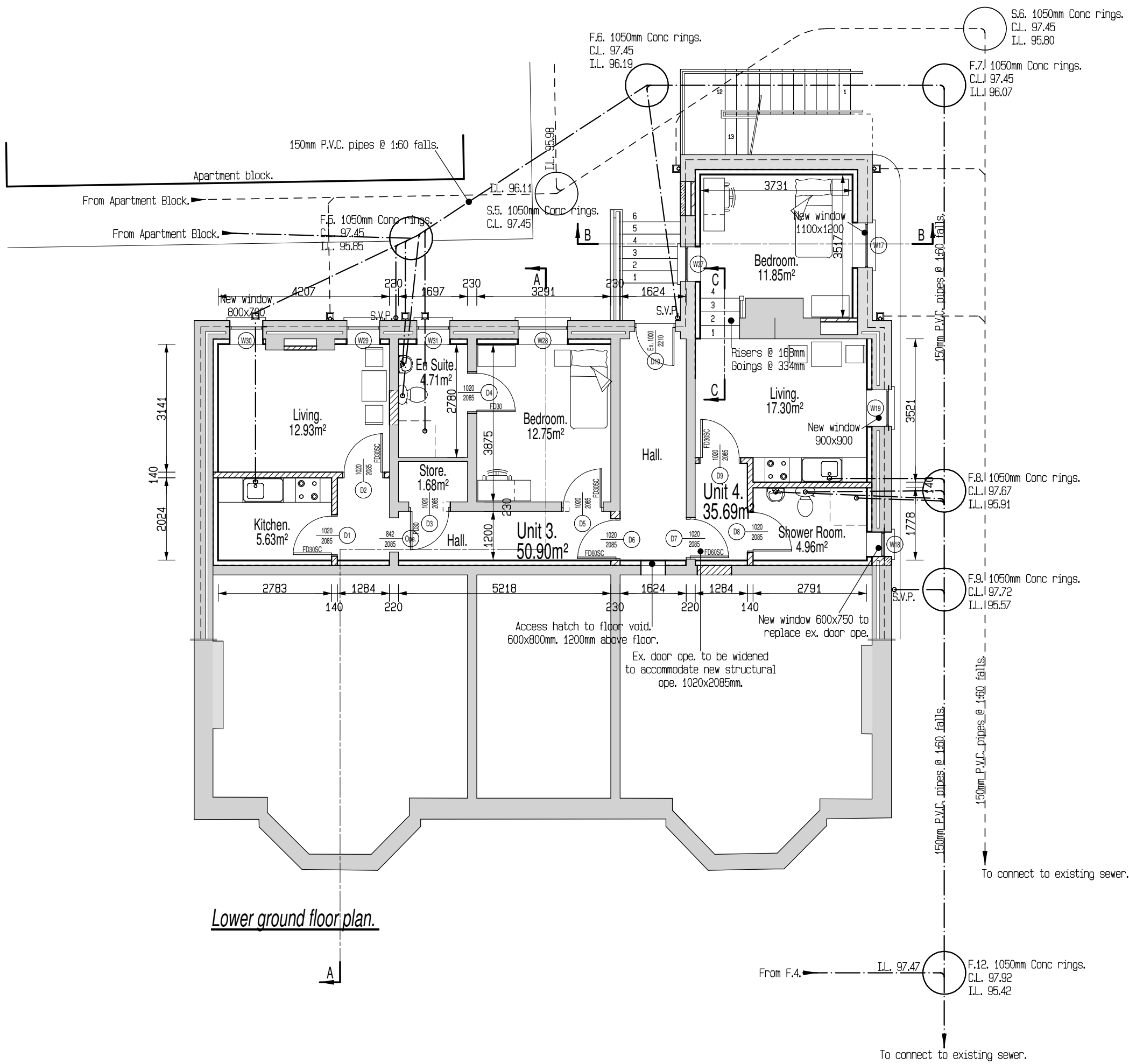

Lower ground floor plan.

