

This drawing and the information contained therein is issued in confidence and is the copyright of Met Surveys Limited. Disclosure of this information to Third Parties and unauthorised copying or replication of this data without approval is forbidden.

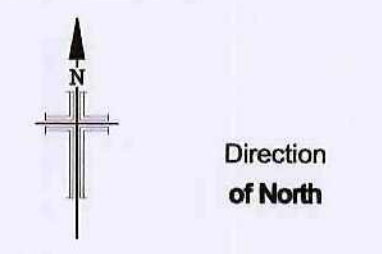

Grid - OS National Grid (Approximate)
Derived by fitting surveyed points to coordinates from OS digital information.
Datum - Related to Ordnance Survey benchmark.
Located on No. 21 Rotherham Road.
Value = 61.37 m A.O.D

KEY

AIR VALVE	AV	KERB OUTLET	KO
BENCH MARK	BM	LAMP POST	LP
BN	BN	MANHOLE (CIRCULAR)	MH
BOLLARD	BL	MANHOLE (RECTANGULAR)	MHR
BORE HOLE	BH	MANHOLE (TRIANGULAR)	MHT
BRITISH TELECOM COVER	BT	MARKER POST	MKR
BUS STOP	BUS	ROAD GULLY	RG
CABLE TV COVER	CATV	RODDING EYE	RE
CABLE TV SUPPLY	CA	SIGN POST	SIGN
COLUMN	COL	TELECOM COVER	TEL
EARTHING POINT	ER	TELEGRAPH POLE	TP
ELECTRICITY COVER	ELEC	THRESHOLD LEVEL	THL
ELECTRICITY POLE	EP	TRAFFIC LIGHT	TL
FIRE HYDRANT	PH	TRIAL PIT	PIT
GAS VALVE	GAS	WASH OUT	WO
GATE	G	WATER METER	WM
INSPECTION COVER (CIRCULAR)	IC	WATER STOP COCK	SC
INSPECTION COVER (RECTANGULAR)	IC	WATER STOP VALVE	SV

DRAINAGE INFO ABBREVIATIONS

COVER LEVEL	CL	CHAMBER BASE LEVEL	Ch.L
INVERT LEVEL	IL	WATER SURFACE LEVEL	WL
UNABLE TO RAISE	UTR		
UNABLE TO MEASURE	UTM		

A	11/03/2009	WS	SURVEY EXTENDED TO THE NORTH	DA
Rev	Date	Drawn	Description	Chkd



Met Surveys Ltd
Southgate House
Pontefract Road
Stourton, Leeds
West Yorkshire
LS10 1SW

T: +44 (0) 113 200 8900
F: +44 (0) 113 200 8901

E: admin@met-surveys.com
W: www.met-surveys.com

Client
MORGAN ASHURST PLC

Site
**ADDITIONAL WORK OAK HAVEN AVENUE
GREAT HOUGHTON, BARNSELY**

Title
**TOPOGRAPHICAL SURVEY
2D**

Surveyed	WS, SB	Drawn	WS
Chk.	DA	Date	11/03/2009
Scale	[A1 Sheet] DWG Ref	Status	
1/200	12546-103_2DT	REV	
Job No	12546-103-2	Rev	A

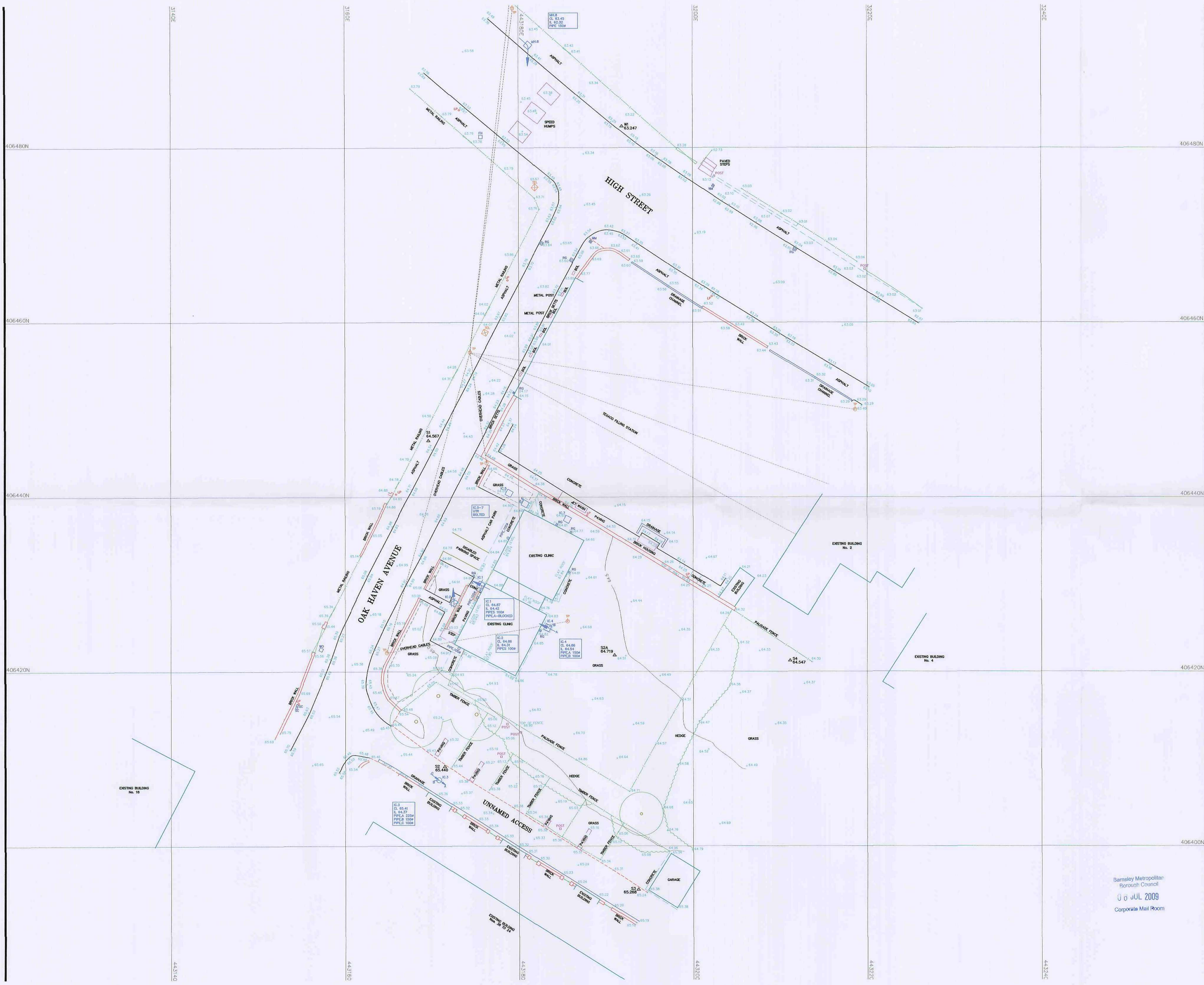

Barnsley Metropolitan
Borough Council
JUL 2009
Corporate Mail Room