

SITE AS EXISTING 1:500

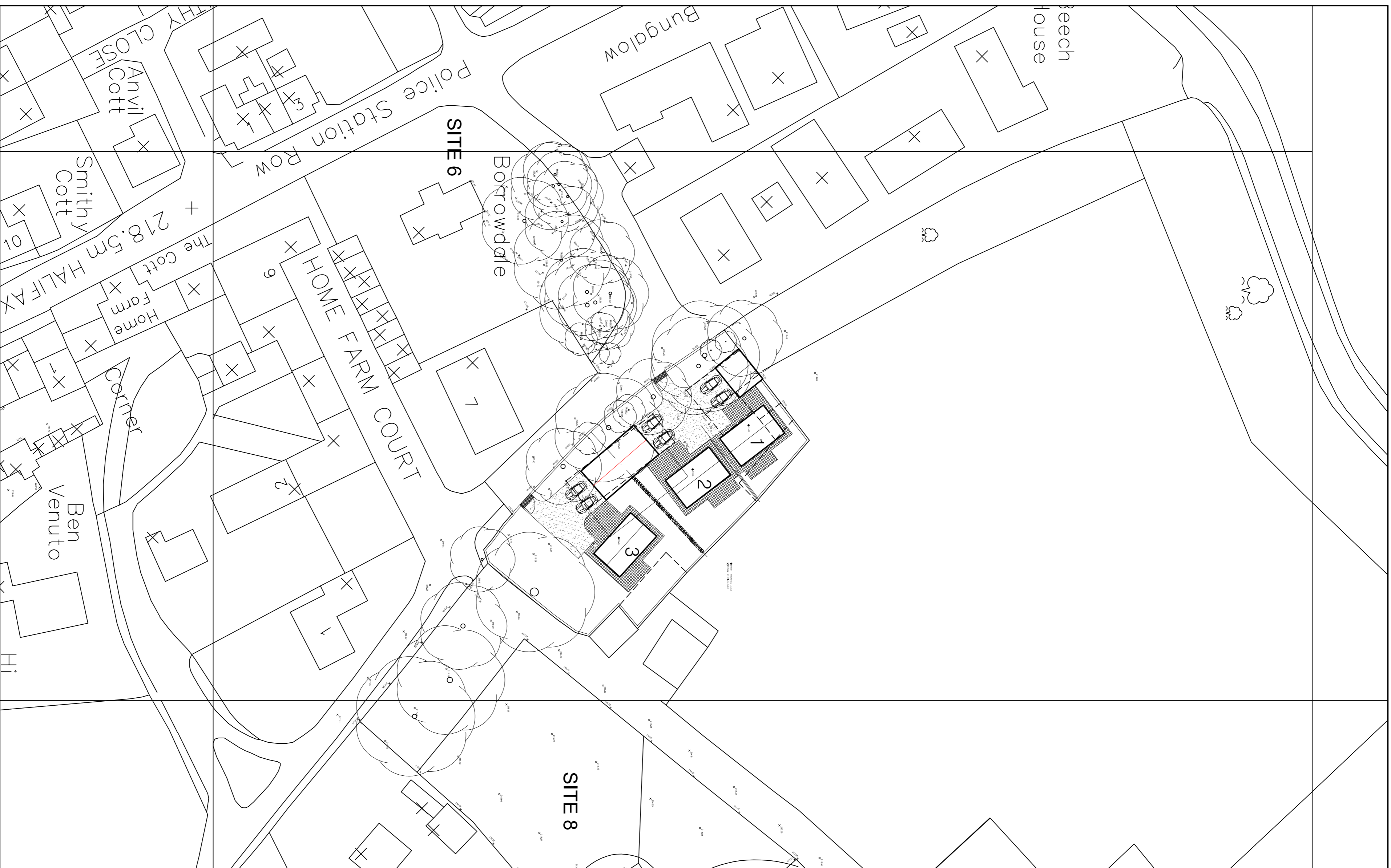

SITE AS PROPOSED 1:500

P1 - 15-04-2016 BOUNDARY AMENDED

revisions

architecturaldrawings ltd

DESIGN | DEVELOPMENT | BUILDING

44 Park Road, Barnby, 2011VE

01522 822222

www.architecturaldrawingsltd.co.uk

REVISIONS

CLIENT

**THE WHARNCLEFFE ESTATE
WORTLEY VILLAGE PLAN**

TITLE

**SITE 7
EXISTING & PROPOSED
SITE PLANS**

DRAWING STATUS

INFORMATION

SCALE 1:500 @ A1

DATE MARCH 2016

JOB NO. DRAWING NUMBER

707 07-01

REV P1