

PROPOSED DRAINAGE
VP 1/2
SCALE - 1:200

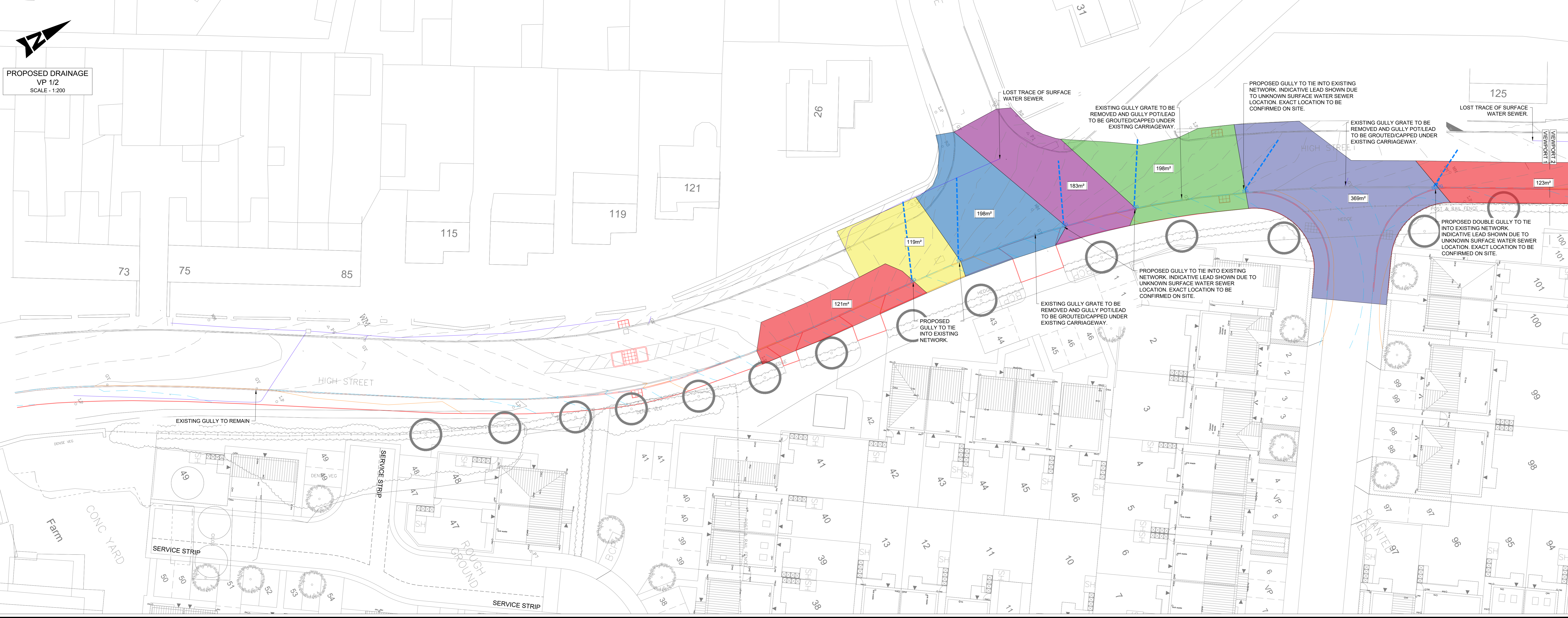

- NOTES:**
1. THESE NOTES ARE INTENDED TO AUGMENT DRAWINGS AND SPECIFICATIONS. WHERE CONFLICT OF REQUIREMENTS EXIST THE ORDER OF PRECEDENCE SHALL BE AS SHOWN IN THE SPECIFICATION. OTHERWISE THE STRICTEST PROVISION SHALL GOVERN.
 2. THIS DRAWING IS TO BE READ IN CONJUNCTION WITH ALL OTHER RELEVANT ENGINEERS AND ARCHITECTS DRAWINGS.
 3. DRAWINGS NOT TO BE SCALED. ALL DIMENSIONS TO BE CHECKED ON SITE BY THE CONTRACTOR. ANY DISCREPANCIES TO BE NOTIFIED TO THE ENGINEER AND FURTHER INSTRUCTIONS OBTAINED BEFORE WORK IS COMMENCED.
 4. LEVELS AT THE IN TO EXISTING ROAD CONSTRUCTION TO BE CONFIRMED. ANY DISCREPANCIES TO BE NOTIFIED TO THE ENGINEER.
 5. ALL WORKS TO BE IN ACCORDANCE WITH THE LOCAL HIGHWAY AUTHORITY'S CONSTRUCTION GUIDE.
 6. THE WORKS WILL BE ADOPTED BY THE HIGHWAY AUTHORITY. THE DEVELOPER AND/OR PRINCIPAL CONTRACTOR MUST THEREFORE ENSURE THAT THE WHOLE WORKS COMPLY BOTH WITH THE SPECIFICATION AND THE DRAWINGS WHICH ARE SUBJECT TO INSPECTION AND APPROVAL BY THE RELEVANT AUTHORITY.
 7. WHERE REQUIRED BY THE LOCAL HIGHWAY AUTHORITY, THE CONTRACTOR SHALL NOTIFY THE APPROPRIATE AUTHORITY PRIOR TO COMMENCEMENT OF EACH STAGE OF THE WORK FOR THEIR REPRESENTATIVE TO CARRY OUT INSPECTION TO ENSURE COMPLIANCE WITH THEIR SPECIFICATION AND APPROVED DETAILS. IF ANY SUCH REQUESTS OR INSTRUCTIONS CAUSE CONFLICT WITH THE SPECIFICATION THE CONTRACTOR SHALL IMMEDIATELY NOTIFY THE ENGINEER.
 8. ALL MATERIAL WITHIN 450mm OF THE FINISHED CARRIAGEWAY SURFACE SHALL BE NON-FROST SUSCEPTIBLE AS REQUIRED BY S.I.W. SERIES 800 CLAUSE 801.
 9. GENERALLY ALL WORKS TO BE UNDERTAKEN IN ACCORDANCE WITH 'THE MANUAL OF CONTRACT DOCUMENTS FOR HIGHWAY WORKS - VOLUME 1 - SPECIFICATION FOR HIGHWAY WORKS (S.H.W.)' CLAUSES SHOWN ON THE DRAWING REFER TO CLAUSES IN THE UK GOVERNMENT'S MANUAL OF CONTRACT DOCUMENTS FOR HIGHWAY WORKS. VOLUME 1 SPECIFICATION OF HIGHWAY WORKS.
 10. THE CONTRACTOR IS RESPONSIBLE FOR ACQUIRING UP TO DATE SERVICE INFORMATION AND SHALL TAKE ALL NECESSARY MEASURES TO IDENTIFY AND LOCATE EXISTING UNDERGROUND SERVICES INCLUDING ANY PRIVATE SUPPLIES, AND IMPLEMENT APPROPRIATE CONTROL MEASURES BEFORE UNDERTAKING ANY EXCAVATIONS.
 11. SAFE DIGGING PRACTICES MUST BE USED WHEN ESTABLISHING THE ACTUAL POSITION OF MAINS PIPES. SERVICES AND OTHER APPARATUS ON SITE BEFORE ANY MECHANICAL PLANT IS USED.
 12. CBRS TO BE TAKEN ON ROAD FORMATION AT 20m INTERVALS USING 600mm DIAMETER PLATE. RESULTS OF WHICH ALONG WITH A LOCATION PLAN IS TO BE PRESENTED TO BMCB ENGINEER TO REVIEW.
 13. ANY TREES WITHIN 3.66m OF THE PROSPECTIVELY ADAPTABLE HIGHWAY WILL REQUIRE A ROOT BARRIER - SEE CONSTRUCTION ENGINEER TO REVIEW.
 14. CCTV OF HIGHWAY DRAINAGE TO BE PROVIDED TO BMCB FOR REVIEW PRIOR TO A PART 1 CERTIFICATE AND PRIOR TO FINAL SURFACING.

THE INFORMATION ON THIS DRAWING IS FOR APPROVAL PURPOSES ONLY. NO CONSTRUCTION WORKS ARE TO BE UNDERTAKEN UNTIL WRITTEN APPROVAL IS RECEIVED FROM LOCAL HIGHWAY'S AUTHORITY.

THIS DRAWING IS TO BE READ IN CONJUNCTION WITH THE FOLLOWING DRAWING REFERENCE 25027;

- SECTION 278**
- 3400 - SECTION 278 - LEGAL BOUNDARY
 - 3401 - SECTION 278 - PROPOSED GENERAL ARRANGEMENT
 - 3402 - SECTION 278 - PROPOSED CONTOURS AND SECTIONS
 - 3403 - SECTION 278 - PROPOSED DRAINAGE
 - 3404 - SECTION 278 - VISIBILITY SPLAYS
 - 3405 - SECTION 278 - HIGHWAY CONSTRUCTION DETAILS
 - 3406 - SECTION 278 - VEHICLE TRACKING
 - 3407 - SECTION 278 - PROPOSED TRAFFIC SIGNS AND ROAD MARKINGS

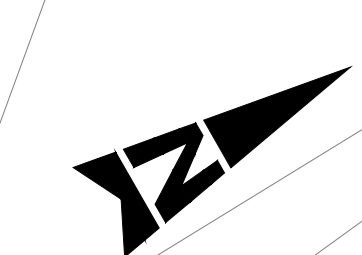

PROPOSED DRAINAGE
VP 2/2
SCALE - 1:200

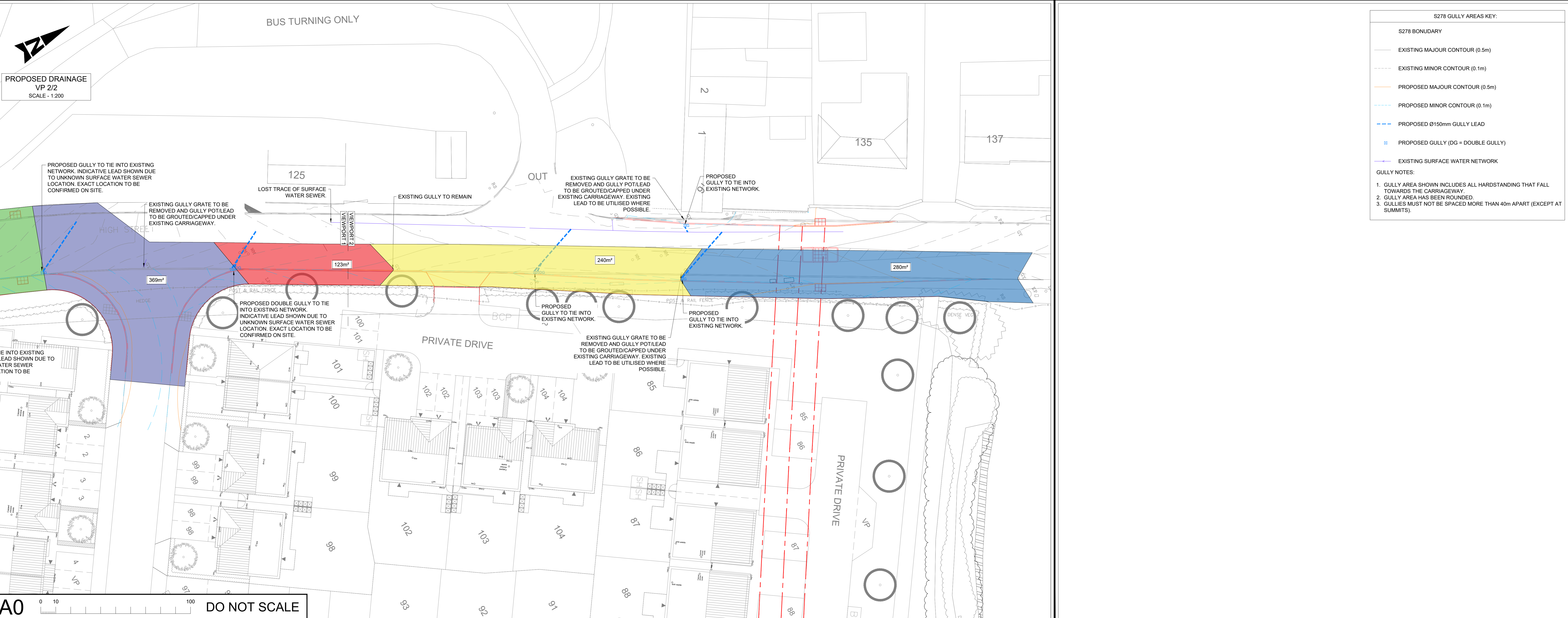

S278 GULLY AREAS KEY:

S278 BOUNDARY

- EXISTING MAJOR CONTOUR (0.5m)
- EXISTING MINOR CONTOUR (0.1m)
- PROPOSED MAJOR CONTOUR (0.5m)
- PROPOSED MINOR CONTOUR (0.1m)
- PROPOSED Ø150mm GULLY LEAD
- PROPOSED GULLY (DG = DOUBLE GULLY)
- EXISTING SURFACE WATER NETWORK

GULLY NOTES:

1. GULLY AREA SHOWN INCLUDES ALL HARDSTANDING THAT FALL TOWARDS THE CARRIAGEWAY.
2. GULLY AREA HAS BEEN ROUNDED.
3. GULLIES MUST NOT BE SPACED MORE THAN 40m APART (EXCEPT AT SUMMITS).

SAFETY, HEALTH AND ENVIRONMENTAL INFORMATION

IN ADDITION TO THE HAZARDS/RISKS NORMALLY ASSOCIATED WITH THE TYPES OF WORK SET OUT IN THIS DRAWING, NOTE THE FOLLOWING SIGNIFICANT RESIDUAL RISKS

Rev	Description	By	Date	Chk'd	Auth
S4	FOR APPROVAL		10.04.26	CK	CK
S4	FOR APPROVAL		14.08.25	CK	CK
S4	FOR APPROVAL		25.07.25	RSJ	RSJ

Rev	Description	By	Date	Chk'd	Auth
R03	UPDATED LAYOUT	WJ	10.04.26	CK	CK
R02	UPDATED LAYOUT	TH	14.08.25	CK	CK
P01	FIRST ISSUE	TH	25.07.25	CK	RSJ

LYNAS ENGINEERS

Lynas Engineers
Cargo Fleet Offices
Middlesbrough Road
Middlesbrough
TS6 6XH
Tel: +44 (0)1642 720280
www.lynaseengineers.com
Copyright © Lynas Engineers Limited (2025)

AVANT homes

**GREAT HAUGHTON
BARNLSLEY**

S278 PROPOSED DRAINAGE

Sheet No	Original Scale	Design/Drawn	Checked	Authorised	
A0	AS SHOWN	TH	CK	RSJ	
Date	25.07.25	Date	25.07.25	Date	25.07.25

Status	Drawing Number	Rev
S4	25027-LE-01-ZZ-DR-D-3403	P03

A0 0 10 100 DO NOT SCALE