

1. Do not scale drawing. If in doubt contact Ropergate Architecture Ltd
2. All dimensions are in millimetres unless noted otherwise.
3. Not for construction unless stated otherwise.
4. When appropriate, this drawing is to be read in conjunction with project specific Designers Risk Assessments, produced in accordance with requirements of Regulation 13 of the Construction (Design and Management) Regulations 2007.
5. The design shown on this drawing is the property of Ropergate Architecture Ltd and is not to be used or its contents copied, communicated or disclosed, in whole or in part, except in accordance with a contract, licence or agreement in writing with Ropergate Architecture Ltd.

NOTES

Drainage Key

- Existing Foul Drainage
- Existing Surface Water Drainage
- Proposed Foul Drainage
- - - Proposed Surface Water Drainage

Existing drainage runs shown on the site plan have been provided by Yorkshire Water via a stats search. Further investigation work is to be undertaken by a civil engineer to ascertain any further drainage on site which may have been missed and provide details of existing foul connections around the site.

Civil engineer is to provide further details for conditions discharge on size of any required site attenuation including discharge rates, carpark drainage proposal including petrol interceptors and on site foul drainage due to lack of information provided by Yorkshire Water.

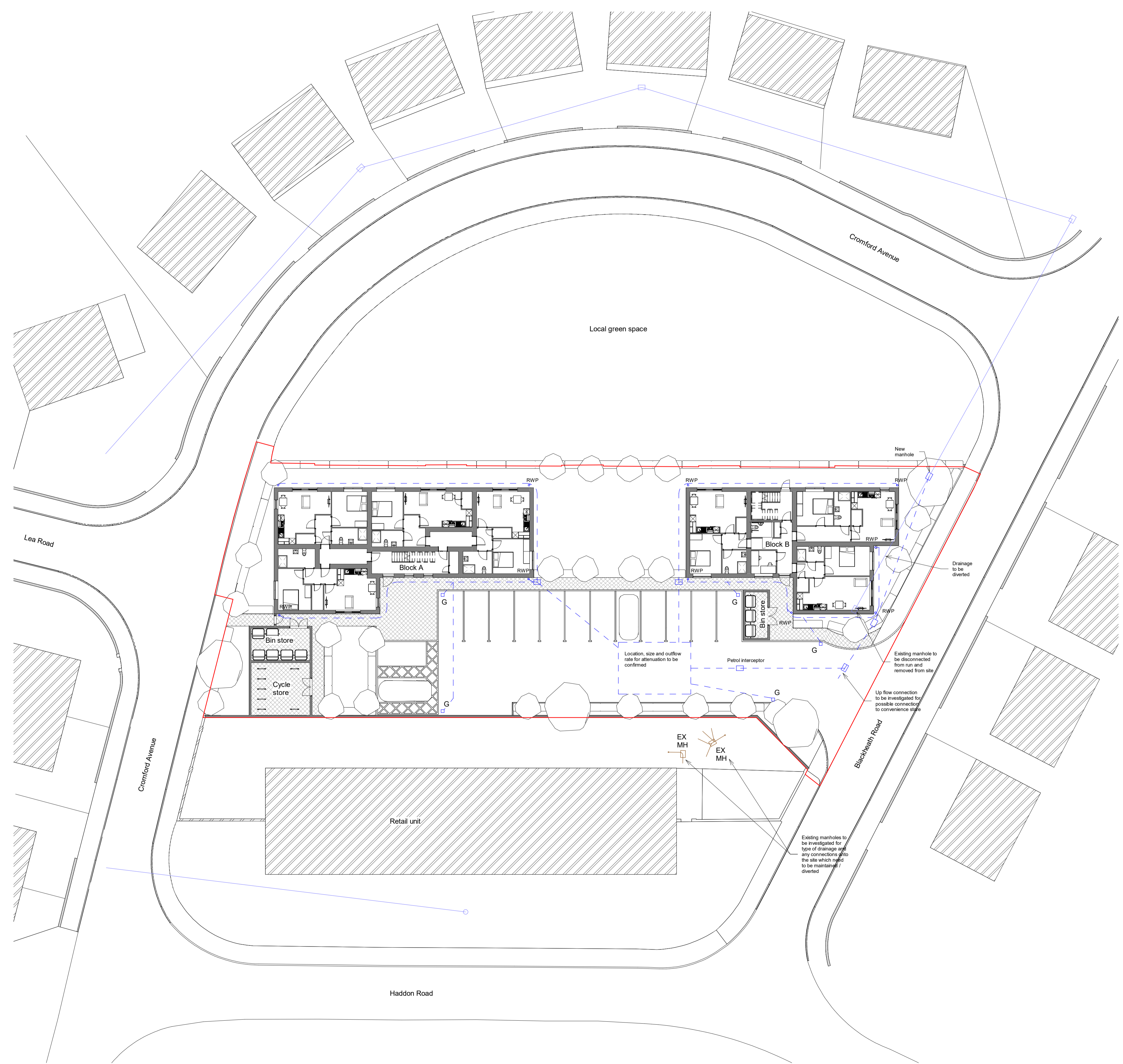

REV	DATE	DESCRIPTION	RA	DM
-	12/11/24	Planning Issue		

ROPERGATE ARCHITECTURE
 THE OLD POST OFFICE, 20B ROPERGATE
 PONTEFRAC, WF8 1LY
 Tel 01977 269100
 Email: mail@ropergatearchitecture.uk www.ropergatearchitecture.uk

PROJECT
 Residential Development
 Alpha Dora
 Haddon Road, Barnsley

TITLE
 Proposed Drainage

STAGE
 Planning

SCALE	As indicated@ A1	DATE	15/11/24
DRAWN	AJB	CHECKED	MS
DRAWING No.	HR- RA- XX- XX- DR- A- (03)10	REV.	-
Subsidiary	S0	PROJECT No.	2032

