

DRAINAGE STATEMENT

Client	Tom Dennerby
Site Location	108 Cemetery Road, Hemingfield, Barnsley, S73 0QG
Date	14 November 2025
Engineer	JS
Revision	-

New Build – 108 Cemetery Road, Hemingfield, Barnsley, S73 0QG

The land investigated comprised:

Proposed development at 108 Cemetery Road, Hemingfield, Barnsley, S73 0QG

In order to determine the ground conditions and infiltration potential, 1 trial hole was excavated to the left hand side of the proposed property.

Foul drainage system

On site foul drainage will be designed in accordance with the Building Regulations AD"H" .

The foul drainage system will discharge to the front elevation of the property and connect to the existing Foul main in Cemetery Road.

Surface water drainage system

On site surface water drainage has been designed in accordance with the Building Regulations AD"H".

Services/utility information has been obtained for the area. The information provided by Yorkshire Water showed that there was no surface water sewer within the immediate area.

Trial holes have been excavated to the rear of the proposed properties, the investigations confirmed the ground conditions to comprise a layer of 300mm topsoil beneath which to a depth of approx. 700mm is a dense firm moist SILT, beyond which to a depth of 1700mm is a dense firm sandy SILT, infiltration was obtained on site and therefore the investigations confirm that soakaways will work given the ground conditions.

It will therefore be necessary to construct soakaways within the left hand garden, a minimum of 5m from the any structure.

A copy of the proposed drainage layout is attached as appendix 4

The trial hole descriptions and infiltration results tabulated below and location plan shown within appendix 2:

Location	Ground conditions description	Infiltration rate
Test pit 1 -	0 to -300mm Topsoils -350 to 1700mm Firm dense sandy silty SILT. Water table encountered at 1.5m below ground level	4.29284E-05

Soakaway Calculations

Plot 1
100m² (hardstanding area)

Conclusions

The foul drainage is to the front elevation of the property or connected to the neighbouring properties system.

Due to the lack of a Yorkshire Water Surface water sewer nearby for the surface water to discharge into, it is necessary to discharge the surface water from the site into soakaway system located a minimum of 5m from any structure. Given the layout of the building, we would advise that the soakaways be constructed within the left hand garden area.

Plot - 4.74m³ required volume = 23 crates sized 1000mm x 500mm x 400mm.



Signed:

On behalf of CMLC Ltd

Appendix 1

Site Plan



Appendix 2

Trial pit location plan and trial pit logs



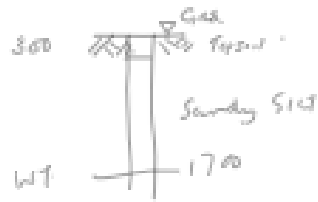

T.P.1
(300 x 2000 x 2000 deep)

Infiltration table	Test 1	Water level	Test 2	Water level	Test 3	Water level
	0	0.3	0	0.3	0	0.3
<i>Notes...</i>	5	0.3	5	0.3	5	
<i>Observations</i>	10	0.4	10	0.4	10	0.3
<i>Water level</i>	15	0.4	15		15	
<i>Soil (type)</i>	20	0.4	20		20	0.4
<i>Flow (type)</i>	25	0.5	25	0.4	25	
	30	0.5	30	0.4	30	
	35	0.9	35	0.5	35	0.5
	40	0.8	40		40	
	45		45	0.6	45	0.5
	50		50		50	
	55		55	0.7	55	
	60	1.0	60		60	0.6
	65	1.0	65	0.7	65	0.6
	70		70	0.8	70	0.6
	75		75		75	0.7
	80	1.1	80	1.0	80	0.7
	85		85		85	0.7
	90		90	1.0	90	0.7
	95	1.2	95		95	
	100		100	1.1	100	0.8
	105		105		105	0.8
	110	1.3	110	1.1	110	0.9
	115	1.3	115		115	0.9
	120	1.4	120	1.2	120	1.0
	125	1.0	125	1.2	125	1.0
	130	1.5	130	1.3	130	1.0
	135	1.5	135	1.3	135	1.1
	140	1.3	140	1.3	140	1.1
	145	1.6	145		145	1.2
	150		150		150	



Trial Hole 1

Appendix 3

Rainfall 100 Year storm – 6 Hour Duration

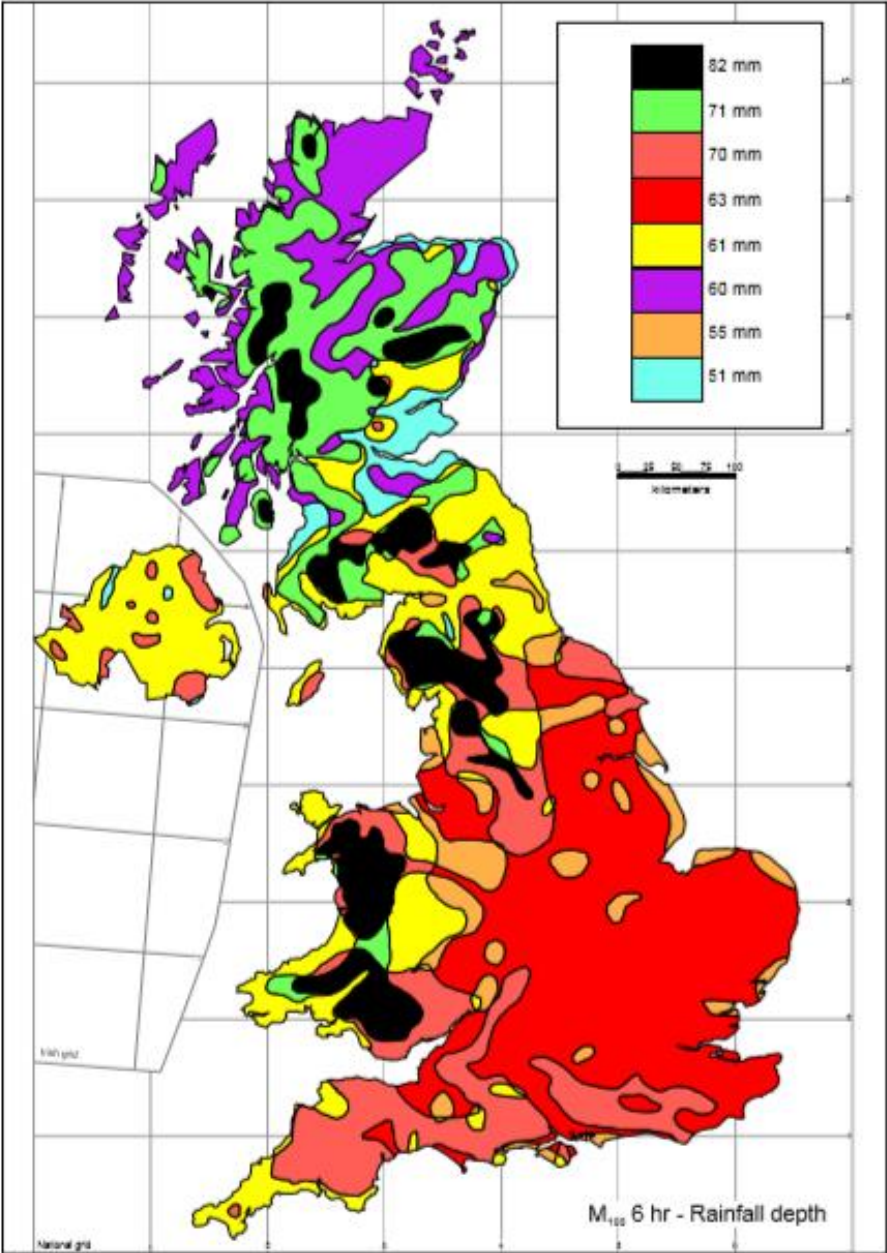



Figure A3.1 100 year 6 hour rainfall depths of UK

Appendix 4

Proposed Drainage Details

New Build – 108 Cemetery Road, Hemingfield, Barnsley – Soakaway locations and sizes

Note: soakaways should be a minimum of 5m from any structure

 CMLC Ltd Piccadilly Circus 48 Warwick Street London www.cmlcltd.uk Tel: 02039233648	108 Cemetery Road, Hemingfield, Barnsley, S73 0QG	Revision	
	Job No: 22987	Page: C/01	
	Prepared By: JES	Date: 14/11/2025	
Section: Test location 1			

<table border="1" style="width: 100%; border-collapse: collapse;"> <thead> <tr> <th colspan="4" style="text-align: center;">ALTERNATIVE SOAKAWAY SIZES</th> </tr> <tr> <th colspan="4" style="text-align: center;">trench soakaways</th> </tr> </thead> <tbody> <tr> <td style="text-align: right;">width of trench [mm]:</td> <td style="text-align: center;">450</td> <td style="text-align: center;">600</td> <td style="text-align: center;">900</td> </tr> <tr> <td style="text-align: right;">required trench length [m]:</td> <td style="text-align: center;">7.99</td> <td style="text-align: center;">6.35</td> <td style="text-align: center;">4.54</td> </tr> <tr> <th colspan="4" style="text-align: center;">ring soakaways</th> </tr> <tr> <td style="text-align: right;">diameter of ring [mm]:</td> <td style="text-align: center;">1050</td> <td style="text-align: center;">1350</td> <td style="text-align: center;">1500</td> </tr> <tr> <td style="text-align: right;">required pit diameter [m]:</td> <td style="text-align: center;">2.37</td> <td style="text-align: center;">2.38</td> <td style="text-align: center;">2.35</td> </tr> </tbody> </table> <p style="font-size: small; margin-top: 5px;">*Base on effective depth and number of pits as in Soakaway Data table</p>	ALTERNATIVE SOAKAWAY SIZES				trench soakaways				width of trench [mm]:	450	600	900	required trench length [m]:	7.99	6.35	4.54	ring soakaways				diameter of ring [mm]:	1050	1350	1500	required pit diameter [m]:	2.37	2.38	2.35	<table border="1" style="width: 100%; border-collapse: collapse;"> <thead> <tr> <th colspan="2" style="text-align: center;">SUMMARY OF CALCULATIONS</th> </tr> </thead> <tbody> <tr> <td style="text-align: right;">critical design rainfall duration 't_{crit}'</td> <td style="text-align: left;">= 120 min</td> </tr> <tr> <td style="text-align: right;">required storage volume 'V_{req}'</td> <td style="text-align: left;">= 4.74 m³</td> </tr> <tr> <td style="text-align: right;">provided storage volume 'V_{prov}'</td> <td style="text-align: left;">= 7.85 m³</td> </tr> <tr> <td style="text-align: right;">utilisation factor</td> <td style="text-align: left;">= 0.62 <i>.OK</i></td> </tr> <tr> <td style="text-align: right;">required time to discharge 50% 't₅₀'</td> <td style="text-align: left;">= 3.88 hours</td> </tr> <tr> <td style="text-align: right;">utilisation factor</td> <td style="text-align: left;">= 0.16 <i>.OK</i></td> </tr> </tbody> </table>	SUMMARY OF CALCULATIONS		critical design rainfall duration 't _{crit} '	= 120 min	required storage volume 'V _{req} '	= 4.74 m ³	provided storage volume 'V _{prov} '	= 7.85 m ³	utilisation factor	= 0.62 <i>.OK</i>	required time to discharge 50% 't ₅₀ '	= 3.88 hours	utilisation factor	= 0.16 <i>.OK</i>
ALTERNATIVE SOAKAWAY SIZES																																											
trench soakaways																																											
width of trench [mm]:	450	600	900																																								
required trench length [m]:	7.99	6.35	4.54																																								
ring soakaways																																											
diameter of ring [mm]:	1050	1350	1500																																								
required pit diameter [m]:	2.37	2.38	2.35																																								
SUMMARY OF CALCULATIONS																																											
critical design rainfall duration 't _{crit} '	= 120 min																																										
required storage volume 'V _{req} '	= 4.74 m ³																																										
provided storage volume 'V _{prov} '	= 7.85 m ³																																										
utilisation factor	= 0.62 <i>.OK</i>																																										
required time to discharge 50% 't ₅₀ '	= 3.88 hours																																										
utilisation factor	= 0.16 <i>.OK</i>																																										

<table border="1" style="width: 100%; border-collapse: collapse;"> <thead> <tr> <th colspan="2" style="text-align: center;">GENERAL DATA</th> </tr> </thead> <tbody> <tr> <td style="text-align: right;">site location:</td> <td style="text-align: left;">England and Wales</td> </tr> <tr> <td style="text-align: right;">soakaway type:</td> <td style="text-align: left;">geocellular units</td> </tr> <tr> <td style="text-align: right;">impermeable area drained to soakaway 'A' [m²]</td> <td style="text-align: left;">= 100</td> </tr> <tr> <td style="text-align: right;">10 min rainfall depth of 5 year return period 'R' [mm]</td> <td style="text-align: left;">= 20</td> </tr> <tr> <td style="text-align: right;">M5-80 to M5-2d rainfall ratio 'γ'</td> <td style="text-align: left;">= 0.50</td> </tr> <tr> <td style="text-align: right;">allowance for climate change:</td> <td style="text-align: left;">40%</td> </tr> </tbody> </table>	GENERAL DATA		site location:	England and Wales	soakaway type:	geocellular units	impermeable area drained to soakaway 'A' [m ²]	= 100	10 min rainfall depth of 5 year return period 'R' [mm]	= 20	M5-80 to M5-2d rainfall ratio 'γ'	= 0.50	allowance for climate change:	40%	<table border="1" style="width: 100%; border-collapse: collapse;"> <thead> <tr> <th colspan="2" style="text-align: center;">SOAKAWAY DATA</th> </tr> </thead> <tbody> <tr> <td style="text-align: right;">soakaway width 'W' [m]</td> <td style="text-align: left;">= 1.00</td> </tr> <tr> <td style="text-align: right;">soakaway length 'L' [m]</td> <td style="text-align: left;">= 6.00</td> </tr> <tr> <td style="text-align: right;">total depth from ground level 'D_t' [m]</td> <td style="text-align: left;">= 2.00</td> </tr> <tr> <td style="text-align: right;">depth to drain invert level 'D_d' [m]</td> <td style="text-align: left;">= 0.50</td> </tr> <tr> <td style="text-align: right;">soakaway effective depth 'D_{eff}' [m]</td> <td style="text-align: left;">= 1.50</td> </tr> <tr> <td style="text-align: right;">free volume in infill aggregate [%]</td> <td style="text-align: left;">= 85</td> </tr> </tbody> </table>	SOAKAWAY DATA		soakaway width 'W' [m]	= 1.00	soakaway length 'L' [m]	= 6.00	total depth from ground level 'D _t ' [m]	= 2.00	depth to drain invert level 'D _d ' [m]	= 0.50	soakaway effective depth 'D _{eff} ' [m]	= 1.50	free volume in infill aggregate [%]	= 85
GENERAL DATA																													
site location:	England and Wales																												
soakaway type:	geocellular units																												
impermeable area drained to soakaway 'A' [m ²]	= 100																												
10 min rainfall depth of 5 year return period 'R' [mm]	= 20																												
M5-80 to M5-2d rainfall ratio 'γ'	= 0.50																												
allowance for climate change:	40%																												
SOAKAWAY DATA																													
soakaway width 'W' [m]	= 1.00																												
soakaway length 'L' [m]	= 6.00																												
total depth from ground level 'D _t ' [m]	= 2.00																												
depth to drain invert level 'D _d ' [m]	= 0.50																												
soakaway effective depth 'D _{eff} ' [m]	= 1.50																												
free volume in infill aggregate [%]	= 85																												

<table border="1" style="width: 100%; border-collapse: collapse;"> <thead> <tr> <th colspan="2" style="text-align: center;">SOIL INFILTRATION DATA</th> </tr> </thead> <tbody> <tr> <td style="text-align: right;">allowance for infiltration through soakaway base:</td> <td style="text-align: left;">30%</td> </tr> <tr> <td style="text-align: right;">available on-site infiltration test results:</td> <td style="text-align: left;"><input checked="" type="radio"/> Yes <input type="radio"/> No</td> </tr> <tr> <td colspan="2" style="text-align: center;">use soakage trial pit table below</td> </tr> <tr> <td style="text-align: right;">internal surface area of trial pit 'a_{trial}' [m²]</td> <td style="text-align: left;">= 4.12</td> </tr> <tr> <td style="text-align: right;">storage volume between 75-25% 'V₇₅' [m³]</td> <td style="text-align: left;">= 0.66</td> </tr> <tr> <td style="text-align: right;">time for water to fall from 75-25% 't₇₅' [min]</td> <td style="text-align: left;">= 120.00</td> </tr> <tr> <td style="text-align: right;">soil infiltration rate 'f' [m/s]</td> <td style="text-align: left;">= 2.22E-05</td> </tr> </tbody> </table>	SOIL INFILTRATION DATA		allowance for infiltration through soakaway base:	30%	available on-site infiltration test results:	<input checked="" type="radio"/> Yes <input type="radio"/> No	use soakage trial pit table below		internal surface area of trial pit 'a _{trial} ' [m ²]	= 4.12	storage volume between 75-25% 'V ₇₅ ' [m ³]	= 0.66	time for water to fall from 75-25% 't ₇₅ ' [min]	= 120.00	soil infiltration rate 'f' [m/s]	= 2.22E-05	<table border="1" style="width: 100%; border-collapse: collapse;"> <thead> <tr> <th colspan="2" style="text-align: center;">SOAKAGE TRIAL PIT DATA</th> </tr> </thead> <tbody> <tr> <td style="text-align: right;">soakage trial pit width 'W_t' [m]</td> <td style="text-align: left;">= 0.60</td> </tr> <tr> <td style="text-align: right;">soakage trial pit length 'L_t' [m]</td> <td style="text-align: left;">= 1.00</td> </tr> <tr> <td style="text-align: right;">total depth from ground level 'D_{tr}' [m]</td> <td style="text-align: left;">= 2.50</td> </tr> <tr> <td style="text-align: right;">depth to pipe invert level 'D_{tr}' [m]</td> <td style="text-align: left;">= 0.30</td> </tr> <tr> <td style="text-align: right;">soakage trial pit effective depth 'D_{tr,eff}' [m]</td> <td style="text-align: left;">= 2.20</td> </tr> <tr> <td style="text-align: right;">free volume in infill aggregate [%]</td> <td style="text-align: left;">= 100</td> </tr> </tbody> </table> <p style="font-size: x-small; margin-top: 5px;">NOTE: focus of excavation assumed to be vertical</p>	SOAKAGE TRIAL PIT DATA		soakage trial pit width 'W _t ' [m]	= 0.60	soakage trial pit length 'L _t ' [m]	= 1.00	total depth from ground level 'D _{tr} ' [m]	= 2.50	depth to pipe invert level 'D _{tr} ' [m]	= 0.30	soakage trial pit effective depth 'D _{tr,eff} ' [m]	= 2.20	free volume in infill aggregate [%]	= 100
SOIL INFILTRATION DATA																															
allowance for infiltration through soakaway base:	30%																														
available on-site infiltration test results:	<input checked="" type="radio"/> Yes <input type="radio"/> No																														
use soakage trial pit table below																															
internal surface area of trial pit 'a _{trial} ' [m ²]	= 4.12																														
storage volume between 75-25% 'V ₇₅ ' [m ³]	= 0.66																														
time for water to fall from 75-25% 't ₇₅ ' [min]	= 120.00																														
soil infiltration rate 'f' [m/s]	= 2.22E-05																														
SOAKAGE TRIAL PIT DATA																															
soakage trial pit width 'W _t ' [m]	= 0.60																														
soakage trial pit length 'L _t ' [m]	= 1.00																														
total depth from ground level 'D _{tr} ' [m]	= 2.50																														
depth to pipe invert level 'D _{tr} ' [m]	= 0.30																														
soakage trial pit effective depth 'D _{tr,eff} ' [m]	= 2.20																														
free volume in infill aggregate [%]	= 100																														

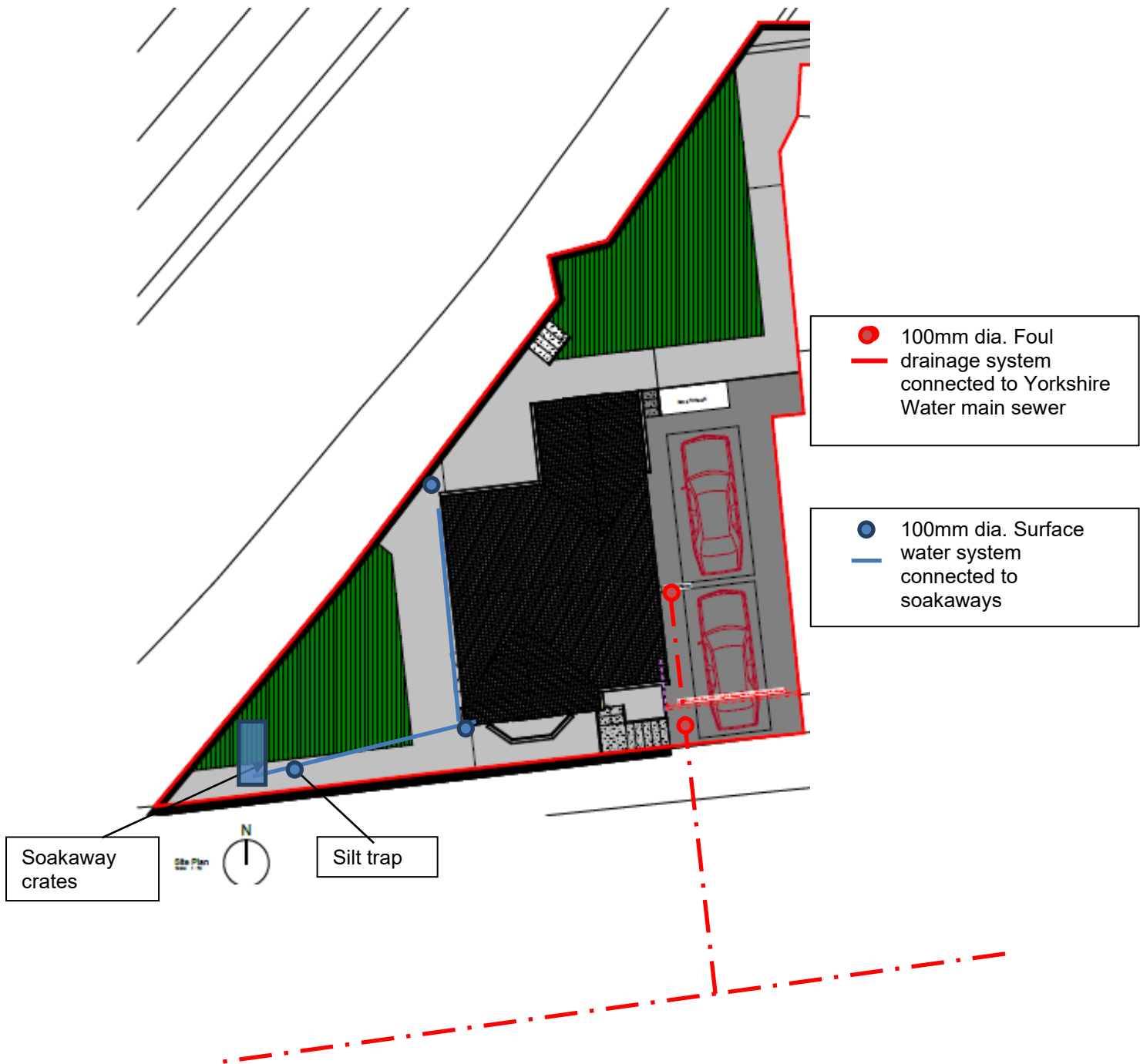

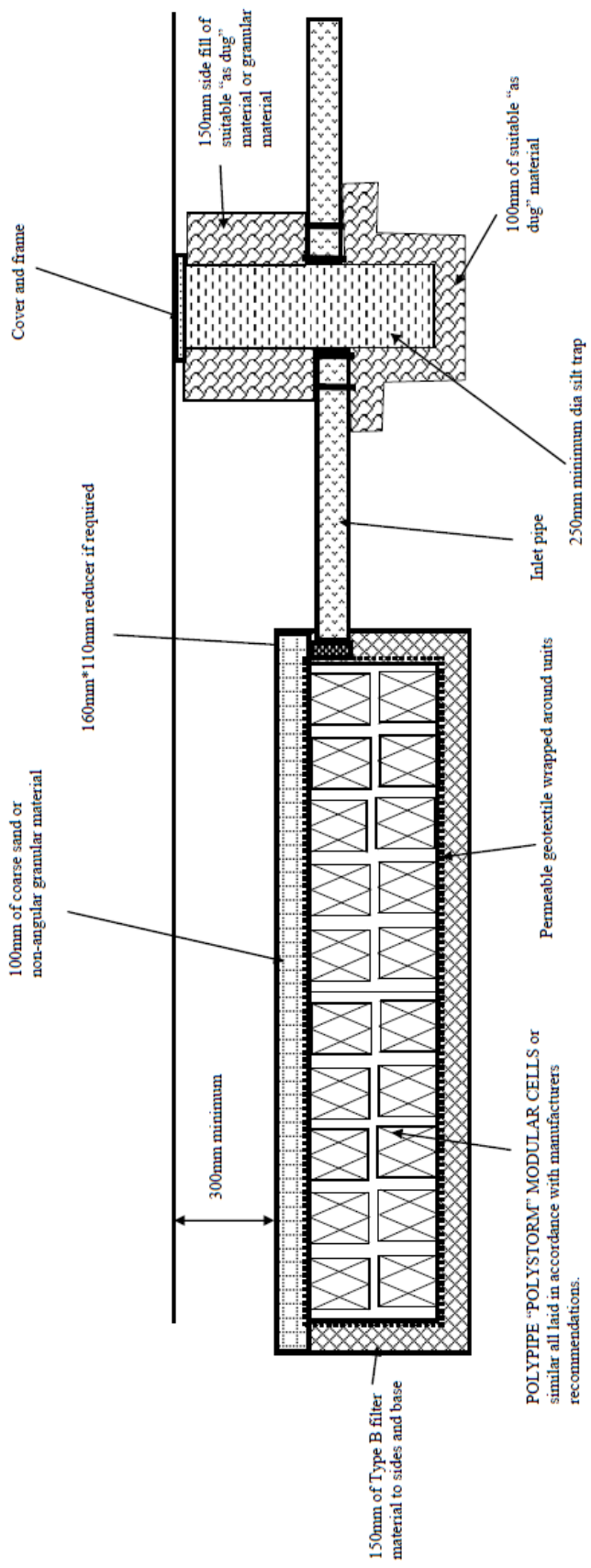

TYPICAL SOAKAWAY DETAIL nts