

EXTERNAL WORKS LEGEND:

- ASPHALT ACCESS ROAD (HEAVY DUTY) (MIN CBR 5%):** 40mm SURFACE COURSE - SMA 10 (SURF) 40/60 PVS55 TO BS9487:2010 AND BS EN 13108-1; 50mm BINDER COURSE - AC20 DENSE (BIN) 100/150 TO BS 59497:2010 AND BS EN 13108-1; 115mm BASE COURSE - AC20 DENSE (BASE) 100/150 TO BS 59497:2010 AND BS EN 13108-1; 350mm TYPE 1 SUB-BASE TO SPEC. FOR HIGHWAY WORKS - CLAUSE 803.
- ACTIVE TRAVEL ROUTE COLOURED TARMAC (MIN CBR 5%):** 30mm SURFACE COURSE - AC10 DENSE (SURF) 100/150 TO MCHW SERIES 900 (REF 20%) CLAUSE 909; 60mm BINDER COURSE - AC20 DENSE (BIN) 100/150 TO BS 59497:2010 AND BS EN 13108-1; 225mm TYPE 1 SUB-BASE TO SPEC. FOR HIGHWAY WORKS - CLAUSE 803.
- ASPHALT FOOTPATH (MIN CBR 5%):** 25mm SURFACE COURSE - AC2 DENSE (SURF) 100/150 TO BS 59497:2010 AND BS EN 13108-1; 50mm BINDER COURSE - AC20 DENSE (BIN) 100/150 TO BS 59497:2010 AND BS EN 13108-1; 225mm TYPE 1 SUB-BASE TO SPEC. FOR HIGHWAY WORKS - CLAUSE 803.
- PEDESTRIAN RESIN BOUND GRAVEL (MIN CBR 5%):** 12 - 18mm SURFACING - RESIN BOUND GRAVEL (TO ARCHITECT / LANDSCAPE ARCHITECT SPEC); TERRAZZO WEEDGUARD GEOTEXTILE OR SIMILAR APPROVED; CONSTRUCTION OF RESIN BOUND GRAVEL IN ACCORDANCE WITH MANUFACTURERS SPECIFICATIONS AND RECOMMENDATIONS; 150mm SUB-BASE - TYPE 1 TO SPECIFICATION TO HIGHWAY WORKS TO CLAUSE 803.
- POROUS PAVING CAR PARKING:** (OPEN GRADED STONE SUB-BASE) NON-INFILTRATION (MIN CBR 5%); 80mm POROUS BLOCK PAVING TO ARCHITECT'S SPECIFICATION, WITH AGGREGATE JOINTING MATERIAL 2/6.3 G₆, 8/20 TO BS EN 12620:2013 NOT SEALED; 50mm AGGREGATE LAYING COURSE 2/6.3 G₆, 8/20 TO BS EN 12620:2013; GEOTEXTILE MEMBRANE (CHARCON PERMAFILTER OR SIMILAR APPROVED); 170mm FILTER MEDIA SUB-BASE WITH MIN. 30% VOID RATIO, CLEAN STONE 400 AGG. STONE TO BE CRUSHED ROCK (GRANITE, BASALT, GABBRO), CONCRETE OR BLAST FURNACE SLAG WITH LOW FINES CONTENT, WITH ROUGH AND ANGULAR PARTICLES, NOT SANDS OR GRAVELS WITH ROUNDED PARTICLES - INCREASE THICKNESS TO SUIT STORAGE REQUIREMENTS; ROBUST GEOTEXTILE FLEECE LINING (TERRAM RG7 OR SIMILAR APPROVED); VISQUEEN UDG MEMBRANE; 100mm TYPE 1 SUB-BASE TO SPEC. FOR HIGHWAY WORKS - CLAUSE 803, BLENDED WITH FINES.
- BENDCRETE AREAS:** HATCHING DENOTES AREAS OF THE SKATE PARK AND PARKOUR AREAS WHERE THE FINISH IS TO BE SPECIFIED AND DESIGNED BY BENDCRETE.
- SECTION 278 AREAS:** AREAS OF EXTERNAL WORKS COVERED BY SECTION 278 AGREEMENT.
- HEAVY DUTY FILTER TRENCH:** (OPEN GRADED STONE SUB-BASE) NON-INFILTRATION (MIN CBR 5%); 80mm POROUS BLOCK PAVING TO ARCHITECT'S SPECIFICATION, WITH AGGREGATE JOINTING MATERIAL 2/6.3 G₆, 8/20 TO BS EN 12620:2013 NOT SEALED; 50mm AGGREGATE LAYING COURSE 2/6.3 G₆, 8/20 TO BS EN 12620:2013; GEOTEXTILE MEMBRANE (CHARCON PERMAFILTER OR SIMILAR APPROVED); 500mm MIN. FILTER MEDIA SUB-BASE WITH MIN. 30% VOID RATIO, CLEAN STONE 400 AGG. STONE TO BE CRUSHED ROCK (GRANITE, BASALT, GABBRO), CONCRETE OR BLAST FURNACE SLAG WITH LOW FINES CONTENT, WITH ROUGH AND ANGULAR PARTICLES, NOT SANDS OR GRAVELS WITH ROUNDED PARTICLES; ROBUST IMPERMEABLE GEOTEXTILE LINING TO TRENCH WALLS AND BASE; PERFORATED PIPE IN BASE TO COLLECT FLOW AND DIRECT TO DRAINAGE NETWORK.

LEGEND

- DENOTES KERB TYPE C1 (125 x 255mm) CHANNEL KERB.
- DENOTES KERB TYPE E1 (50 x 150mm) EDGE KERB.
- EXTERNAL WORKS GENERAL ARRANGEMENT TO BE READ IN CONJUNCTION WITH CURRENT ARCHITECTS SITE PLAN / LANDSCAPE ARCHITECTS SITE PLAN WHERE RELEVANT.
- +47.000 EXISTING SITE LEVEL.
- SITE BOUNDARY.

DO NOT SCALE

FOR THE AVOIDANCE OF DOUBT, NO APPROVALS, REVIEWS, COMMENTS OR INDICATION OF SATISFACTION GIVEN BY ARC ENGINEERS IN TERMS OF SUBSTRUCTURE DRAWINGS, PRODUCTS OR PROCEDURES SHALL BE REDUCED OR EXTENDED TO THE OBLIGATION OF THE SUB-CONTRACTOR OR SUPPLIER TO ADHERE TO THE SPECIFIC ARCHITECT'S DRAWINGS, STATUTORY REQUIREMENTS AND GOOD WORKING PRACTICE. ARC ENGINEERS ACCEPT NO LIABILITY FOR THE SELECTION OF MATERIALS OR WORKMANSHIP IN THE EXECUTION OF THE WORKS.

GENERAL NOTES

- THESE NOTES ARE INTENDED TO AUGMENT DRAWINGS AND SPECIFICATIONS, WHERE CONFLICT OR REQUIREMENTS EXIST, THE ORDER OF PRECEDENCE SHALL BE AS SHOWN IN THE SPECIFICATIONS, OTHERWISE THE ARCHITECT'S PRECEDENCE SHALL GOVERN.
- THE DRAWING IS TO BE READ IN CONJUNCTION WITH ALL OTHER RELEVANT ENGINEERS AND ARCHITECTS DRAWINGS.
- DRAWINGS NOT TO BE SCALED.
- ALL DIMENSIONS TO BE CHECKED ON SITE BY THE CONTRACTOR. ANY DISCREPANCIES TO BE NOTIFIED TO THE ENGINEER/ARCHITECT AND FURTHER INSTRUCTIONS OBTAINED BEFORE WORK IS COMMENCED.
- THE STRUCTURE IS DESIGNED TO BE SELF-SUPPORTING AND STABLE AFTER THE BUILDING IS FULLY COMPLETE. IT IS THE CONTRACTOR'S SOLE RESPONSIBILITY TO DETERMINE THE ERECTION PROCEDURE AND SEQUENCE AND ENSURE THAT THE BUILDING AND ITS COMPONENTS ARE SAFE DURING ERECTION. THIS INCLUDES THE ADDITION OF WATER TO TEMPORARY BRACING, GUSSET OR TIE-BEAMS WHICH MAY BE NECESSARY. SUCH MATERIAL REMAINING THE PROPERTY OF THE CONTRACTOR UPON COMPLETION.
- ALL WORK TO COMPLY TO CURRENT BUILDING REGULATIONS AND TO BE IN ACCORDANCE WITH THE RELEVANT BRITISH STANDARDS AND APPROPRIATE CODES OF PRACTICE.
- FOR FURTHER NOTES REFER TO PROJECT SPECIFICATIONS.

SAFETY, HEALTH & ENVIRONMENTAL INFORMATION

In addition to the hazards/risks normally associated with the types of work detailed on this drawing, note the following risks and information.

Risks listed here are not exhaustive. Refer to Risk Assessment Register: 24053

Construction:

Demolition:

No Unusual hazards/risks

For information relating to Use, Cleaning and Maintenance see Health & Safety File

It is assumed that all works will be carried out by a competent contractor working, where appropriate, to an approved method statement.

- INDICATES A RESIDUAL RISK REQUIRING A COMPULSORY ACTION
- INDICATES A RESIDUAL RISK FOR INFORMATION
- INDICATES A RESIDUAL RISK REQUIRING PROHIBITIVE ACTION
- INDICATES A RESIDUAL RISK AS A WARNING

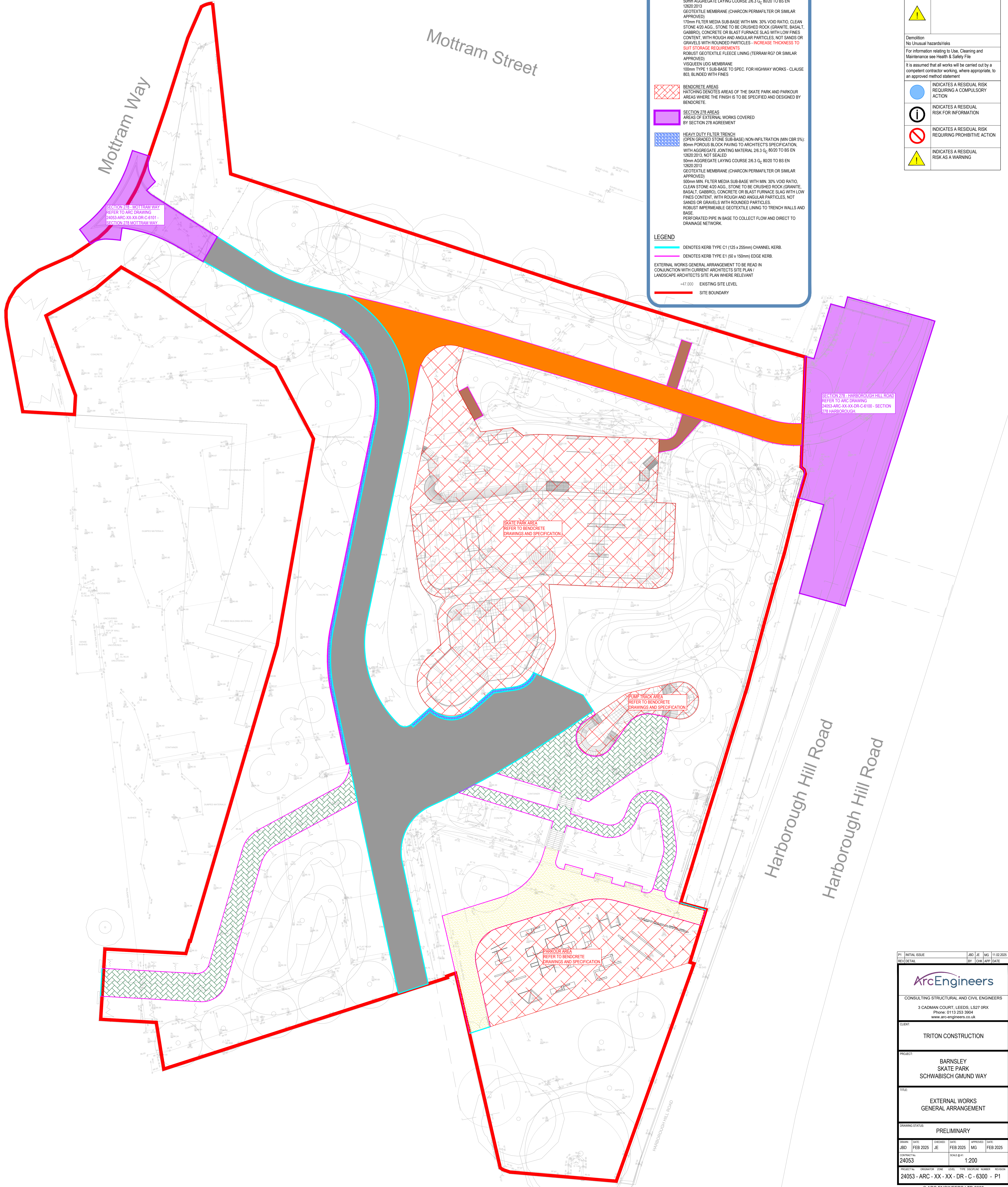

SECTION 278 - MOTTRAM WAY
REFER TO ARC DRAWING
24053-ARC-XX-XX-DR-C-6101 -
SECTION 278 MOTTRAM WAY

SKATE PARK AREA
REFER TO BENDCRETE
DRAWINGS AND SPECIFICATION

DUMP TRACK AREA
REFER TO BENDCRETE
DRAWINGS AND SPECIFICATION

PARKOUR AREA
REFER TO BENDCRETE
DRAWINGS AND SPECIFICATION

SECTION 278 - HARBOURHILL ROAD
REFER TO ARC DRAWING
24053-ARC-XX-XX-DR-C-6100 - SECTION
178 HARBOURHILL ROAD

PI	INITIAL ISSUE	ARC JE	MG	11/02/2025
REV	REVISION	BY	CHKD	DATE
ArcEngineers				
CONSULTING STRUCTURAL AND CIVIL ENGINEERS				
3 CADMAN COURT, LEEDS, LS27 0RX Phone: 0113 253 3904 www.arc-engineers.co.uk				
CLIENT:	TRITON CONSTRUCTION			
PROJECT:	BARNESLEY SKATE PARK SCHWABISCH GUMUND WAY			
TITLE:	EXTERNAL WORKS GENERAL ARRANGEMENT			
DRAWING STATUS:	PRELIMINARY			
DATE:	DATE:	DATE:	DATE:	DATE:
JBO	FEB 2025	JE	FEB 2025	MG
PROJECT NO:	24053			
SCALE:	1:200			
24053 - ARC - XX - XX - DR - C - 6300 - P1				
© ARC ENGINEERS LTD 2025				