

KERESFORTH HALL ROAD

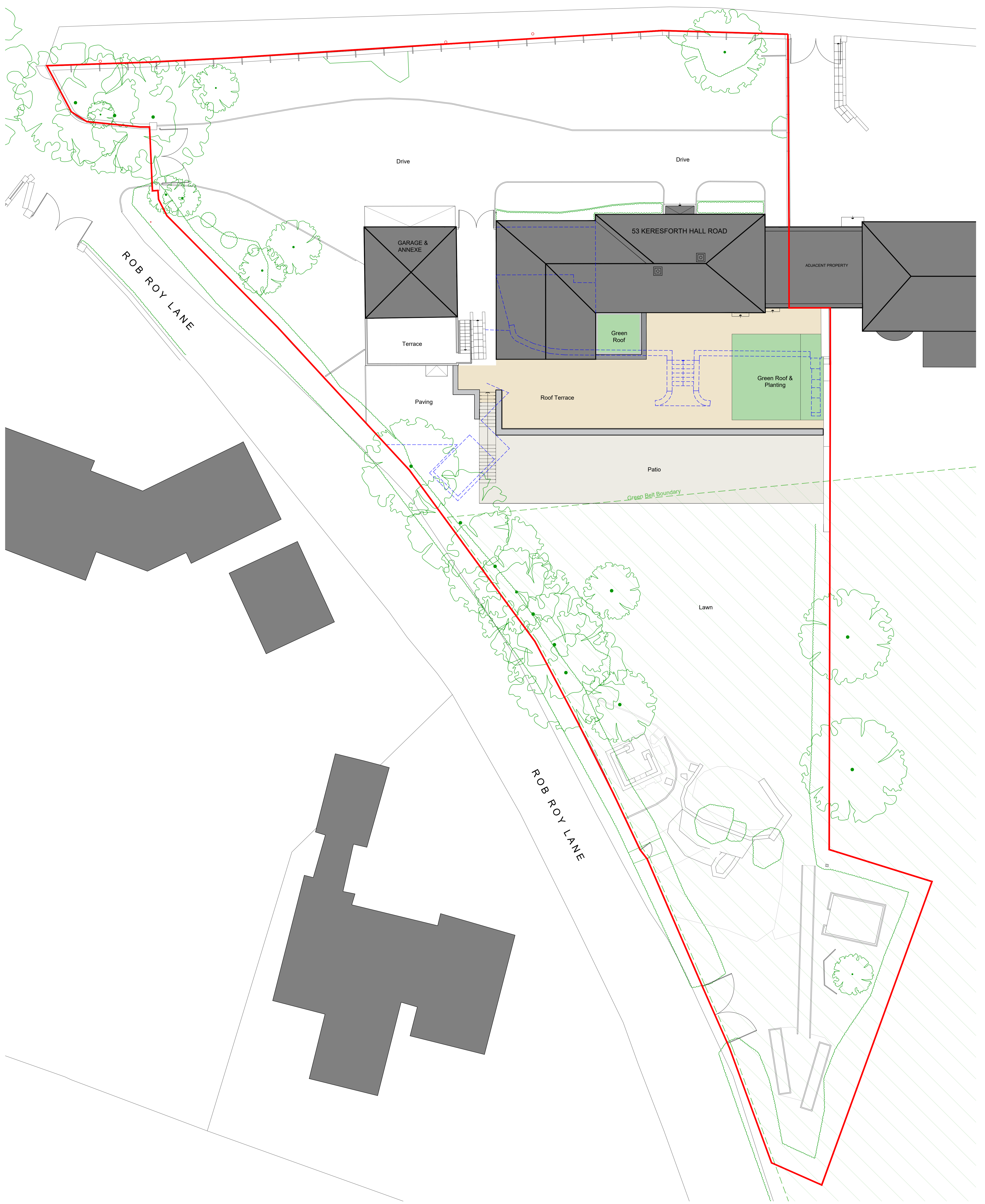

<p>Contact Us: info@s75design.com Project: 53 Keresforth Hall Road, Barnsley, S70 6NL</p>	<p>Drawing: Proposed Site Plan</p>																			
	Scale: 1:100 @ A0	Drawn: CJR	Date: Jan '26																	
	Drawing Purpose: PLANNING APPLICATION																			
	Drawing Reference: 1014-S75-XX-XX-DR-A-21001	Rev: P1	Rev:	<table border="1"> <tr> <td>02</td> <td>Drawings updated following comments from the LPA</td> <td>14.02.26</td> <td>CJR</td> <td>JK</td> </tr> <tr> <td>01</td> <td>Initial Issue</td> <td>10.01.26</td> <td>CJR</td> <td>JK</td> </tr> <tr> <td>00</td> <td>Preparation</td> <td>05.01.26</td> <td>JK</td> <td>JK</td> </tr> </table>	02	Drawings updated following comments from the LPA	14.02.26	CJR	JK	01	Initial Issue	10.01.26	CJR	JK	00	Preparation	05.01.26	JK	JK	
02	Drawings updated following comments from the LPA	14.02.26	CJR	JK																
01	Initial Issue	10.01.26	CJR	JK																
00	Preparation	05.01.26	JK	JK																
<p>Do not scale from this drawing. The contractor is to check all dimensions on site and report any discrepancies to the architect. All rights reserved in respect of the copyright, design and patents act 1988 have been generally asserted. Note:</p>																				