

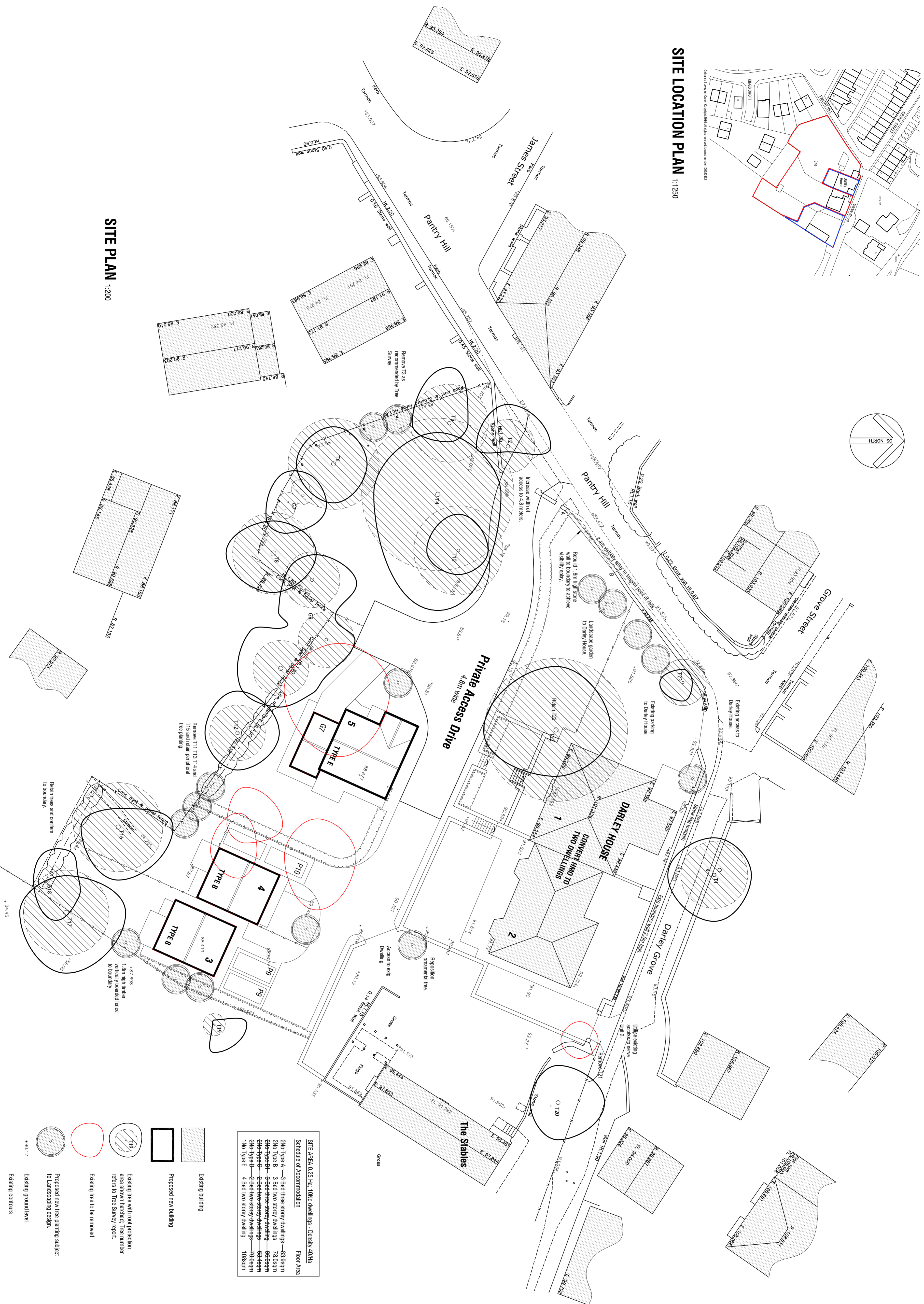





SITE LOCATION PLAN 1:1250



SITE PLAN 1:200

SITE AREA 0.25 Ha - 1000 dwellings - Density 40/Ha	Floor Area
Schedule of Accommodation	
2No Type A - 3 Bed three-storey dwellings - 65-69sqm	1300sqm
2No Type B - 3 Bed two-storey dwellings - 72.0sqm	1440sqm
2No Type C - 3 Bed three-storey dwellings - 65-69sqm	1300sqm
2No Type D - 2 Bed two-storey dwellings - 65-69sqm	1300sqm
1No Type E - 4 Bed two-storey dwelling - 108sqm	1080sqm

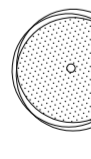
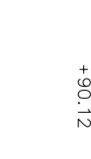
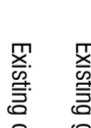
-  Existing building
-  Proposed new building
-  Existing tree with not protection area shown hatched. Tree number refers to Tree Survey report.
-  Existing tree to be removed
-  Proposed new tree planting subject to Landscaping design.
-  Existing ground level
-  Existing contours

RESIDENTIAL DEVELOPMENT
DARLEY HOUSE
PANTRY HILL
WORSBROUGH DALE
BARNSLEY

OUTLINE PROPOSALS
SITE PLAN

architectural design and building consultants

mbcohdesign
 Fairfield House
 Barnsley S70 2ET
 T: 01228 286246
 M: 07988 698300
 E: mcohdesign@btconnect.com

Scale	AS SHOWN @ A1	Drawn	MLB
Date	OCT 2017	Ref.	16 20
Dwg No.	P10	Rev.	6

06.07.2018 - Further minor alterations for planning submission.
 F 04.07.2018 - Further minor alterations for planning submission.
 E 05.06.2018 - Redesign layout.
 Reduce numbers, retain protected trees, retain existing buildings at Darley House, amend access to re-plot highways comments.
 D 26.04.18 - Redesign layout.
 C 18.01.2018 - Amend Location Plan to exclude Darley House from site, amend schedule of accommodation.
 B 20.12.2017 - Amend survey, add trackings, amend design of Units 1 and 2.
 A 02.10.17 - Amend access, add trackings, amend design of Units 1 and 2.