

403500N 439320E 439400E 403480N 403440N 403400N

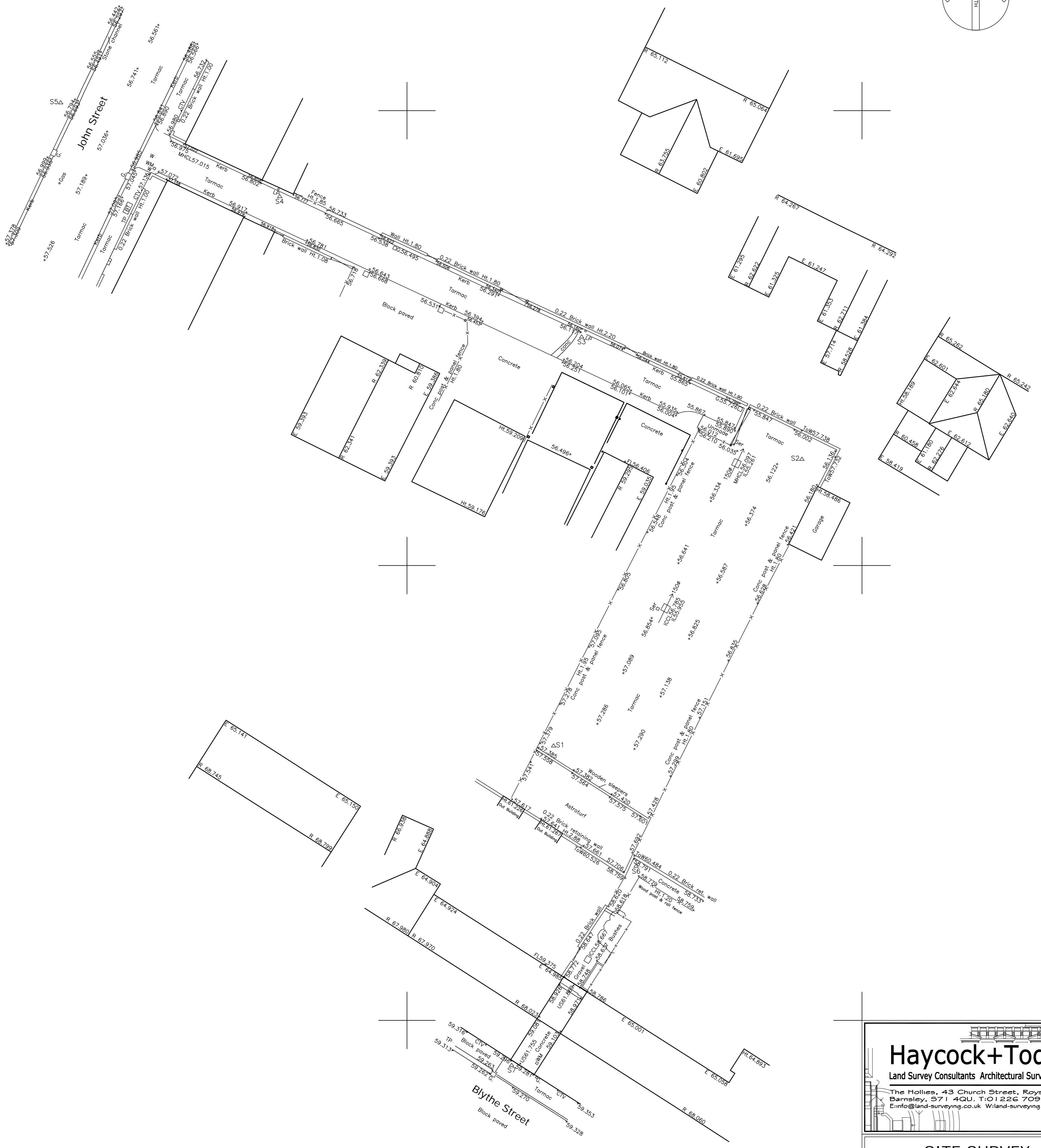
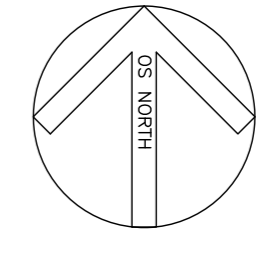

Station	Easting	Northing	Level
S1	439372.889	403424.131	57.373
S2	439394.717	403449.338	56.084
S3	439375.356	403460.090	56.111
S4	439348.811	403472.439	56.760
S5	439329.553	403480.690	56.880
S6	439380.144	403413.552	58.793
S7	439369.199	403396.045	59.294

403360N 439320E

**Haycock+Todd**  
 Land Survey Consultants Architectural Surveyors  
 The Hollies, 43 Church Street, Royston,  
 Barnsley, S71 4DU, T: 01226 709530  
 E: info@land-surveying.co.uk W: land-surveying.co.uk

**SITE SURVEY**  
**BLYTHE STREET**  
**WOMBWELL**  
**BARNSELY**

Sheet 1 of 1	Surveyed by DR
Datum	Drawn by DR
GRID: Related to Ordnance Survey using One Point Localisation on Station S2, Orientation at OS Gnd North.	Date of Survey March 2026
LEVEL: Related to Ordnance Survey by connection to the OS Active Network by G.P.S	Scale 1/200
	Survey Job No. <b>S11302</b>

LEGEND		Floor Level	FL 10.907
Manhole shown thus	oMH	Height floor to ceiling	C.2.22
Inspection Cover	oIC	Height floor to struct soffit	SS 2.87
Lamp post	oLP	Height floor to false ceiling	FC 2.22
Gully	oG	Height floor to sill	SO.67
Lampost	oLP	Height sill to window head	DI.98
Telegraph Pole	oTP	Height floor to underside	US 3.61
Electricity Pole	oEP	Ceiling Slopes Up	CSU
Road Traffic Signs	oRS	Height floor to Arch	Ar.2.99
Traffic Lights	oTL	Height floor to Arch Spring	AS.6.67
British Telecom	oBT	Vent	V
Cable Television	oCATV	Fall Pipe	FP
Fire Hydrant	oFH	Sky Light	SL
Safety Valve	oSV	Water Closet	WC
Stop tap Water	oSW	Sink	S
Stopcock Gas	oSG	Boxed Column	BC
Unknown Stoptap	oST		

403360N 439400E