

NOTES

PROTECTION OF EXISTING VEGETATION

Existing vegetation to be retained on site shall be protected where necessary during works by a tree protective barrier, secured to a scaffold tubing framework with fluorescent tape to the top rail. Protective fencing shall be erected on the canopy drip line wherever possible. Laminated, waterproof A4 signs shall be fixed to the fence posts at 10m intervals bearing the words 'PROTECTED TREE ZONE - NO STORAGE OR OPERATIONS WITHIN FENCED AREA'.

Tracking of machinery, storage of chemicals and building materials shall not be permitted within the protected area. Leaks or spills should be removed immediately and the contaminated soil replaced. No bonfires shall be lit within 5m of the canopy spread. Any excavation work beneath the canopy spread shall be carried out by hand.

All works affecting trees within the development shall be subject to BS 5837:2012.

TREE PLANTING

Tree planting to the front gardens of selected plots will break up the hard lines of the buildings and create focal points within the development. The tree species selected will maximise food and nectar sources for birds and invertebrates. Trees will be planted as Select and Heavy Standards to provide a reasonable degree of instant maturity to the development. Foundation design of new buildings shall accommodate proposed tree planting in accordance with NHBC guidelines.

Suggested species:

Acer campestre 'Streetwise' (AcS)	Prunus padus (Pp)
Acer rubrum (Ar)	Prunus subhirtella 'Autumnalis' (PsA)
Acer platanoides 'Laciniatum' (Apl)	Pyrus calleryana 'Chanticleer' (PcC)
Alnus glutinosa (Ag)	Quercus robur (Qr)
Betula pubescens (Bpu)	Sorbus aria (Sa)
Carpinus betulus (Cb)	Sorbus aucuparia (Sau)
Fagus sylvatica (Fs)	Sorbus aucuparia 'Asplenifolia' (SaA)
Malus sylvestris (Ms)	Sorbus 'Embley' (SE)
Malus tschonoskii (Mt)	Tilia cordata (Tc)

SHRUB PLANTING

A mix of evergreen and deciduous shrubs will be planted in selected front gardens to soften the development and to provide a valuable food source for birds and invertebrates. A mix of medium/low shrubs will be planted to shrub beds with medium/large varieties used against high walls and hedges.

Suggested species: () density/m2

Berberis candidula 'Amstelveen' (5), Berberis thunbergii 'Atropurpurea Nana' (6), Ceanothus thyrsiflorus repens (5), Choisya ternata 'Sundance' (4), Cotoneaster conspicuus 'Decorus' (4), Cytisus praecox 'Albus' (4), Euonymus fortunei 'Emerald 'n' Gold' (6), Fuchsia 'Mrs Popple' (4), Hebe 'Red Edge' (5), Hebe 'Autumn Glory' (4), Hebe 'Mrs Winder' (4), Hypericum moserianum (5), Lavandula angustifolia 'Hidcote' (6), Lavandula angustifolia 'Munstead' (6), Lonicera pileata (5), Philadelphus 'Manteau d'hermine' (3), Prunus laurocerasus 'Low 'n' Green' (4), Rosa 'Swany' (4), Sarcococca confusa (5), Spiraea japonica 'Goldflame' (4), Viburnum davidii (5).

HEDGE PLANTING

Hedges will be planted in selected plots to strengthen boundaries and improve screening. Ornamental hedge planting will consist of Beech & Escallonia, which will contribute to all year round colour and texture. Hedges are to be planted as a double staggered row of 40-60cm high hedging plants.

NATIVE HEDGE PLANTING

Native hedgerows will be planted to improve wildlife foraging opportunities. Native hedge planting will consist of Blackthorn, Spindle, Dog rose, Guelder rose and Hazel. Hedges are to be planted as a double staggered row of 40-60cm high hedging plants.

KEY

	Existing trees/vegetation to be retained with root protection area
	Existing trees/vegetation to be removed
	Proposed Extra heavy standard (14-16cm girth) tree
	Proposed heavy standard (12-14cm girth) tree
	Proposed selected standard (10-12cm girth) tree
	Proposed orchard trees
	Proposed Beech hedging Proposed evergreen flowering hedge (Escallonia)
	Proposed native hedge
	Proposed mixed native species shrub planting
	Proposed mixed native species tree & shrub planting
	Proposed ornamental shrub planting
	Proposed turf
	Rear gardens
	Existing sward to be retained and enhanced
	Existing sward/ species rich grass seed to be kept closely mown
	Proposed wildflower grass seed (EM2)
	Proposed wetland wildflower grass seed for basin (EM8)
	Species rich grassland (EL1)
	Mowing line
	Proposed 1800mm high close boarded timber fencing (detailed by others)
	Proposed 1800mm high double sided timber fencing (detailed by others)
	Proposed vertical metal railing (detailed by others)
	Proposed 450mm high timber trip rail (detailed by others)
	Proposed brick walls (detailed by others)
	Proposed drystone walls (detailed by others)

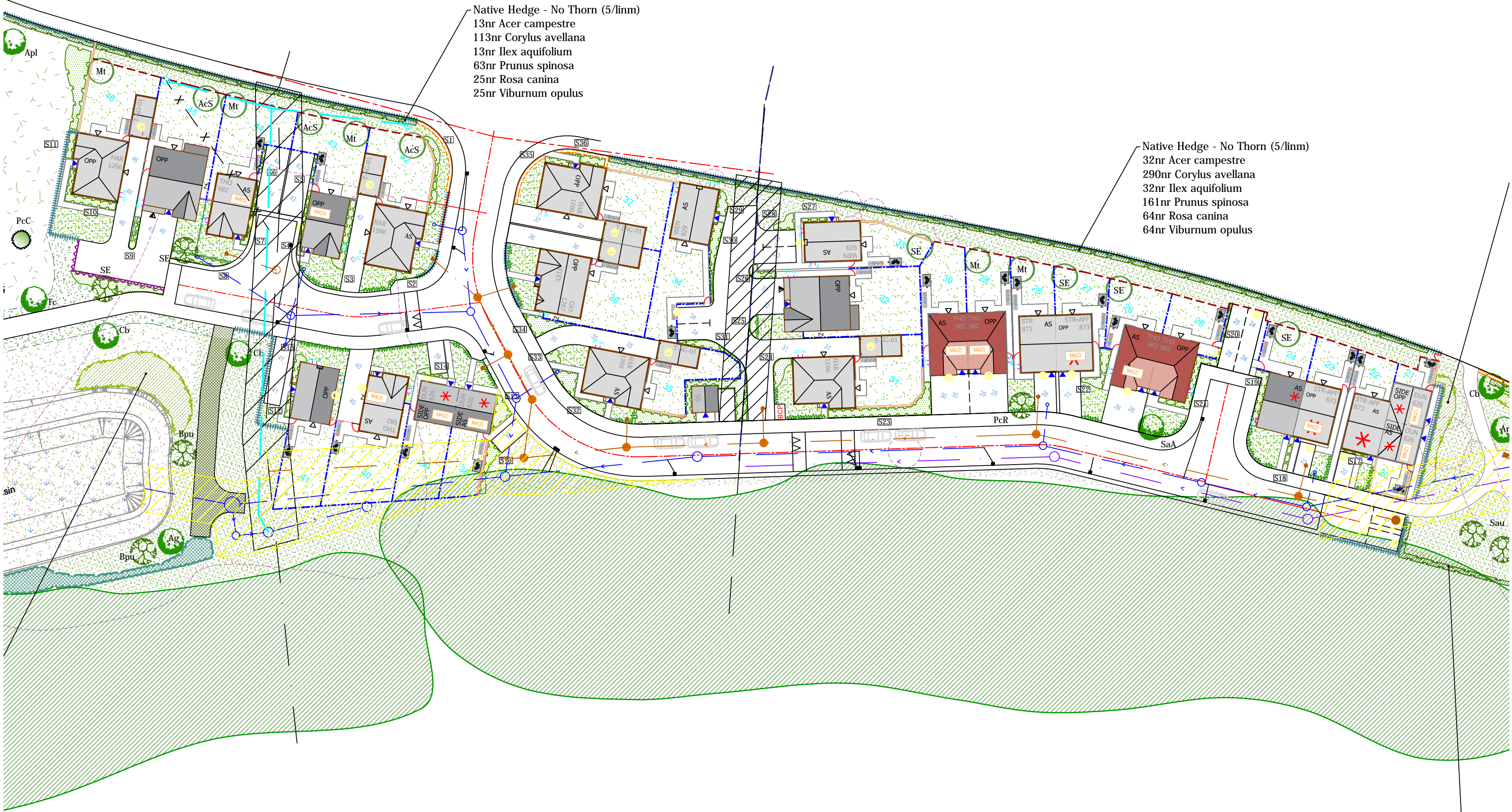

TO BE READ IN CONJUNCTION WITH R/2675/2G AND R/2675/3G

Rev G:	Site updated to latest Planning Drawing 2239.01.AK and drainage information added (CS)	May 24
Rev F:	Planting Mix labels added (CS)	Mar 24
Rev E:	Whole site updated to latest Duchy Drawing 2239.01 AJ (CS)	Mar 24
Rev D:	Whole site updated to latest Duchy Drawing 2239.01 AG Plant bed labels and Tree codes added (CS)	Mar 24
Rev C:	Addition of community orchard and open ditch to key (SF)	June 23
Rev B:	Whole site updated to latest Duchy drawing 2239.01.V	March 23
Rev A:	Whole site updated to latest Duchy drawing 2239.01.S	Feb 23

 Westleigh Hall Wakefield Road Denby Dale Huddersfield HD8 8QJ telephone 01484 861611 fax 01484 861616 isdn 01484 866900 email info@fdalandscape.co.uk www.fdalandscape.co.uk	client Duchy Homes		project Residential Development	
	DARTON LANE, DARTON			
	drawing title LANDSCAPE MASTERPLAN WESTERN PORTION			
	scale 1:500 @A1	date Jan 23	dwn by MBN/SF	drawing no R/2675/1G