

This survey has been prepared on the basis of information provided to ACS Consulting and is not intended to be used for any other purpose. ACS Consulting does not accept liability for any loss or damage caused by the use of this information. The accuracy of the information is not guaranteed. The information is provided for the use of the client and is not intended to be used for any other purpose. ACS Consulting is not responsible for any loss or damage caused by the use of this information. All data shown on the map is the property of ACS Consulting and is not to be used for any other purpose without the written consent of ACS Consulting.

**Arboricultural Legend** (where applicable)

- INDIVIDUAL TREE
- INDICATIVE EXTENT OF GROUPED FEATURE
- CATEGORY GRADE A  
Trees of high quality
- CATEGORY GRADE B  
Trees of moderate quality
- CATEGORY GRADE C  
Trees of low quality
- CATEGORY GRADE U  
Trees unsuitable for retention
- ROOT PROTECTION AREA (RPA)  
As defined (BS5837 2012 4.6.2)
- ROOT PROTECTION AREA (RPA)  
As defined (BS5837 2012 4.6.2)
- BRIDGE SEDIMENT
- Tree subject to TPO
- SITE BOUNDARY
- OFF-SITE TREES AS RECORDED ON TOPOGRAPHICAL SURVEY

**TREE CATEGORIES**  
Tree categories have been measured and plotted at their central points for clarity and presentation purposes.

**ROOT PROTECTION AREA (RPA)**  
The Root Protection Area (RPA) is a hatched area indicating the minimum area around a tree deemed to contain sufficient roots and root structures to be retained and where protection of the roots and soil structure is to be treated as a priority. (Refer to main report for further details).

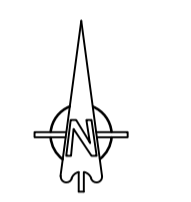

**General Notes**

1. The arboricultural survey is based on the supplied topographical survey. This may contain inaccurate information.
2. The accuracy of the tree/feature location cannot be guaranteed.
3. All arrows on steps / ramps etc indicate an LP direction unless otherwise stated.
4. Contours are shown on soft detail areas only (where applicable) and annotated at the interval identified above. Hard detail areas may be contoured if specifically requested.
5. Site traffic or obstructions encountered at the time of the survey may have resulted in tree/brush features being omitted.

**Survey Control**

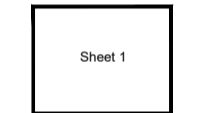

Rev	Date	Description	CAD
Client			

Prism Ag

ACS Consulting  
Barnley  
01619 755402  
info@acsconsulting.co.uk

ACS Consulting  
272 Main Street  
Goleen  
CO. AOH  
01411 334 813  
info@acsconsulting.co.uk

**Arboricultural Survey**  
56 Hill End Road,  
Mapplewell, Barnsley

Plotted Scale: A1@1:200

Surveyor: IRM	CAD: SPT	Checker: IRM	Rev:
Date of Issue: June 2022	ACS Ref No: TCP14644/Y/100		

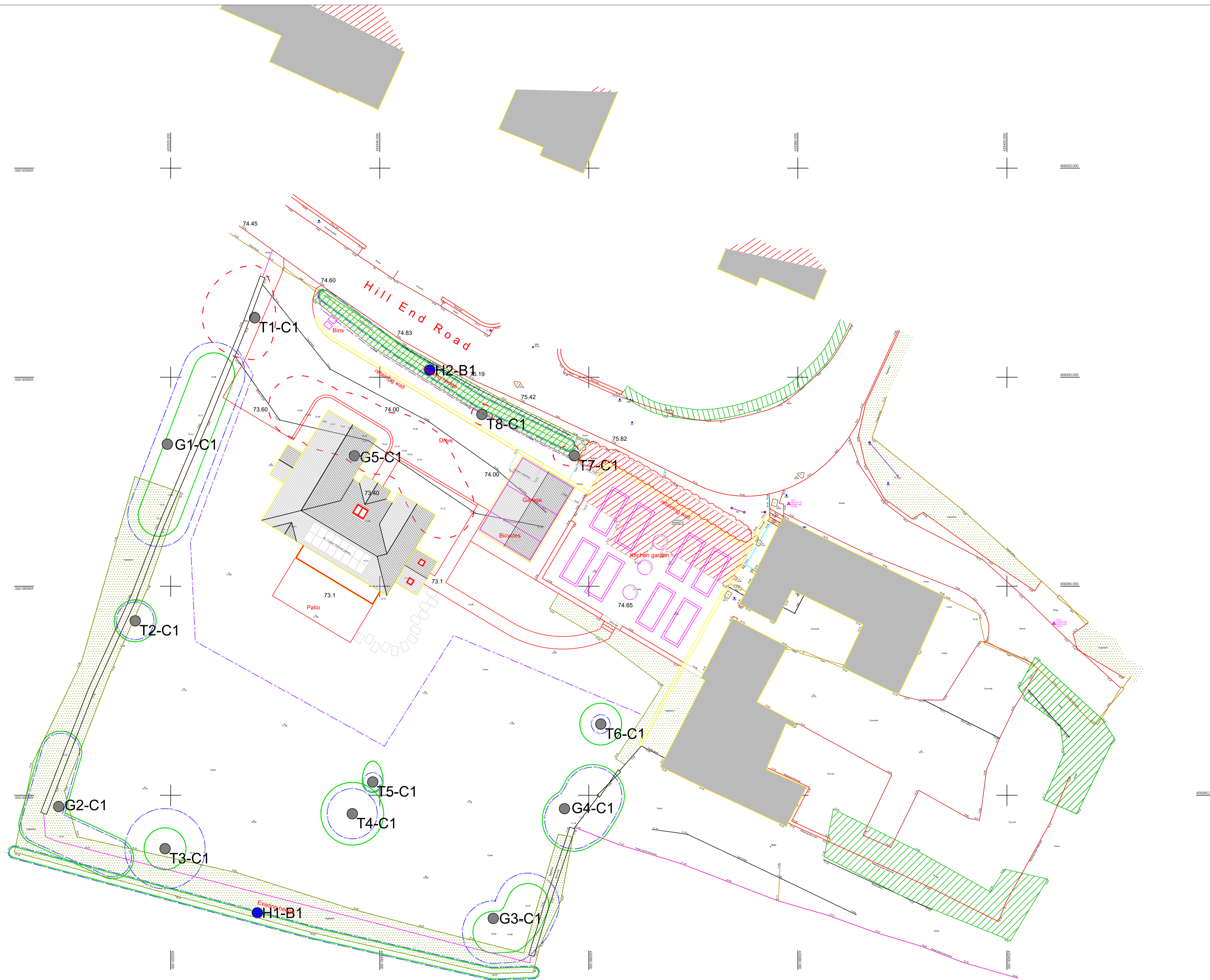

This survey has been undertaken at the address above and the information contained herein is for the use of the client only. It is not to be used for any other purpose. The accuracy of the information is not guaranteed. The client is responsible for the accuracy of the information. The client is responsible for the accuracy of the information. The client is responsible for the accuracy of the information.

**Arboricultural Legend**  
(where applicable)

- TREES GROUPS OR HEDGES TO BE RETAINED
- TREES GROUPS OR HEDGES TO BE REMOVED
- ROOT PROTECTION AREAS (RPA)
- TREE PROTECTION FENCING (TPF)
- TREE PROTECTION FENCING (TPF)
- TAMER BOX PROTECTION
- TEMPORARY CIRCUIT PROTECTION
- SHADE SEGMENT CAST BY TREE

- NOTES:**
- TREE CANOPIES HAVE BEEN MEASURED AND PLOTTED AT THEIR CORNER POINTS FOR CLARITY AND PRESENTATION PURPOSES. APPROXIMATE VALUES OF OFF-SITE TREES HAVE BEEN APPROXIMATED. APPROXIMATE VALUES OF OFF-SITE TREES HAVE BEEN APPROXIMATED.
  - THE ROOT PROTECTION AREAS (RPA) ARE A DESIGN TOOL TO PROTECT THE ROOTS OF TREES. THE RPA IS DESIGNED TO CONTAIN SUFFICIENT ROOTS AND PROTECT VOLUME TO MAINTAIN THE TREE'S STABILITY AND HEALTH. PROTECTION OF THE ROOTS AND SOIL STRUCTURE IS TO BE TREATED AS A PRIORITY. REFER TO MAIN REPORT FOR FURTHER DETAILS.
  - THE SURVEY HAS BEEN UNDERTAKEN AT THE TIME OF THE SURVEY. THE SURVEY MAY HAVE RESULTED IN ARBORICULTURAL FEATURES BEING OBTAINED OR IDENTIFIED THAT WERE NOT IDENTIFIED AT THE TIME OF THE SURVEY.
  - TREE WORKS ARE TO BE UNDERTAKEN BY QUALIFIED CONTRACTORS TO REMOVED TREES.
  - THE RPA ARE TO BE UNDERTAKEN BY QUALIFIED CONTRACTORS TO REMOVED TREES.
  - THE ARBORICULTURAL SURVEY IS BASED ON THE SUPPLIED TOPOGRAPHICAL SURVEY. THE LOCATION OF FEATURES IDENTIFIED HAS NOT BEEN CHECKED.
  - ALL WORKS SHOULD BE UNDERTAKEN IN ACCORDANCE WITH THE ARBORICULTURAL METHOD STATEMENT BY ACS CONSULTING.
  - THESE DRAWINGS ARE FOR PLANNING PURPOSES ONLY. THESE DRAWINGS ARE TO BE READ IN CONJUNCTION WITH THE ARBORICULTURAL METHOD STATEMENT BY ACS CONSULTING.
  - THESE DRAWINGS ARE FOR PLANNING PURPOSES ONLY. THESE DRAWINGS ARE TO BE READ IN CONJUNCTION WITH THE ARBORICULTURAL METHOD STATEMENT BY ACS CONSULTING.
  - THESE DRAWINGS ARE FOR PLANNING PURPOSES ONLY. THESE DRAWINGS ARE TO BE READ IN CONJUNCTION WITH THE ARBORICULTURAL METHOD STATEMENT BY ACS CONSULTING.
  - THESE DRAWINGS ARE FOR PLANNING PURPOSES ONLY. THESE DRAWINGS ARE TO BE READ IN CONJUNCTION WITH THE ARBORICULTURAL METHOD STATEMENT BY ACS CONSULTING.
  - THESE DRAWINGS ARE FOR PLANNING PURPOSES ONLY. THESE DRAWINGS ARE TO BE READ IN CONJUNCTION WITH THE ARBORICULTURAL METHOD STATEMENT BY ACS CONSULTING.
  - THESE DRAWINGS ARE FOR PLANNING PURPOSES ONLY. THESE DRAWINGS ARE TO BE READ IN CONJUNCTION WITH THE ARBORICULTURAL METHOD STATEMENT BY ACS CONSULTING.
  - THESE DRAWINGS ARE FOR PLANNING PURPOSES ONLY. THESE DRAWINGS ARE TO BE READ IN CONJUNCTION WITH THE ARBORICULTURAL METHOD STATEMENT BY ACS CONSULTING.
  - THESE DRAWINGS ARE FOR PLANNING PURPOSES ONLY. THESE DRAWINGS ARE TO BE READ IN CONJUNCTION WITH THE ARBORICULTURAL METHOD STATEMENT BY ACS CONSULTING.

THIS DRAWING SHOULD BE READ IN CONJUNCTION WITH ACS CONSULTING ARBORICULTURAL METHOD STATEMENT

**General Notes**

- The arboricultural survey is based on the supplied topographical survey. This may contain inaccurate information.
- The accuracy of the tree/feature location cannot be guaranteed.
- All arrows on slope ramps etc indicate an UP direction unless otherwise stated.
- Contours are shown on soft detail areas only (where applicable) and annotated at the interval identified above. Hand detail areas may be contoured if specifically requested.
- Site traffic or obstructions encountered at the time of the survey may have resulted in tree/feature features being omitted.

**Survey Control**

Sheet 1

Rev	Date	Description	CAD
Client			
		Prism Ag	

ACS Consulting  
Barnsley  
Kiveton Park  
01905 755402  
m@acsconsulting.co.uk

ACS Consulting  
272 Hill Street  
Glossop  
01454 354103  
g@acsconsulting.co.uk

**Arboricultural Layout**  
56 Hill End Road  
Mapplewell, Barnsley

Plotted Scale: A1@1:200

Surveyor: IRM	CAD: SPT	Checker: IRM	Rev:
Date of Issue: Oct 2022	ACS Ref No: ARB4644/Y200		

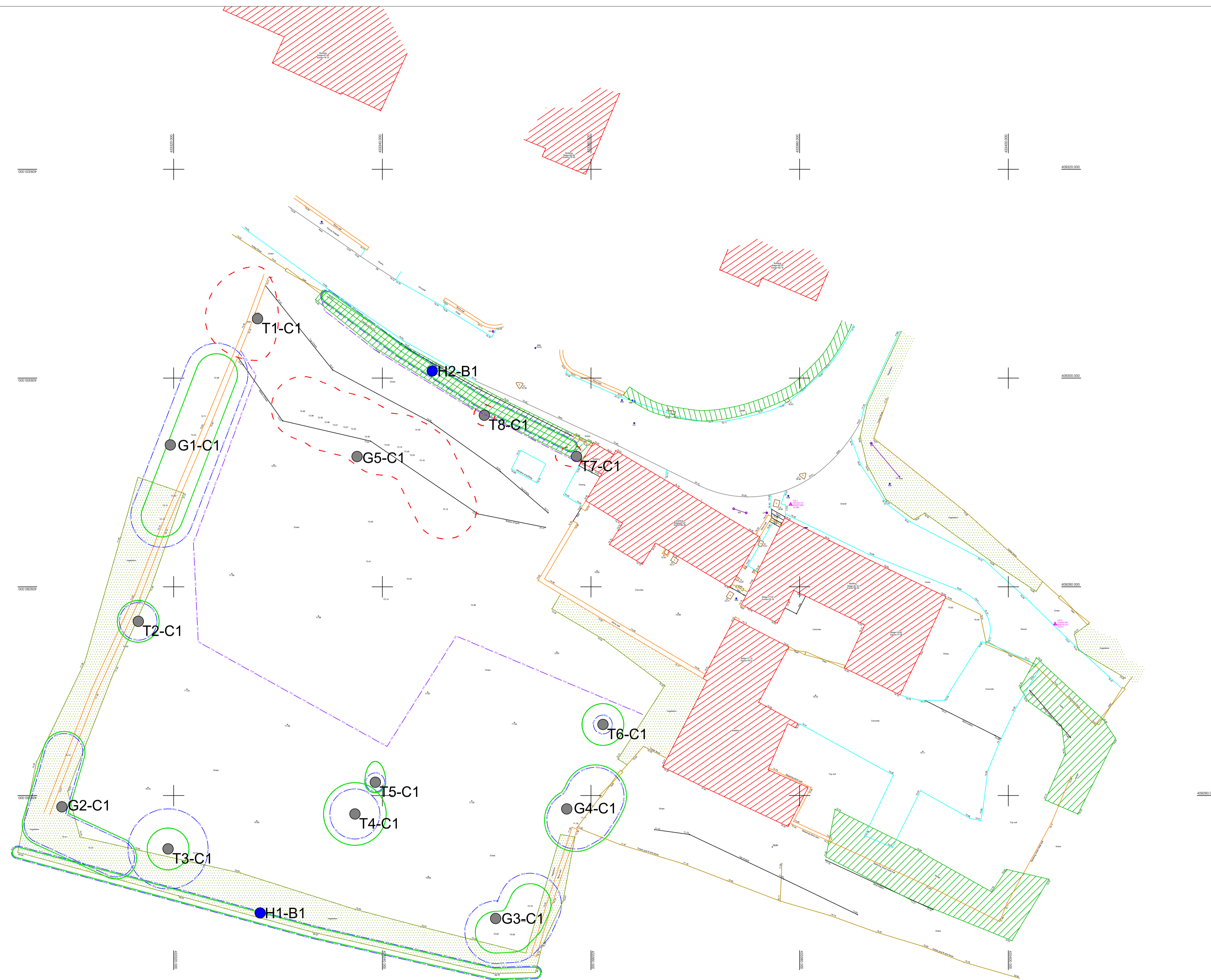

This survey has been undertaken in accordance with the relevant standards and codes of practice. The accuracy of the survey is dependent on the quality of the data provided to ACS Consulting. The accuracy of the survey is dependent on the quality of the data provided to ACS Consulting. The accuracy of the survey is dependent on the quality of the data provided to ACS Consulting.

**Arboricultural Legend**  
(where applicable)

- TREES GROUPS OR HEDGES TO BE RETAINED
- TREES GROUPS OR HEDGES TO BE REMOVED
- ROOT PROTECTION AREAS (RPA)
- TREE PROTECTION FENCING (TPF)
- TREE PROTECTION FENCING (TPF)
- TAMBER BOX PROTECTION
- TEMPORARY CIRCUIT PROTECTION
- BRIDGE SEGMENT CAST BY TREE

- NOTES:**
- TREE CANOPIES HAVE BEEN MEASURED AND PLOTTED AT THEIR CORNER POINTS FOR CLARITY AND PRESENTATION PURPOSES.
  - THE LOCATION AND DIMENSIONS OF OFF-SITE TREES HAVE BEEN APPROXIMATED UNLESS OTHERWISE STATED.
  - THE ROOT PROTECTION AREAS (RPA) AS A RESULT OF THE DESIGN TOOL, INDICATE THE PROTECTIVE MEASURES THAT SHOULD BE TAKEN TO MAINTAIN THE TREE'S STABILITY AND THE PROTECTION OF THE ROOTS AND SOIL STRUCTURE IS TO BE TREATED AS A PRIORITY. REFER TO MAIN REPORT FOR FURTHER DETAILS.
  - THE SURVEY MAY HAVE REVEALED AN UNEXPECTED FEATURE BEING OBTAINED ON THIS SITE. THIS FEATURE HAS BEEN IDENTIFIED AND NOTED ON THIS DRAWING.
  - TREE WORKS ARE TO BE UNDERTAKEN BY QUALIFIED CONTRACTORS TO REMOVED TREES.
  - THE LOCATION OF ANY PROPOSED BRIBES AND BARS TO BE INSTALLED SHOULD BE CHECKED WITH THE SUPPLIER.
  - THE ARBORICULTURAL SURVEY IS BASED ON THE SUPPLIED TOPOGRAPHICAL SURVEY. THE LOCATION OF FEATURES SHOWN HAS NOT BEEN CHECKED.
  - DO NOT SCALE FROM THIS DRAWING.
  - ALL DIMENSIONS ARE IN METRES UNLESS OTHERWISE STATED.
  - THIS DRAWING IS TO BE READ IN CONJUNCTION WITH THE ARBORICULTURAL METHOD STATEMENT BY ACS CONSULTING.
  - THESE DRAWINGS ARE FOR PLANNING PURPOSES ONLY.
  - TREE PROTECTION FENCING TO BE INSTALLED IN ACCORDANCE WITH BS5838:2012. TREES WITH PROTECTIVE FENCING SHOULD BE IDENTIFIED WITH A SIGN.
  - TREE PROTECTION MEASURES TO BE INSTALLED PRIOR TO WORKS COMMENCING.
  - WHERE THE SITE IS FOR ENCROACHMENT WITH A TREE ROOT PROTECTION AREA (RPA) EXISTS OR NECESSARY WORKS WITHIN THE RPA ARE TO BE UNDERTAKEN, THESE MUST BE ACCORDANCE WITH THE APPROVED METHOD STATEMENT BY ACS CONSULTING.
  - ALL TREE OPERATIONS SHOULD BE MADE AWARE THROUGH A SITE VISIT AND A TREE SURVEY. THE TREE SURVEY SHOULD BE MADE AWARE THROUGH A SITE VISIT AND A TREE SURVEY. THE TREE SURVEY SHOULD BE MADE AWARE THROUGH A SITE VISIT AND A TREE SURVEY.
- THIS DRAWING SHOULD BE READ IN CONJUNCTION WITH ACS CONSULTING ARBORICULTURAL METHOD STATEMENT

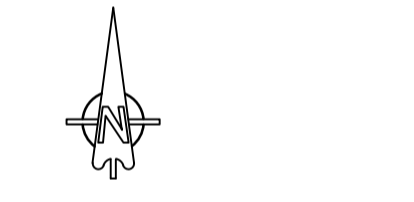

**General Notes**

- The arboricultural survey is based on the supplied topographical survey. This may contain inaccurate information.
- The accuracy of the tree/feature location cannot be guaranteed.
- All arrows on slope ramps etc. indicate an UP direction unless otherwise stated.
- Contours are shown on soft detail areas only (where applicable) and annotated at the interval identified above. Hard detail areas may be contoured if specifically requested.
- Site traffic or obstructions encountered at the time of the survey may have resulted in tree/feature features being omitted.
- NOT FOR CONSTRUCTION.

**Survey Control**

Sheet 1

Rev	Date	Description	CAD
Client			
		Prism Ag	

ACS Consulting  
 172 Hill Street  
 Glasgow  
 G2 4JF  
 0141 554 444  
 info@acsconsulting.co.uk

ACS Consulting  
 172 Hill Street  
 Glasgow  
 G2 4JF  
 0141 554 444  
 info@acsconsulting.co.uk

**Tree Protection Plan - Planning**

56 Hill End Road  
 Mapplewell, Barnsley

Plotted Scale: A1@1:200

Surveyor: IRM	CAD: SPT	Checker: IRM	Rev:
Date of Issue: Oct 2022	ACS Ref No: TPP14644/Y/300		

