

CLIENT :
ICELAND

PROJECT :
TFWH EXTERNAL SIGNAGE

SITE REFERENCE :
BARNSELEY

PRODUCT TYPE/DOCUMENT TITLE :

--

A Merson Group Business

MERSON-ASG
SIGNAGE & BRANDING

DRAWING / DOCUMENT No :
CD-B02319-1

FILE PATH:
L:\webbs\B02319TFW\Barnsley\External\2\DESIGN\3\VISUALS\SCHEDULE\CD-B023191

ISSUE : DATE :
1 **26.10.16**

DESIGN STATUS :
NOT FOR CONSTRUCTION

DESIGN REGISTER

Our design information is issued as a multi-page document. Each document has a unique number and each drawing or page a sequential number of that. Individual drawings/pages within a document have a revision status marked by a letter and a red rev' cloud on the drawing. Each document issue is marked by a number, the table below provides a history of this document.

ISSUE :	DATE :	DESIGNER :	CHECKED :	APPROVED :	DESIGN STATUS :	SUMMARY OF ISSUE :
1	26.10.16	OM	--	--	NOT FOR CONSTRUCTION	INITIAL PROPOSAL

RISK ELEMENTS

During design development risks are identified on drawings/pages using a bold red dashed box. This could be information or detail yet to be confirmed leading to risk in proceeding or ones that remain in the design but highlighted to reduce risk to construction, safety, health or the environment. The table below shows numbered risks and how these have been managed.

RISK No :	DESCRIPTION OF RISK :	RESOLUTION AGREED :
--	--	--

INDICATED BY : **-----**

FRONT ELEVATION
@ 1:100



FLEX SKIN LAYOUT
@ 1:50



FLEXBOX SPECIFICATION

- 01 Flex box frame constructed from SignComp extrusion. Frame to be etched and powder coated RAL 7011 30-40% matt finish.
- 02 The slate grey prints are to be printed on to one layer of block out 3M 3635-20b (black adhesive, white faced block out material), then to have one layer of 'Clear gloss' 3M 8518 vinyl over laminate to be applied to the face of the printed material only. Roundel to be 3M 3630-33 (Red) and 3M 100 series (Black) applied to the face of the skin material. Text to be weeded out.
- 03 Illumination provided by GE Tetra PowerMAX 4100 / GE PS12 12 volt - 60watt PSU's
- 04 2.5mm thick aluminium rear panel.

SECTION A-A
@ 1:5

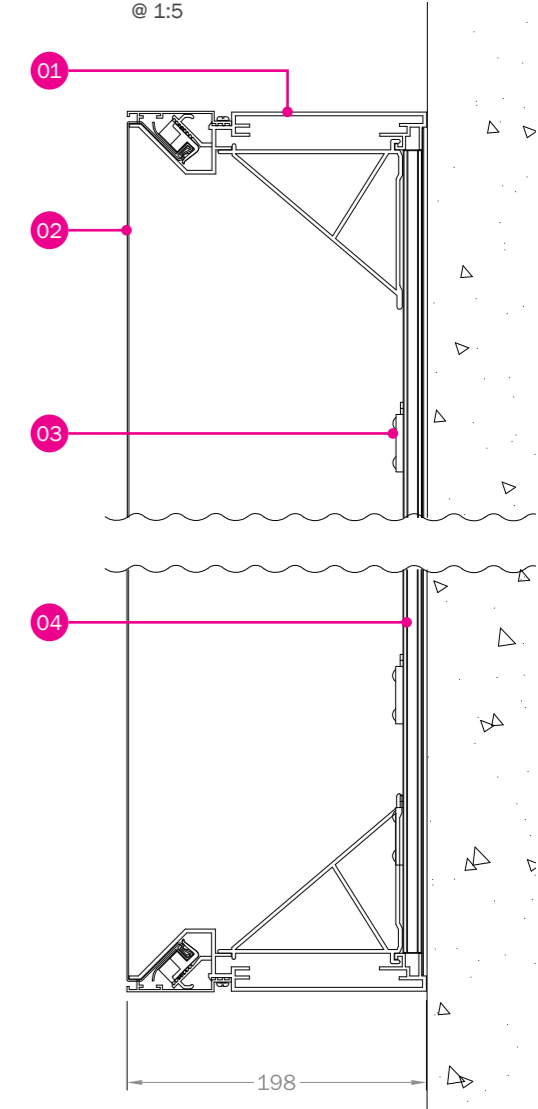

HTUS - 3000mm
Colour Red – approx. 35 cd/m²
Colour White – approx. 300 cd/m²
Colour Black (with red vinyl applied on back) – approx. 10 cd/m²

FLEX SKIN - SHOWING LEDS
@ 1:50



APPROX 876 MODS

FLEX FRAME - SPLITS
@ 1:50

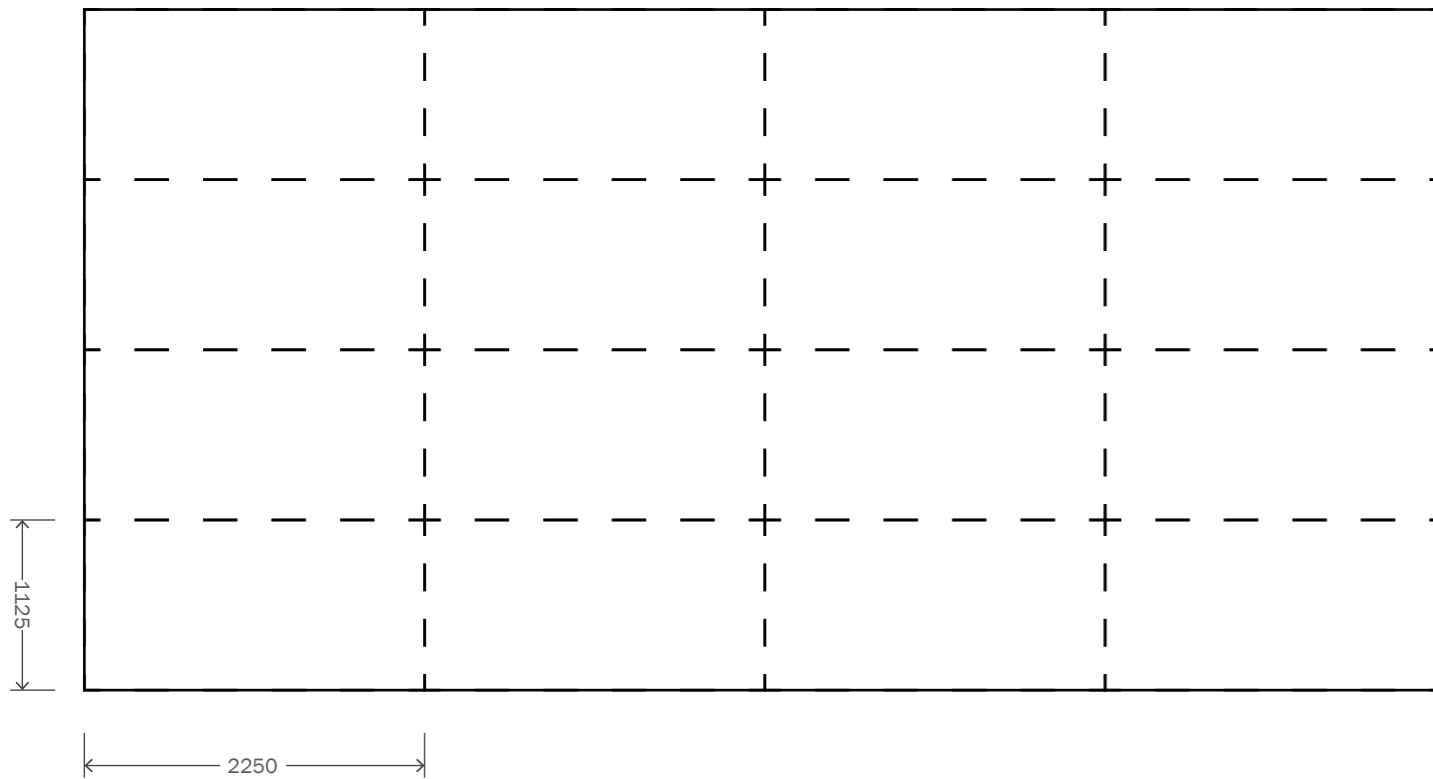

TOTEM VINYL

Rear adhesive double layer printed vinyl applied to existing totems.
 3 off req. for Totem A
 2 off req. for Totem B

TOTEM A - 3 SIDED



TOTEM A - 3 SIDED



TOTEM B - 2 SIDED



TOTEM VINYL
NTS





A Merson Group Business

MERSON-ASG

SIGNAGE & BRANDING

MERSON-ASG SIGNAGE & BRANDING
2 YOUNG PLACE
EAST KILBRIDE
GLASGOW
SCOTLAND
G75 0TD