

Terry STEPLIFT 1000

Uniclass L771:N5352	EPIC N1:Y311
CI/SfB (66.1) X (U35)	

01/11/2004

The Terry STEPLIFT 1000 is the ideal solution to wheelchair access problems in domestic situations



TSL 1000 with upper level gate



TSL 1000 with double step bridging unit in line with door way



TSL 1000 with triple step bridging unit and upper level landing

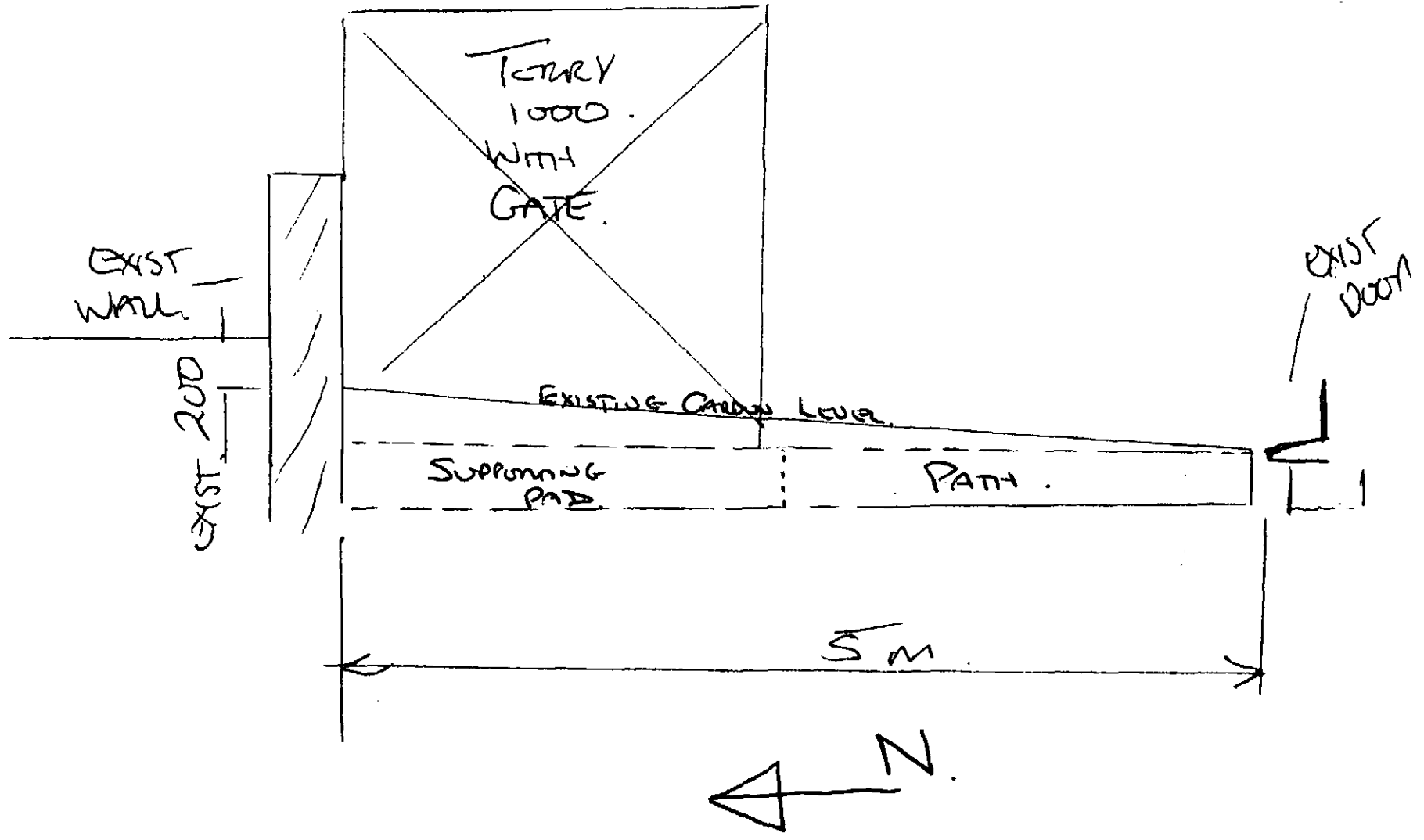

DEVELOPMENT MANAGEMENT © BIRMIK .JAN. 06

NOTES

(ED10111)

TSL1000 (1400 x 800 & std. ramp) Site Preparation Details

Rise must be smooth and flush. Height of rise must not exceed 290mm without upper level protection. This face must be structural.

Ensure adequate drainage when lift is outside. Drainage grooves position to suit site requirements. 600mm max between grooves.

Base to be level to +/- 5mm over base area.

Door way centre line

Dimensions shown with power pack on LHS. Reverse if power pack on RHS

Min wall or obstruction clearance

Upper floor see page 20

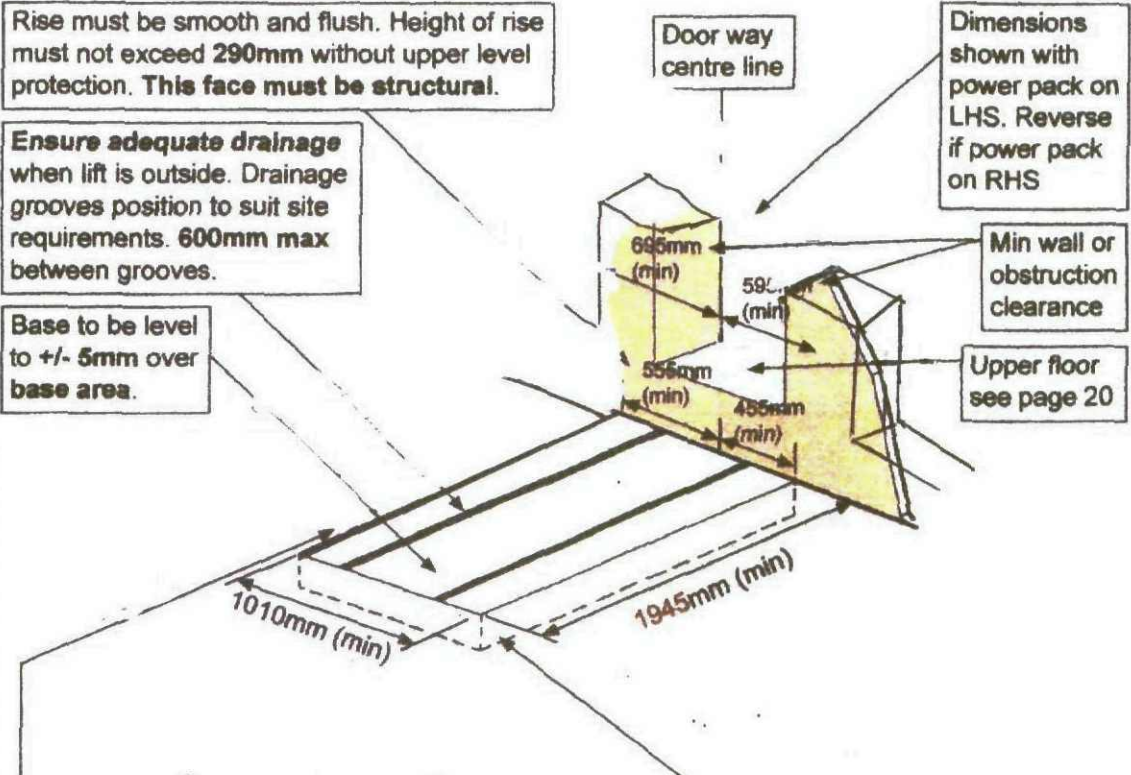

UPDATE *

NOTE 150mm clearance required to any wall or obstruction around lift OR with no handrail on wall side, 10mm max to flush vertical, smooth wall - throughout full travel height and to 1100mm at upper level (NB 150mm clearance still required on the opposite wall if handrail retained).

100mm (min) thick concrete base or suspended floor with well secured 18mm plywood covering (WBP grade).

UPDATE *

Lift dimensions

a	990mm
b	476mm
c	1450mm
d	900mm

UPDATE *

Allow 10mm between lift and wall

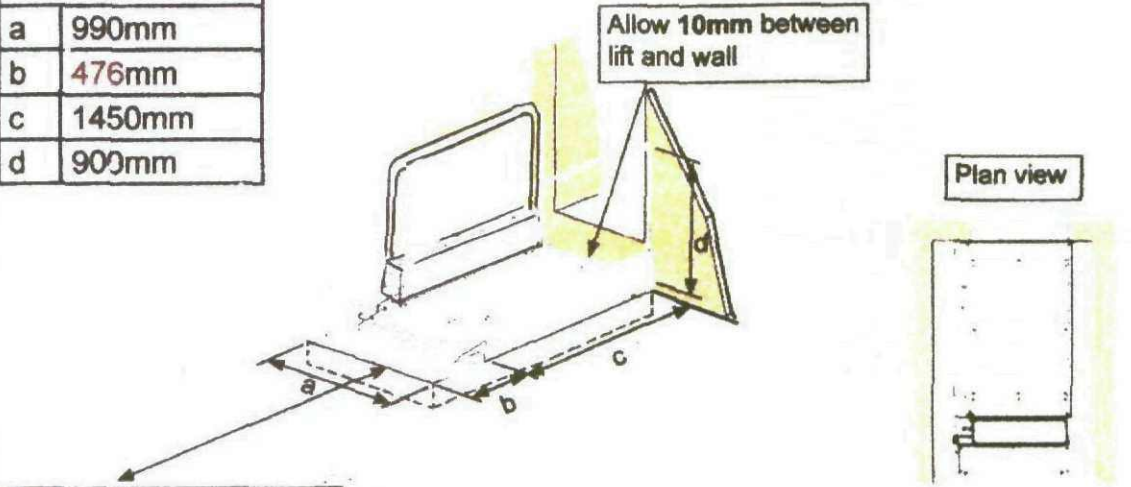

UPDATE *

1200mm circulation space.

TSL1000 Upper Level Gate Details

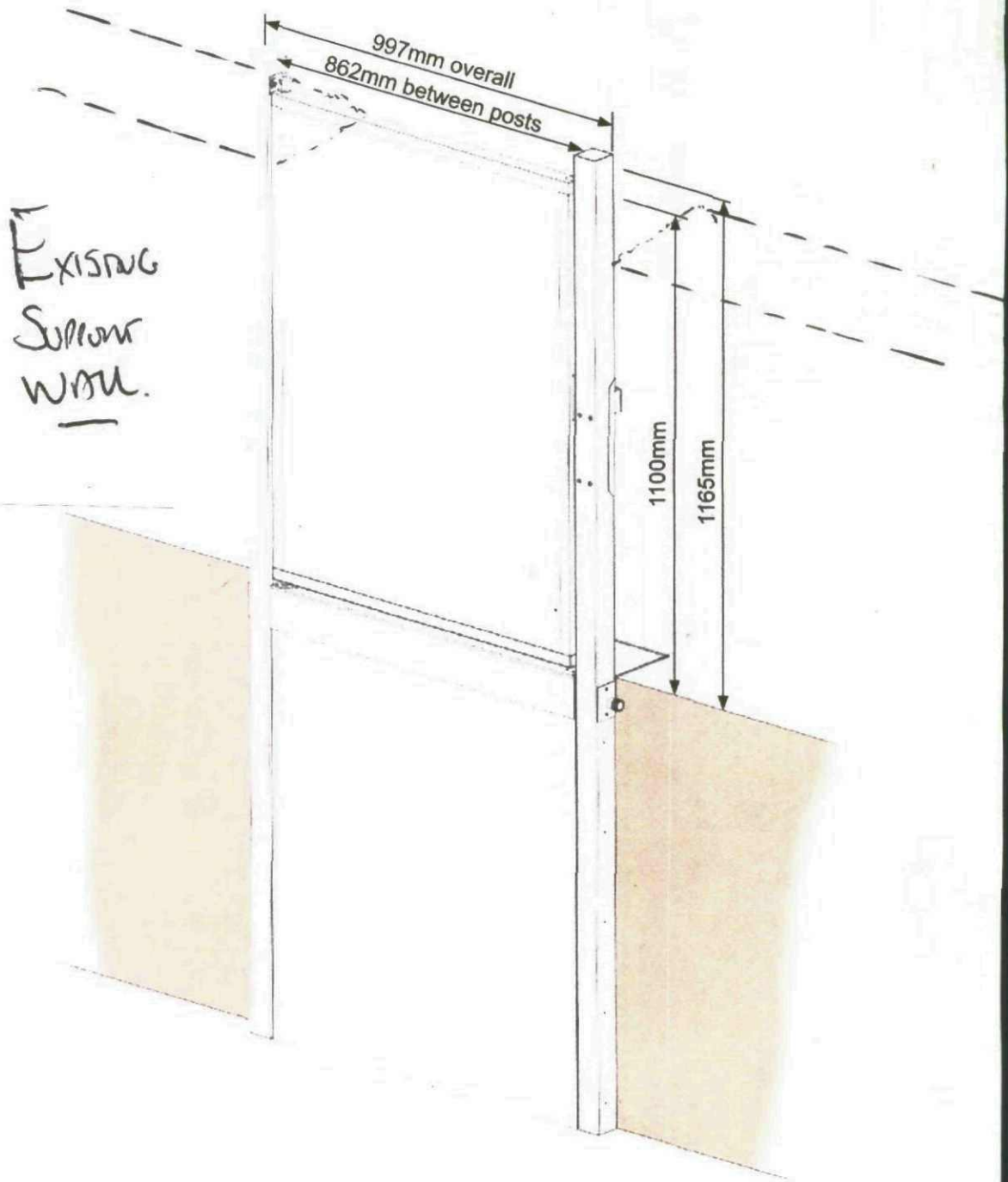

Terry STEPLIFT 1000

Uniclass	EPIC
L771:N5352	N1:Y311
CI/SfB	
(66.1)	X (U35)

01/11/2004

The Terry STEPLIFT 1000 is the ideal solution to wheelchair access problems in domestic situations



TSL 1000 with upper level gate



TSL 1000 with double step bridging unit in line with door way



TSL 1000 with triple step bridging unit and upper level landing

Terry STEPLIFT 1000

- **Practical** - with step bridging, provides both wheelchair and pedestrian access at the existing doorway
- **Durable** - Stainless steel/aluminium finish as standard - suitable for outdoor use
- **Easy to Use** - has conveniently situated controls and shallow approach ramp
- **Versatile** - up to 1 metre rise with bridging steps for up to 3 steps. Upper level side access & indoor pit models available
- **Cost Effective** - often cheaper than a ramp and can be re-sited
- **Reliable** - battery back up provides normal operation in case of mains power failure (30 cycles)
- **Low Maintenance** - annual servicing recommended. Maintenance contract available
- **Unobtrusive** - blends into its surroundings
- **Safe** - built to BS 6440 by a Company with 25 years' design experience in access for disabled

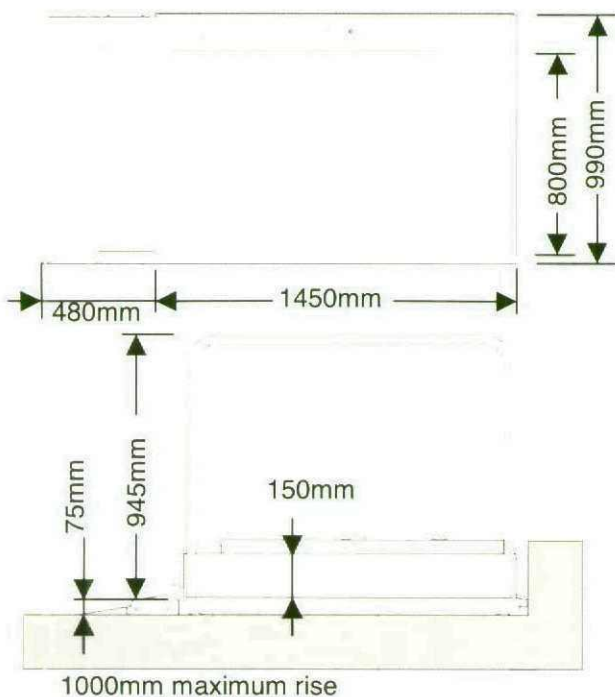

General Specification

- Designed to BS 6440
- Safe working load - 250kg
- Closed height - 75mm
- Maximum rise - 1 metre
- Ramp which doubles as a security device for wheelchair
- Silent, smooth operation
- Dedicated power supply not required

Safety Features

- Arrestor mechanism incorporated into ramp
- Full platform safe edge as standard
- Scissor mechanism fully enclosed by bellows
- Low voltage operation (24 VDC)
- Full battery backup as standard



Terry Group Ltd

Dolphin Mobility East Midlands Ltd
Unit 3a Exchange Road, Lincoln
Lincolnshire, LN6 3JZ
Tel. 01522 686315
Fax. 01522 500316
www.dolphin-mobility.co.uk



email:sales@terrylifts.co.uk

Terry Lifts' policy is one of continuous product development and the company reserves the right to change specifications, including standard colours without notice.