

THIS DRAWING IS PRODUCED FOR USE IN THIS PROJECT ONLY AND MAY NOT BE USED FOR ANY OTHER PURPOSE. THE ORIGINATOR ACCEPTS NO LIABILITY FOR THE USE OF THIS DRAWING OTHER THAN THE PURPOSE FOR WHICH IT WAS INTENDED IN CONNECTION WITH THIS PROJECT AS RECORDED IN THE 'PURPOSE FOR ISSUE' AND 'FILE STATUS CODE'.

THIS DRAWING MAY NOT BE REPRODUCED IN ANY FORM WITHOUT PRIOR WRITTEN AGREEMENT.

© CROWN COPYRIGHT AND DATABASE RIGHTS - ORDNANCE SURVEY LICENCE NUMBER 100019340.

KEY PLAN



NOTES

- Existing kerbline/junction removed
- Visibility splays
- FK - Full height kerb
- DK - Dropped Kerb
- FLK - Flush Kerb

Rev	Description	Date
P3	Verge/Plot 7 brick wall revised at junction.	01.12.20
P4	Verge amended to 700mm Junction amended with verge continuing to footpath.	01.12.20
P5	Forward visibility added to junction. Plot 7 position amended. Boundary treatments updated to Plot 7.	01.12.20
P6	Plot 7 building line updated.	01.12.20
P7	Rear garden fencelines amended to suit driver visibility. Plot 7 garden reduced to provide forward visibility.	02.12.20



NPS Barnsley Ltd
Gateway Plaza, Sackville St, Barnsley, South Yorkshire, S70 2RD,
Tel: 01228 774000; Email: barnsley@nps.co.uk; web: www.nps.co.uk

CLIENT

BMBC Housing Growth

PROJECT

Laithes Lane

TITLE

Proposed Highways Site Plan

SCALE 1:200 DISCIPLINE ARCHITECT PROJECT NUMBER 103684

DRAWING NUMBER NPS-XX-PL-DR-A-014 REV CODE P7

STATUS CODE S2 PURPOSE OF ISSUE PLANNING APPROVAL Drawn BST Checked Approved

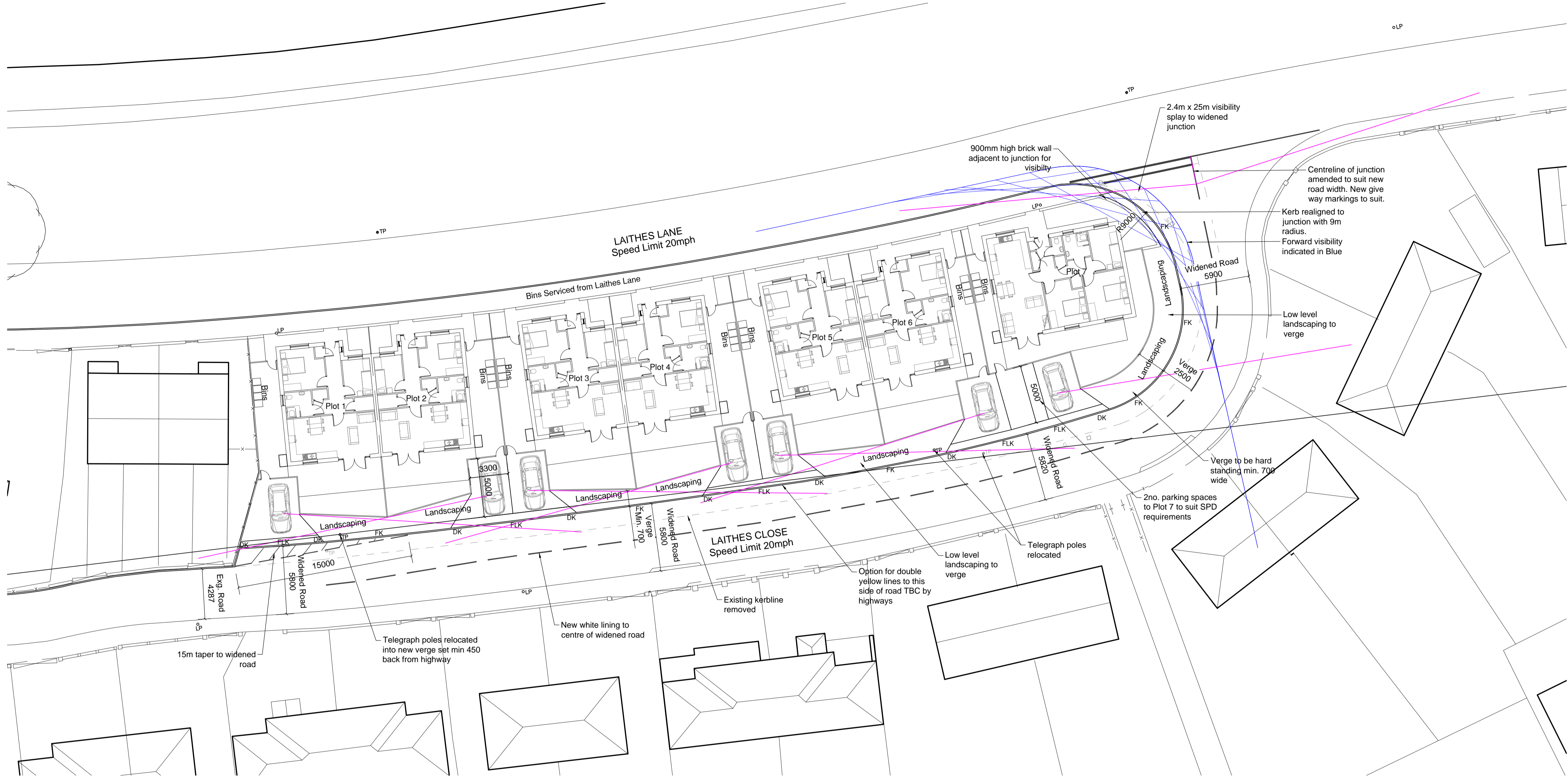

01 Site Plan
1:200