

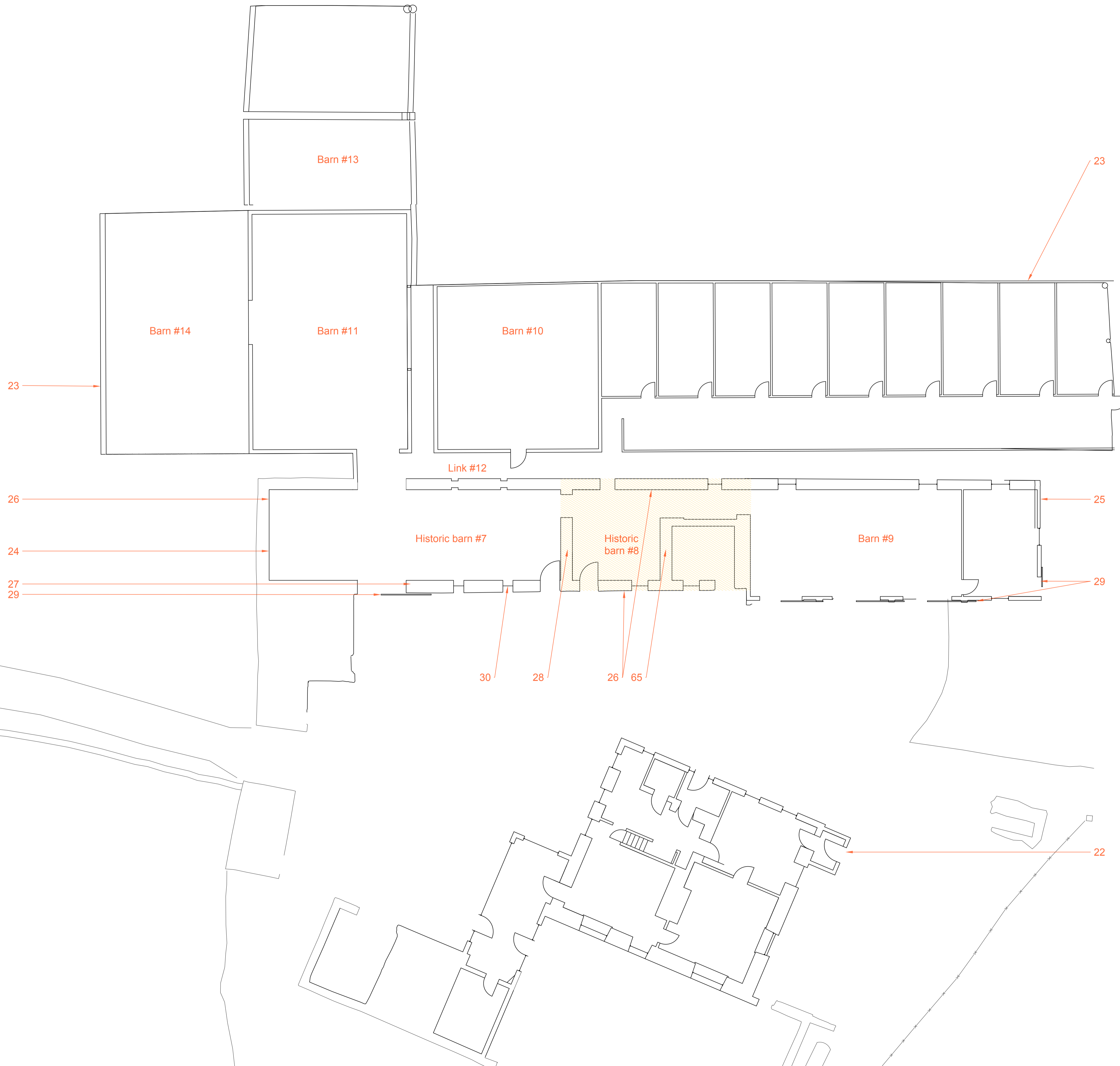

Key Plan 1:1250



- 11. Existing wall at first floor level
- 22. Line of Cottage
- 23. Line of recently constructed barns of poor quality
- 24. Rubble fill external walling of the original building - with recent render finish to south gable.
- 25. Bonded brickwork external wall to Recent Barn #9
- 26. Location of external wall to be rebuilt under separate Listed Building Consent
- 27. Location of opening jamb to be under pinned under separate Listed Building Consent
- 28. Location of internal wall at first floor level to be rebuilt under separate Listed Building Consent
- 29. Close boarded sliding barn door
- 30. Existing openings with timber windows, masonry blocking or open
- 65. Location of existing wall at first floor to remain.

Robin Ashley Architects

Hawk Works, 105 Mary Street,
Sheffield, S1 4RT
t: 0114 258 7450
e: contact@raarchitects.co.uk
www.raarchitects.co.uk



project: Far Westhorpe Farm

client: Mr + Mrs Pearson
drawing: Historic Barns #7+#8
Existing plan at ground floor

drawing number: **24-39-037**

revision: B (17/02/2026)
date: October 25
scale: 1:100
original size: A1
issue: Approval
drawn: RAI
checked: DJU

this drawing may be scaled only for the purposes of planning approval
check all dimensions on site + refer all queries prior to carrying out work
this drawing is to be used only for the purposes for which it is issued
© robin ashley architects LLP
registered in england + wales, number OC310 421

