

EXISTING & PROPOSED CELLAR PLAN

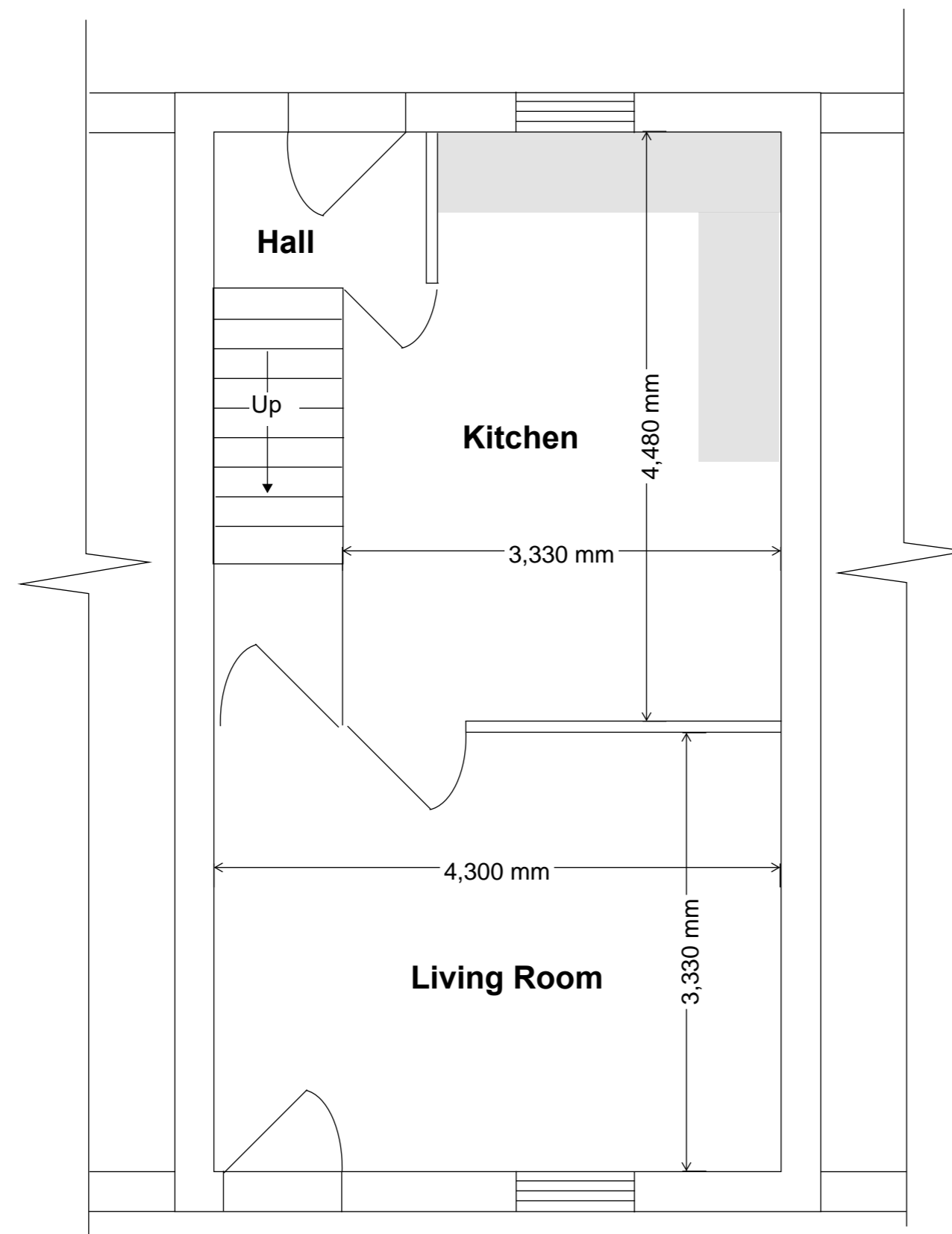

PREVIOUS GROUND FLOOR PLAN



PROPOSED GROUND FLOOR PLAN

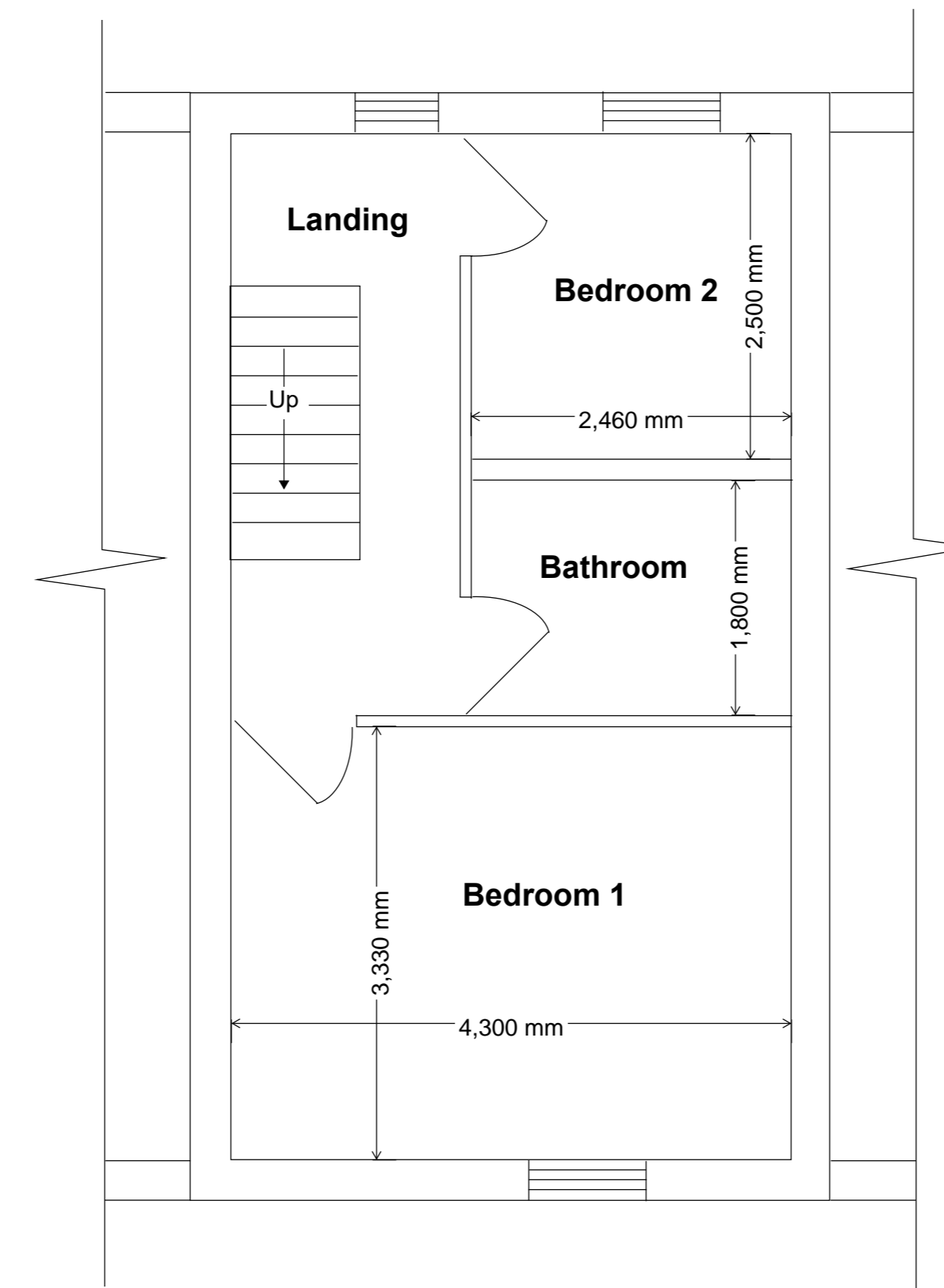

PREVIOUS FIRST FLOOR PLAN

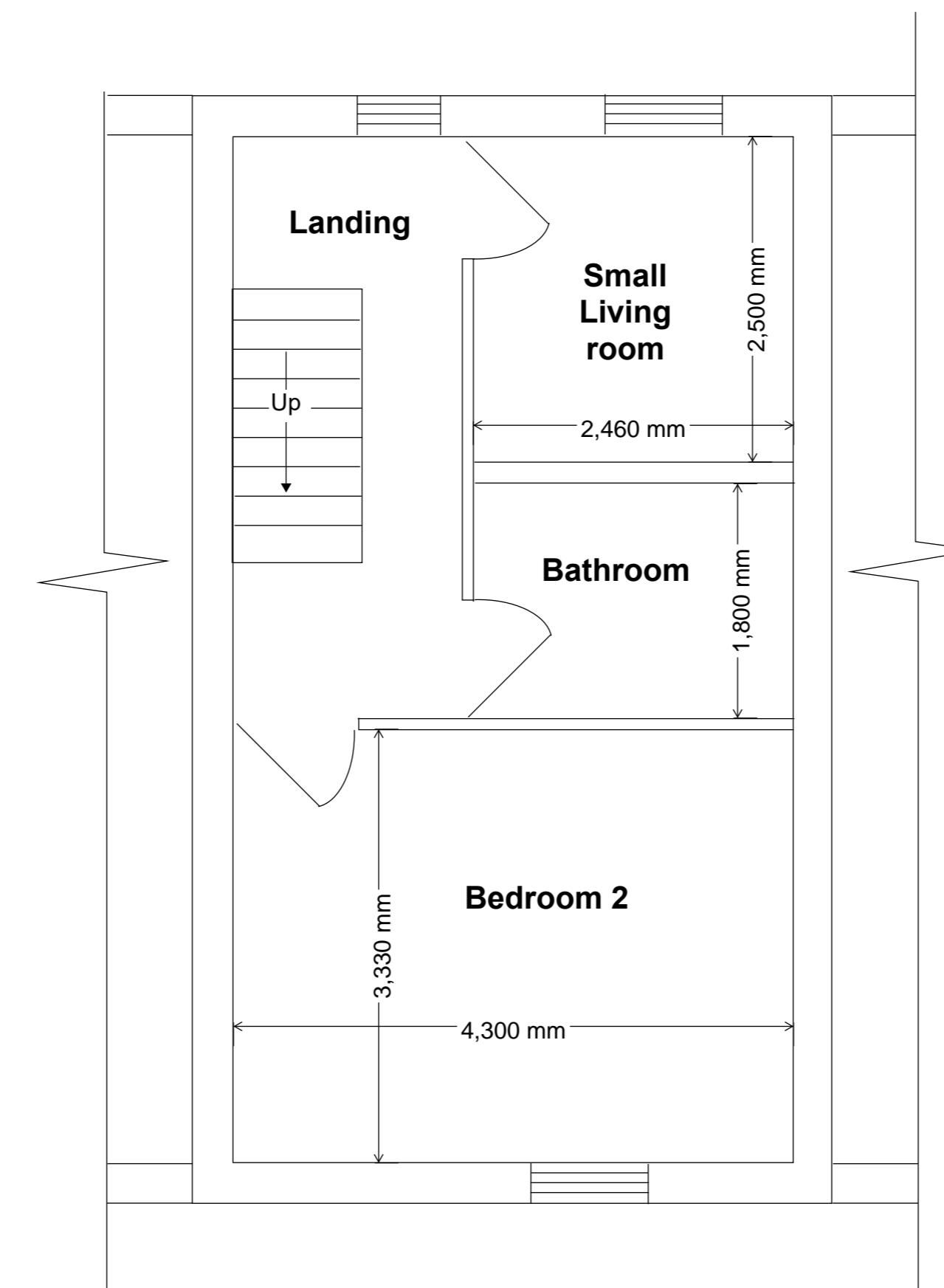

PROPOSED FIRST FLOOR PLAN

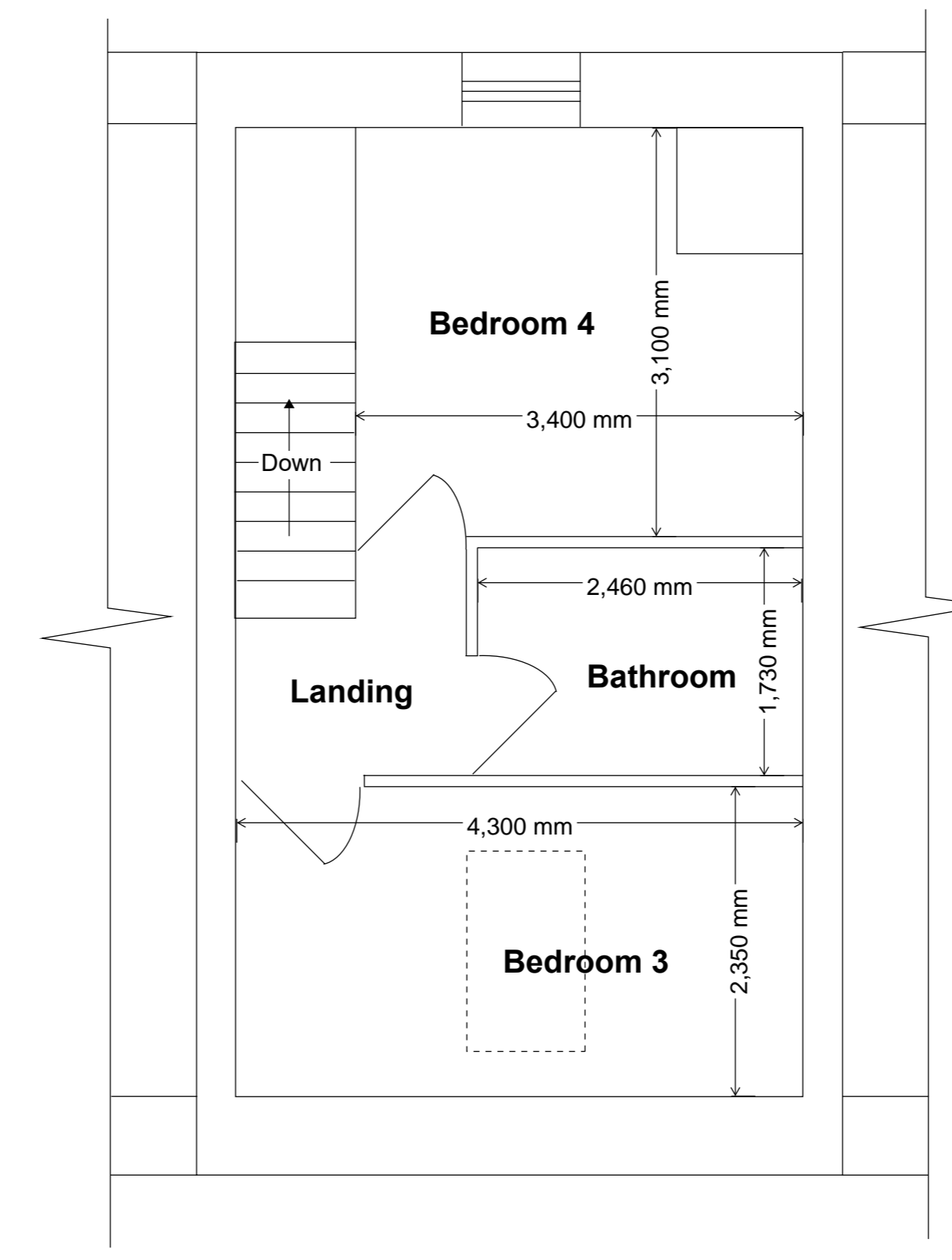

EXISTING & PROPOSED SECOND FLOOR PLAN

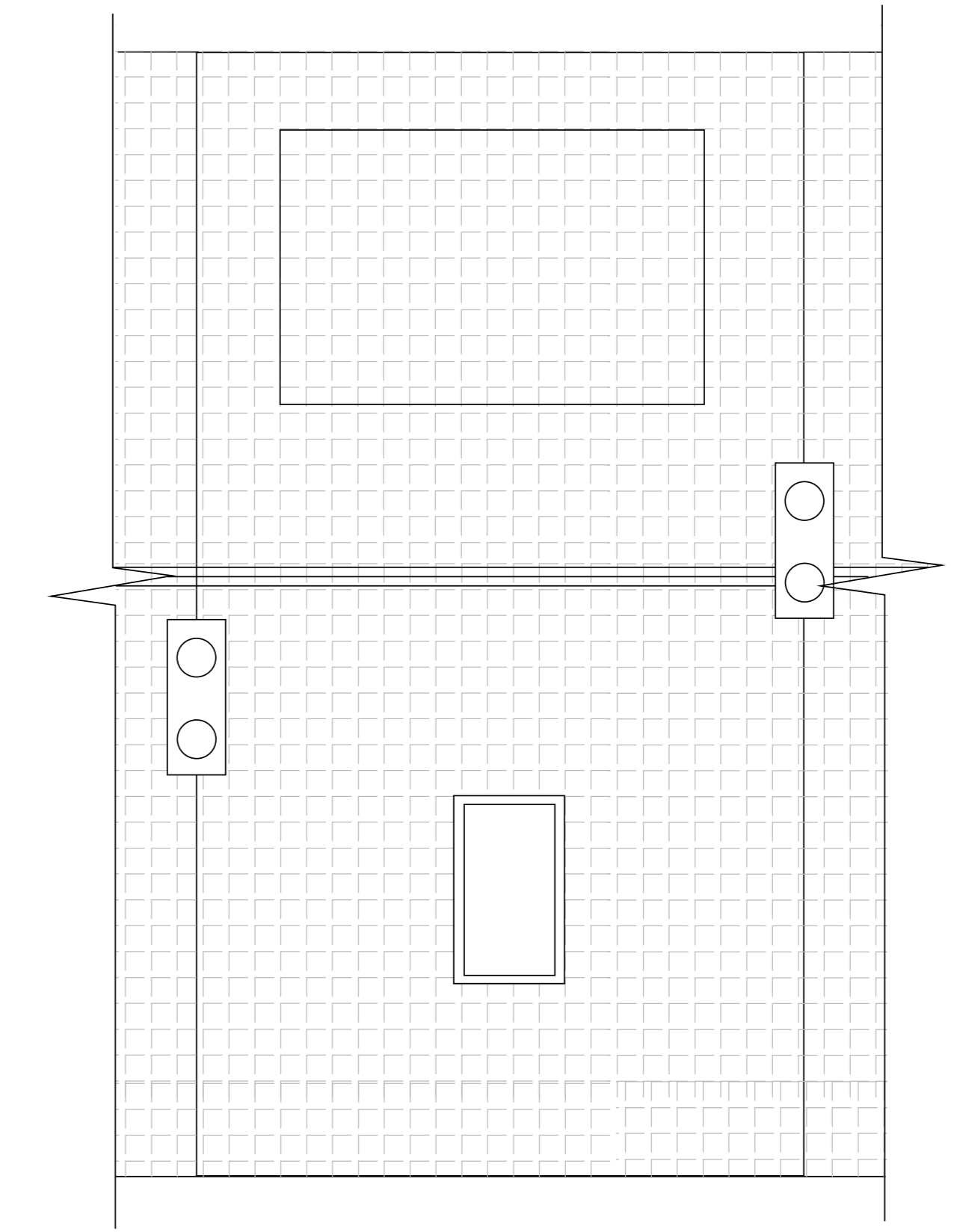

EXISTING & PROPOSED ROOF PLAN

NOTES

- DO NOT SCALE, USE WRITTEN AND SITE DIMENSIONS ONLY.
- ALL DIMENSIONS TO BE TAKEN ON SITE PRIOR TO MANUFACTURE OF ANY ELEMENT OR COMPONENT.
- ALL WORKS TO BE IN ACCORDANCE WITH ALL CURRENT EDITIONS AND RELEVANT CLAUSES OF BUILDING REGULATIONS BRITISH STANDARDS, CODES OF PRACTICE AND HSE DIRECTIVES EVEN IF UNSTATED.
- ANY DISCREPANCIES TO BE NOTIFIED TO SUPERVISING OFFICER.
- ALL PIPES, DRAINS, CABLE, DUCTS, SERVICES, ETC. TO BE ACCURATELY LOCATED ON SITE PRIOR TO ANY EXCAVATION, DEMOLITION OR DRILLING. MAKE GOOD TO ALL SURFACES AND FINISHES DISTURBED.
- NEW FOUNDATIONS TO BE TO S.E. DETAILS. ALL FOUNDATIONS TO BE IN ACCORDANCE WITH PART A APPROVED DOCUMENTS TO THE BUILDING REGULATIONS AND BS 8004 AND AGREED WITH THE BUILDING INSPECTOR ON SITE BEFORE COMMENCEMENT.
- NEW EXTERNAL WALLS TO BE 280mm CAVITY CONSTRUCTION COMPRISING 102 BLOCKWORK OUTER LEAF, 50mm CAVITY WITH MIN. 40mm INSULATION, 100mm BLOCKWORK INNER LEAF. PROVIDE CELOTEX CW4000 FOIL FACED ROOF SLAB INSULATION HELD IN PLACE AGAINST BLOCKWORK WITH RETAINING CLIPS TO GIVE MIN. 0.28 W/m²K U VALUE. (NOTE: BLOCKWORK UNIT WEIGHT NOT TO EXCEED 20kg). CAVITIES TO BE CLEAN, CLEAR, CONTINUOUS, CLOSED AT EAVES AND FILLED WITH LEAN MIX CONCRETE BELOW GROUND LEVEL. DPT TO BE 150mm ABOVE EXTERNAL GROUND LEVEL THROUGHOUT.
- ALL BLOCKWORK TO HAVE MIN. COMPRESSIVE STRENGTH OF 7N/mm². HORIZONTAL CHASES IN WALLS NOT TO EXCEED 1/6 OF WALL THICKNESS. VERTICAL CHASES IN WALLS NOT TO EXCEED 1/3 OF WALL THICKNESS.
- WALL TIES TO BE STAINLESS STEEL SAFETY TIES SET AT 750mm HORIZONTAL, 450mm VERTICAL CENTRES AT 500mm G/C MAX.
- ALL EXTERNAL LINTELS TO WINDOWS AND DOORS TO BE INSULATED IG. HT/3 TUD OR SIMILAR APPROVED. ALL LINTELS TO HAVE MIN. 150mm END BEARING. STEPPED DPC TO BE PROVIDED OVER ALL LINTELS TO GIVE CONTINUOUS CAVITY TRAP. PROVIDE CAVITY CLOSER BLOCK AND RUBBERED INSULATED DPC TYPE 1, DOWNED INSULATED DPC TO JAMBS AND SILL OF ALL EXTERNAL WINDOW OPENINGS TO ACHIEVE MIN. 1.28W/m²K U VALUE.
- ALL FLASHING TO BE LEAD CODE 5, COVER FLASHINGS TO BE WEDGED IN TO EXISTING WALLS WITH LEAD WEDGES AT 500mm G/C MAX.
- CONCRETE INTERLOCKING ROOF TILES ON 38x29mm TREATED S/W TILING BATTENS ON SARKING FELT TO BS 747.
- THE CEILING LINE FOLLOWS THE PITCH OF THE ROOF (MIN. 1:5). A MINIMUM OF 25mm AIR GAP OR EQUIVALENT MUST BE MAINTAINED AT EAVES AND A MINIMUM OF 5mm OR EQUIVALENT AT WALL HEADS. A MINIMUM OF 50mm AIR GAP MUST BE MAINTAINED OVER INSULATION. SLOPING CEILING TO BE FOIL BACKED PLASTERBOARD AND SKIM. PROVIDE CELOTEX WK400 150mm THK ROOF INSULATION (OR SIMILAR APPROVED) BETWEEN BATTENS AND CELOTEX PL4000 INSULATION BACKED PLASTERBOARD (15mm THK INSULATION, 12.5mm PLASTERBOARD) TO UNDERSIDE OF BATTENS TO ACHIEVE MIN. 0.16 W/m²K U VALUE. WOOD BATTENS TO BE POSITIONED ABOVE ALL INSULATION. WALL PLATE TO BE 100x80mm TREATED S/W SECURED TO TOP OF WALL USING 300x60x6mm LONG GALVANIZED STEEL STRIPS SCHEDULED INTO WALL PLATE AND BUILT INTO WALL AT MAX. 800mm G/C. FACIA AND SOFFIT TO BE UPVC TO MATCH EXISTING. PROVIDE CONTINUOUS INSECT SCREENED VENT ABOVE FACIA OR WITHIN SOFFIT TO GIVE MIN. 25mm CLEAR VENTILATION.
- GROUND FLOOR - PROPOSED SUSPENDED TIMBER FLOOR - 22mm THK PS MOISTURE RESISTANT T & G CHIPBOARD FLOORING ON C16 STRENGTH CLASS JOISTS, 80mm W/4 x 225mm DEEP AT MAX. 400 CENTRES. FLOOR TO BE INSULATED BETWEEN JOISTS WITH MIN. 125mm THICK CELOTEX F5000 SERIES SOLID INSULATION (OR SIMILAR APPROVED) TO ACHIEVE MIN. 0.220W/m²K U VALUE. INSTALLED TO MANUFACTURERS INSTRUCTIONS. CROSS FLOOR VENTILATION TO UNDER FLOOR VOID TO BE PROVIDED BY INSTALLING AIR BRICKS AND TELESCOPIC UNDERFLOOR VENTILATORS IN OPPOSING MASONRY WALLS. VENTILATORS SHOULD BE SPACED AT MAX 2m CENTRES.
- PROVIDE PVC-U GUTTERS ON GUTTER BRACKETS. ALL NEW GUTTERS TO BE HALF ROUND 125mm AND DISCHARGE INTO MIN. 75mm DIA. PVC-U RAINWATER PIPES. WHERE A RAINWATER PIPE DISCHARGES ONTO A LOWER LEVEL ROOF A PIPE SHOE SHOULD BE FITTED TO DIVERTE WATER AWAY FROM THE BUILDING. THE SHOE SHOULD BE FITTED WITH A DISTRIBUTOR PIPE TO ENSURE THAT THE FLOW WITHIN THE RECEIVING GUTTER IS SUFFICIENT SO THAT IT DOES NOT OVER TOP THE GUTTER. DESIGN FOR THE SIZE OF RAINWATER GOODS TO BE BACKED UPON.
- NEW BELOW GROUND DRAINS TO BE 100/150mm HEPWORTH PLASTIC OR SIMILAR BSA CERTIFIED APPROVED. DRAINS TO BE Laid AT MIN. 1:40 FALL AND AT FALLS AND BEDDING TO MANUFACTURERS INSTRUCTIONS. NEW MANHOLES TO BE CONSTRUCTED FROM BSA CERTIFIED POLYPROPYLENE CHAMBERS INSTALLED IN ACCORDANCE WITH MANUFACTURERS INSTRUCTIONS IF LESS THAN 1m DEEP. ANY NEW RAINWATER DRAINAGE TO GO TO EXISTING DRAINAGE SYSTEM WHICH IS TO BE DETERMINED ON SITE IN PRESENCE OF BUILDING INSPECTOR TO PROVE SUITABILITY. ANY DRAINS BELOW BUILDING TO BE ENCASED IN CONCRETE. EXACT POSITION AND RUN OF NEW DRAINAGE TO BE DETERMINED ON SITE IN PRESENCE OF BUILDING INSPECTOR.
- EXTENSION/MODIFICATIONS TO HEATING & ELECTRICAL SYSTEM TO BE SPECIALIST DESIGN AND MANUFACTURE.
- ALL ELECTRICAL SOCKETS TO BE SET BETWEEN 450mm AND 1200mm FROM FLOOR LEVEL.
- PROVIDE SMOKE DETECTORS MIN. 5m FROM KITCHEN DOORS. ALL INTERLINKED AND FED FROM SEPARATE SUPPLY ON THE DISTRIBUTION BOARD. SMOKE DETECTORS, SOUNDERS, EMERGENCY LIGHTING AND BREAK GLASS CALL POINTS LAYOUT, DESIGN AND INSTALLATION TO BE TO BE APPROVED BY LOCAL FIRE AUTHORITY ALONG WITH ANY FIRE EXIT SIGNAGE AND FIRE EXTINGUISHERS. ELECTRICAL WORKS TO ACCORDANCE WITH PART P.
- NEW WINDOWS TO BE DOUBLE GLAZED, HERMETICALLY SEALED. ALL DOORS AND WINDOWS TO BE TO SPECIALIST DESIGN AND MANUFACTURE. ANY GLAZING TO BS 6202 1982 AND BS 6206 AND PART N APPROVED DOCUMENTS TO THE BUILDING REGULATIONS. INTERNAL DOORS TO BE TO CLIENTS SPECIFICATION. ALL DOORS TO HAVE MIN. 1.5 PANS OR HIKES. WINDOWS TO BE FITTED WITH TRICKLE VENT TO GIVE MIN. 8000mm² BACKGROUND VENTILATION. U VALUE OF EXTERNAL WINDOWS TO BE MIN. 1.6 W/m²K. DOORS 1.8 W/m²K U VALUE.
- ANY KITCHEN AREAS, UTILITY ROOMS AND EN-SUITES TO HAVE EXTRACT VENTILATION.
- GAS SERVICE PIPES - CONTACT TRANSCO ON 0870 2430745 IF A GAS SERVICE PIPE NEEDS TO BE MOVED. IF A GAS MAIN IS AFFECTED RING 01904 754291 TO ARRANGE A SITE VISIT.

Rev	Drawn	Approved	Date	Description
PLANNING / BUILDING REGS				
Client				
HENRY BOWER				
Designed	LB	FEB 26	Date	Checked
Drawn	LB		Date	Approved
Original Scale	1:20			Original Size
Dwg. Title				
32 DODWORTH ROAD BARNESLEY S70 6DY				
Dwg. No.	001			Rev.
				Sheet No.