

Drawing status

Notes	Drawn by	AP	Size	A1	Scale	1:50	Status	Rev	Date
PRELIMINARY STUDY							P	-	
AMENDMENTS: Option 2 slightly changed: Refurbishment of 2 no. WCs and cannula area added.							P	A	11/12/20
AMENDMENTS: Option 1 accepted. Option 2 and 3 omitted							P	B	
AMENDMENTS: Ramp length amended; modular building pushed further 200mm from the face of the existing building.							P	C	03/03/21
AMENDMENTS: D02 handed the other way.							P	D	16/03/21
AMENDMENTS: - D03 and D05 located to be 190mm from the neighbouring wall. - D05 opening direction has been changed to be outwards. - Change 1 has been widened by 100mm towards the MRI Prep Area. - D4 has been changed to be a double swing door. - Cabinets in the MRI Prep Area have been moved 75mm away from the wall to create space for the scribe.							P	E	19/03/21
AMENDMENTS: Existing column in wall has been moved to correct location. Accurate dimension provided by the contractor.							P	F	22/03/21
AMENDMENTS: WHB locations amended.							P	G	31/03/21

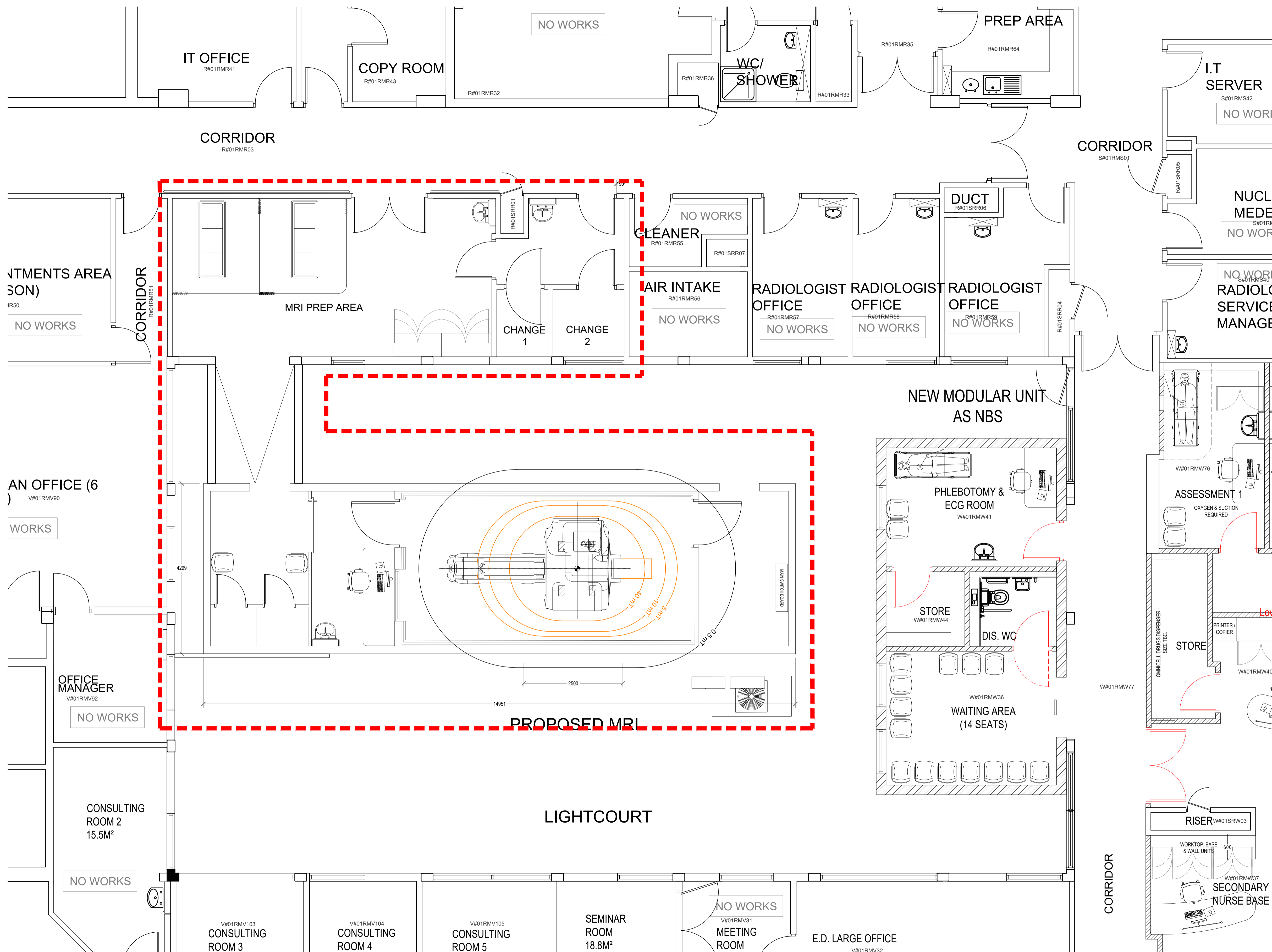

Drawing status annotation
P-Preliminary T-Tender D-Design (post preliminary) C-Construction As-As Built

Client
BARNSELY HOSPITAL NHS
FOUNDATION TRUST

Project title
MODULAR MRI

Project no
170/032

Drawing title
PROPOSED PLAN

Drawing no	Status	Revision
(0-)01	P	G

PROPOSED PLAN
1:50