

Key Plan 1:250

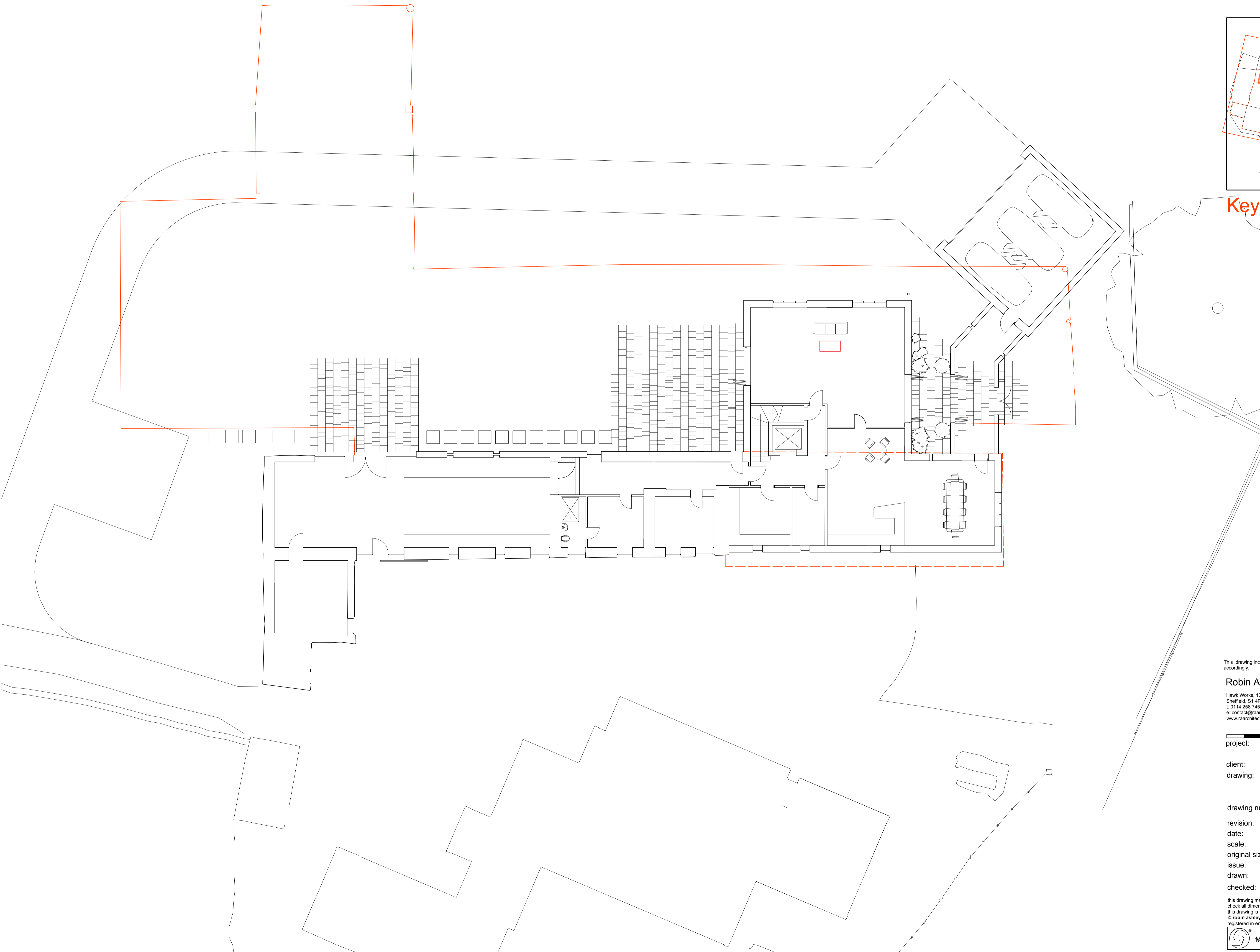

This drawing incorporates information from 3rd parties and its veracity is restricted accordingly.

**Robin Ashley Architects**

Hawk Works, 105 Mary Street,  
Sheffield, S1 4RT  
t: 0114 258 7450  
e: contact@raarchitects.co.uk  
www.raarchitects.co.uk



project: Far Westhorpe Farm

client: Mr + Mrs Pearson  
drawing: Historic Barns #7+#8  
Proposed plan at ground floor

drawing number: **24-001-043**

revision: B (17/02/2026)

date: October 2025

scale: 1:100

original size: A1

issue: Approval

drawn: DJU

checked: DJU

this drawing may be scaled only for the purposes of planning approval  
check all dimensions on site + refer all queries prior to carrying out work  
this drawing is to be used only for the purposes for which it is issued  
© robin ashley architects LLP  
registered in england + wales, number OC310 421

