

# Church Lane, Hoylandswaine

## Technical Layout

Material Schedule		
External Finish	Plots	Roof Tile
Marshall's Cromwell Pitch faced Buff Weathered Artstone	All Plots	Russell Grampian Anthracite

house type schedule				
type	PI CODE		Sq.Ft	No.
469	Holden H469 HSTN	4 bed detached	1536	12
454	Shelbourne H454 HSTN	4 bed detached	1823	11
497	Chelworth H497 HTN	4 bed detached	1703	8
534	Maddoc H534 HSTN	5 bed detached	1797	8
536	Moorecroft H536 HSTN	5 bed detached	2236	5
546	Arbury H546 HSTN	5 bed detached	2356	5
500	Emerson H500 HSTN	5 bed detached	1797	8
500C	Emerson H500 HTN	5 bed detached	1797	3
BU	Burleigh	2 bed bungalow	650	2
383	Strathmore P383 HSTN	3 bed semi-detached	832	4
383	Strathmore P383 HTN	3 bed semi-detached	832	1
<b>TOTAL</b>			<b>67</b>	

**Plots 17-21, 25-26 & 30-31 to be constructed to 2013 Building Regulations**

**All remaining plots are constructed to 2010 Building Regulations**

**OPTIONAL WINDOWS**  
**ALL optional windows shown on house type working drawings to be omitted.**  
**H546 - W2 lounge window to be omitted.**

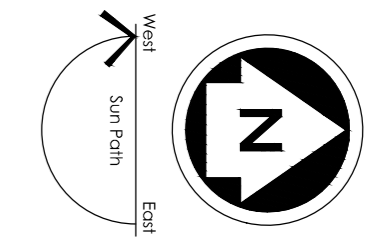
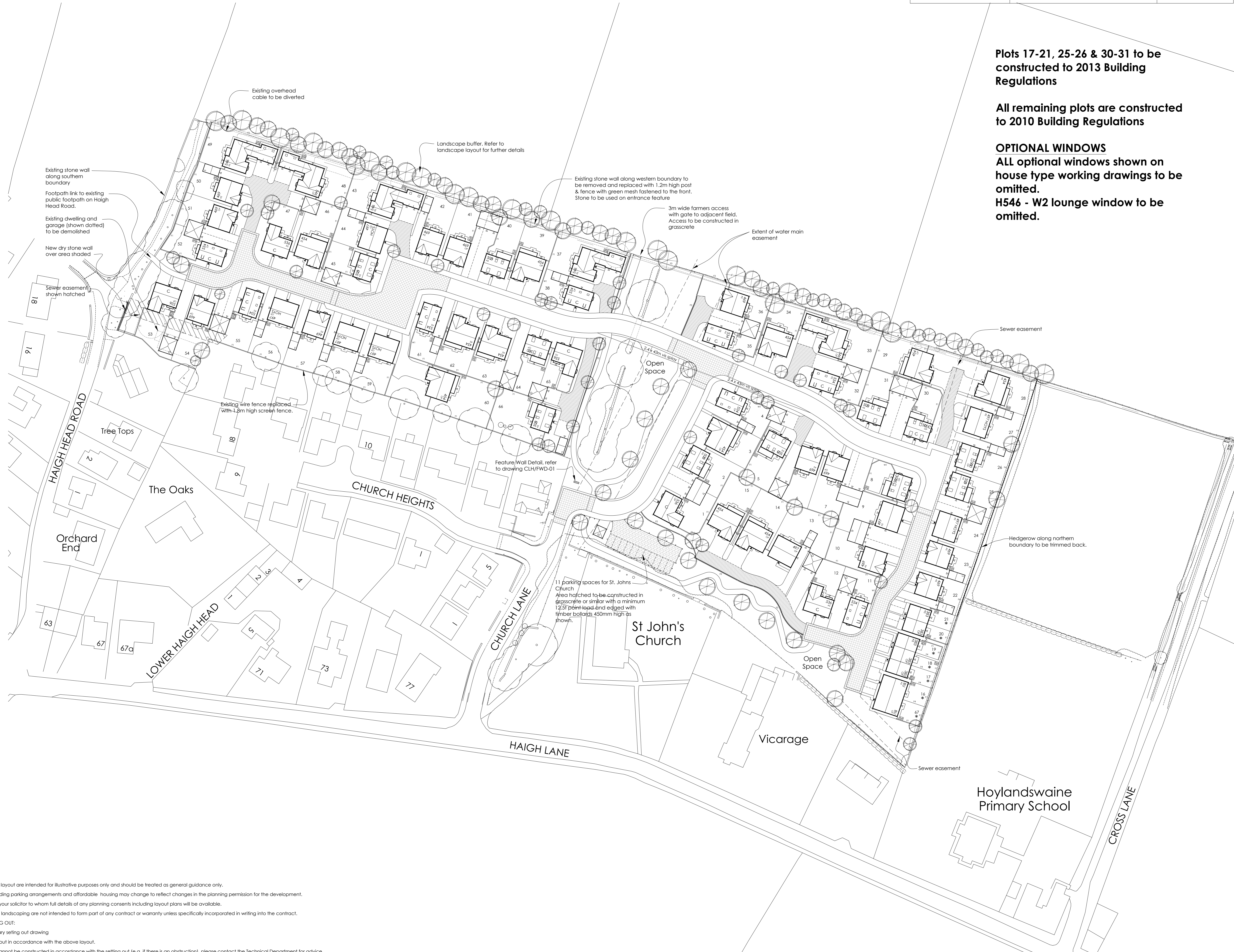

### Legend

- Shared Surface
- Private Drive
- 1.8m high timber screen fence
- 1.8m high screen wall
- 0.9 high timber post and rail fence
- 1.2m high timber post and rail fence with green mesh attached to the front
- 1.2m high timber screen fence
- Lockable gate
- Bin storage in rear gardens
- Corner turning / Dual aspect dwellings
- Grit bin locations - 3 in total
- Affordable housing
- Single garage - 3164mm x 6177mm  
DWG No. 2010/SG/401
- Double garage - 5642mm x 6177mm  
DWG No. 2010/DG/402
- Twin garage - 6337mm x 6177mm  
DWG No. 2010/DG/403
- Triple garage - 8697mm x 6177mm  
DWG No. 2010/TG/404
- Quad garage - 11185mm x 6177mm  
DWG No. 2010/QG/405

- K 28.10.16 Plots 39, 41, 42 & 43 handed, Plot 61 re-positioned. Boundary fences adjusted to suit external works 1.2m high fence introduced to rear of plots 22-28
- J 29.09.16 Boundary fence removed from the bottom of the garden plots 22 - 28
- H 13.09.16 H497 house type code updated
- C 08.08.16 Footpath revised through open space. Footpath link to school removed
- F 17.06.16 Drive revised to plot 11 to give access to plot 12 services
- E 18.04.16 Length of fence added to north eastern boundary
- D 18.01.16 Farmers access constructed in grasscrete
- C 13.12.15 Boundary treatment revised along western boundary Footpath access to school revised. Feature wall shown adjacent site entrance
- B 29.07.15 Facing stone revised
- A 01.06.15 Garages revised on plots 55 & 66. Boundary revised on plot 54

Development: Church Lane	
Location: Hoylandswaine	
Marketing Name:	
Drawing Title: Technical Layout	
Drawing Number: HS-TL / 01	
Revision: K	Scale @ A0: 1:500
Drawn By: KL	Date Started: May 2015

**NOTE:**

- Images and site layout are intended for illustrative purposes only and should be treated as general guidance only.
- Site layout including parking arrangements and affordable housing may change to reflect changes in the planning permission for the development. Please speak to your solicitor to whom full details of any planning consents including layout plans will be available.
- Site layouts and landscaping are not intended to form part of any contract or warranty unless specifically incorporated in writing into the contract.

**BOUNDARY SETTING OUT:**

- Refer to boundary setting out drawing
- Set boundaries out in accordance with the above layout.
- If a boundary cannot be constructed in accordance with the setting out (e.g. if there is an obstruction), please contact the Technical Department for advice.

Space to live.

**David Wilson Homes**

Vico Court, Ring Road, Lower Wortley, Leeds, LS12 6AN  
 Tel: 0113 279 0099 Fax: 0113 279 0038