

VEHICLE PROFILE

Phoenix 2-25W (with Volvo FM12 chassis)
 Overall Length 11.125m
 Overall Width 2.530m
 Overall Body Height 3.205m
 Min Body Ground Clearance 0.410m
 Track Width 2.500m
 Lock to lock time 4.00s
 Kerb to Kerb Turning Radius 9.250m

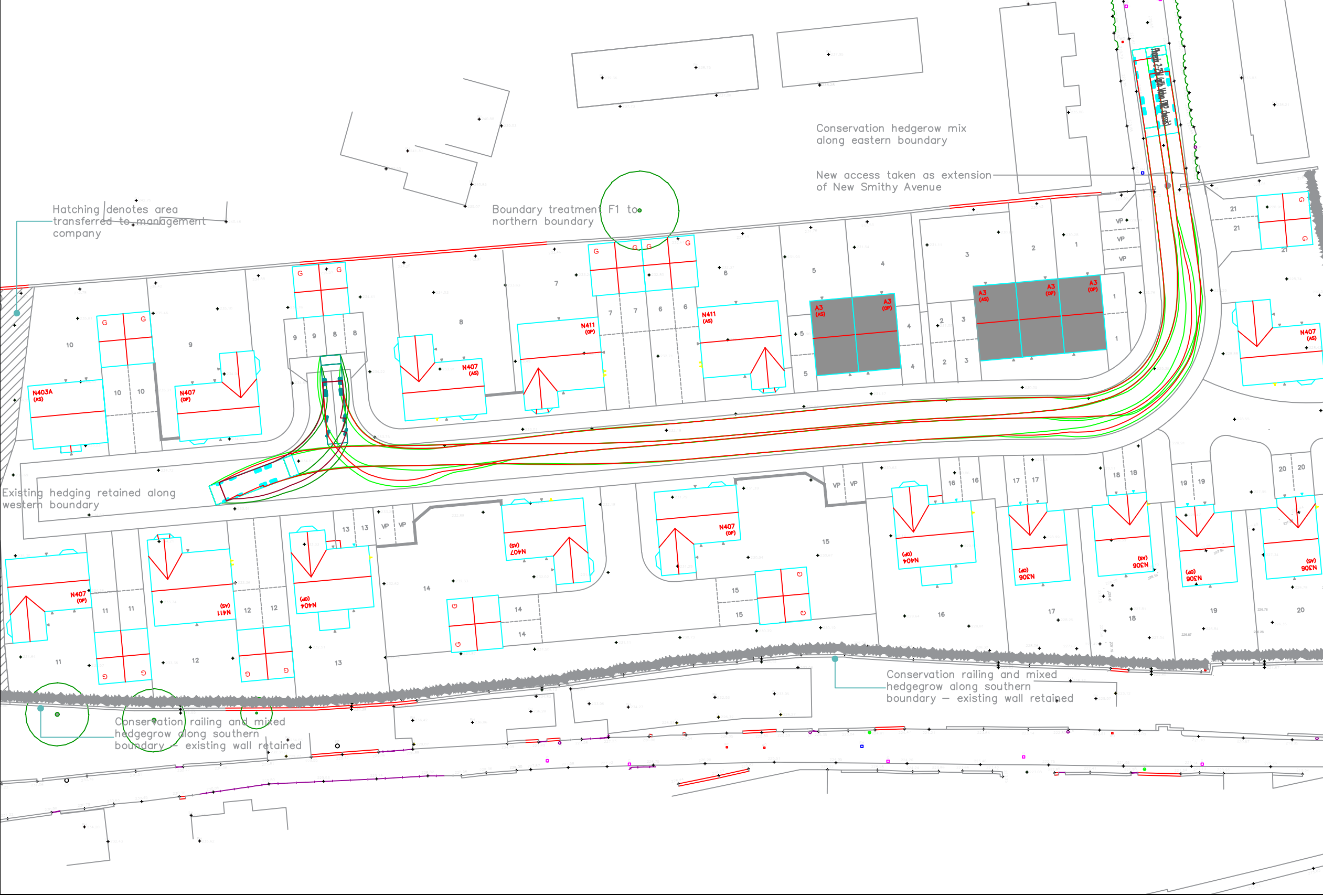

REVISIONS

REV	DESCRIPTION	DATE	BY
-	-	-	-



Project:
**NEW SMYTHY AVENUE
 THURLSTONE**

Client:
NEWETT HOMES

Drawing:
**LARGE REFUSE VEHICLE SWEEP
 PATH ANALYSIS**

Drawn By: **AJA** Date: **29/06/2021**

Checked: **ATM** Scale: **1:500 @ A3**

Drawing No. **AMA/20366/ATR006** Rev. **-**