

GENERAL NOTES

DEVELOPMENT OF THE SITE WILL TAKE PLACE WITH SEPARATE SYSTEMS FOR Foul AND SURFACE WATER DRAINAGE. THE SEPARATE SYSTEMS WILL EXTEND TO THE POINTS OF DISCHARGE TO BE AGREED WITH YORKSHIRE WATER. Foul WATER DOMESTIC WASTE SHOULD DISCHARGE TO THE 550mm DIAMETER PUBLIC COMBINED SEWER RECORDED IN SHEFFIELD ROAD AT A POINT TO THE EAST OF THE SITE. Foul WATER FROM KITCHENS AND/OR FOOD PREPARATION AREAS OF ANY RESTAURANTS AND/OR CANTENES ETC MUST PASS THROUGH A FAT AND GREASE TRAP OF ADEQUATE DESIGN BEFORE ANY DISCHARGE TO THE PUBLIC SEWER NETWORK. THE Foul WATER DISCHARGE RATE WILL BE BASED ON THE OCCUPANCY AND USE OF THE BUILDING. DUE TO THE SIGNIFICANT AMOUNT OF MADE GROUND AND TO PROTECT THE SITE SOAKAWAYS AND FUTURE DEVELOPMENT PROPOSALS, THE PROPOSED SURFACE WATER DRAINAGE SOLUTION IS VIA A SYSTEM ATTENUATED WITH A HYDRO-BRAKE AND STORED ON SITE IN OVER SIZED PIPES (OR SIMILAR MEANS OF STORAGE) DISCHARGING TO THE 450mm DIAMETER PUBLIC SURFACE WATER SEWER RECORDED IN SHEFFIELD ROAD, AT A POINT TO THE EAST OF THE SITE. THE FINALISED PROPOSALS, INCLUDING CALCULATIONS, WILL BE SUBMITTED TO LPA, YORKSHIRE WATER AND HIGHWAYS FOR CONSIDERATION.

LEGEND:

- EXISTING ADOPTED COMBINED SEWER (ON YORKSHIRE WATER SEWER MAP)
- EXISTING ADOPTED Foul WATER DRAIN (ON YORKSHIRE WATER SEWER MAP)
- EXISTING Foul WATER DRAIN (NOT ON YORKSHIRE WATER SEWER MAP)
- PROPOSED NON ADOPTED Foul WATER DRAIN
- PROPOSED YORKSHIRE WATER ADOPTED Foul WATER DRAIN
- EXISTING ADOPTED STORM WATER DRAIN (ON YORKSHIRE WATER SEWER MAP)
- EXISTING ADOPTED STORM WATER DRAIN (NOT ON YORKSHIRE WATER SEWER MAP)
- EXISTING STORM WATER DRAIN
- PROPOSED NON-ADOPTED STORM WATER DRAIN
- PROPOSED ADOPTED YORKSHIRE WATER STORM WATER DRAIN
- EXISTING SURFACE WATER DRAIN TO BE ABANDONED
- RODDING EYE
- RAINWATER PIPE
- ROAD GULLY
- Foul WATER CONSTRUCTED CHAMBER
- Foul WATER POLYPROPYLENE INSPECTION CHAMBER
- STORM WATER POLYPROPYLENE INSPECTION CHAMBER
- COMBINED FLOW CONSTRUCTED CHAMBER
- STORM WATER CONSTRUCTED CHAMBER
- BACK INLET GULLY
- DEMARCATION CHAMBER
- EXISTING SURFACE WATER SEWER TO BE SURVEILED AS PART OF CCTV SURVEY
- EXISTING Foul WATER SEWER TO BE SURVEILED AS PART OF CCTV SURVEY

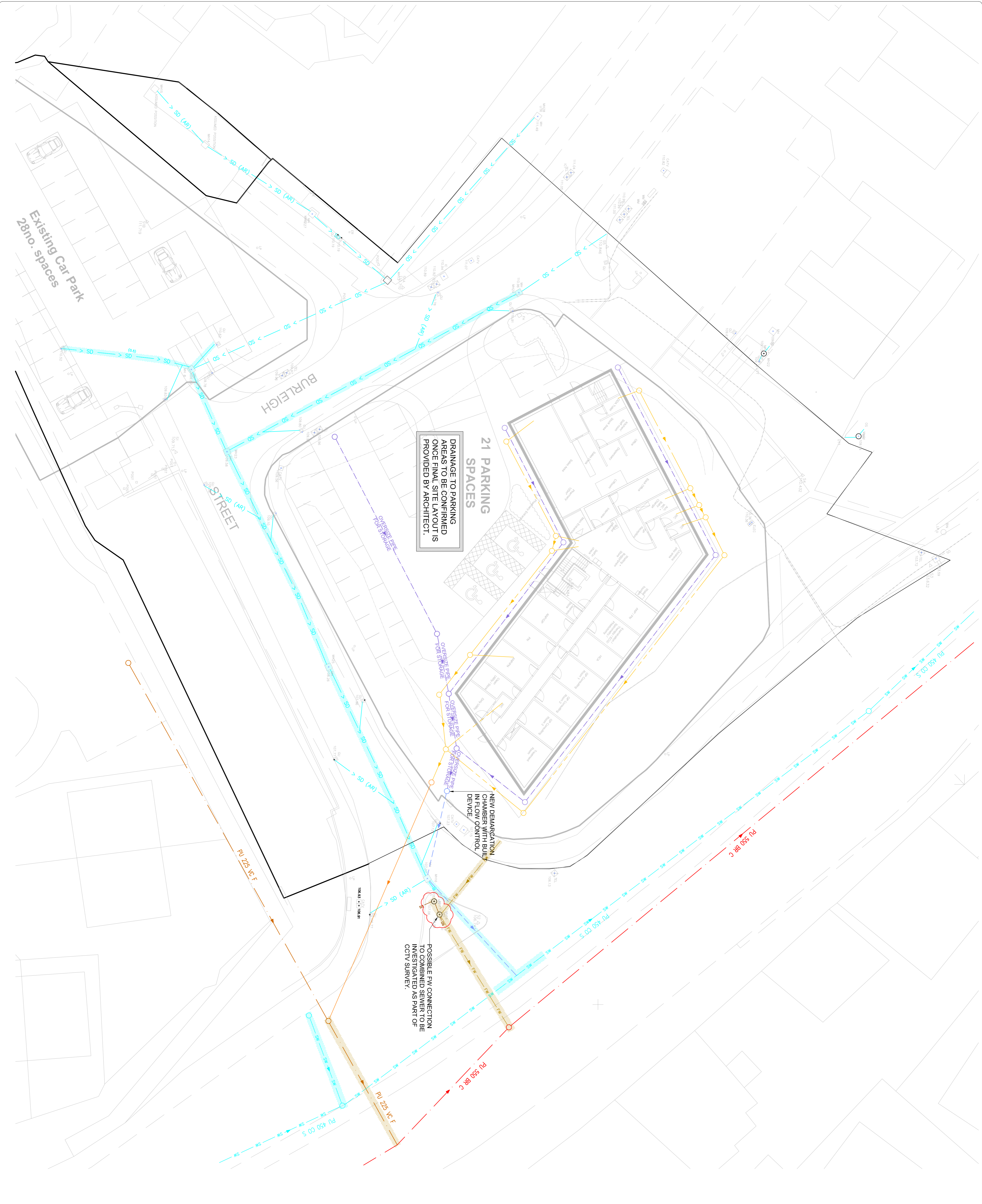

<p>© COPYRIGHT OF BRIDGES POUND LIMITED THIS DRAWING IS THE PROPERTY OF BRIDGES POUND LIMITED AND IS NOT TO BE REPRODUCED OR TRANSMITTED IN ANY FORM OR BY ANY MEANS, ELECTRONIC OR MECHANICAL, INCLUDING PHOTOCOPYING, RECORDING, OR BY ANY INFORMATION STORAGE AND RETRIEVAL SYSTEM, WITHOUT PRIOR WRITTEN CONSENT.</p>		<p>REGISTERED FIRM ISO 9001</p>	
<p>BRIDGES POUND CONSULTING ENGINEERS</p>		<p>10 Station Road Kettlewell, Leeds LS19 5BQ Tel: 0113 274 0721 Fax: 0113 274 9486 Email: g.pound@bridgespound.co.uk</p>	
<p>Client: PARK GROVE BURELIEGH</p>		<p>704 The Chantry West Park 50 Westminster Bridge Road London SE10 0XG Tel: 020 7253 7251 Fax: 020 7953 3717</p>	
<p>Project: PARK GROVE SURGERY BARNSLEY</p>		<p>Wira House 1, West Park 50 Westminster Bridge Road London SE10 0XG Tel: 0113 274 0721 Fax: 0113 274 9486 Email: g.pound@bridgespound.co.uk</p>	
<p>Title: DRAINAGE LAYOUT</p>		<p>Drawing No: Y379/00/01</p>	
<p>Drawing Status: PRELIMINARY</p>		<p>Rev: 0</p>	
<p>Date: FEB 2015</p>		<p>Scale: 1:200</p>	
<p>Drawn: MR</p>		<p>Checked: AMJ</p>	