

0 0.5 1.0 1.5 2.0 2.5m
Scale 1:50

- All dimensions and levels are to be checked on site.
- Any discrepancies are to be reported to the architect before any work commences.
- This drawing shall not be scaled to ascertain any dimensions. Work to figured dims only.
- This drawing shall not be reproduced without express written permission from AEW.
- Title overlay drawings and ownership boundaries are produced using all reasonable endeavours. AEW cannot be responsible for the accuracy or scale discrepancy of base plans supplied to them.
- All works are to be undertaken in accordance with Building Regulations and the latest British Standards.
- All proprietary materials and products are to be used strictly in accordance with the manufacturers recommendations.

CDM 2015

Client notified of duties: **At Annual Review Meeting**

Principal Designer: **Bernard Sims Associates**

Unless noted below, all known hazards have been highlighted on the drawing:

- This drawing is based on Architecture Design Limited drawing 94.20/04.1 Rev C (dated 09.09.2021)
- Proposed layout subject to Building Control approval of fire strategy and access arrangements.
- Where only 1no. Toilet is to be provided; no more than 5no. Members of staff may be permitted to be on the premises at any one time. (In accordance with table 1; Regulation 21 of the Workplace (Health, Safety and Welfare) Regulations 1992)
- Note 2no Estate signs:
 - Large standalone 8m pole sign - internally illuminated
 - Small standalone totem board type sign at entrance to car park - internally illuminated
- New gas, water, electricity and BT / internet all to be installed
- Acoustic / background noise survey report TBC subject to planning conditions

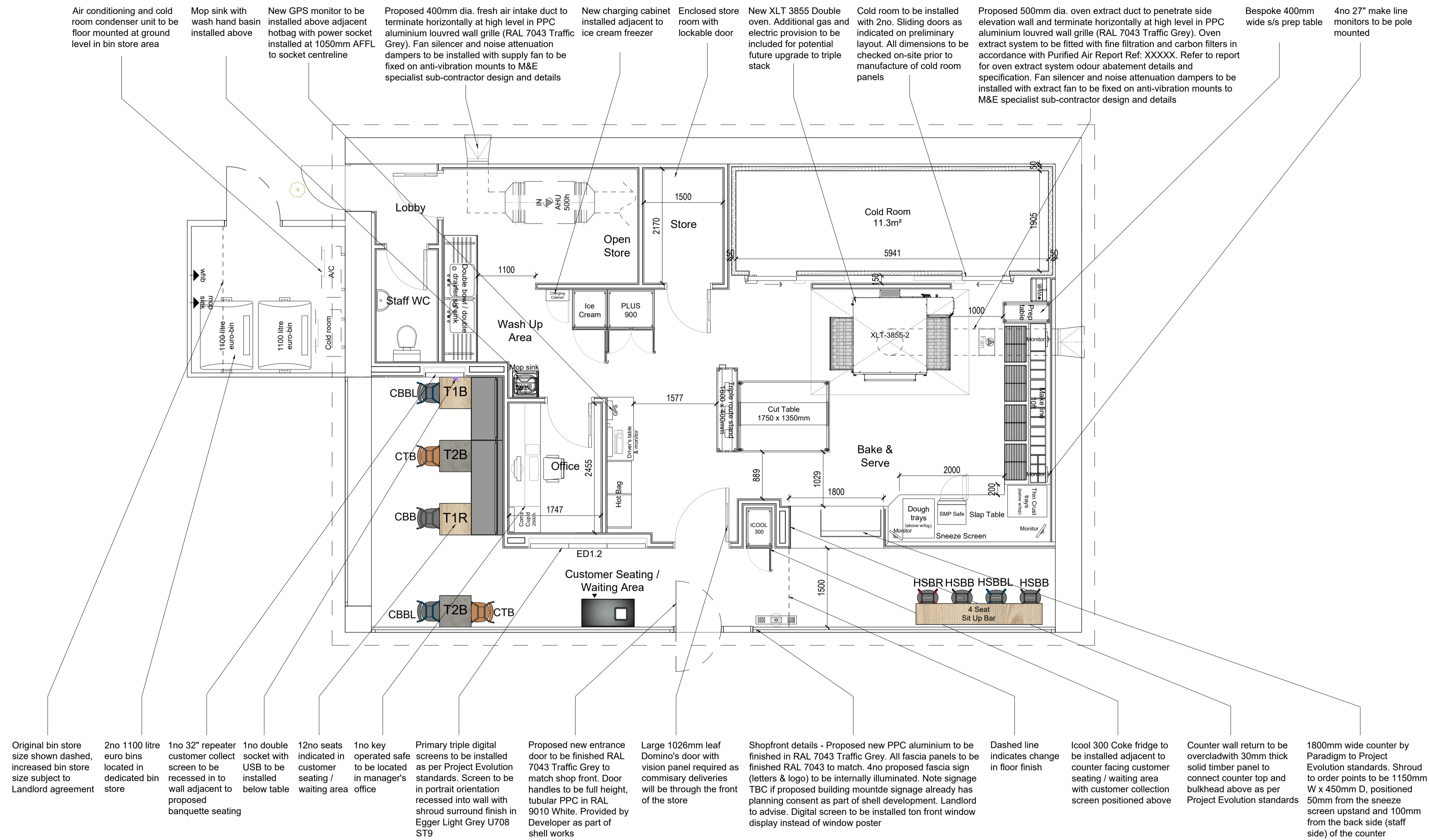

Ground Floor

Note: Door to achieve min. 1050mm clear opening

- Air conditioning and cold room condenser unit to be floor mounted at ground level in bin store area
- Mop sink with wash hand basin installed above
- New GPS monitor to be installed above adjacent hotbag with power socket installed at 1050mm AFFL to socket centreline
- Proposed 400mm dia. fresh air intake duct to terminate horizontally at high level in PPC aluminium louvered wall grille (RAL 7043 Traffic Grey). Fan silencer and noise attenuation dampers to be installed with supply fan to be fixed on anti-vibration mounts to M&E specialist sub-contractor design and details
- New charging cabinet installed adjacent to ice cream freezer
- Enclosed store room with lockable door
- New XLT 3855 Double oven. Additional gas and electric provision to be included for potential future upgrade to triple stack
- Cold room to be installed with 2no. Sliding doors as indicated on preliminary layout. All dimensions to be checked on-site prior to manufacture of cold room panels
- Proposed 500mm dia. oven extract duct to penetrate side elevation wall and terminate horizontally at high level in PPC aluminium louvered wall grille (RAL 7043 Traffic Grey). Oven extract system to be fitted with fine filtration and carbon filters in accordance with Purified Air Report Ref: XXXXX. Refer to report for oven extract system odour abatement details and specification. Fan silencer and noise attenuation dampers to be installed with extract fan to be fixed on anti-vibration mounts to M&E specialist sub-contractor design and details
- Bespoke 400mm wide s/s prep table
- 4no 27" make line monitors to be pole mounted
- Original bin store size shown dashed, increased bin store size subject to Landlord agreement
- 2no 1100 litre euro bins located in dedicated bin store
- 1no 32" repeater customer collect screen to be recessed in to wall adjacent to proposed banquette seating
- 1no double socket with USB to be installed below table
- 12no seats indicated in customer seating / waiting area
- 1no key operated safe to be located in manager's office
- Primary triple digital screens to be installed as per Project Evolution standards. Screen to be in portrait orientation recessed into wall with shroud surround finish in Egger Light Grey U708 ST9
- Proposed new entrance door to be finished RAL 7043 Traffic Grey to match shop front. Door handles to be full height, tubular PPC in RAL 9010 White. Provided by Developer as part of shell works
- Large 1026mm leaf Domino's door with vision panel required as commissary deliveries will be through the front of the store
- Shopfront details - Proposed new PPC aluminium to be finished in RAL 7043 Traffic Grey. All fascia panels to be finished RAL 7043 to match. 4no proposed fascia sign (letters & logo) to be internally illuminated. Note signage TBC if proposed building mounted signage already has planning consent as part of shell development. Landlord to advise. Digital screen to be installed ton front window display instead of window poster
- Dashed line indicates change in floor finish
- Icool 300 Coke fridge to be installed adjacent to counter facing customer seating / waiting area with customer collection screen positioned above
- Counter wall return to be overlaid with 30mm thick solid timber panel to connect counter top and bulkhead above as per Project Evolution standards
- 1800mm wide counter by Paradigm to Project Evolution standards. Shroud to order points to be 1150mm W x 450mm D, positioned 50mm from the sneeze screen upstand and 100mm from the back side (staff side) of the counter

A	05/11/21	JM	JJS
REV	Date	Drawn by -	Checked by -

Status	Purpose of Issue
S2	For Approval
drawing stage	Stage 1c - Preliminary
client	Domino's Pizza Group

project	store
Doncaster Road Barnsley S70 3PE	PJ004174

drawing title	Preliminary Layout
---------------	---------------------------

date	25/10/21	drawn	JM
scale@A1	1:50	checked	JJS