

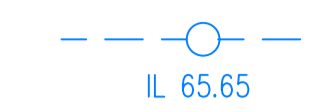

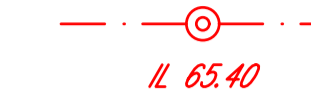

KEY

-  Existing public foul sewer to remain
-  Private surface water sewer and chamber. 110mm dia UPVC unless stated otherwise. IL 65.65
-  Private foul water sewer and chamber. 110mm dia UPVC unless stated otherwise. IL 65.40
-  CHANNEL Linear drainage channel (Aco or similar)
-  Rodding Eye.
-  Cellular Attenuation tank Refer to specific detail

NOTES

All works to comply with Building Regulations Approved document Part H.

Drainage points shown are approximate and should be checked against the house type working drawings.

All existing drainage to be checked for line and level prior to commencement.

Invert levels shown indicate the invert level of the main channel within the chamber. Branches connect at +50mm.

At changes of direction the main channel is to be used with bends outside the chamber. Branches not to be used for changes of direction.

First foul chambers may need to be lowered depending on floor construction.

All Inspection chamber covers and channel drains within driveways are to be class B125 loading minimum.

The position and level of Aco's/gullies/Inspection chambers are approximate only and are dependant on final finished levels.

WATER LEVEL AND BED LEVEL OF WATERCOURSE TO BE CHECKED PRIOR TO WORKS COMMENCING
OUTFALL PIPE TO BE SET 300mm ABOVE NORMAL WATER LEVEL

FOUL CONNECTION IS SUBJECT TO A SECTION 106 APPLICATION TO YORKSHIRE WATER
INVERT LEVEL TO BE CHECKED PRIOR TO WORKS COMMENCING ON SITE

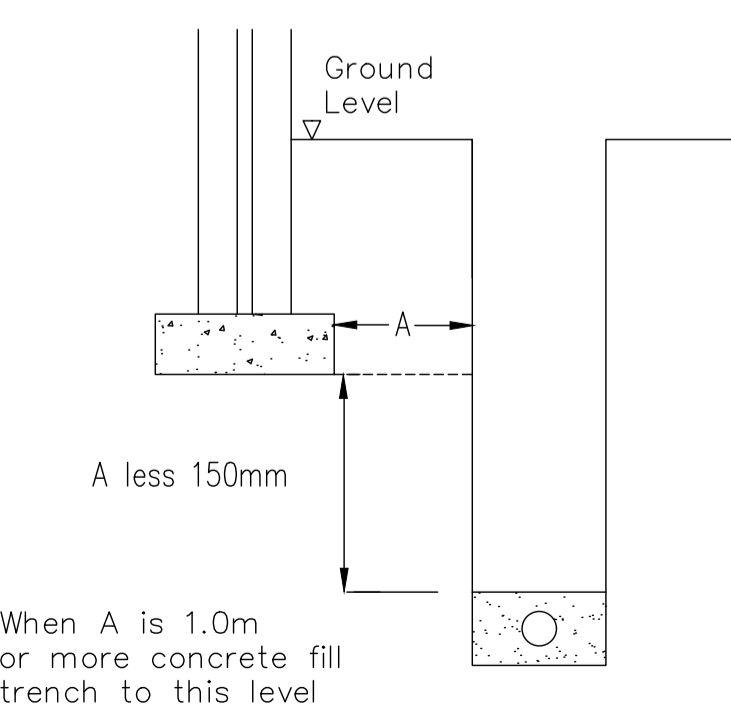
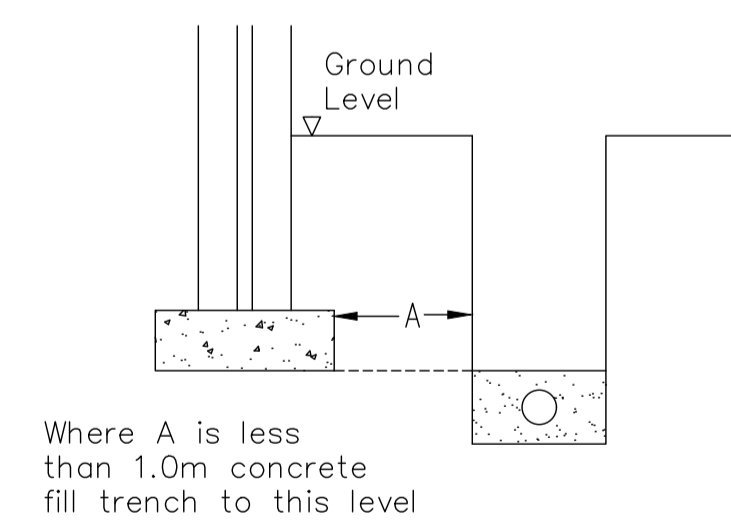

Preliminary

Rev	Details	Date	Drwn	Chk.
A	Tank size amended	22-11-24	AST	

Bo Homes

**Tumbling Lane
Lundwood, Barnsley**

Drainage Design

Dwg No. : STE/24/12/02 A

Date : 18-11-24

Scale : 1:200

Copyright © Shaun Tonge Engineering

**SHAUN TONGE
ENGINEERING**

11 Broomhead Road, Wombwell, Barnsley, S73 0SA.
Mobile 07528 278070 · Email Shauntongeengineering@yahoo.co.uk