

NORTH

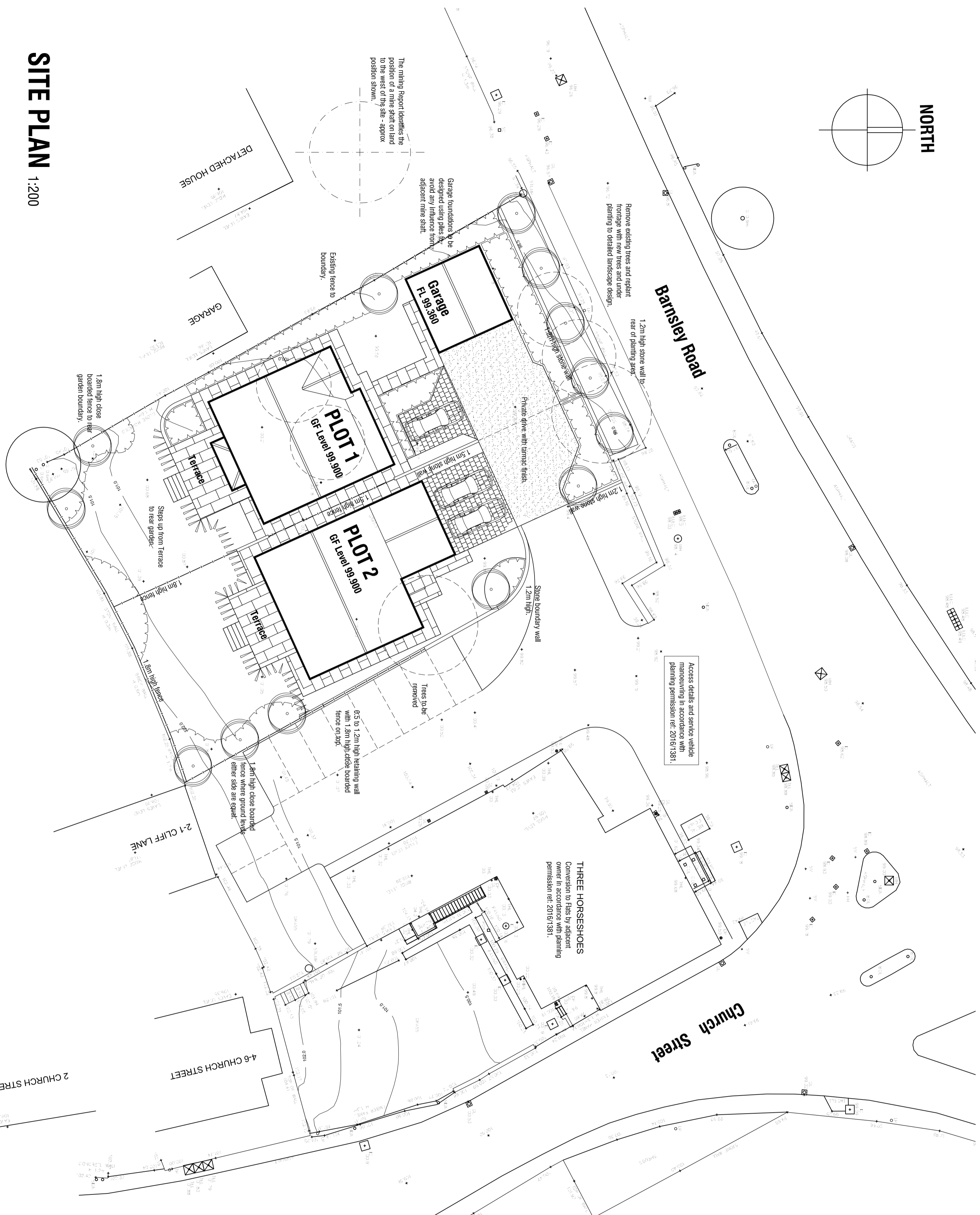
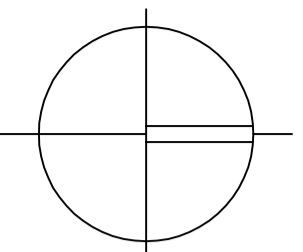

Barnsley Road

Church Street

Garage foundations to be designed using piles to avoid any influence from adjacent mine shaft.

Remove existing trees and replant frontage with new trees and under planting to detailed landscape design.

1.2m high stone wall to rear of planting area.

Private drive with tarmac finish.

1.2m high Stone boundary wall

Access details and service vehicle manoeuvring in accordance with planning permission ref: 2016/7381.

THREE HORSESHOES Conversion to Flats by adjacent owner in accordance with planning permission ref 2016/7381.

The mining Report identifies the position of a mine shaft on land to the west of the site - approx position shown.

Existing fence to boundary.

Garage Fl. 99.360

PLOT 1 GF Level 99.900

PLOT 2 GF Level 99.900

Terrace

Terrace

GARAGE

DETACHED HOUSE

Terrace

Steps up from Terrace to rear garden.

1.8m high close boarded fence to rear garden boundary.

2-1 CLIFF LANE

4-6 CHURCH STREET

2 CHURCH STREET

External Materials:

- Tarmac finish to private drive.
Marshalls Tegula block paving colour ref: Traditional.
Natural stone flags with pointed joints.
Stone walls in Ripon Fall regularly coursed stone flush pointed.
1.8m or as shown, close boarded timber fence with dark brown stain finish.
New tree and shrub planting in accordance with Landscaping Proposals to be submitted for approval prior to commencement.
Trees to be removed

Rev B 20.07.2017 - Amend to coordinate with Landscape Design and Site Investigation Report.
Rev A 18.07.2017 - Update for planning submission.

LAND ADJ THREE HORSESHOES
BARNLSLEY ROAD
BRIERLEY

PROPOSALS

SITE PLAN

mboothdesign
architectural design and building consultants

Fairfield House Barnsley Close
Barnsley S75 2LU
T: 01226 286258
M: 07881 898300
E: mboothdesign@btconnect.com

Scale AS shown @ A2 Drawn MJB
Date June 2017 Ref: 17.13

Dwg No. P01 Rev. B

SITE PLAN 1:200

Copyright mboothdesign. All dimensions in millimeters unless otherwise stated. Dimensions for setting out in existing buildings are to be checked and verified on site.