

metsec 172C13

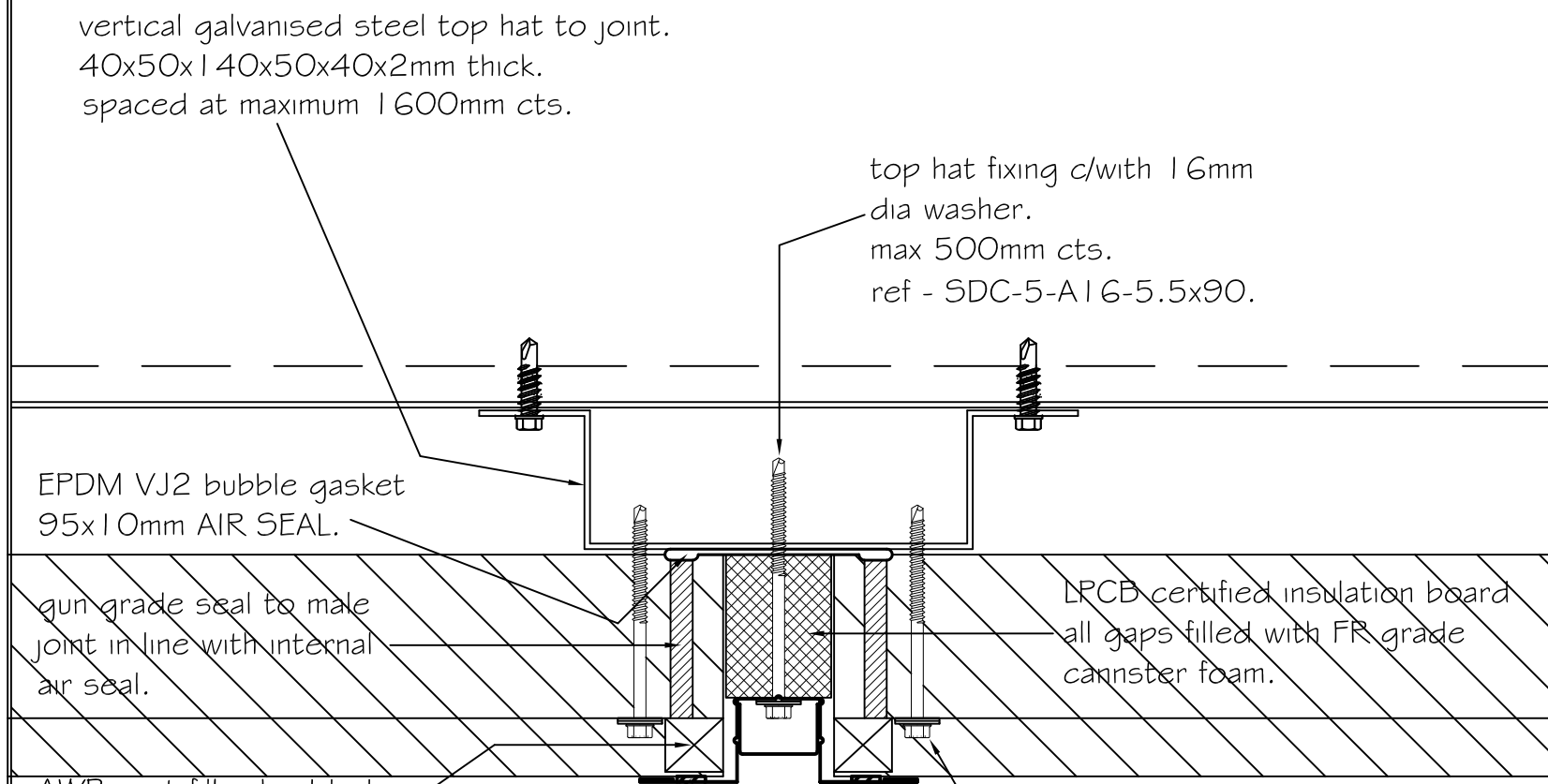

vertical galvanised steel top hat to joint.  
40x50x140x50x40x2mm thick.  
spaced at maximum 1600mm cts.

top hat fixing c/with 16mm  
dia washer.  
max 500mm cts.  
ref - SDC-5-A16-5.5x90.

EPDM VJ2 bubble gasket  
95x10mm AIR SEAL.

gun grade seal to male  
joint in line with internal  
air seal.

AWP joint filler bedded  
on gun grade sealant.

4mm diameter butyl  
rubber sealant.

LPCB certified insulation board  
all gaps filled with FR grade  
canister foam.

80mm thick kingspan  
evolution axis composite  
panel. 600mm module.

anti corrosion coated self  
drilling screw c/ith washer.  
ref - SDC-5-A16-5.5x90.

option A vertical top hat.  
plus recessed insert.  
supplied in 3.0m lengths.  
sealed butt strap to joints.  
ALL TOP HAT / INSERTS SPECTRUM  
METALLIC SILVER.

**TYPICAL VERTICAL JOINT  
DETAIL.**  
for panel profile / specification  
refer drawing C2268 w - 108.

metsec 172C13

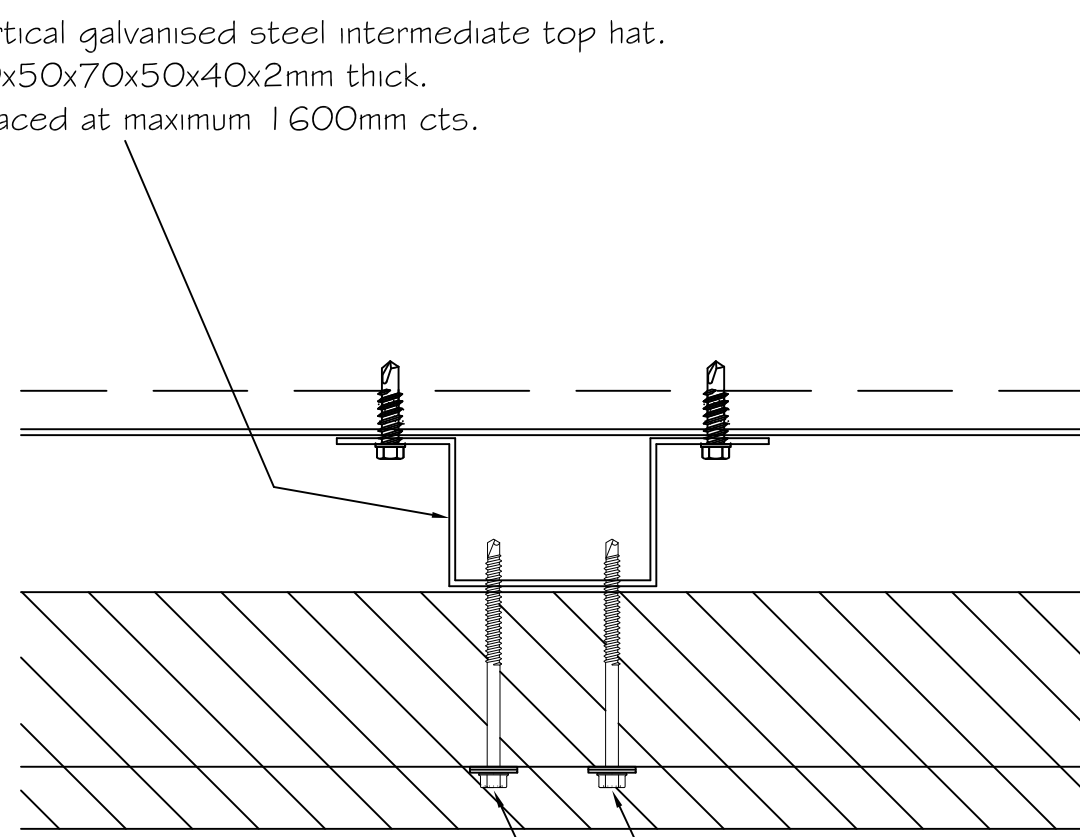

vertical galvanised steel intermediate top hat.  
40x50x70x50x40x2mm thick.  
spaced at maximum 1600mm cts.

**TYPICAL INTERMEDIATE  
JOINT DETAIL.**

anti corrosion coated self  
drilling screw c/ith washer.  
ref - SDC-5-A16-5.5x90.  
2 fixings at intermediate.

**ROOFDEC LIMITED**

BRAITHWELL WAY,  
HELLABY INDUSTRIAL ESTATE,  
ROTHERHAM S66 8QY.  
TEL: #####  
FAX: #####  
E-MAIL: #####

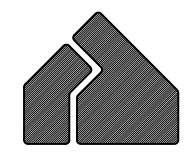

**CONTRACT:**  
BBIC PHASE 5.  
NEW BUILD OFFICE SPACE.  
BARNSELY. S75 1JL.

**TITLE:**  
KINGSPAN WALL PANEL.  
VERTICAL JOINT / FIXING  
DETAILS.

DATE	REV	AMENDMENT
29/6/20	P2	TOP HAT INSERT ADDED. COLOURS NOTED. FIXING REF ADDED.
22/5/20	P1	FIRST ISSUE FOR COMMENT

**DRAWN BY:**  
MOL  
**JOB No:**  
C2268.  
**DRAWING No:**  
C2268 W - 109

**DRAWING STATUS:**  
APPROVAL 1.  
**SCALE:**  
NTS  
**REVISION**  
P1 P2