

# Tree Protection Area KEEP OUT

Do not move this fence

**PLANNING PERMISSIONS**  
TREES ENCLOSED BY THIS FENCE ARE PROTECTED BY PLANNING CONDITIONS WHICH ARE THE SUBJECT OF A TREE PRESERVATION ORDER.  
CONTAMINATION OF A TREE PRESERVATION ORDER MAY LEAD TO CRIMINAL PROSECUTION.  
ANY RE-ENTRY INTO THE PROTECTED AREA MUST BE WITH THE WRITTEN PERMISSION OF THE LOCAL PLANNING AUTHORITY.



## Protective Fencing

To be erected prior to the commencement of all works on site, and retained in place throughout construction.  
Default specification: To comprise either 2.4m wooden site hoarding or a 2.3m high scaffolding framework comprising of vertical and horizontal framework, well braced to resist impacts, with uprights to be spaced at a maximum of 2.0m intervals and driven into the ground to a minimum of 600mm. On to this, standard anti-climb welded mesh panels are to be securely fixed to each other with at least two scaffold clamps and to the scaffold framework with wire.  
Secondary specification: To comprise of 2m tall welded mesh panels on rubber or concrete feet. Panels are to be joined together using a minimum of two anti-tamper covers, installed so that they can only be removed from inside the fence. The panels should be supported on the inner side by stabilizer struts, which should be attached to a base plate and secured with ground pins.  
All weather notices should be erected at regular intervals on the white mesh panels with words such as "Construction exclusion zone - Keep out".

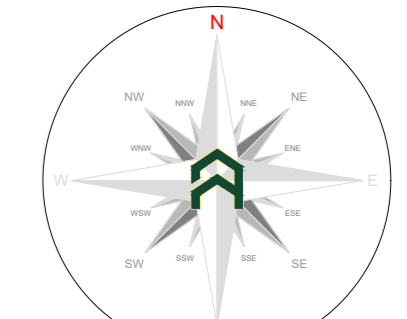

Indicative only

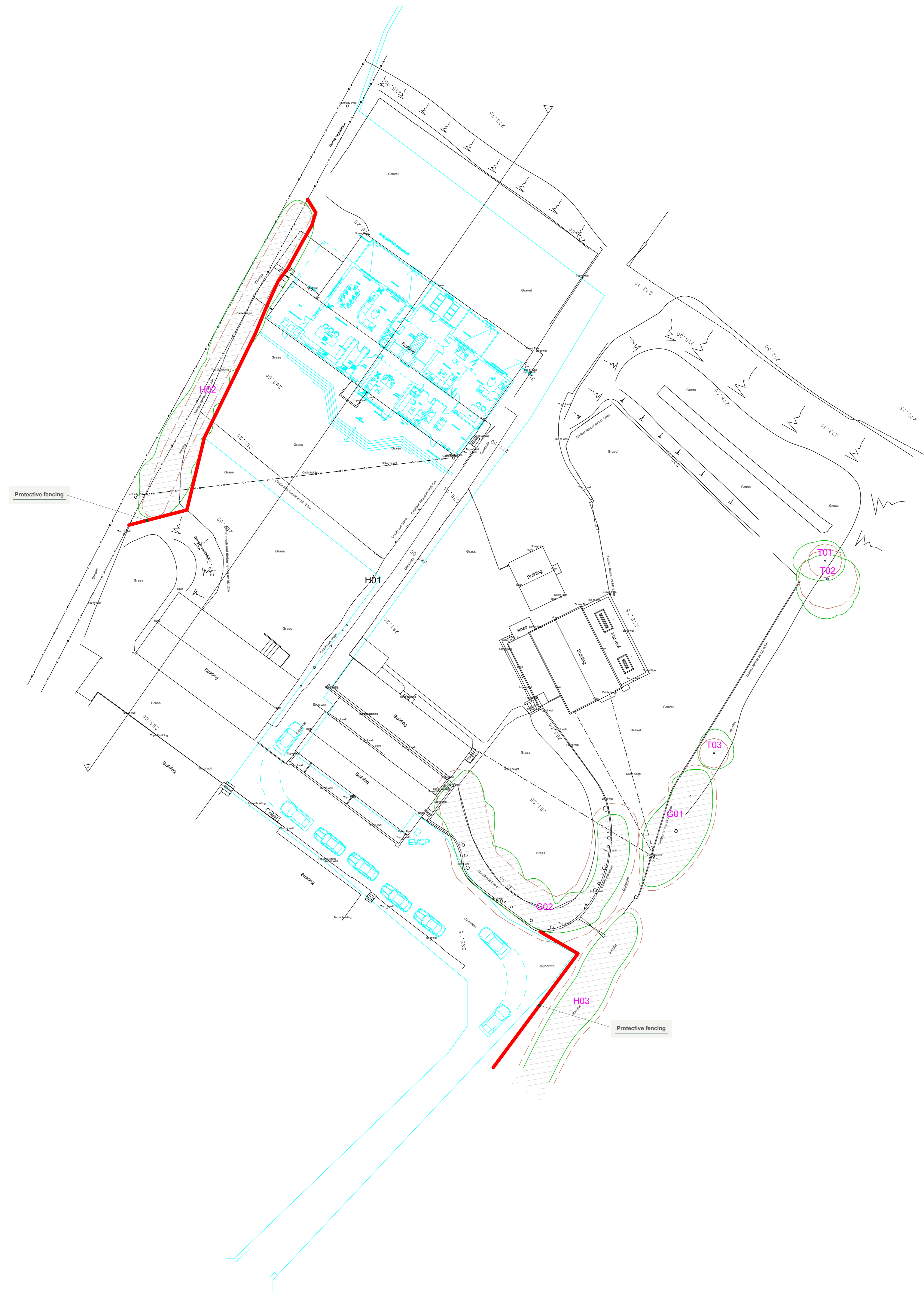

Tree Work Schedule			
No.	Species	Works	Category
H01	Leyland Cypress	Fall trees and remove stumps	C2

All tree work to be undertaken in accordance with British Standard BS 5836:2010 Tree work - Recommendations.  
All stumps are to be removed and the site is to be left as found.  
Care is to be taken of the ground around retained trees to make sure that it does not become compacted as a result of tree surgery operations. No equipment or vehicles such as tractor lorries, tractors, excavators or cranes shall be parked or driven beneath the crowns of any retained trees, to prevent subsequent compaction and root death.

### Arboricultural Supervision

The arboricultural consultant will be required to attend site to directly supervise all demolition and construction works that have to be undertaken within the root protection areas. This will include:

- Pre-commencement site meeting
- Location of protective measures
- Any demolition and/or excavations within or adjacent to RPA's, including foundations, hard surfacing or underground services (a non-exhaustive list)
- Arboricultural sign off and removal of protective measures.

### Arboricultural Method Statement

Please refer to Arbtech Consulting Ltd Tree Schedule and Arboricultural Method Statement, for full details on all surveyed trees and how all aspects of the development may be implemented without detriment to retained trees.



**Project:**  
Stancilffe House Farm,  
Woodhead Road,  
Wortley,  
Sheffield,  
S35 7DA

**Client:**  
Khella Property Services

**Drawing:**  
Tree Protection Plan

**Based on:**  
Proposed Site Plan

**Drawing No:**  
Arbtech TPP 01

**Date:** Feb 2024 **Scale:** 1:200 @ A0 **Drawn:** AJN

**Key:**

Tree Nos.	T01	Tree Canopies	Trunks
RPA's	Category 'B' trees	Category 'B' ground	Category 'B' trees
Category 'C' trees	Category 'C' ground	Existing site	Proposed site
Proposed Site	Trees to be removed	H01	Protective fencing

