

Proposed access gates

Existing access gate to be closed and dry stone walled up to match existing.

JOAN ROYD LANE

new dry stone wall access splays

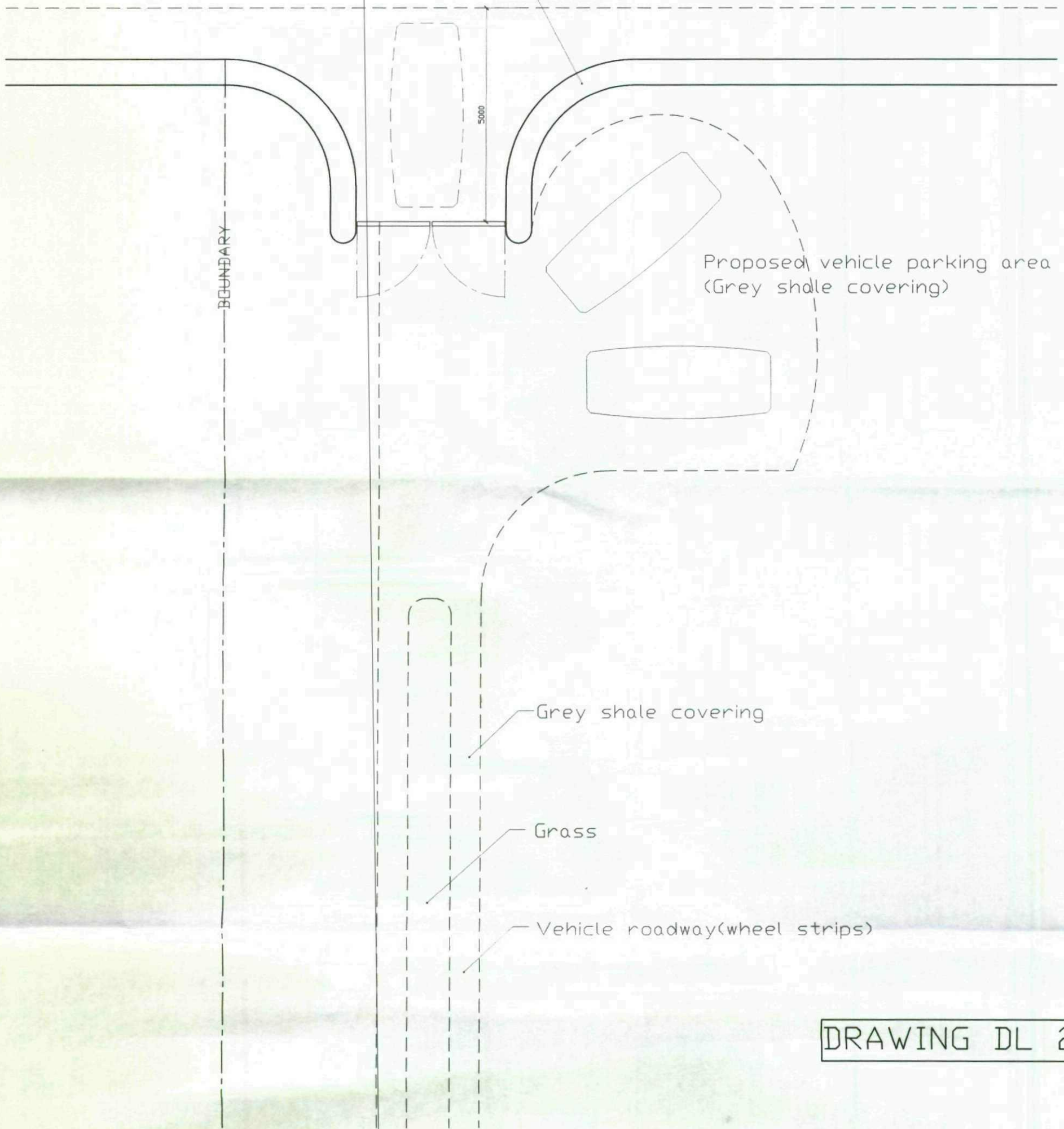

Proposed vehicle parking area (Grey shale covering)

Grey shale covering

Grass

Vehicle roadway (wheel strips)

BOUNDARY

DRAWING DL 2

SCALE 1 : 100

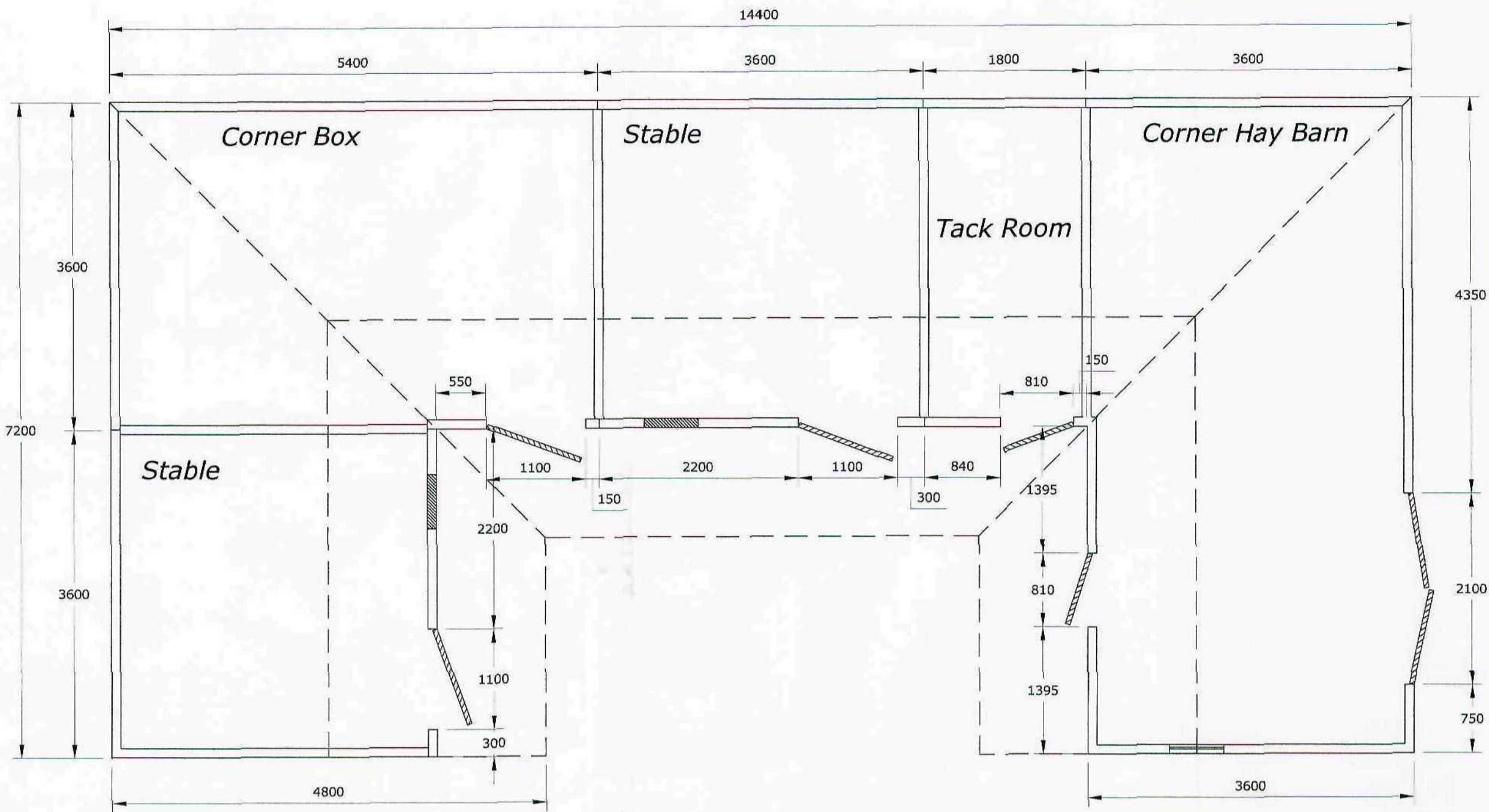

Plan & Section Views 1:50

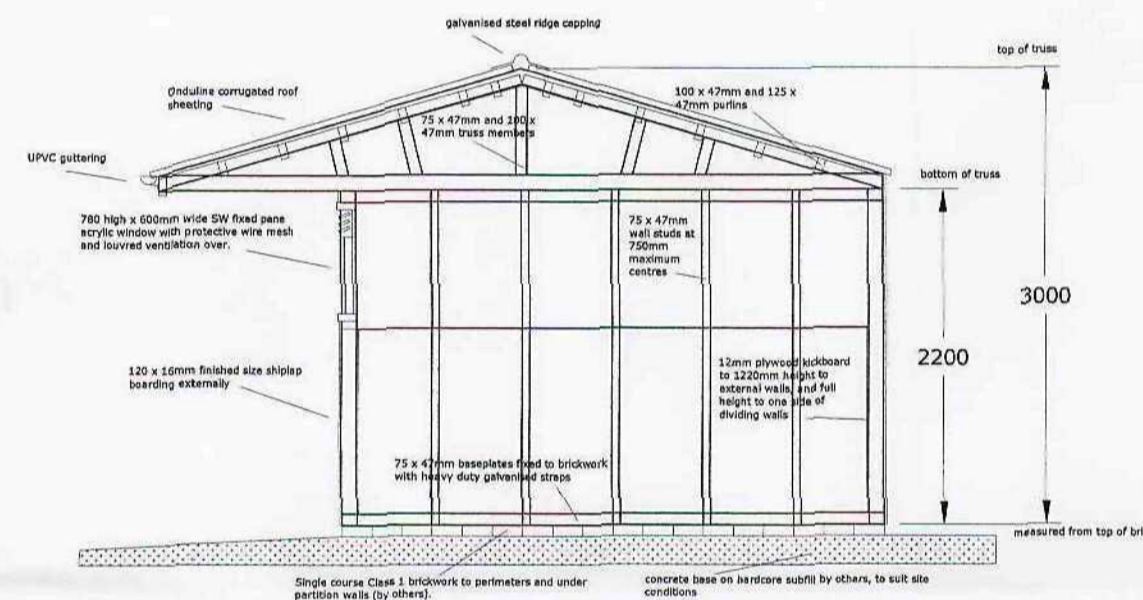

Elevation Views 1:100



Key Plan 1:2500

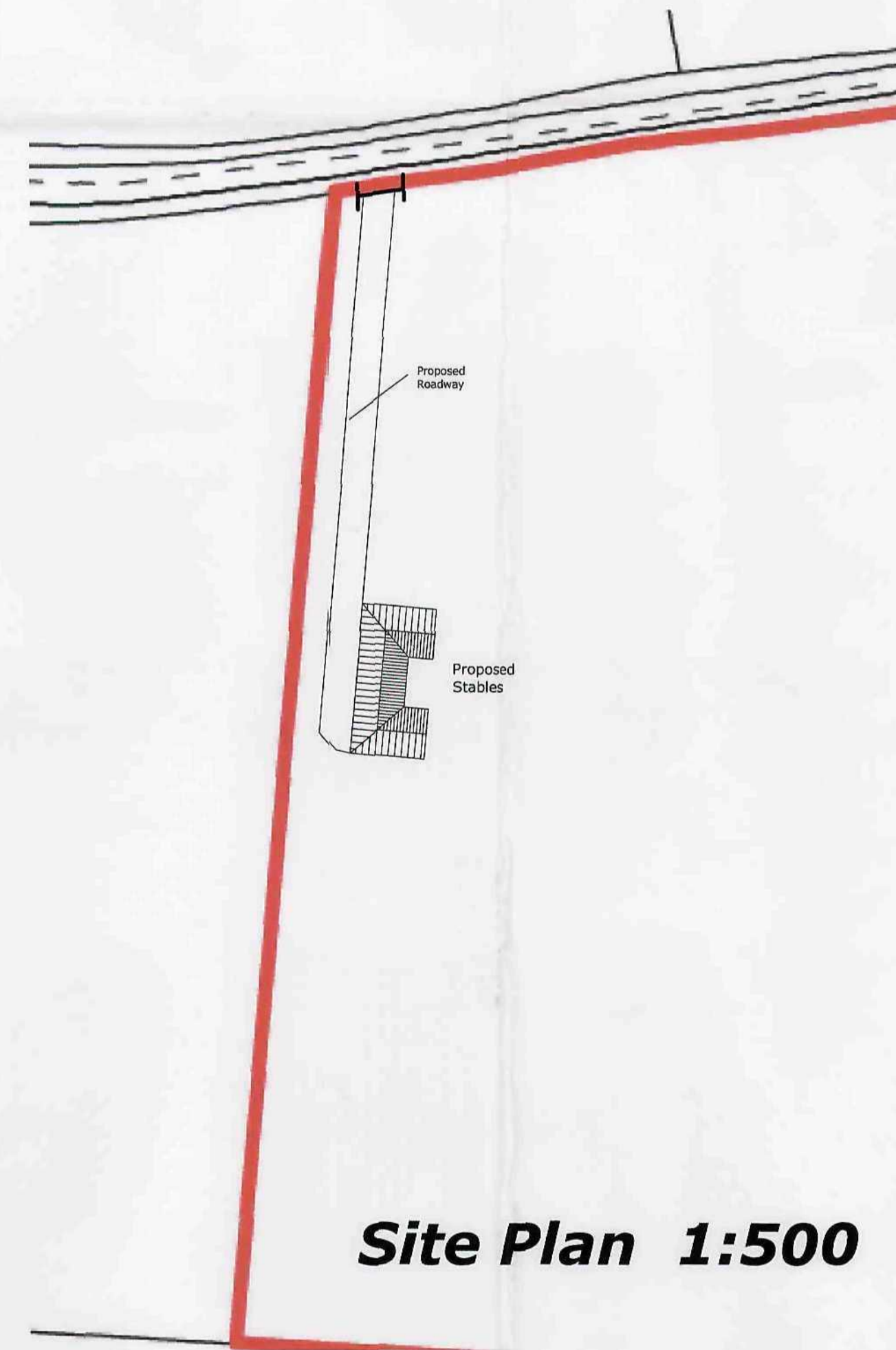

Site Plan 1:500

Written dimensions only to be taken. This drawing must not be used for scaling purposes.
Designs, drawings, and specifications are not to be reproduced without the express permission of Redmire Stables Ltd.

Project Name and Address
Land at:
Joan Royd Cottage
Joan Royd Lane

Janet Woodhead

DRAWING DL 1

General Notes

SPECIFICATION NOTES

ROOF - Onduline black corrugated fibre based roofing sheets with galvanised metal ridge capping.

ROOF TRUSSES - In 75 x 47mm and 100 x 47mm pressure treated softwood with 100 x 47mm and 125 x 47mm purlins as shown on section.

EXTERNAL WALLS - 120 x 16mm (finished size) pressure treated redwood SW shiplap boarding to 75 x 47mm studwork frame with 75 x 47mm headplate and soleplate. 12mm plywood kickboarding 1220mm high on external walls, and to full height internal on dividing walls.

DOORS - 1100 wide x 2130mm high double leaf ledged and braced stable doors with hot dipped galvanised T-hinges, Brenton bolts, cabin hooks, and anti-chew strip.

WINDOWS - 780 high x 600mm wide softwood framed acrylic windows with a protective wire mesh internally, and a permanent louvred ventilator over.

RAINWATER DISPOSAL - 112mm half round black UPVC gutters to fall to 68mm dia rain water pipes to discharge to surface water drains, to be installed by others on accordance with local regulations.

REDMIRE STABLES & BUILDINGS Ltd

Five Oaks Sawmill
Haven Road, Five Oaks
West Sussex
RH14 9BD

Tel: 01403 785508
Fax: 01403 785333

email: mark@redmire.co.uk
web: www.redmire.co.uk

No. Revision / Issue Date

Project *mtp/2008/077*

Date *03rd July 2008*

Scale *as denoted*