

Langley Design Sheldon Bicycle shelter, 6No. spaces covered and lit by LED or solar lighting

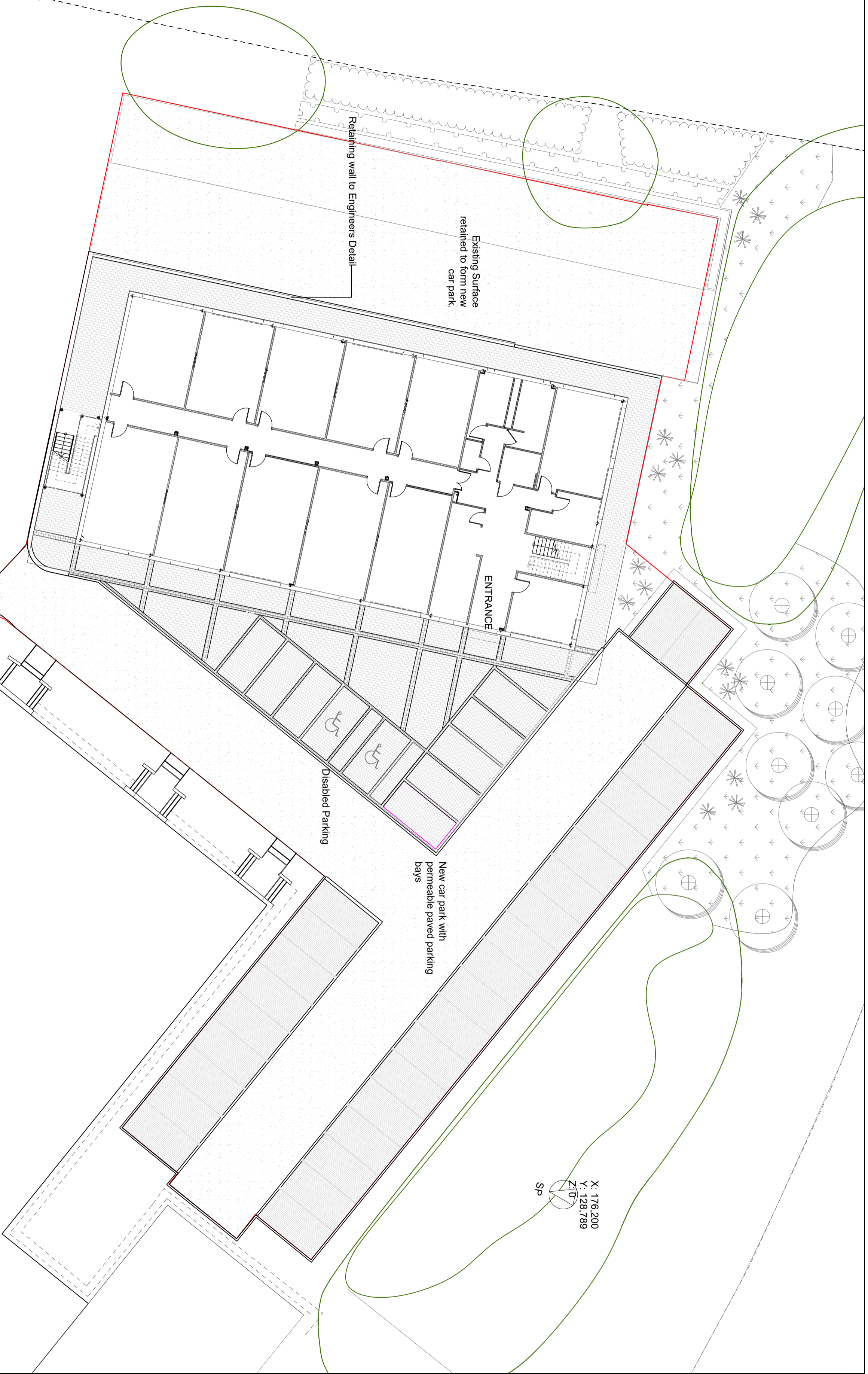

MAIN SITE

# KEY

## Hard Works

- Tobermore Hydropave Sienna Duo  
208/173 x 300 x 60mm Silver grey  
Permeable blocks. In stretcher bond
- Tobermore Hydropave Pedesta 100 x 200 x 80mm natural coloured  
Permeable pavings laid in herringbone with charcoal blocks denoting parking bays
- Tobermore Hydropave Sienna Duo  
208/173 x 173 x 60mm Graphite  
Permeable blocks as inlay detail in single or double rows.
- \*All Permeable blocks to be laid on sub base to BS7533 as per manufacturer recommendations.
- Macadam
- 150 x 150mm PC Concrete channel as edge to paving and parking areas



Langley Design Sheldon bicycle shelter with space for 6No. bikes.

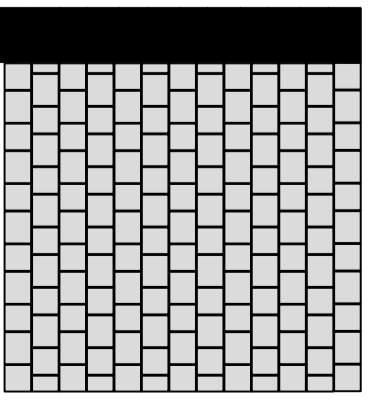

Typical paving layout 1:50 @A1

PL1	17/10/19	For planning	GB	VM
N/A	10/10/19	For Comment	VM	GB
REV:	DATE:	NOTES:	DR:	CK:



Samuel House, 5 Fox Valley Way, Stockbridge, Sheffield, S18 2AA

CLIENT: **EDGE PS Limited**  
 PROJECT: **Barnsley Business and Innovation Centre**  
 DRAWING TITLE: **Hard Landscape Details**

PROJECT NO.: SHF.1717.001  
 DRAWING NO.: L.D.002

DATE: Oct 2019  
 SCALE: 1:200

DRAWN: VM  
 CHECKED: GB

DRAWING STATUS: For Planning  
 ISSUE: PL1