

This drawing is based on survey information supplied by Turner and Townsend combined with Ordnance Survey Information & road realignment information provided by Barnsley Metropolitan Borough Council. Refer to Scott Wilson drawing for proposed level information.

SVFRS to confirm legal boundary prior to commencement

DRAWING KEY

1. Concrete block paving, Marshalls key/block 100 x 200 x 80mm chamfered edge block, on min 25mm sand bedding over base and sub base to structural engineers specification as NBS Q25/335
2. Concrete paving slabs, Marshalls, Charnwood blinding over min. 150mm well compacted hardcore as NBS Q25/315
3. Tarmac, built up, base and sub base to structural engineers specification

Refer to 06-105(90)001 for boundary wall details

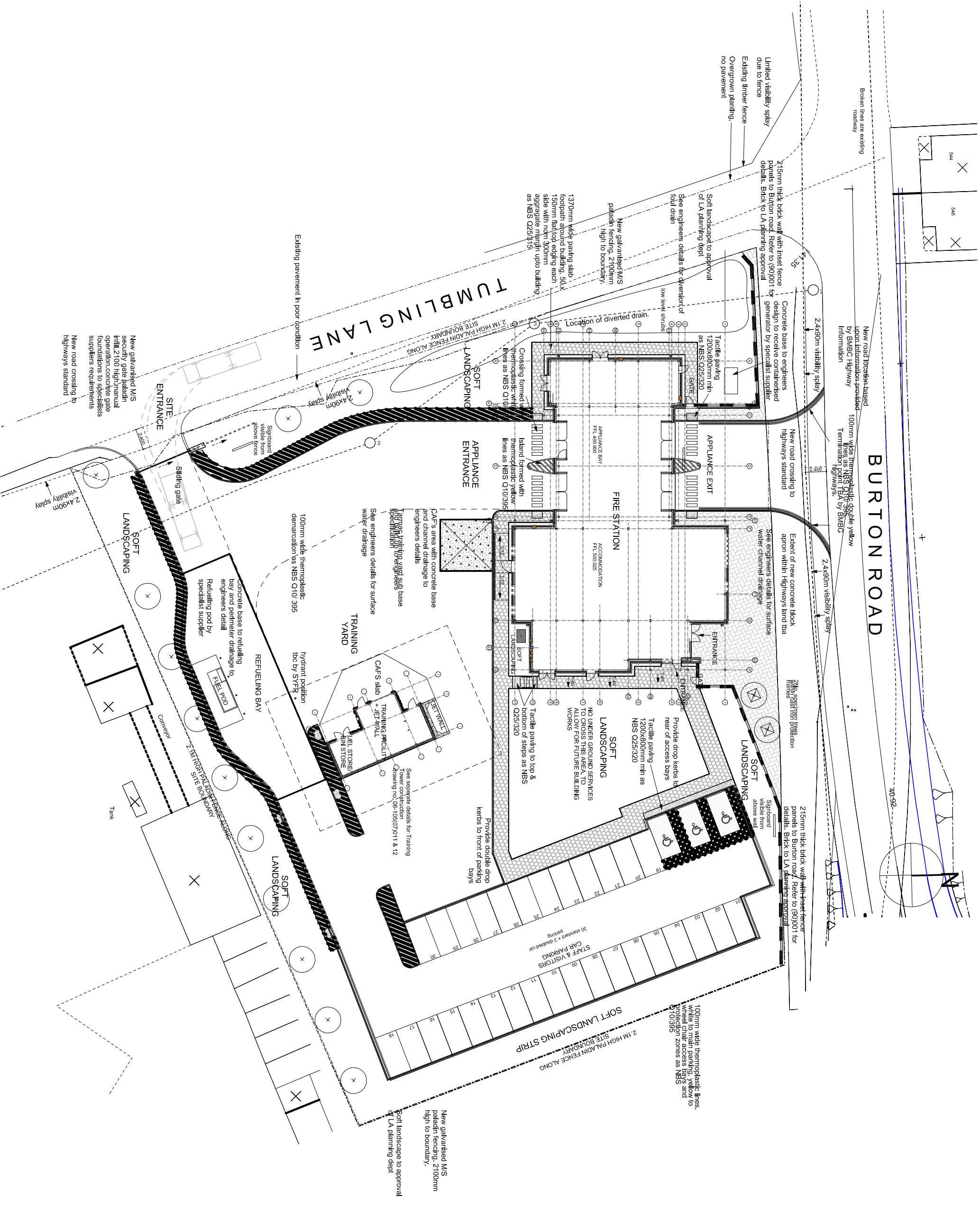

This drawing is a record of the project status taken from the final construction issue including any site amendments to layout as notified to Bond Bryan Architects Ltd. Bond Bryan Architects Ltd accept no liability for changes to layout which may have been implemented but not formally notified to them prior to the issue of this drawing.

R0	Record Issue	ALH	SM	26.04.10
----	--------------	-----	----	----------

Bond Bryan Architects
 Floor 1 Fountain Precinct, Balm Green Sheffield, S1 2JA
 T +44 (0)114 252 8070 E info@bondbryan.co.uk
 F +44 (0)114 279 5988 W www.bondbryan.com

S YORKSHIRE FIRE & RESCUE
 Gudworth Community
 Tumbling Lane Barnsley

PROPOSED SITE PLAN
GUDWORTH COMMUNITY
FIRE STATION
TUMBLING LANE BARNSELEY
PROPOSED SITE PLAN

scale	date	drawn	checked
1:200 @ A1	14.04.09	AS	CT
job no	category / dwg no	revision	
06-105 (06)001	R0		